



SERVICE PARTS LIST

BULLETIN NO.
54-07-2275

SPECIFY CATALOG NO. AND SERIAL NO. WHEN ORDERING PARTS		REVISED BULLETIN	DATE
12V CLAMP METER (AC/DC Clamp)			Apr. 2010
CATALOG NO.	2239-20	SERIAL NUMBER	C18A
WIRING INSTRUCTION			

EXAMPLE:

00	0
----	---

 Component Parts (Small #) Are Included
 When Ordering The Assembly (Large #).

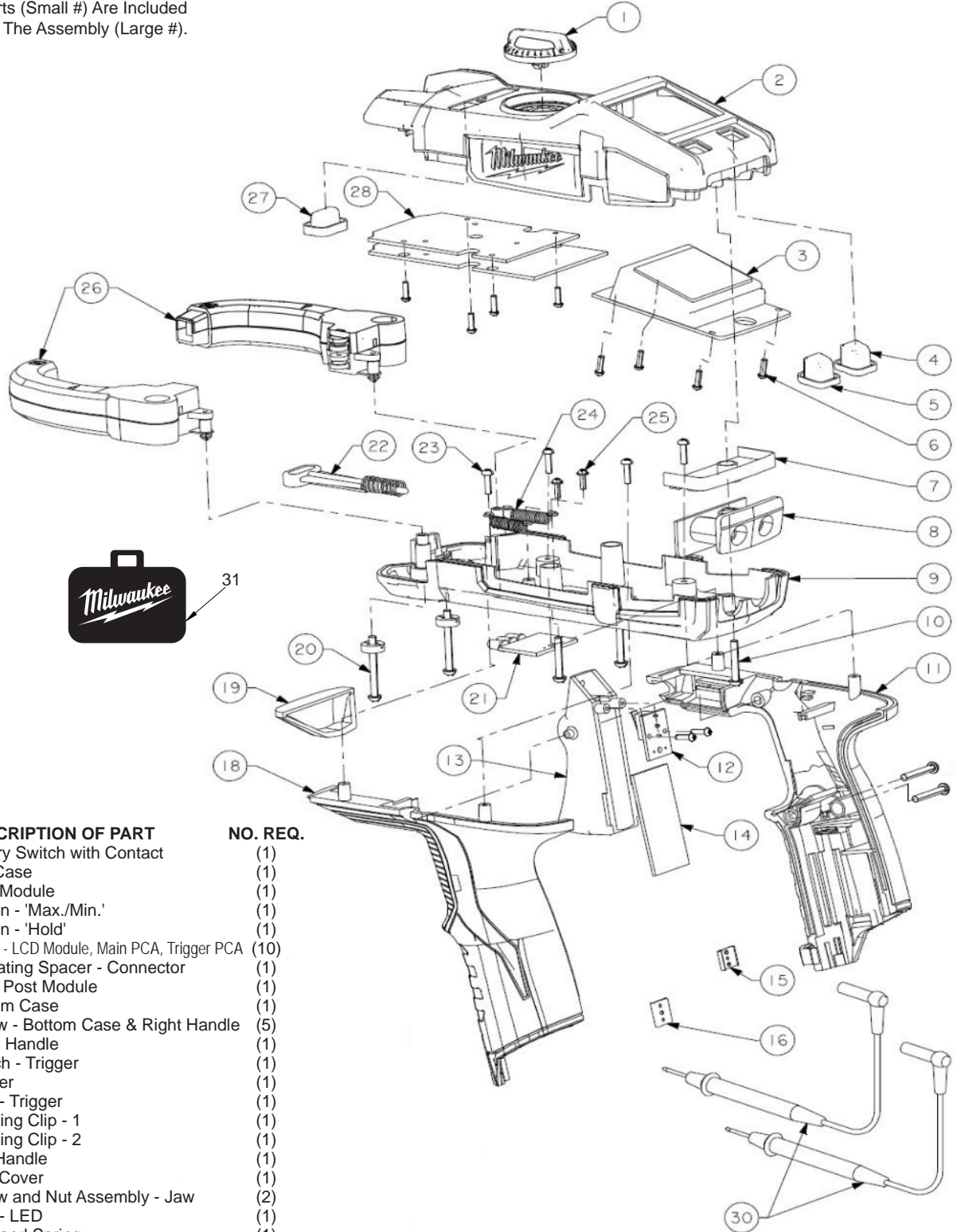

FIG.	PART NO.	DESCRIPTION OF PART	NO. REQ.
1	23-66-0565	Rotary Switch with Contact	(1)
2	31-50-1405	Top Case	(1)
3	44-06-0095	LCD Module	(1)
4	42-42-0080	Button - 'Max./Min.'	(1)
5	42-42-0935	Button - 'Hold'	(1)
6	05-81-0325	Screw - LCD Module, Main PCA, Trigger PCA	(10)
7	31-86-0165	Insulating Spacer - Connector	(1)
8	22-58-0035	Input Post Module	(1)
9	31-50-1435	Bottom Case	(1)
10	05-81-0335	Screw - Bottom Case & Right Handle	(5)
11	31-44-0335	Right Handle	(1)
12	23-66-0455	Switch - Trigger	(1)
13	31-92-0040	Trigger	(1)
14	22-06-0110	PCA - Trigger	(1)
15	42-70-0075	Housing Clip - 1	(1)
16	42-70-0055	Housing Clip - 2	(1)
18	31-44-0365	Left Handle	(1)
19	44-06-0105	LED Cover	(1)
20	06-10-0100	Screw and Nut Assembly - Jaw	(2)
21	22-06-0115	PCA - LED	(1)
22	44-10-0165	Pole and Spring	(1)
23	05-81-0345	Screw - Right and Left Handle	(4)
24	40-50-0685	Plug Spring	(2)
25	05-81-0355	Screw - Plug Spring	(4)
26	30-55-0025	Jaw Assembly	(1)
27	42-42-0090	Button - 'Zero'	(1)
27a	42-42-0115	Button - 'Inrush'	(1)
28	22-06-0135	Main PCA	(1)
30	49-77-1001	Test Lead Set	(1)
31	42-55-0010	Carrying Case, Optional	(1)

MILWAUKEE ELECTRIC TOOL CORPORATION
 13135 W. LISBON RD., BROOKFIELD, WI 53005
 Drwg. 2