

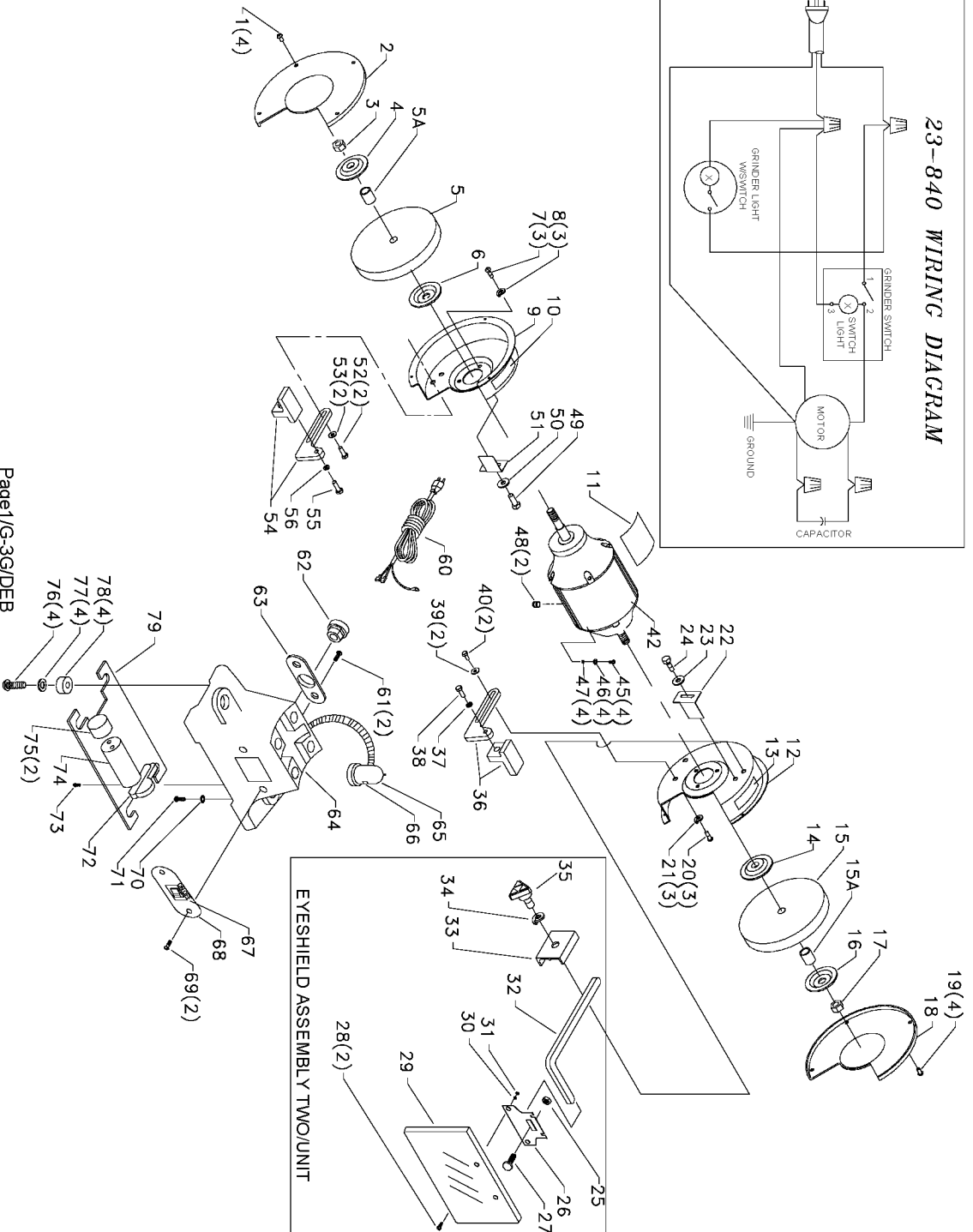

23-840 8" GRINDER W/LIGHT

G-3G

PART NO. 900646
Revised: 10-15-04

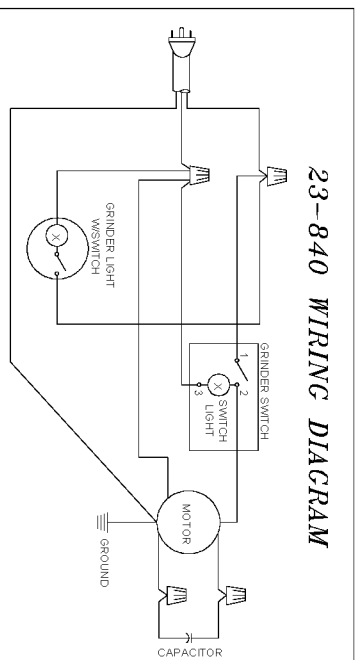

Parts List for 23-840 Type 1

| Item Number | Part Number | Description | Qty Required |
|-------------|--------------|---------------------|--------------|
| 1 | 1320003 | SCREW | 4 |
| 2 | 1320400 | COVER | 1 |
| 3 | 1320074 | LH NUT | 1 |
| 4 | 000000-00 | No Longer Available | 1 |
| 5 | 23-883 | 8IN GRIND WHEEL/36G | 1 |
| 5 | 1346830 | BUSHING(5/8 TO 1/2) | 1 |
| 6 | 000000-00 | No Longer Available | 1 |
| 7 | 1320005 | SCREW | 3 |
| 8 | 000000-00 | No Longer Available | 3 |
| 9 | 000000-00 | No Longer Available | 1 |
| 10 | 491834-00 | ROTATION LABEL | 1 |
| 11 | 000000-00 | No Longer Available | 1 |
| 12 | 000000-00 | No Longer Available | 1 |
| 13 | 491834-00 | ROTATION LABEL | 1 |
| 14 | 000000-00 | No Longer Available | 1 |
| 15 | 23-884 | 8IN GRIND WHEEL/60G | 1 |
| 15 | 1346830 | BUSHING(5/8 TO 1/2) | 1 |
| 16 | 000000-00 | No Longer Available | 1 |
| 17 | 1320075 | HEX NUT 1/2-12 | 1 |
| 18 | 1320400 | COVER | 1 |
| 19 | 1320003 | SCREW | 4 |
| 20 | 901021207528 | MACHINE SCREW | 3 |
| 21 | 000000-00 | No Longer Available | 3 |
| 22 | 000000-00 | No Longer Available | 1 |
| 23 | 5140010-69 | WASHER | 1 |
| 24 | 1340609 | BOLT | 1 |
| 25 | 489026-00 | HEX NUT | 1 |

Parts List for 23-840 Type 1

| Item Number | Part Number | Description | Qty Required |
|-------------|---------------|---------------------|--------------|
| 26 | 1320426 | FRAME | 1 |
| 27 | 901110200821 | CARRIAGE BOLT | 1 |
| 28 | 901023031066 | SCREW | 2 |
| 29 | 1320424 | EYESHIELD | 1 |
| 29 | 000000-00 | No Longer Available | 1 |
| 30 | 1320087 | WASHER | 1 |
| 31 | 902011201216 | HEX NUT | 1 |
| 32 | 1320423 | ROD | 1 |
| 33 | 1320422 | BRACKET | 1 |
| 34 | 904020101703S | LOCK WASHER | 1 |
| 35 | 000000-00 | No Longer Available | 1 |
| 36 | 1320828 | TOOL REST ASSY | 1 |
| 37 | 904020101703S | LOCK WASHER | 1 |
| 38 | 901010600607S | SCREW | 1 |
| 39 | 491956-00 | WASHER | 2 |
| 40 | 489047-00 | CAP SCREW | 2 |
| 45 | 901020100511 | MACHINE SCREW | 4 |
| 46 | 491957-00 | LOCK WASHER | 4 |
| 47 | 489026-00 | HEX NUT | 4 |
| 48 | 1320155 | GROMMET | 2 |
| 49 | 1340609 | BOLT | 1 |
| 50 | 5140010-69 | WASHER | 1 |
| 51 | 000000-00 | No Longer Available | 1 |
| 52 | 489047-00 | CAP SCREW | 2 |
| 53 | 491956-00 | WASHER | 2 |
| 54 | 1320828 | TOOL REST ASSY | 1 |
| 55 | 901010600607S | SCREW | 1 |

Parts List for 23-840 Type 1

| Item Number | Part Number | Description | Qty Required |
|-------------|---------------|---------------------|--------------|
| 56 | 904020101703S | LOCK WASHER | 1 |
| 60 | 000000-00 | No Longer Available | 1 |
| 61 | 1320005 | SCREW | 2 |
| 62 | 1320130 | STRAIN RELIEF | 1 |
| 63 | 1320211 | PLATE | 1 |
| 64 | 000000-00 | No Longer Available | 1 |
| 65 | 000000-00 | No Longer Available | 1 |
| 66 | 1349968 | WARNING LABEL | 1 |
| 67 | 1320151 | SWITCH | 1 |
| 68 | 000000-00 | No Longer Available | 1 |
| 69 | 1320003 | SCREW | 2 |
| 70 | 488983-00 | LOCK WASHER | 1 |
| 71 | 1320005 | SCREW | 1 |
| 72 | 1320160 | CLAMP | 1 |
| 73 | 1320005 | SCREW | 1 |
| 74 | 000000-00 | No Longer Available | 1 |
| 75 | 000000-00 | No Longer Available | 2 |
| 76 | 901023031066 | SCREW | 4 |
| 77 | 1320087 | WASHER | 4 |
| 78 | 1320217 | PAD | 4 |
| 79 | 1320416 | COVER | 1 |