

PORTER-CABLE

SPEED-BLOCK[®]

FINISHING SANDER

WARNING: Electrical repairs should only be attempted by trained repairmen. Contact the nearest Porter-Cable Service Center or other competent repair center.

330

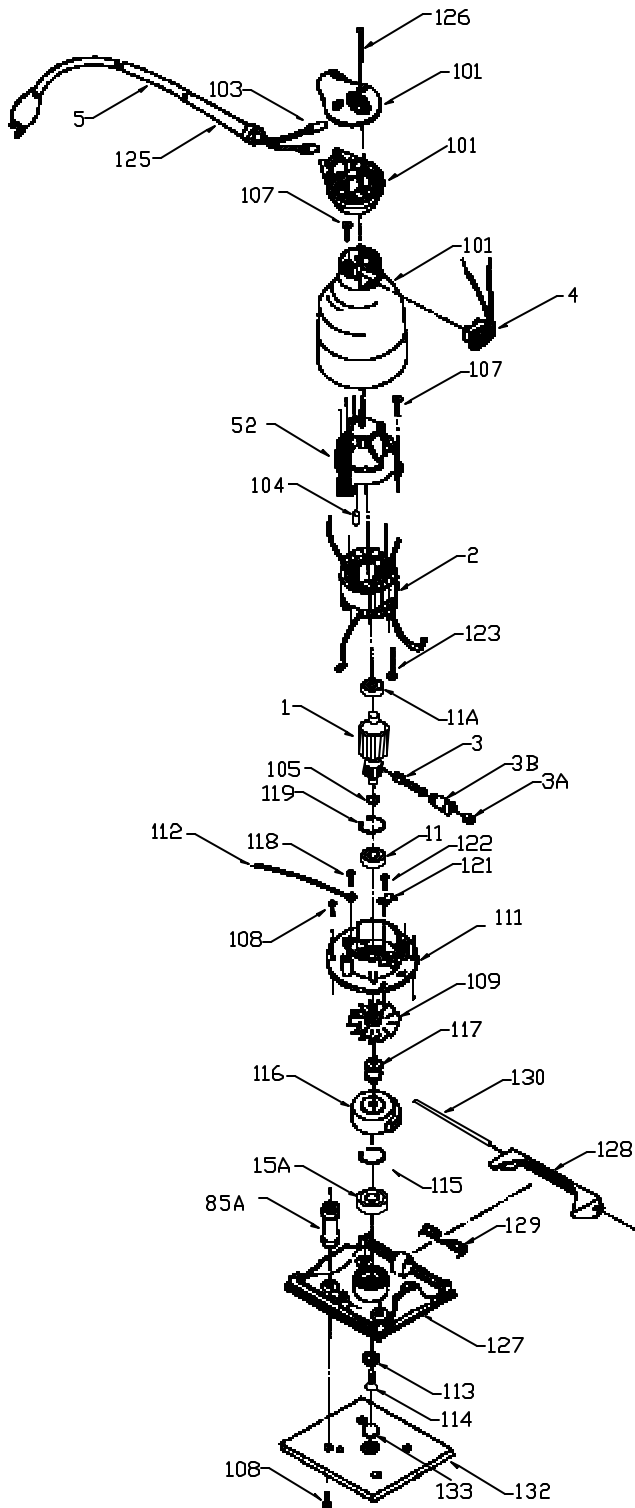

| Ref. No. | Part No. | Description |
|----------|----------|--|
| 1 | 681044** | Armature, 120V |
| 2 | 681045** | Field, 120V |
| 3 | 848790** | Brush, 120V |
| | 849103 | Brush, 220V |
| 3A | 823727 | Brush Cap |
| 3B | 848476** | Brush Holder |
| 4 | 882294 | Switch |
| 5 | 872258 | Cord, 120V (330T2, 330C) |
| | 846674 | Cord, 120V (330T1) |
| | 862891 | Cord, 220V (Euro) |
| 11 | 887099 | Bearing |
| 11A | 855284 | Bearing |
| 15A | 855277** | Counterweight Bearing |
| 52 | 843431 | Motor Housing |
| 85A | 846738 | Pad Posts |
| 101 | 873520 | Housing Set (Current Matte Finish) |
| 103 | 846249 | Wire Nut |
| 104 | 842597 | Rubber Plug |
| 105 | 823738 | Armature Spacing Ring |
| 107 | 878262 | Screw |
| 108 | 681637 | Self-Tapping Screw 10 - 16 X 1/2" (Late T1, T2) |
| | 851011 | Machine Screw 10 - 32 X 1/2" (Early T1) |
| 109 | 843438 | Fan |
| 111 | 843407 | Bearing Housing |
| 112 | 849314 | Ground Terminal (T1) |
| 113 | 843457 | Counterweight Washer |
| 114 | 877532 | Counterweight Screw |
| 115 | 802302 | Bearing Ring |
| 116 | 874573 | Counterweight |
| 117 | 845493 | Coupling |
| 118 | 803157 | Ground Screw (6-32x1/4, Late T1) |
| | 844107 | Ground Screw (8-32x1/4, Early T1) |
| 119 | 859769 | Retaining Ring (Lower Bearing) |
| 121 | 801271 | Brush Holder Retainer |
| 122 | 844107 | Brush Holder Screw |
| 123 | 824080 | Field Screw |
| 125 | 843464 | Strain Relief |
| 126 | 876651 | Self-Threading Screw (Current) |
| | 802759 | Machine Screw (Early) |
| 127 | 843471** | Pad Holder Assy., Incl: Ref 15A, 115, 128, 129, 130 |
| 128 | 843449 | Paper Clamp |
| 129 | 843450 | Paper Clamp Spring |
| 130 | 859064 | Paper Clamp Rod |
| 132 | 13597 | Foam Stikit Pad (Current) |
| | 846724 | Felt Pad (Early, NOT for use with Stikit [®] Type Abrasives) |
| 133 | 847698 | Dust Seal |
| * | 846372 | Paper Clamp Wrench |
| * | 844864 | Paper Clamp Pad (Early T1, 330C) |
| * | 855628 | Field Lead (with Brush Terminal) |

ACCESSORIES (Optional)

| | | |
|----|-------|---|
| * | 47696 | Sponge Contour Pad (NOT for use with Stikit [®] Type Abrasives) |
| * | 47699 | Felt Rubbing Pad |
| * | | Not Shown |
| ** | | See Service Notes |

Stikit[®] is a Registered Trademark of Minnesota Mining and Manufacturing Corp.

PORTER-CABLE
PROFESSIONAL POWER TOOLS

BRUSH AND BRUSH HOLDER - 330 T1 - REF. 3 & 3B

Early Model Type 1 units incorporated a shorter brush and brush holder than later models.

Early Model T1

843456 Brush Holder 1 1/8" Long
857761 Brush 3/8" Long

Late Model T1 & T2

848476 Brush Holder 1 5/16" Long
848790 Brush 9/16" Long

PAD HOLDER AND BEARING - REF. 127 & 15A

Clean pad holder (Ref. 127), bearing bore and outer race of ball bearing (Ref. 15a). Apply light coating of #609 Loctite to bearing bore and assemble immediately. Allow one-hour cure time before operating tool.

ARMATURE AND FIELD 220V - REF. 1 & 2

The 220 Volt armatures and fields are no longer available.