

PARTS LIST

10" JOB SITE TABLE SAW

MODEL NO. C10RB

PARTS LIST FOR SCHEMATIC

Always order by I.D. Number

HKU#	I.D.	Description	Size	QTY	HKU#	I.D.	Description	Size	QTY
726434	08VH	CORD CLAMP		1	325736	10HW	SWITCH BOX		1
325684	08W1	BRACKET		1	325737	10HZ	SEGMENT GEAR		1
325685	08W2	SPACER		1	325738	10J0	POINTER BRACKET		1
325686	08WG	ANGLE ROD BRACKET		1	325739	10J1	NEEDLE POINTER		1
325687	08WS	STRAP		3	325740	10J4	ANGLE ROD		1
325688	08ZK	FLAT WASHER		2	325741	10J5	DUST COLLECTOR JOINT		1
325689	0901	BUSH		1	325742	10J6	SCREW BAR		1
325690	0908	FLAT WASHER	D=φ16	1	325743	10J9	CAP HD. SQ.NECK BOLT	M6*1.0-40	1
325691	0909	FLAT WASHER	D=φ15	1	325744	10JK	SIDE COVER		1
325692	090Q	PLUNGER HOUSING		1	325745	10JL	RACK		1
726437	09JK	WRENCH		1	325746	10JN	SET PLATE		2
325693	09XJ	COMPRESSION SPRING		1	325747	10JP	SIDE COVER		1
325694	0898	BEVEL GEAR		1	325748	10JR	LOCATING BAR		1
325695	089E	BUSH	D=φ16 H=16	3	325749	10JS	ROLL PIN		1
325696	089M	STRAP		1	325750	10JU	ANCHOR PLATE		2
325697	089N	STRAP		4	325751	10JV	LOCATING BAR		1
325698	08A1	COMPRESSION SPRING		1	325752	10JW	LOCATING BAR		1
325699	08A3	ANCHOR BLOCK	D=φ20 d=φ10	1	325753	10JX	INSERT	#23	1
726450	08A4	SPACER		1	325754	10JY	SPACER		2
325700	08A5	ARBOR COLLAR		1	325755	10JZ	SIDE COVER		2
726454	08AC	SET NUT		1	325756	10K1	INSERT	#23	1
726455	08AE	ARBOR COLLAR	φ45	1	325757	10K2	BUSH		2
325701	087V	SPONGE		2	325758	10K4	PARALLEL PIN		2
325702	08CM	BEVEL GEAR		1	325759	10K5	HEX. SOC. HD. CAP BOLT	M5*0.8-8	4
726466	08D0	BLADE		1	325760	10K6	HEX. SOC. HD. CAP BOLT	M6*1.0-30	2
726473	0J3P	HEX. WRENCH		1	325761	20GJ	BRACKET STOP		1
726474	0J3Q	HEX WRENCH		1	325762	20XZ	HEIGHT REGULATING BOLT ASS'Y		1
325703	0J4D	FLAT WASHER	φ5*10-1	4	325763	213B	SPACER	40*5	4
726477	0J4E	FLAT WASHER	φ6*13-1	1	325764	21CX	FOLLOWER PLATE		1
726478	0J4F	FLAT WASHER	φ8X16-2.5	4	325765	239T	CR.RE. PAN HEAD TAPPING & WASHER SCREW	M5*0.8-16	4
325704	0J4Q	FLAT WASHER	φ12*21-2	1	325916	26E8	FLAT WASHER	φ5*9.5-1.2	1
726484	0J6G	FLAT WASHER	φ8.2*18-2.0	2	726762	275R	LOCATION SEAT		1
325706	0J6K	FLAT WASHER	φ6*30-4	1	325766	28BN	COVER		1
726485	0J6T	FLAT WASHER	3/16*3/4-1/16	4	325767	28C3	RACK		1
726486	0J6U	FLAT WASHER	3/16*1/2-3/64	4	325769	28EX	NEEDLE POINTER		1
726490	0J76	FLAT WASHER	1/4*3/4-1/16	2	325770	28FL	SCALE ASS'Y		1
726491	0J78	FLAT WASHER	1/4*1/2-3/32	1	726811	28P2	ROCKER SWITCH		1
325708	0J7E	FLAT WASHER	5/16*11/16-1/16	4	726812	28PA	KNOB		1
325709	0J88	FLAT WASHER	10*1/2-1/16	1	726817	28QS	POWER CORD CLAMP		2
726495	0J8D	FLAT WASHER	3/8*3/4-5/64	1	325772	28V2	HEX WASHER HD BOLT	M6*1.0-16	2
726497	0J95	SPRING WASHER	φ6	1	726873	293H	PUSH -BLOCK		1
726502	0JAF	EXTERNAL TOOTH LOCK WASHER	φ5	1	325773	29R2	WARNING LABEL		4
325710	0JE6	C-RING		4	325774	29R6	STICKER		1
325711	0JPM	HEX. HD. BOLT	M6X1.0-70	1	325775	29R9	CUSHION		1
726534	0JX7	HEX. SOC. SET SCREW	M6*1.0-6	6	325776	2A6C	RAIL		1
325713	0JYN	HEX. SOC. COUNTERSUNK HD. SCREW	M6*1.0-25	4	325917	2CC8	BODY SHELL		1
325714	0K0X	HEX. HD. SCREW AND WASHER	M6*1.0-16	2	325781	2CC9	SWITCH BOX COVER		1
726539	0K2B	HEX SOC. HD. CAP SCREW	M6*1.0-16	4	325782	2CCA	HANDLE		4
325717	0K35	CR.RE. PAN HD. SCREW & WASHER	M5*0.8-25	1	325783	2CCB	FRONT PANEL		1
726545	0K3X	CR.RE. PAN HD. SCREW & WASHER	M5X0.8-14	1	325784	2CCC	WHEEL		1
325720	0K6U	CR.-RE. TRUSS HD. SCREW	M4X0.7-8	1	325798	2CHM	TABLE	#CD	1
726553	0K72	CR.-RE. TRUSS HD. SCREW	M5X0.8-12	1	325799	2CHN	SIDE TABLE	#CD	1
726555	0K7F	CR. RE. ROUND WASHER HD. SCREW	M5*0.8-8	3	325801	2DDE	HANDLE BAR ASS'Y		1
726557	0K7K	CR. RE. ROUND WASHER HD. SCREW	M6*1.0-12	6	325802	2DDJ	MITER GAUGE ASS'Y		1
325721	0K9S	HEX. HD. TAPPING SCREW	M5*0.8-25	4	325803	2DDK	PARALLEL BRACKET ASS'Y		1
325722	0KA5	CR.RE. PAN HD. TAPPING SCREW	M4*16-20	5	325804	2DE9	SPLITTER BRACKET		1
325723	0KB3	CR.RE. PAN HD. TAPPING SCREW	M4*18-8	2	325806	2DFU	SPLITTER		1
726573	0KB9	CR.RE. PAN HD. TAPPING SCREW	M5X16-10	5	325807	2DT5	RAIL		1
325725	0KC6	CR. RE. TRUSS HD. TAPPING SCREW	M4*16-12	6	325808	2DTD	HANDLE	#CE	1
325726	0KCF	CR. RE. TRUSS HD. TAPPING SCREW	M4*18-10	3	325809	2DTL	BLADE GUARD ASS'Y		1
726577	0KCX	CR. RE. PAN HD PLAIN WASHER TAPPING SCREW	M5*0.8-10	8	325810	2DV1	POWER CABLE ASS'Y		1
726578	0KCY	CROSS-RECESSED PAN HD PLAIN WASHER TAPPING SCREW	M5*0.8-12	4	325811	2DV6	LOCKING HANDLE ASS'Y		1
325727	0KCC	CROSS-RECESSED PAN HD PLAIN WASHER TAPPI	M5*0.8-16	2	325812	2DVA	HANDLE		3
726580	0KDJ	CR. RE. PAN HD. SCREW	M5*0.8-12	2	325817	2E0T	MOTOR		1
325728	0KDN	CR. RE. PAN HD. SCREW	M5*0.8-25	1	325820	2EA9	SPACER		2
325729	0KEA	CR. RE. PAN HD. SCREW	M6*1.0-35	2	325823	2EHM	WARNING LABEL		1
325914	0KJO	CAP HD. SQ.NECK BOLT	M6*1.0-16	2	325824	2EHN	LABEL		1
726591	0KJ7	CAP HD. SQ.NECK BOLT	M8*1.25-16	1	325826	2EHS	LABEL		1
726597	0KMS	HEX. NUT	M6*1.0 T=5	1	325827	2EHT	CAUTION LABEL		1
726603	0KMY	HEX. NUT	M8*1.25 T=6.5	1	325828	2EHV	CAUTION LABEL		1
325730	0KNE	HEX. NUT	M6*1.0 T=5	2	325829	2EHW	TILTING SCALE		1
325731	0KP8	HEX. NUT	9/16*18UNF T=8	1	325830	2EHY	SCALE		1
726616	0KQX	NUT	M6*1.0 T=6	2	325918	2EHZ	LABEL		1
726617	0KQY	LOCK NUT	M8*1.25 T=8	4	325919	2ERK	FRONT COVER		1
726620	0KRR	SERRATED TOOTHED HEXAGON FLANGE NUT	M6*1.0 T=6	8	325836	2EPX	BODY		1
325732	0KTA	STRAIN RELIEF		2	325840	2ETF	LABEL		1
726635	0LSL	CIRCUIT BREAKER SWITCH		1					

10" JOB SITE TABLE SAW

MODEL NO. C10RB

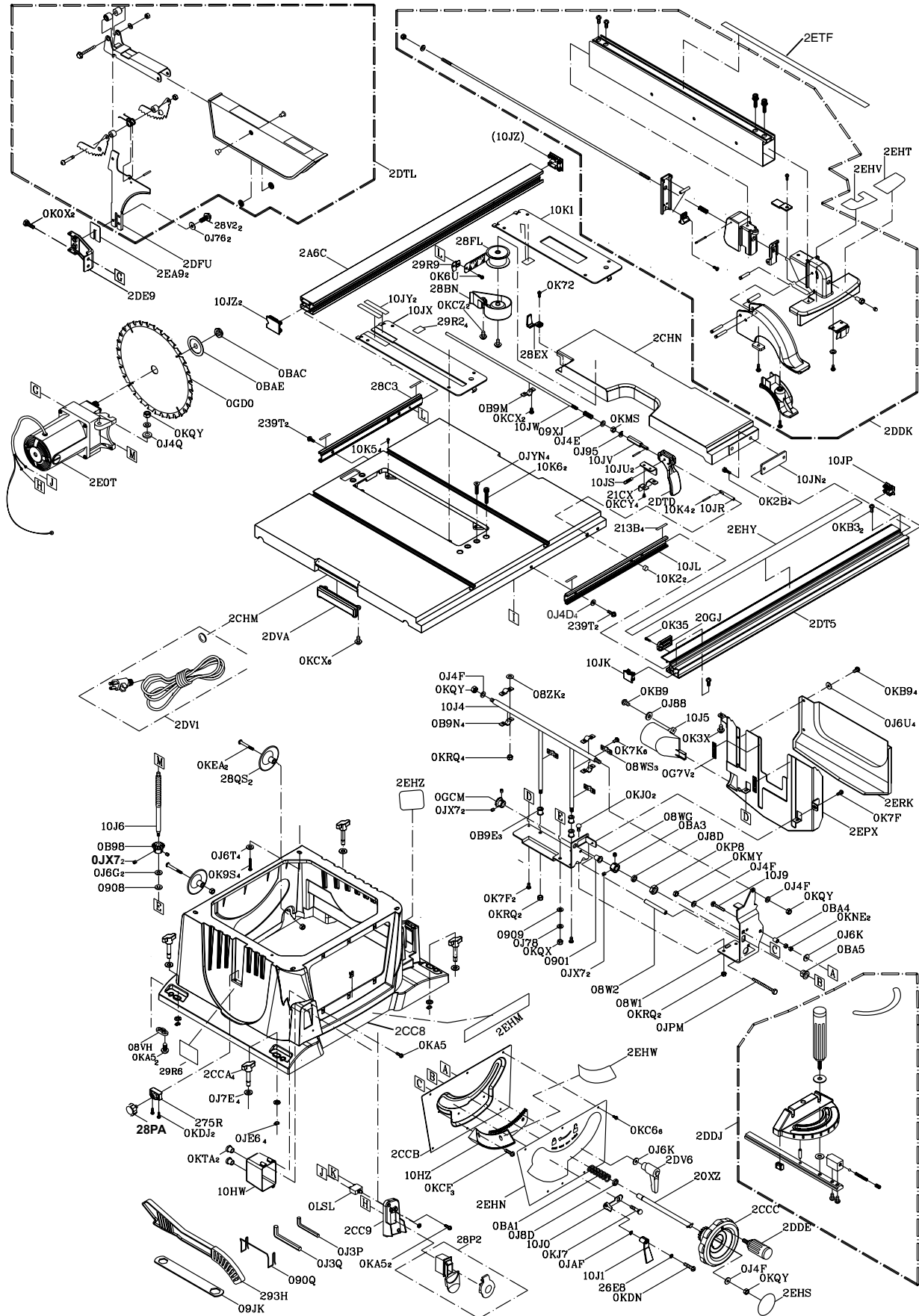

PARTS LIST FOR STAND

HKU#	I.D.	Description	Size	QTY
726482	OJ4W	FLAT WASHER	φ8.2*18-1.5	4
325712	OJPV	HEX. HD. BOLT	M8X1.25-70	2
726617	OKQY	LOCK NUT	M8*1.25 T=8	2
326151	2457	FLAT WASHER	φ10*22-2	2
325915	OZW7	WING NUT		1
325785	2CCD	BRACKET ASS'Y	#CE	1
325786	2CCE	BRACKET ASS'Y	#CE	1
325797	2CFW	RUBBER FOOT BUSH		3
325920	2F5Y	FLOOR PLATE		1
325921	2F69	LEVELING PAD		1

