

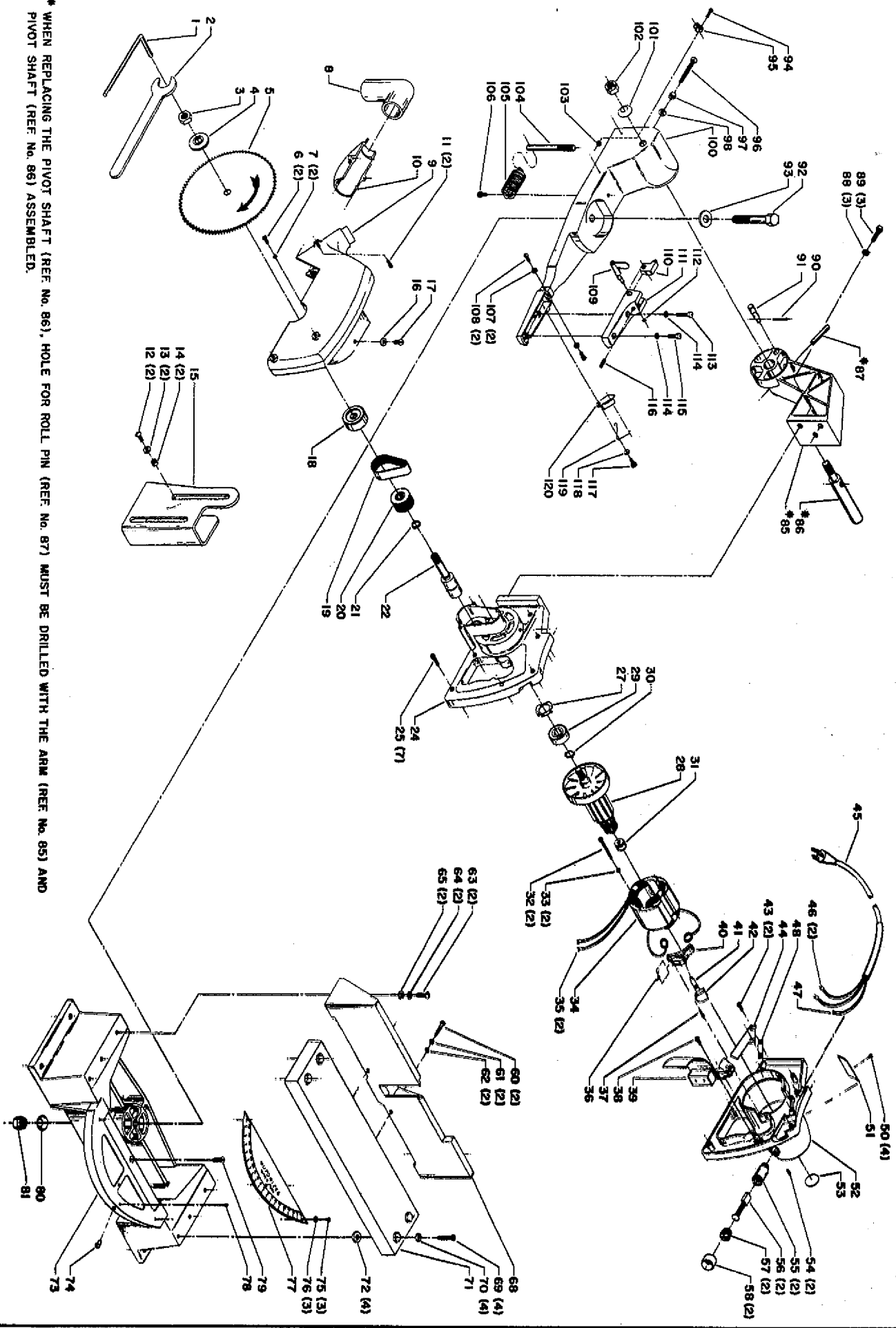

# 34-010 MOTORIZED MITER BOX (OLD STYLE, PRIOR TO SERIAL NO. FD-6575)

MB-1  
Revised 1-1-85



\* WHEN REPLACING THE PIVOT SHAFT (REF. NO. 86), HOLE FOR ROLL PIN (REF. NO. 87) MUST BE DRILLED WITH THE ARM (REF. NO. 85) AND PIVOT SHAFT (REF. NO. 86) ASSEMBLED.

## Parts List for 34-010 Type 1 Prior to S/N FD-6575

Item Number	Part Number	Description	Qty Required
1	000000-00	No Longer Available	1
2	000000-00	No Longer Available	1
3	000000-00	No Longer Available	1
4	489170-00	FLANGE	1
5	000000-00	No Longer Available	1
6	901061217381	SCREW	2
7	904020101701	Use 904-02-010-1726	2
8	000000-00	No Longer Available	1
9	000000-00	No Longer Available	1
11	901061617382	Use 1087576	2
12	901020100503	MACHINE SCREW	2
13	904010101614S	STEEL WASHER	2
14	422171040001	SPACER	2
15	000000-00	No Longer Available	1
16	904010101614S	STEEL WASHER	1
17	901030408015S	CAP SCREW	1
18	000000-00	No Longer Available	1
19	000000-00	No Longer Available	1
20	000000-00	No Longer Available	1
21	000000-00	No Longer Available	1
22	000000-00	No Longer Available	1
24	000000-00	No Longer Available	1
25	000000-00	No Longer Available	1
27	000000-00	No Longer Available	1
29	920040205335	BEARING	1
30	904150120293	RING	1
31	920040916633	BEARING	1

## Parts List for 34-010 Type 1 Prior to S/N FD-6575

Item Number	Part Number	Description	Qty Required
32	901020520716	SCREW	2
33	491958-00	LOCK WASHER	2
36	000000-00	No Longer Available	1
37	422170710002	PIN	1
38	901061217383	SCREW	1
39	000000-00	No Longer Available	1
40	000000-00	No Longer Available	1
41	842828	BRAKE LEVER	1
42	842827	BRAKE BUTTON	1
43	901061217383	SCREW	2
44	000000-00	No Longer Available	1
45	000000-00	No Longer Available	1
48	000000-00	No Longer Available	1
50	901064502250S	DRIVE SCREW	4
51	000000-00	No Longer Available	1
54	901040900112	SET SCREW	2
55	438020110001	HOLDER	2
56	000000-00	No Longer Available	2
57	803250	CAP	2
58	000000-00	No Longer Available	1
60	000000-00	No Longer Available	2
61	904020101701	Use 904-02-010-1726	2
62	904010101610S	STEEL WASHER	2
63	901020100501	MACHINE SCREW	2
64	491957-00	LOCK WASHER	2
65	904010101604S	STEEL WASHER	2
68	422170430002	Use 422-17-043-0003	1

## Parts List for 34-010 Type 1 Prior to S/N FD-6575

Item Number	Part Number	Description	Qty Required
69	901020100535	MACHINE SCREW	4
70	904010101604S	STEEL WASHER	4
71	000000-00	No Longer Available	1
72	904080213886	WASHER	4
73	000000-00	No Longer Available	1
74	000000-00	No Longer Available	1
75	901020100558	MACHINE SCREW	3
76	492056-00	WASHER	3
77	000000-00	No Longer Available	1
78	901041506227	SET SCREW	1
79	422171120004	LEVEL SCR	1
80	000000-00	No Longer Available	1
81	000000-00	No Longer Available	1
85	000000-00	No Longer Available	1
86	000000-00	No Longer Available	1
87	905010105091	PIN	1
88	904020101703S	LOCK WASHER	3
89	901010600602	CAP SCREW	3
90	905010102735	ROLL PIN	1
91	1088247	Use 422-17-371-0002	1
92	000000-00	No Longer Available	1
93	904010101622	STEEL WASHER	1
94	901020100576	MACHINE SCREW	1
95	438010040015S	CABLE CLAMP 5/16	1
96	000000-00	No Longer Available	1
98	904020101703S	LOCK WASHER	1
100	000000-00	No Longer Available	1

## Parts List for 34-010 Type 1 Prior to S/N FD-6575

Item Number	Part Number	Description	Qty Required
101	000000-00	No Longer Available	1
102	000000-00	No Longer Available	1
103	902011205436	Use 902-01-120-1204	1
104	000000-00	No Longer Available	1
105	000000-00	No Longer Available	1
106	901030408015S	CAP SCREW	1
107	902011201203S	HEX NUT	2
108	901020100559	MACHINE SCREW	2
109	000000-00	No Longer Available	1
110	000000-00	No Longer Available	1
111	000000-00	No Longer Available	1
112	000000-00	No Longer Available	1
113	000000-00	No Longer Available	1
114	904030601665	LOCK WASHER	1
115	000000-00	No Longer Available	1
116	000000-00	No Longer Available	1
117	000000-00	No Longer Available	1
118	000000-00	No Longer Available	1
119	000000-00	No Longer Available	1
120	000000-00	No Longer Available	1