

ROUTER

6302
6702
6902
513T6/T7

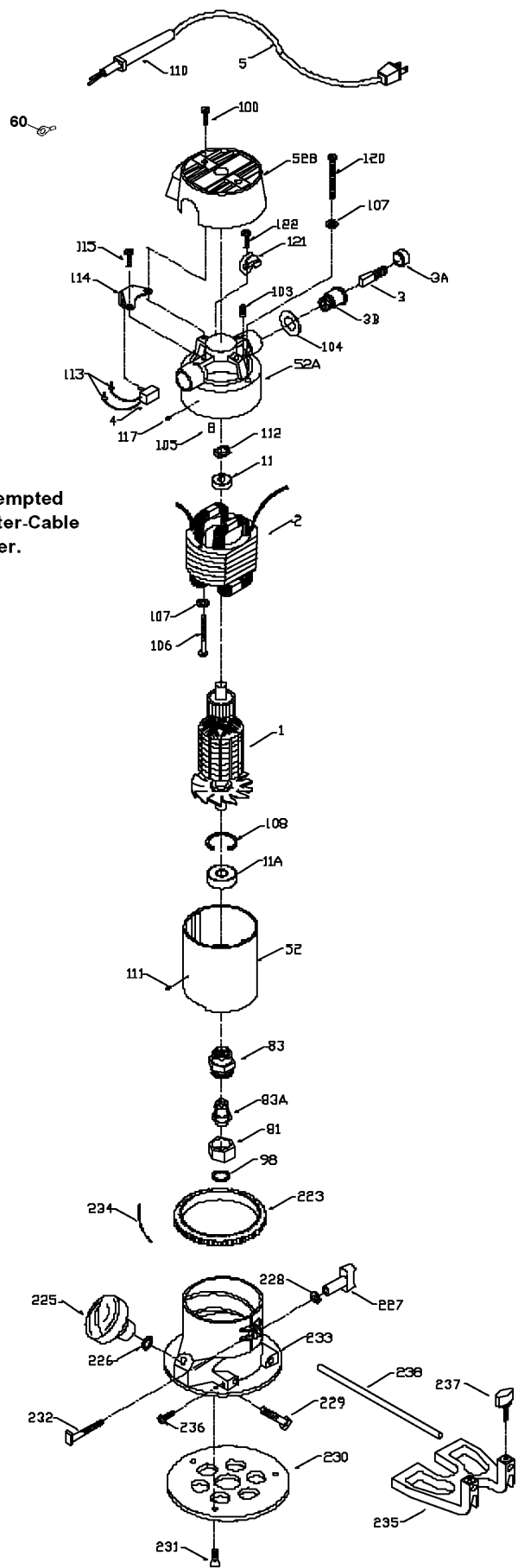

WARNING: Electrical repairs should only be attempted by trained repairmen. Contact the nearest Porter-Cable Service Center or other competent repair center.

Parts List for 6302 Type 2

Item Number	Part Number	Description	Qty Required
1	874588	ARMATURE-220	1
1	000000-00	No Longer Available	1
1	000000-00	No Longer Available	1
1	000000-00	No Longer Available	1
2	874589	FIELD-220	1
2	694210	FIELD	1
2	803104	LEAD	1
3	N031652	BRUSH	2
3	803483	BRUSH CAP	2
3	873497	BRUSH HOLDER	2
4	842606SV	SWITCH	1
4	876320	SWITCH.	1
5	879758	CORD-EURO	1
5	A11126	CORDSET	1
11	855284	BEARING	3
11	878064SV	BEARING	3
52	903967SV	CASING & PINS FRONT	1
52	899192SV	REAR HOUSING	1
52	888727	MOTOR HOUSING CAP	1
60	849314	TERM	1
81	875893	COLLET NUT	1
83	872793	CHUCK	1
83	42999	1/4 INCH COLLET ASSY	1
83	42975	3/8 INCH COLLET ASSY	1
83	42975	3/8 INCH COLLET ASSY	1
83	42950	1/2 INCH COLLET ASSY	1
83	876671	COLLET 1/2 INCH	1

Parts List for 6302 Type 2

Item Number	Part Number	Description	Qty Required
83	876669	COLLET 1/4 INCH	1
83	876670	COLLET 3/8 INCH	1
98	823030	SNAP-RING	10
100	878813	SCREW	10
103	804360	SCREW	10
104	803496	WASHER	10
105	842597	PLUG	1
106	881082	SCREW MACHINE STEEL	10
107	802430	LOCKWASHER	10
108	802426	RING	10
111	800835	PIN	10
112	842610	SPRING-PRELOAD	10
113	682063	CONNECTOR VS	1
114	842598	BRACKET SWITCH	1
114	876396	BRACKET	1
115	802764	SCREW	10
117	801374	SCREW	10
120	681260	SCREW & WASHER	10
121	874137	CORD CLAMP	1
122	877817	SCREW	10
239	849314	TERM	1
241	696696	SCREW	10
856	A22709	OPEN-END WRENCH	1
856	883356	BIT	1
856	A22709	OPEN-END WRENCH	1
856	683157	WRENCH OPEN END	1
856	683157	WRENCH OPEN END	1

Parts List for 6302 Type 2

Item Number	Part Number	Description	Qty Required
861	000000-00	No Longer Available	1
861	000000-00	No Longer Available	1
861	902829	CARRYING CASE	1
861	000000-00	No Longer Available	1