



# SERVICE PARTS LIST

**BUL. 54-40-4100**

## ELECTRONICALLY CONTROLLED SAWZALL

REVISED BUL. 6335-1 DATE Feb. '68

**Catalog No. 6505**

Starting Serial No. **335-1001**

WIRING INSTR.

Both Model and Serial No. must be furnished to obtain correct parts.

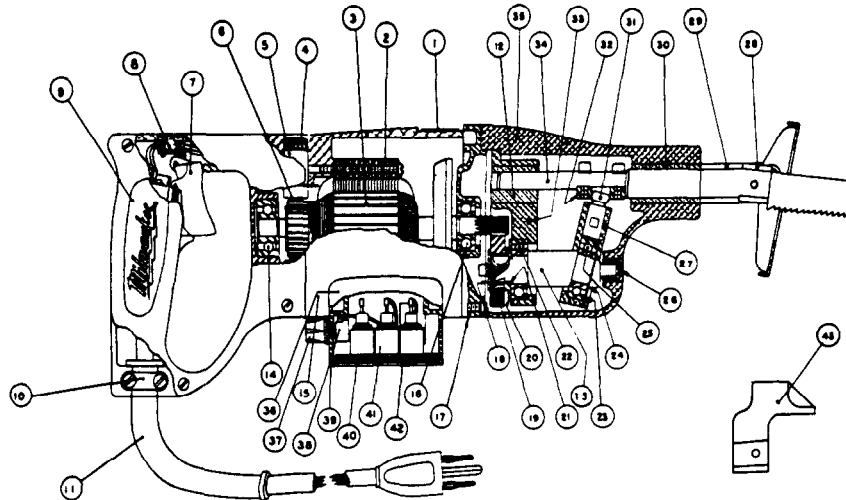

**CORRECTS AND SUPERSEDES SERVICE BULLETIN 6335-1 DATED 2/18/64 See Starred (\*) Items.**

### ILLUSTRATED PARTS

FIG.	PART NO.	DESCRIPTION OF PART	NO.REQ.	FIG.	PART NO.	DESCRIPTION OF PART	NO.REQ.
1	12-98-3000	Name Plate		24	34-60-1200	Retaining Ring	
2	18-42-1180	Field Assembly		25	02-04-1510	Ball Bearing	
3	16-42-1340	Armature Assembly		26	02-50-1640	Needle Bearing	
4	23-44-0060	Brush Retaining Screw	(2)	27	28-72-9001	Wobble Plate	
5	22-22-0080	Brush Holder Assembly	(2)	28	42-68-0071	Blade Clamp (Old Style)	
6	22-18-0100	Carbon Brush Assemblies	(2)		42-68-0073	Blade Clamp (New Style)	
7	23-66-0230	Switch		29	45-16-0055	Pivot Shoe Assembly	
8	45-36-0110	Switch Spacer		30	42-24-0091	Spindle Bearing	
9	28-20-3151	Handle Cover		31	45-58-0050	Ball End Stud	
10	28-17-0400	Cord Clamp Strap		32	42-28-0050	Reciprocating Spindle Block	
11	22-64-0170	Cord Set		33	28-72-1001	Bearing Plate	
12	42-24-0101	Spindle Bearing		34	38-50-2002	Reciprocating Spindle	
13	36-92-0601	Wobble Shaft		35	28-14-0571	Gear Case	
14	02-04-0970	Ball Bearing		36	42-04-0140	Control Housing Spacer	(2)
*15	28-50-4492	Motor Housing (Includes item 9 & Screws)		37	23-18-0060	Control Knob	
16	02-04-0940	Ball Bearing		38	23-38-7550	Variable Speed Control (Incl. in item 41)	
17	28-28-0341	Diaphragm		39	43-76-0130	Speed Control Housing	
18	45-88-0180	Gear Retaining Washer		40	12-98-6600	Speed Control Name Plate	
19	32-40-1101	Intermediate Gear		41	23-37-0050	Speed Control Regulator	
20	44-86-0090	Bearing Retainer		42	23-16-0280	Insulator	
21	45-36-0121	Gear Spacer		43	48-03-2000	Off-Set Blade Adaptor (Incl. 28-20-0051, 42-68-0073 & scrs.)	
22	02-04-1510	Ball Bearing		44	14-38-0270	Speed Control Housing Assy.(Incl. items 37, 38, 39, 41)	
23	34-80-2300	Retaining Ring					

### MISCELLANEOUS PARTS NOT SHOWN

PART NO.	DESCRIPTION OF PART	NO.REQ.	PART NO.	DESCRIPTION OF PART	NO.REQ.
23-86-0110	Brush Holder Insulating Washer (Fiber)	(2)	06-81-9525	10-24x1/2 Truss Hd. Shoe Bracket Scrs. (Sems)	(4)
23-16-0050	Switch Insulator		06-81-2500	6-32x3/8 Flat Hd. Bearing Ret. Screws	(2)
06-81-5800	6-32x5/16 Fil.Hd.Sems Switch Mtg. Scrs.	(2)	06-81-0900	8-32x7/16 Brg. Retainer Plate Screw	(2)
06-81-8400	4-40x1/4 Rd. Hd. Name Plate Screws (Sems)	(2)	06-81-6500	8-32x1-3/8 Fil. Hd. Gear Case Scrs. (Sems)	(2)
06-83-2645	1/4-20x3/8 Soc.Hd. Hd'less Set Scr. Self Locking	(2)	06-81-6650	8-32x1-3/4 Fil. Hd. Gear Case Scrs. (Sems)	(2)
06-83-2650	1/4-20x3/8 Brush Holder Set Screw	(2)	06-81-6600	8-32x1-3/4 Fil. Hd. Field Scrs (Sems)	(2)
06-81-8625	6-32x1/4 Rd. Hd. Ground Wire Scr.(Sem)(Brass)		06-81-6600	8,32x1-3/4 Fil.Hd. Field Scrs (Sems)	(2)
06-75-2400	10-32x1/2 Socket Head Screws	(4)	06-81-6150	8-32x1/2 Fil. Hd. Cord Clamp Strap Scrs. (Sems)	(3)
49-96-0070	Socket Screw Wrench		06-81-8600	6-32x3/16 Rd.Hd. Sems Spring Clip Screw	
45-30-0050	Shock Absorber Slug		23-86-0050	Rubberized Retaining Washer	
42-70-0050	Spring Clip		06-55-1800	Nut(1/4-32 Thread, Incl. with item 41)	
22-75-0070	Control Knob Dial		06-85-0050	No. 4x1/4 P.K. Pan Hd. Speed Control Name Plate Scr.(4)	(4)
23-86-0580	Fiber Washer (1/4 I.D. x 3/8 O.D. x 1/64)		06-85-0250	No. 6x3/8 P.K. Pan Hd. Regulator Mtg. Screws	(2)
06-81-5875	6-32x1-1/8 Fil.Hd. Control Housing Mtg. Sems (2)		*06-81-3750	8-32x1" Oval Hd. Handle Cover Scrs.	(2)
*06-97-3400	Lock Washer		*06-97-3200	Lock Washer	
*06-42-1200	#212 Woodruff Key				