



SERVICE PARTS LIST

BUL. 54-40-4205

TWO SPEED SAWZALL

REVISED BUL. 54-40-4204 DATE: July '72

Catalog No. 6510

Starting Serial No. **284-183656**

WIRING INSTR. **58-01-0231**

Both Model and Serial No. must be furnished to obtain correct parts.

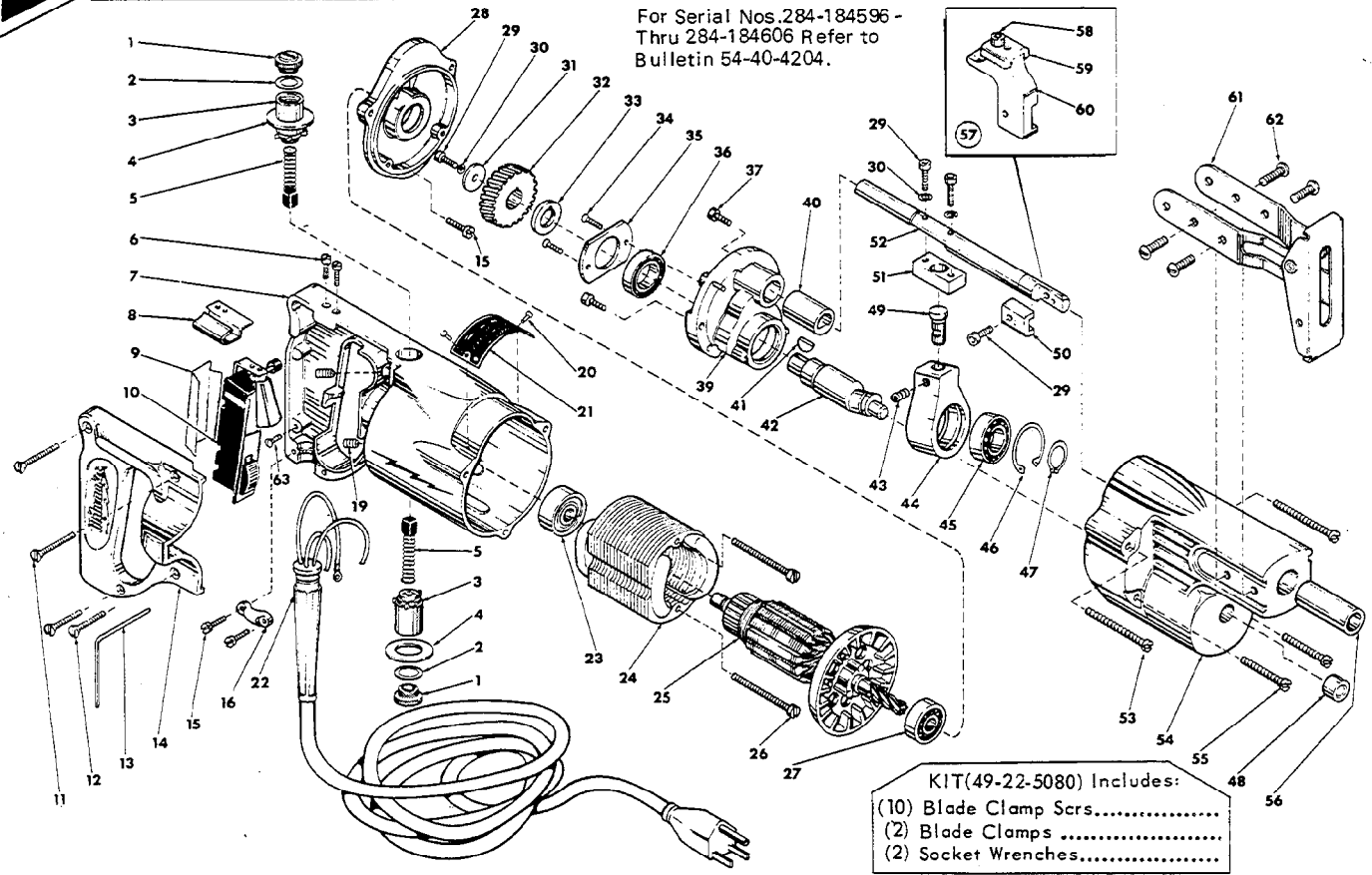

For Serial Nos. 284-184596 - Thru 284-184606 Refer to Bulletin 54-40-4204.

FIG.	PART NO.	DESCRIPTION OF PART	NO.REQ.
1	23-44-0060	Brush Retaining Screw	(2)
2	23-86-0050	Washer	(2)
3	22-22-0080	Brush Holder	(2)
4	23-86-0110	Washer	(2)
5	22-18-0100	Carbon Brush	(2)
6	06-81-5800	6-32x5/16 Fil.Hd. Sem	(2)
7	28-50-4485	Motor Housing (Includes Fig. Nos. 11, 12 and 14)	
8	42-68-0225	Wire Baffle	
★9	23-16-0660	Insulator	
★10	23-66-0482	Switch	
11	06-81-3750	8-32x1 Oval Hd. Screw	(2)
12	06-81-3700	8-32x7/8 Oval Hd. Screw	(2)
13	49-96-0070	Socket Screw Wrench	
★14	28-20-3601	Handle Cover	
15	06-81-6150	8-32x1/2 Fil.Hd. Sem	(3)
16	28-17-0400	Clamp Strap	
★17	48-66-4080	Socket Wrench Holder (Not Shown)	
19	06-83-2650	1/4-20x3/8 Knrl. Set Screw	(2)
★20	06-85-0200	6x1/4 Rd. Hd. T type Z Screw	(2)
★21	12-99-0031	Nameplate	
22	22-64-0380	Cord Set	
23	02-04-0970	Ball Bearing	
24	18-42-1120	115 Volt Field	
25	16-42-1170	115 Volt Armature	
26	06-81-6600	8-32x1-3/4 Fil.Hd. Sem	(2)
27	02-04-0940	Ball Bearing	
28	28-28-0341	Diaphragm	
29	06-75-2400	10-32x1/2 Skt. Hd. Screw	(4)
30	06-97-3400	Lock Washer	(3)
31	45-88-0180	Retaining Washer	
32	32-40-1101	Intermediate Gear	

FIG.	PART NO.	DESCRIPTION OF PART	NO.REQ.
33	45-36-0121	Gear Spacer	
34	06-81-2500	6-32x3/8 Flat Hd. Screw	(2)
35	44-86-0090	Bearing Retainer	
36	02-04-1510	Ball Bearing	
★37	06-81-6150	8-32x 1/2 Fil.Hd. Sem	(2)
39	28-72-1001	Bearing Plate	
40	42-24-0101	Spindle Bearing	
41	06-42-1200	Woodruff Key	
42	36-92-0601	Wobble Shaft	
43	06-83-2645	1/4-20x3/8 Hds. Set Screw	
44	28-72-9001	Wobble Plate	
45	02-04-1510	Ball Bearing	
★46	34-80-2355	Retaining Ring	
47	34-60-1200	Retaining Ring	
48	02-50-1640	Needle Bearing	
49	45-58-0050	Ball End Stud	
50	42-68-0073	Blade Clamp	
51	42-28-0050	Spindle Block	
52	38-50-2002	Spindle	
53	06-81-6650	8-32x1-3/4 Fil.Hd. Sem	(2)
54	28-14-0571	Gear Case	
55	06-81-6500	8-32x1-3/8 Fil.Hd. Sem	(2)
56	42-24-0091	Spindle Bearing	
57	48-03-2000	Offset Blade Adapter Assy. (Includes Fig. Nos. 58, 59 and 60)	
58	06-75-2400	10-32x1/2 Skt. Hd. Screw	
59	42-68-0073	Blade Clamp	
60	28-02-0051	Offset Blade Adapter	
61	45-16-0055	Pivot Shoe Assembly	
62	06-81-9525	10-24x1/2 Truss Head Sem	(4)
63	06-81-8625	6-32x1/4 Ground Screw	

KIT(49-22-5080) Includes:
 (10) Blade Clamp Scrs.....
 (2) Blade Clamps
 (2) Socket Wrenches.....