



# SERVICE PARTS LIST

**BULLETIN NO.**  
55-40-0324

SPECIFY CATALOG NO. AND SERIAL NO. WHEN ORDERING PARTS		REVISED BULLETIN 55-40-0323	DATE May'93
<b>VARIABLE SPEED DOUBLE INSULATED SAWZALL®</b>			
CATALOG NO.	6512-4	STARTING SERIAL NO.	600A
			WIRING INSTRUCTION 58-03-1325

**EXAMPLE:**  

00	0
----	---

 Component Parts (Small #) Are Included  
 When Ordering The Assembly (Large #).

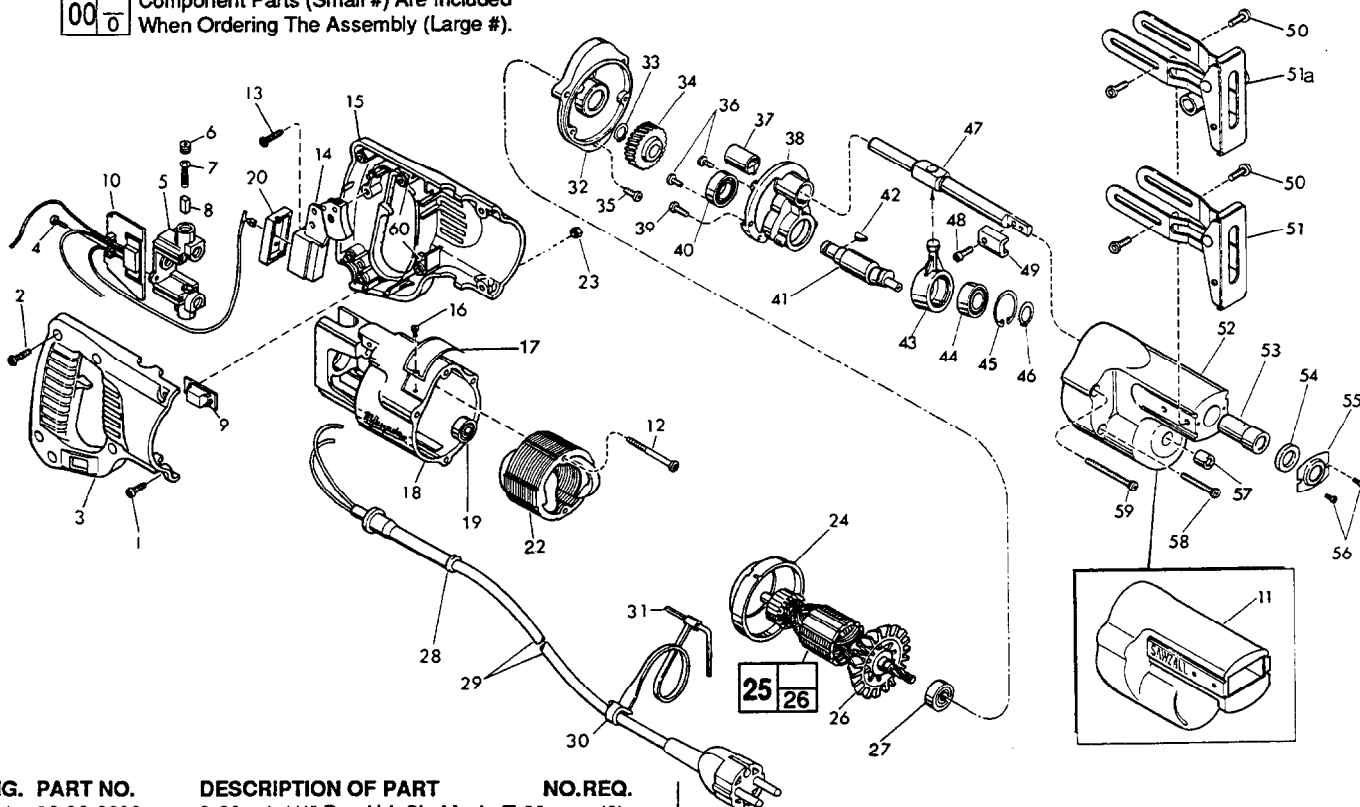

FIG.	PART NO.	DESCRIPTION OF PART	NO.REQ.
	1	06-82-2390 8-32 x 1-1/4" Pan Hd. Slit. Mach. T-20	(2)
	2	06-82-7270 8-16 x 5/8" Pan Hd. Slit. Plast. T-20	(5)
	3	31-44-1651 Right Handle Half	(1)
	4	06-82-7240 6-19 x 1/2" Pan Hd. Slit. Plast. T-15	(2)
★	5	22-22-1380 Brush Holder Assembly	(1)
	6	23-44-0190 Brush Retaining Cap	(2)
	7	23-52-0160 Brush Spring	(2)
	8	22-16-0375 Carbon Brush	(2)
	9	31-53-0120 Plug	(1)
	10	14-20-0425 Remote Switch Assembly	(1)
	11	45-12-0305 Gear Case Insulator	(1)
	12	06-82-7395 8-16 x 1-3/4" Pan Hd. Plast. T-20	(2)
	13	06-82-7270 8-16 x 5/8" Pan Hd. Slit. Plast. T-20	(1)
	14	23-66-1975 Switch	(1)
	15	14-34-0423 Handle Assembly	(1)
★	16	06-72-1720 Nameplate Rivet	(2)
	17	12-99-0940 Nameplate Blank	(1)
★	18	31-50-0030 Motor Housing	(1)
	19	02-04-0845 Ball Bearing	(1)
	20	45-12-0470 Dust Shield	(1)
	22	18-34-0220 220 V. Field	(1)
	23	06-55-0835 8-32 Hex Nut	(2)
	24	31-05-0050 Baffle	(1)
	25	16-34-0425 220 V. Armature	(1)
	26	22-84-0531 Fan Assembly	(1)
	27	02-04-0911 Ball Bearing	(1)
	28	44-76-0210 Cord Protector	(1)
	29	22-64-4525 Cord Set	(1)
	30	48-66-4080 Key Holder	(1)
	31	49-96-0070 5/32" Socket Wrench	(1)
	32	28-28-0350 Diaphragm	(1)
	33	34-60-0920 External Retaining Ring	(1)
	34	32-40-1920 Intermediate Gear	(1)
	35	06-82-6070 8-16 x 5/8" Fil. Hd. Plast. T-20	(1)
	36	06-95-0075 6-32 x 3/8" Truss Hd. Tapite Screw	(2)
	37	42-24-0250 Rear Spindle Bearing	(1)
	38	28-72-1002 Bearing Plate	(1)
★	39	06-82-3056 8-32 x 1/2" Fil. Hd. Tapite T-20	(2)
	40	02-04-1510 Ball Bearing	(1)

FIG.	PART NO.	DESCRIPTION OF PART	NO.REQ.
	41	36-92-0720 Wobble Shaft Assembly	(1)
	42	06-42-1200 Woodruff Key	(1)
	43	30-72-0060 Wobble Plate	(1)
	44	02-04-1510 Ball Bearing	(1)
	45	34-80-2355 Internal Retaining Ring	(1)
	46	34-60-1200 Retaining Ring	(1)
	47	38-50-5410 Reciprocating Spindle	(1)
★	48	06-75-2402 10-32 x 9/16" Pan Hd. Tapite Sems	(1)
	49	42-68-0073 Blade Clamp	(1)
	50	06-95-6270 10-24 x 1/2" Pan Hd. Tapite Sems	(4)
	51	45-16-0495 Pivot Shoe Assembly	(1)
51a	45-16-0590 Pivot Shoe Assembly-European	(1)	
	52	28-14-1780 Gear Case	(1)
	53	42-24-0320 Spindle Bearing	(1)
	54	45-06-0300 Felt Seal	(1)
	55	44-86-0370 Seal Retainer	(1)
	56	06-95-0050 4-40 x 3/16" Pan Hd. Tapite Screw	(2)
	57	02-50-1640 Needle Bearing	(1)
★	58	06-82-3154 8-32 x 1-3/8" Fil. Hd. Tapite T-20	(2)
	59	06-82-6217 8-16 x 1-15/16" Fil. Hd. Plast. T-20	(2)
	60	14-46-1001 Foam Slug Kit - 10 Slugs	(2)
		22-33-0290 Capacitor	(1)

**FIG. NOTES**  
 39 Apply type 242 blue loctite  
 33,45,46 Burr side out  
 37 V-notch press in from diaphragm side  
 53 Press .02/.03 below surface (.51/.76mm)

**FIG. LUBRICATION**  
 34,38 1/2 oz. type "A" grease, No. 49-08-0800.  
 52 2-1/2 oz. type "B" grease, No. 49-08-0600.

**MILWAUKEE ELECTRIC TOOL CORPORATION**  
 13135 W. LISBON RD., BROOKFIELD, WI 53005