

PORTER-CABLE

C2150-1

Oil Free Portable Air Compressor

WARNING: Electrical repairs should only be attempted by trained repairmen. Contact the nearest Porter-Cable Service Center or other competent repair center.

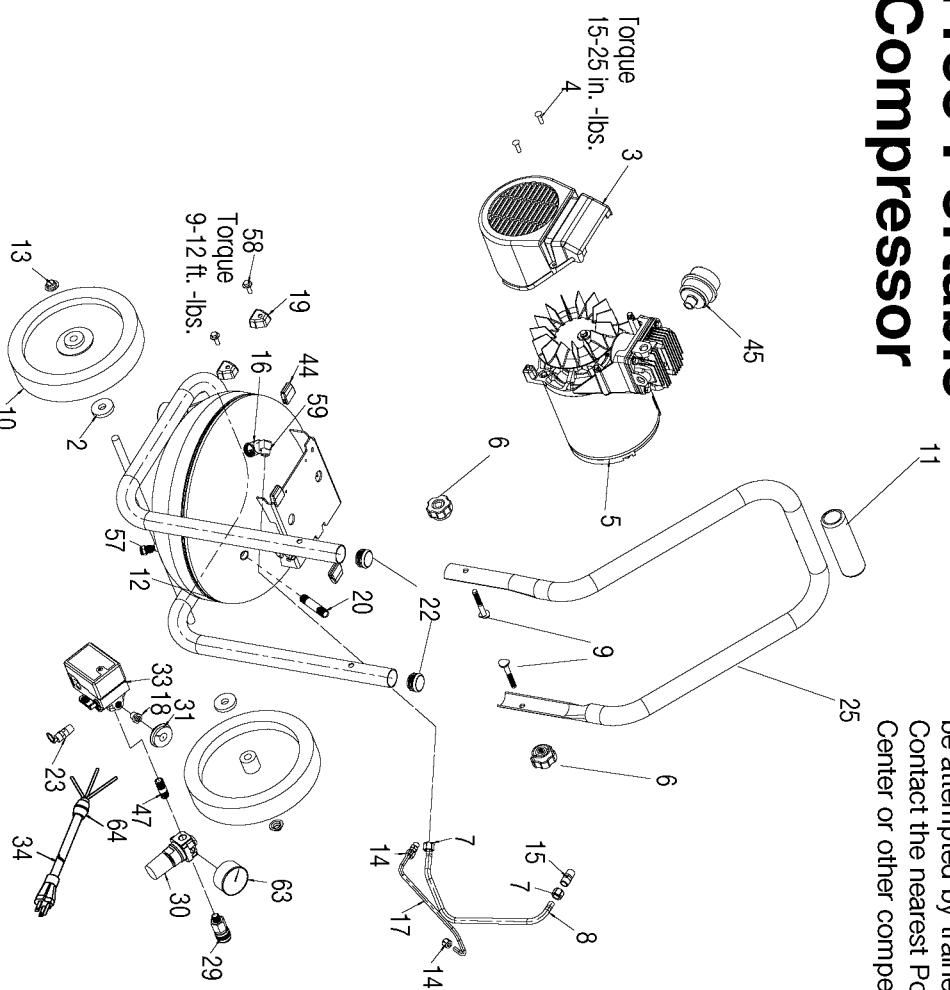

Parts List for C2150 Type 1

| Item Number | Part Number | Description | Qty Required |
|-------------|-------------|----------------------|--------------|
| 2 | 000000-00 | No Longer Available | 2 |
| 3 | D20653 | SHROUD MINI P-C GRAY | 1 |
| 4 | ACG-408 | ASSY FASTENER | 2 |
| 5 | 000000-00 | No Longer Available | 1 |
| 6 | 16471 | KNOB .313-18 NUT | 2 |
| 7 | SSP-7813 | ASSY NUT SLEEVE 3/8 | 2 |
| 8 | AC-0620 | TUBE OUTLET PANCAKE | 1 |
| 9 | 000000-00 | No Longer Available | 2 |
| 10 | D23138 | WHEEL 9 BLACK SEMI-P | 2 |
| 11 | 000000-00 | No Longer Available | 1 |
| 12 | 000000-00 | No Longer Available | 1 |
| 13 | W137 | NUT .50 PAL | 2 |
| 14 | SSP-7811 | ASSY NUT SLEEVE 1/4 | 2 |
| 15 | SSP-6050 | CONNECTOR MALE 1/4NP | 1 |
| 16 | D24880 | VALVE CHECK 1/2NPT X | 1 |
| 17 | D28391 | TUBE | 1 |
| 18 | SSP-6021 | BUSHING REDUCER 1/8- | 1 |
| 19 | ACG-18 | CUP SADDLE MOUNT | 1 |
| 20 | D30323 | NIPPLE | 1 |
| 22 | D21197 | PLUG TUBE 1.25 OD 18 | 2 |
| 23 | D20114 | VALVE SAFETY 175 .25 | 1 |
| 25 | D28130 | HANDLE 1.25OD PC RED | 1 |
| 29 | A19513 | BODY QC .250 IND .25 | 1 |
| 30 | N008792 | REGULATOR RPR KIT | 1 |
| 30 | D27253 | REGULATOR 4PORT P2 L | 1 |
| 31 | Z-D23004 | GAUGE 1.5OD 200PSI . | 1 |
| 33 | Z-D26612 | SWITCH PRES 4PORT 12 | 1 |

Parts List for C2150 Type 1

| Item Number | Part Number | Description | Qty Required |
|-------------|-------------|----------------------|--------------|
| 34 | D26615 | CORD POWER ST 14GA 1 | 1 |
| 44 | AC-0716 | ISOLATOR 3PT MOUNT 9 | 3 |
| 45 | N022053 | FILTER REPLACEMENT | 1 |
| 45 | N022307 | FILTER ASSY. | 1 |
| 45 | D24322 | FILTER REPLACEMENT | 1 |
| 47 | N053094 | NIPPLE | 1 |
| 57 | A17038 | DRAIN VALVE | 1 |
| 58 | 91895680 | SCREW .250-20X.750 H | 2 |
| 59 | SSP-6429 | ELBOW 1/4 NPT X 3/8 | 1 |
| 63 | Z-D27212 | GAUGE 200PSI .125NPT | 1 |
| 64 | 000000-00 | No Longer Available | 1 |
| 101 | Z-D27791 | MOTOR | 1 |
| 102 | Z-AC-0140 | ASSY ECCENTRIC BEARI | 1 |
| 104 | AC-0108 | FAN 5.75 DIA | 1 |
| 105 | SSF-586 | SCREW .250-20X.750 U | 1 |
| 106 | K-0650 | KIT COMP RING REPLAC | 1 |
| 107 | KK-4835 | KIT CONNECTING ROD L | 1 |
| 108 | SSG-8156 | ORING 2.759/2.719ID | 1 |
| 109 | Z-AC-0032 | ASSY VALVE PLATE | 1 |
| 110 | ACG-45 | ORING P/L HEAD | 1 |
| 111 | AC-0236 | HEAD MACH 3/8 NPT 1/ | 1 |
| 112 | SSF-3158-1 | SCREW #10-24X.750 TH | 1 |
| 113 | SSF-927 | SCREW .250-20X1.125 | 1 |
| 118 | KK-4835 | KIT CONNECTING ROD L | 1 |
| 119 | SSF-3158-1 | SCREW #10-24X.750 TH | 1 |
| 120 | KK-4835 | KIT CONNECTING ROD L | 1 |
| 856 | N008806 | LABEL HOT SURFACE TR | 1 |

Parts List for C2150 Type 1

| Item Number | Part Number | Description | Qty Required |
|-------------|-------------|----------------------|--------------|
| 856 | N008799 | LABEL | 1 |
| 856 | 000000-00 | No Longer Available | 1 |
| 856 | SSF-630 | SCREW .250-20X1.50 H | 1 |
| 856 | LA-3164 | LABEL | 1 |
| 856 | D28138 | WARNING LABEL | 1 |
| 856 | D28318 | BUMPER RUBBER FOOT 1 | 1 |