

## Universal Rotary Hammer - 0 611 226 739 - GBH 2 SR

[www.powertools-aftersaleservice.com](http://www.powertools-aftersaleservice.com)



**BOSCH**

Item	Part Number	Description	Illustration	Price	Quantity	Price Group
2	1 614 220 105	Field 100-120V		1	-,-	1 31
3/60	1 616 610 072	Fan BLACK		1	-,-	1 12
4	1 617 200 079	On-Off Switch		1	-,-	1 34
5	2 604 460 187	Power supply cord USA/CDN 2,68m 2 x 082mm SJ 18/2		1	-,-	1 26
6	2 600 703 017	Grommet Ø6,4-Ø7,2x76 MM		1	-,-	1 13
6	2 600 703 018	Grommet Ø7,3-Ø8,6x76 MM		1	-,-	1 13
6	2 600 703 019	Grommet Ø8,7-Ø9,6x76 MM		1	-,-	1 13
7	2 601 035 001	Cable Clip		1	-,-	1 11
9	1 611 110 X28	Manufacturer's nameplate		1	-,-	1 15
10	2 610 908 994	Warning Plate		1	-,-	1 13
13	1 610 905 025	Deep-Groove Ball Bearing 7x19x6		1	-,-	1 19
14	1 610 905 048	Deep-Groove Ball Bearing 9x24x7		1	-,-	1 21
16	2 604 337 016	Brush Holder		1	-,-	2 11
18	1 610 522 009	Air-Deflector Ring		1	-,-	1 11
22	1 616 317 602	Cylindrical Gear Z=50		1	-,-	1 24
24	1 617 000 518	Toothed Shaft Z=3/9		1	-,-	1 36
26	1 618 700 062	Hammer Piston		1	-,-	1 26
27	1 618 710 057	Striker		1	-,-	1 27
28	1 613 124 040	Striker Pin		1	-,-	1 17
29	1 613 105 012	Piston Pin		1	-,-	1 15
31	1 615 510 003	Protective Grille		1	-,-	1 13
34	1 610 508 008	Protective Cap L=17 MM, SDS-PLUS		1	-,-	1 12
35	1 610 206 021	Rubber Ring		1	-,-	1 11
37	1 610 390 017	Damping Bushing		1	-,-	1 17
38	1 610 102 026	Supporting Disc		1	-,-	1 13
41	1 610 101 011	Shim washer 1,2 MM THICK		1	-,-	2 11
42	1 610 202 015	Plain bearing		1	-,-	1 14
43	1 611 098 005	Tab Washer		1	-,-	1 14
44	1 615 820 092	Switching Element		1	-,-	1 13

Item	Part Number	Description	Illustration	Price	Quantity	Price Group
	45 1 614 651 014	Switch Spring		1	-,-	1 11
	46 1 614 690 002	Driver Pin		1	-,-	1 11
	48 1 611 016 003	Holding Plate		1	-,-	1 12
	49 1 612 026 035	Switch Button RED		1	-,-	1 11
	60 1 610 910 073	Needle-Roller Bearing		1	-,-	1 23
	61 1 610 910 098	Needle bearing		1	-,-	1 15
	62 1 610 910 074	Needle bearing		1	-,-	1 15
	63 1 610 910 064	Needle bearing		1	-,-	1 14
	64 1 610 913 010	Needle-Roller Assembly		1	-,-	1 16
	65 1 610 591 016	Plain bearing		1	-,-	1 13
	67 1 610 905 016	Deep-Groove Ball Bearing		1	-,-	1 22
	70 1 610 283 019	Shaft Seal		1	-,-	1 20
	71 1 610 290 029	Scraper		1	-,-	1 13
	72 1 610 210 068	O-Ring 24,0x2,5 MM		1	-,-	1 11
	73 1 610 210 187	O-Ring		1	-,-	1 12
	74 1 610 210 104	O-Ring 11,0x3,5 MM		1	-,-	1 13
	75 1 610 210 105	O-Ring 18,0x3,5 MM		1	-,-	1 13
	76 1 610 210 046	O-Ring 10,5x2,7 MM		1	-,-	1 11
	77 1 610 210 106	O-Ring 60,0x3,0 MM		1	-,-	1 13
	80 1 614 634 005	Compression Spring		1	-,-	1 11
	81 1 614 611 009	Compression Spring		1	-,-	1 11
	83 1 614 611 006	Compression Spring		1	-,-	1 15
	85 1 614 601 011	Retaining ring		1	-,-	2 11
	86 1 614 601 024	Retaining ring		1	-,-	1 11
	87 2 916 540 012	Retaining ring DIN 7993-A22		1	-,-	1 13
	88 1 613 200 007	Roller		1	-,-	3 11
	89 1 903 230 013	Ball DIN 5401-Ø7MM-III-ST		1	-,-	1 10
	90 1 603 435 036	Tapping Screw 4,8x78 MM, TORX T-20		1	-,-	4 11
	91 2 603 490 026	Lens Head Screw 4x32		1	-,-	1 10
	92 2 912 401 020	Tapping Screw DIN 7981-3,9x19-C-Z-ST		1	-,-	4 10
	93 2 910 211 005	Tapping Screw DIN 7971-ST2,9x9,5-F		1	-,-	4 10
	94 2 603 435 015	Recessed-Head Screw DIN 7981-ST3,5x9,5-F		1	-,-	2 11
	95 2 603 410 001	Socket head cap screw M3x6,5-4.8		1	-,-	2 11
	96 2 912 401 018	Tapping Screw DIN7981-ST3,9x13-C-Z		1	-,-	1 10
	100 2 604 448 104	Connecting Cable L=63 MM WHITE		1	-,-	1 11
	101 1 614 448 034	Connecting Cable L=45 MM BLUE		1	-,-	1 11
	102 2 604 448 005	Cable L=130 MM WHITE		1	-,-	2 11
	103 1 614 448 017	Connecting Cable L=55 MM WHITE		1	-,-	1 12
	104 1 614 431 023	Connecting Cable L=90 MM WHITE		1	-,-	1 12
	700 1 617 000 154	Drill Chuck Shank 1/2"SDS-PLUS		2	-,-	1 31
	700/20 2 603 421 226	Countersunk-Head Screw M6x27 LEFTHAND THREADS		2	-,-	1 11
	701 1 608 571 088	Chuck		2	-,-	1 32
	701/700 2 607 950 007	Chuck Wrench SG2		2	-,-	1 18
	711 1 617 000 133	Parts Set		2	-,-	1 -
	711/10/2 2 604 601 004	Retaining ring		2	-,-	1 11
	750 2 605 438 294	Carrying Case		2	-,-	1 -
	755 1 618 580 000	Angle Drill Head SDS-PLUS		2	-,-	1 -
	801 1 617 000 477	Motor Housing		1	-,-	1 28
	803 1 614 010 112	Armature With Fan 100-120V		1	-,-	1 43

Item	Part Number	Description	Illustration	Price	Quantity	Price Group
811	1 617 014 114	Carbon Brush	1	-,-	1	22
819	1 617 000 385	Gear Housing	1	-,-	1	35
820	1 617 000 981	Intermediate Flange	1	-,-	1	32
821	1 616 490 061	Ratchet Sleeve SDS-PLUS	1	-,-	1	40
821/01	1 616 490 060	Ratchet Sleeve SDS-PLUS	1	-,-	1	43
822	2 602 025 118	Auxiliary Handle Ø43 MM	2	-,-	1	26
822/120	1 612 025 019	Auxiliary Handle M8	2	-,-	1	19
822/124	1 611 316 006	Clamping Band Ø43 MM	2	-,-	1	13
822/125	1 613 490 002	T-Head Bolt M8x40 MM	2	-,-	1	13
822/802	2 608 040 176	index turning toolholder Ø43 MM	2	-,-	1	19
823	1 616 328 042	Gear Sleeve Z=26/6	1	-,-	1	36
826	1 617 000 517	Toothed Shaft Z=3/9	1	-,-	1	43
830	1 615 819 018	Drive bearing	1	-,-	1	41
832	1 612 026 037	Clamp Handle BLACK	1	-,-	1	24
833	1 617 000 163	Protection Sleeve SDS-PLUS	1	-,-	1	20
847	1 617 000 348	Guide Ring	1	-,-	1	26
850	2 607 200 231	Change-Over Switch	1	-,-	1	25
879	1 613 001 009	Depth-Gauge SW 6x210 MM	2	-,-	1	15
888	1 601 106 035	Nameplate 26x42 MM	1	-,-	1	13

Illustration - Type E

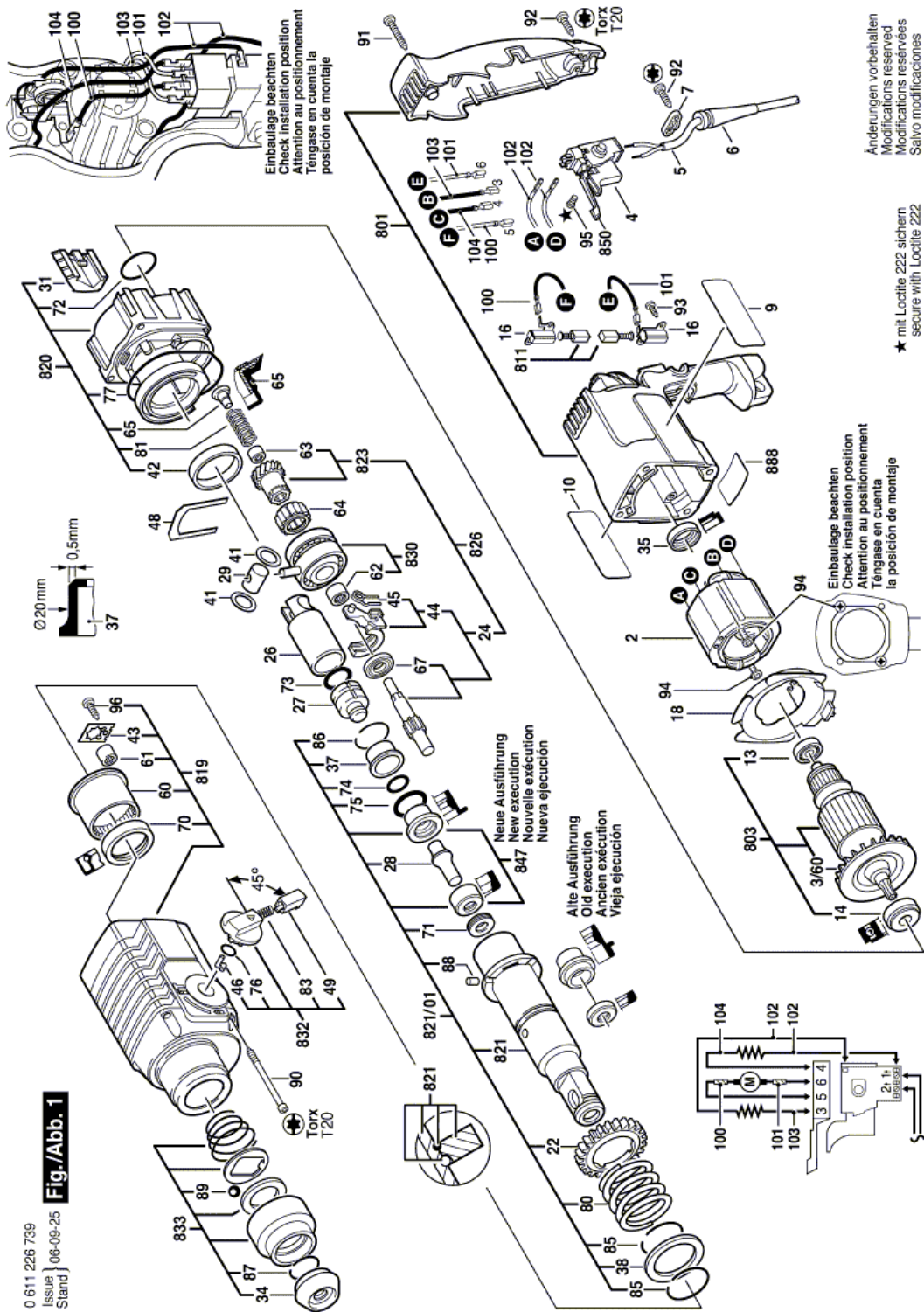

0 611 226 739  
Issue  
Stand } 06-09-25  
**Fig./Abb. 1**

Illustration - Type E

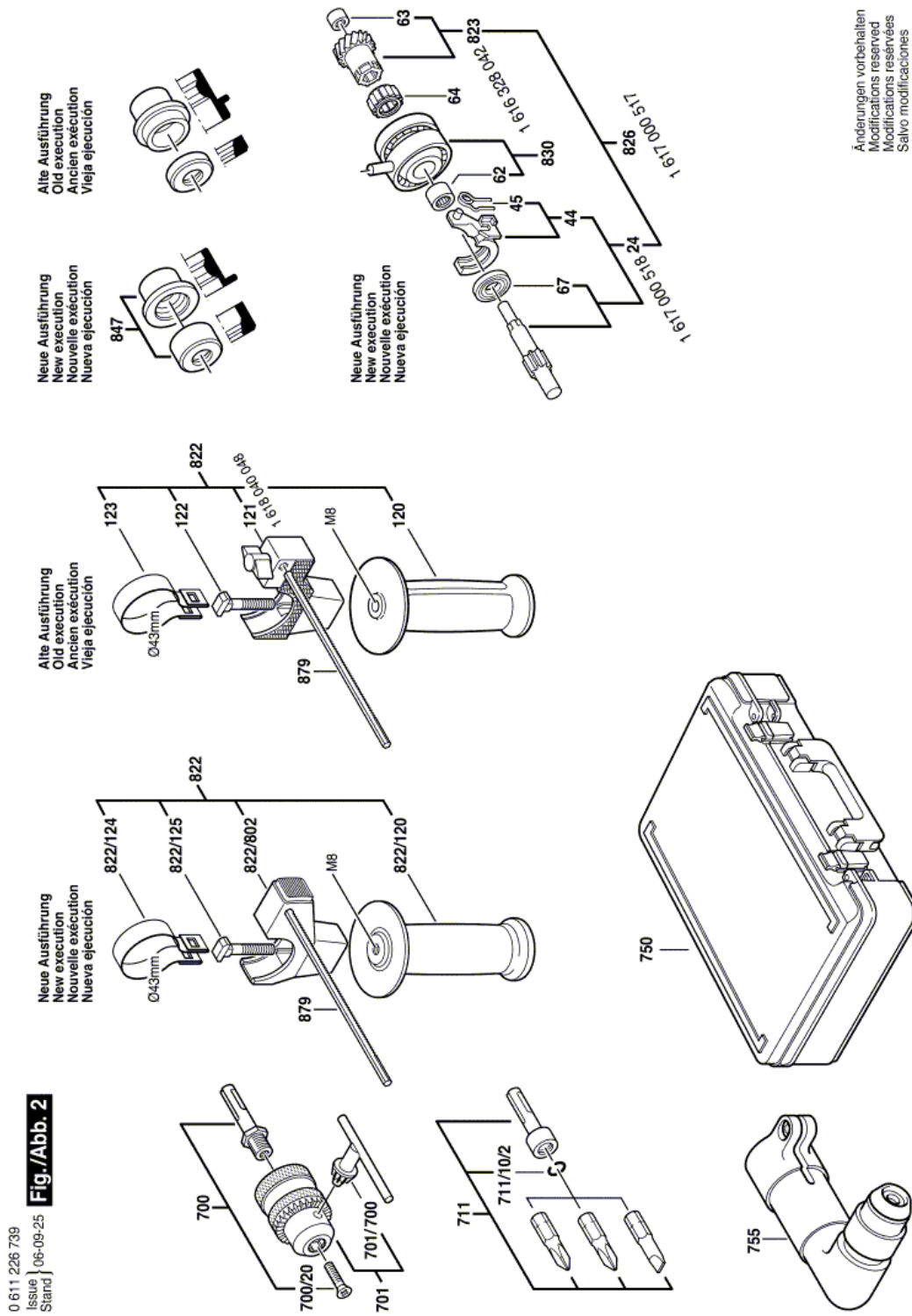

Information subject to change without further notice.