

Cordless Drill - 0 601 920 534 - GBM 12 VE

www.powertools-aftersaleservice.com



BOSCH

Item	Part Number	Description	Illustration	Price	Quantity	Price Group
4	2 607 200 302	On-Off Switch	1	-,-	1	37
9	2 601 118 083	Sticker SUNNY SIDE	1	-,-	1	12
20	2 601 110 606	Sticker SHADOW SIDE	1	-,-	1	11
25	2 606 135 018	Drilling Spindle 3/8"	1	-,-	1	23
26	1 900 905 120	Deep-Groove Ball Bearing 10x26x8	1	-,-	1	22
27	2 916 650 001	Spring retaining ring DIN 471-10x1MM-FSt	1	-,-	1	10
29	2 600 301 011	Sintered-Metal Bushing	1	-,-	1	11
31	2 601 251 003	Holding Spring Ø8,7 MM	1	-,-	1	14
32	2 601 324 012	Contact Spring	1	-,-	2	12
33	2 601 099 026	Locking Lever 36,5 MM	1	-,-	1	11
35	2 600 302 002	Sintered-Metal Bushing	1	-,-	2	11
36	2 603 490 022	Torx Oval-Head Screw 4x16	1	-,-	7	10
37	2 910 641 050	Oval-Head Screw DIN 7985-M3x8-4.8	1	-,-	1	10
39	2 605 715 000	Heat Sink	1	-,-	1	16
42	1 609 200 147	Screwdriver Blade 6 MM	1	-,-	1	14
43	2 601 250 002	Holding Spring	1	-,-	1	11
44	2 601 250 003	Clamp Spring	1	-,-	1	11
46	2 601 099 027	Adjusting Slide BLACK	1	-,-	1	11
48	2 600 100 607	Shim 0,3 MM	1	-,-	1	11
48	2 600 100 636	Shim 0,3 MM THICK	1	-,-	2	11
49	2 604 413 005	Cable L=52 MM WHITE	1	-,-	3	11
50	2 604 413 004	Cable L=79 MM WHITE	1	-,-	2	11
52	2 601 010 038	Dust Protection	1	-,-	1	11
53	2 606 316 112	Pinion Z=11	1	-,-	1	16
738	1 608 571 066	Key Chuck Ø1-10 MM, 3/8"	1	-,-	1	-
738/800	1 607 950 042	Chuck Wrench SG 1, Ø4x60 MM	1	-,-	1	-
760	2 607 224 431	Fast Charger USA 120/7,2-24V, 1h	1	-,-	1	48
76	2 607 225 033	Fast Charger USA 120/7,2-24V, 30 MIN.	N/A	-,-	1	46
801	2 605 104 873	Housing Section BLUE	1	-,-	1	29
802	2 607 022 910	DC motor 12V	1	-,-	1	33
828	1 609 340 005	Toothed Shaft Z=10/19/81	1	-,-	1	29
830	2 607 335 021	Slide-In Accu Package 12V, 1,4Ah, NiCd	1	-,-	1	-
855	1 609 340 007	Set Of Gears Z=58/67	1	-,-	1	30

Item	Part Number	Description	Illustration	Price	Quantity	Price Group
899	0 601 920 520	Cordless Screwdriver	1	-,-	1	-

Illustration - Type E

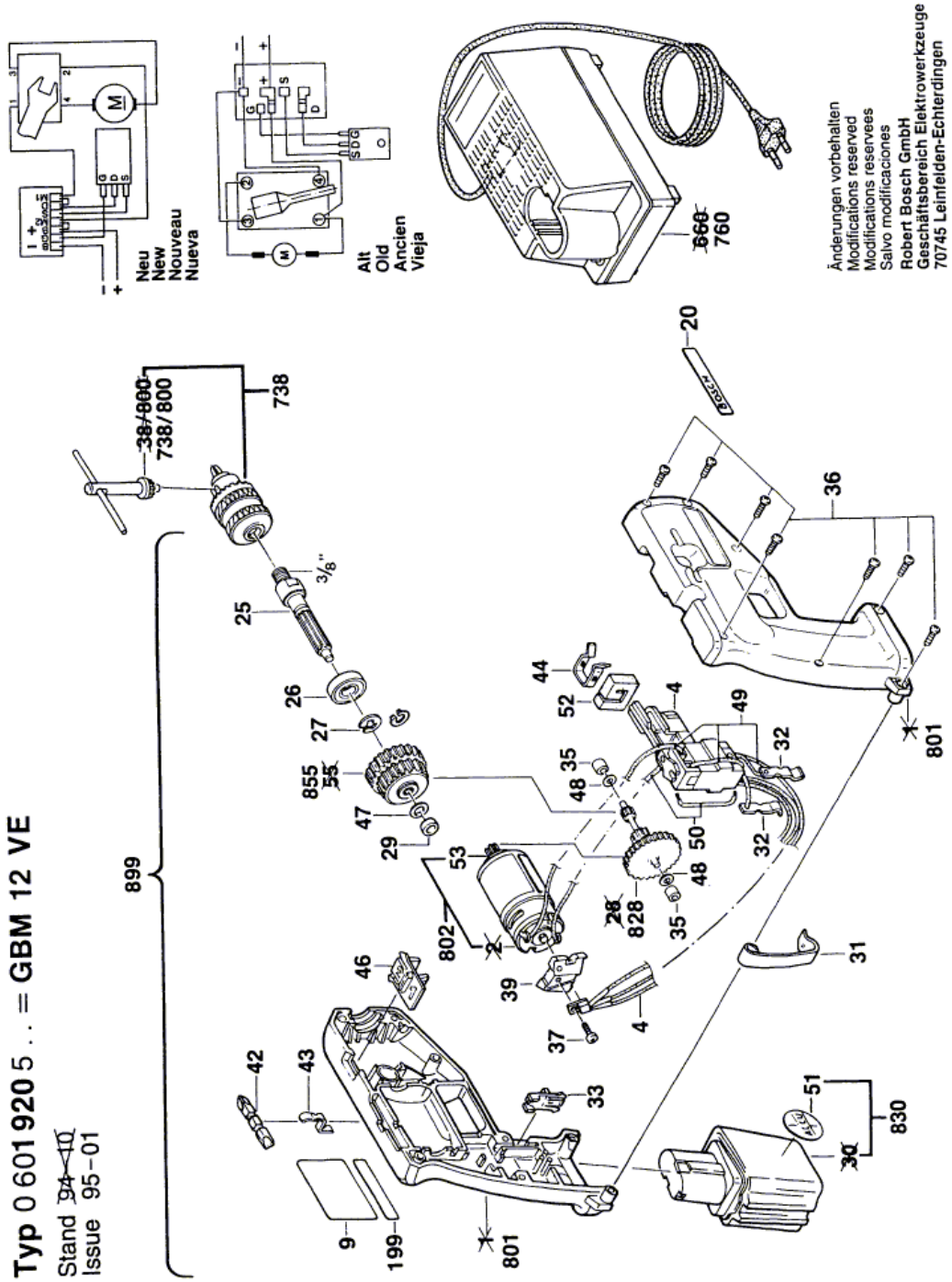

Information subject to change without further notice.