

Service Manual

Battery charger

Model No. **LBC-10B**

Sub Model No.
EY0L10

GREENLEE brand
North America

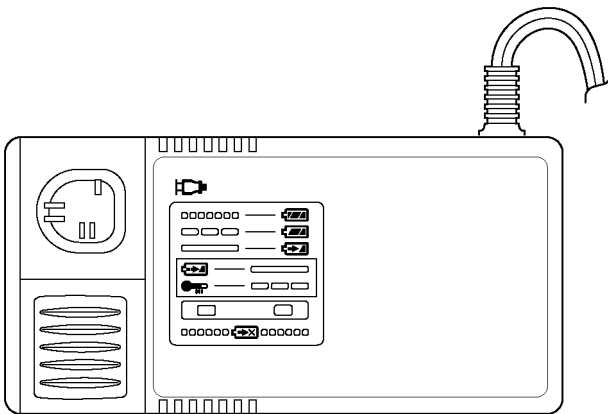

Please file and use this manual together with the service manual for Model No. EY0L10, Order No. PTD0610U46CE.

⚠ WARNING

This service information is designed for experienced repair technicians only and is not designed for use by the general public. It does not contain warnings or cautions to advise non-technical individuals of potential dangers in attempting to service a product. Products powered by electricity should be serviced or repaired only by experienced professional technicians. Any attempt to service or repair the product or products dealt with in this service information by anyone else could result in serious injury or death.

IMPORTANT SAFETY NOTICE

There are special components used in this equipment which are important for safety. These parts are marked by **⚠** in the Schematic Diagrams, Circuit Board Diagrams, Exploded Views and Replacement Parts List. It is essential that these critical parts should be replaced with manufacturer's specified parts to prevent shock, fire or other hazards. Do not modify the original design without permission of manufacturer.

TABLE OF CONTENTS

	PAGE	PAGE
1 Exploded View and Replacement Parts List -----	2	

1 Exploded View and Replacement Parts List

Model No. : LBC-10B Exploded View

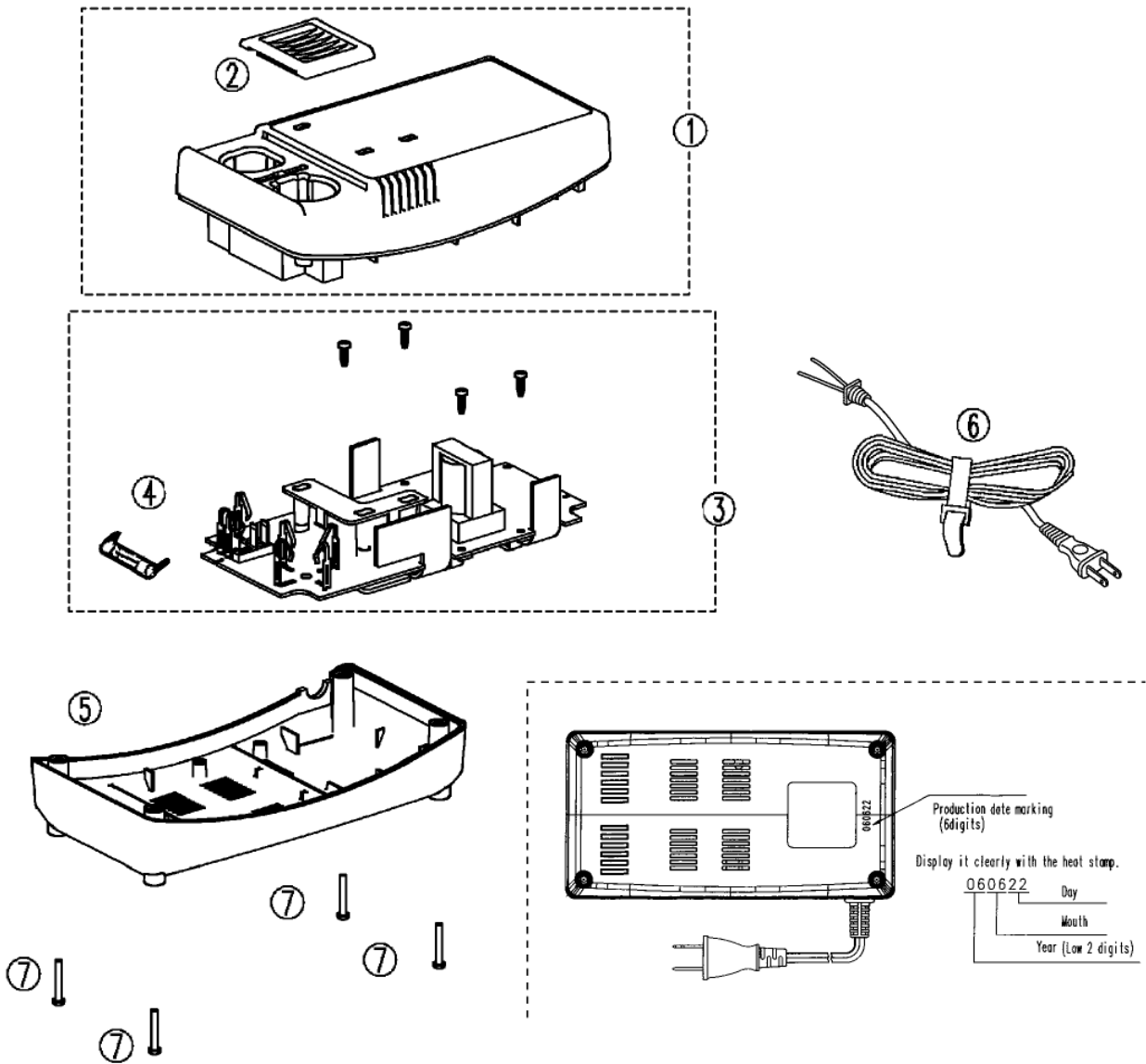

Model No. : LBC-10B Parts List

Safety	Ref. No.	Part No.	Part Name & Description	Q'ty	Remarks
	1	WEZOL10G0010	HOUSING A	1	
	2	WEYOL10K3107	SLIDE COVER	1	
	3	WEYOL10L2108	MODULE	1	
	4	WEYOL10L2618	FUSE	1	(250V 3.15A)
	5	WEZOL10G0020	HOUSING B	1	
	6	WEYOL10K2058	POWER CORD	1	(A-2 PLUG)
	7	WEYOL10K6238	TORX TAPPING SCREW	4	(K3-20)