

N86C

COIL-FED PNEUMATIC NAILERS CLAVADORAS PNEUMÁTICAS ALIMENTADAS POR ROLLO CLOUEURS PNEUMATIQUES A ENROULEMENT

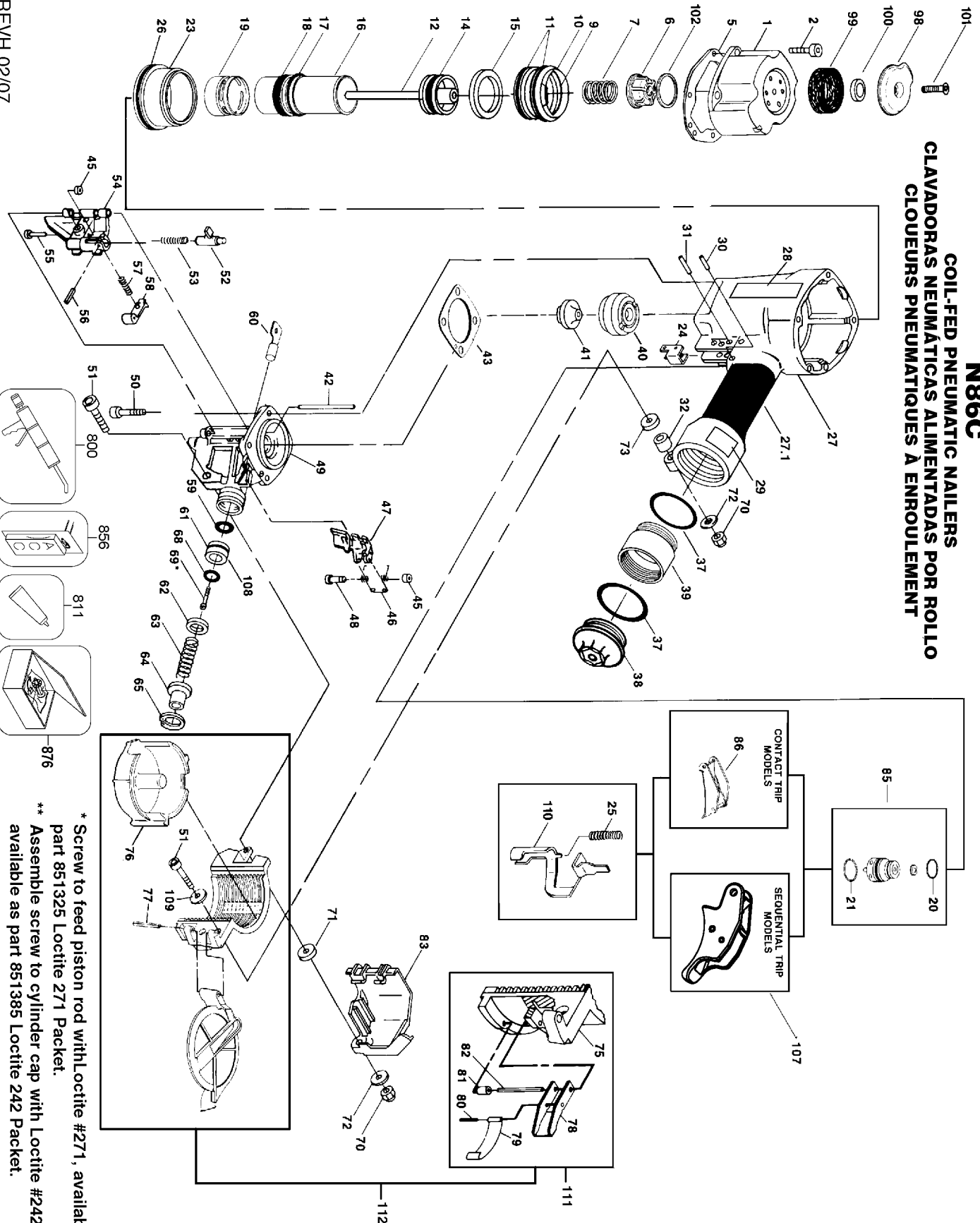

IP1066-1REVH 02/07

TO BE USED WITH PARTS LIST IP1066-2 AND OPERATION AND MAINTENANCE MANUAL 102776

* Screw to feed piston rod with Loctite #271, available as part 851325 Loctite 271 Packet.
 ** Assemble screw to cylinder cap with Loctite #242, available as part 851385 Loctite 242 Packet.

Parts List for N86C Type 0

Item Number	Part Number	Description	Qty Required
1	000000-00	No Longer Available	1
2	MSC6100-25	SCREW-SHCS-M6X1.00X2	4
4	000000-00	No Longer Available	1
5	N70118	SEAL-CYLINDER CAP	1
6	N86132	PISTON STOP	1
7	854017-S	SPRING-COMPRESSION	1
9	MRG051531	O-RING-2.028X.122	1
10	105578	HEAD VALVE (SERVICE	1
11	851538	O-RING-2.675X.116	2
12	000000-00	No Longer Available	1
14	851606-S	O-RING-1.850X.210	1
15	N86125	HEAD VALVE SEAL	1
16	000000-00	No Longer Available	1
17	89673	O-RING	1
18	000000-00	No Longer Available	1
19	000000-00	No Longer Available	1
20	86459	O-RING	1
21	MRG019824	O-RING-.780X.094	1
23	000000-00	No Longer Available	1
24	N70145	GUIDE-ARM	1
25	N80132	SPRING-CONTACT ARM	1
26	MRG084431	O-RING-3.323X.122	1
27	110005	FRAME	1
27	107490	GRIP-HANDLE	1
28	112767	LABEL-BOSTITCH	1
29	159912	LABEL-WARNING-COIL N	1
30	MPP030020	PIN-SPIRAL M3X20MM	1

Parts List for N86C Type 0

Item Number	Part Number	Description	Qty Required
31	102549	PIN-SPECIAL SPIROL M	1
32	N70143	BUSHING-RUBBER	1
37	MRG049431	O-RING-2.343X.118	2
38	N70167	CAP-END	1
39	N86113	FRAME EXTENSION	1
40	000000-00	No Longer Available	1
41	N80130	DRIVER GUIDE	1
42	N80125	PIN-SPECIAL	1
43	N80354	GASKET-NOSE	1
45	854004	WASHER-RUBBER-7	2
46	N80120	SPRING-TORSION	1
47	N80119	PAWL-FEED	1
48	N50087	PIN-SPECIAL(STEP)	1
49	N80158	NOSE	1
50	MSC8125-28	SCREW-SHCS M8X28	4
51	MSC6100-40	SCREW-SOC. HD. CAP M	2
52	N70150	LATCH DOOR	1
53	854013	SPRING,CMPRSN.	1
54	N80126	DOOR	1
55	N70140	PIN-SPECIAL(STEP)	1
56	MPP030012	PIN-SPIROL	1
57	854011	COMPRESSION SPRING	1
58	N70149	PAWL CHECK	1
59	MRG009824	O-RING-.386X.094	1
60	N80121	ROD-FEED PISTON	1
61	851384	O-RING-.987X.103	1
62	N80123	BUMPER-FEED PISTON	1

Parts List for N86C Type 0

Item Number	Part Number	Description	Qty Required
63	N80122	SPRING-COMPRESSION	1
64	N80124	COVER-FEED PISTON	1
65	851383	RING-RETAINING METRI	1
68	LW14.2	WASHER-1/4 HI COL LO	1
69	MSC6100-16	SCREW-SHCS-M6X1.00X1	1
70	MHE6100-100	NUT-ESN M6X1	2
71	105973	SPACER	1
72	MPW6.2	WASHER.SPECIAL	2
73	N80107	SPACER-FRAME	1
76	N80103	BOTTOM-CANISTER	1
77	UB5130	PIN-SPIROL 1/4 X 1 7	1
78	107455	LATCH-CANISTER	1
79	N80108	SPRING-FLAT	1
80	UB2110.4	PIN-ROLL 1/8 X 5/8	1
81	N80106	SPACER-LATCH	1
82	UB2126	PIN-ROLL 1/8 X 1 5/8	1
83	N80131	GUARD-CONTACT ARM	1
85	TVA6	KIT-TRIGGER VALVE	1
86	CNTK2	KIT-CONTACT TRIP CON	1
98	N100134A	COVER-EXHAUST	1
99	N100136	MUFFLER- EXHAUST	1
100	N100138	SPACER- MUFFLER	1
102	N100137	RING- BUMPER	1
107	SEQ6	KIT-SEQUENTIAL	1
108	N80128	PISTON-FEED	1
109	MPW6.3	WASHER-PWN M6	1
110	N80127	ARM-CONTACT-SERRATED	1

Parts List for N86C Type 0

Item Number	Part Number	Description	Qty Required
111	121632	ASSEMBLY-BRACKET	1
112	121635	ASSEMBLY-CANISTER	1
800	100653	LUBE (2CC)	1
800	100679	LUBE (1LB.CAN)	1
811	851385	LOCTITE	1
811	851325	LOCTITE	1
856	105005	ASSY-ADJUSTABLE CONT	1
876	DC3	DIAL-A-DEPTH KIT	1