

N88RH17-2

PNEUMATIC STICK NAILER
CLAVADORA NEUMÁTICA ALIMENTADA POR BARRA
CLOUEUR PNEUMATIQUE EN BANDES

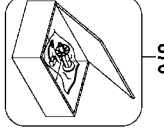
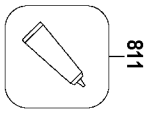
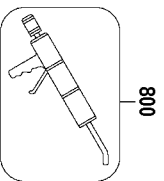
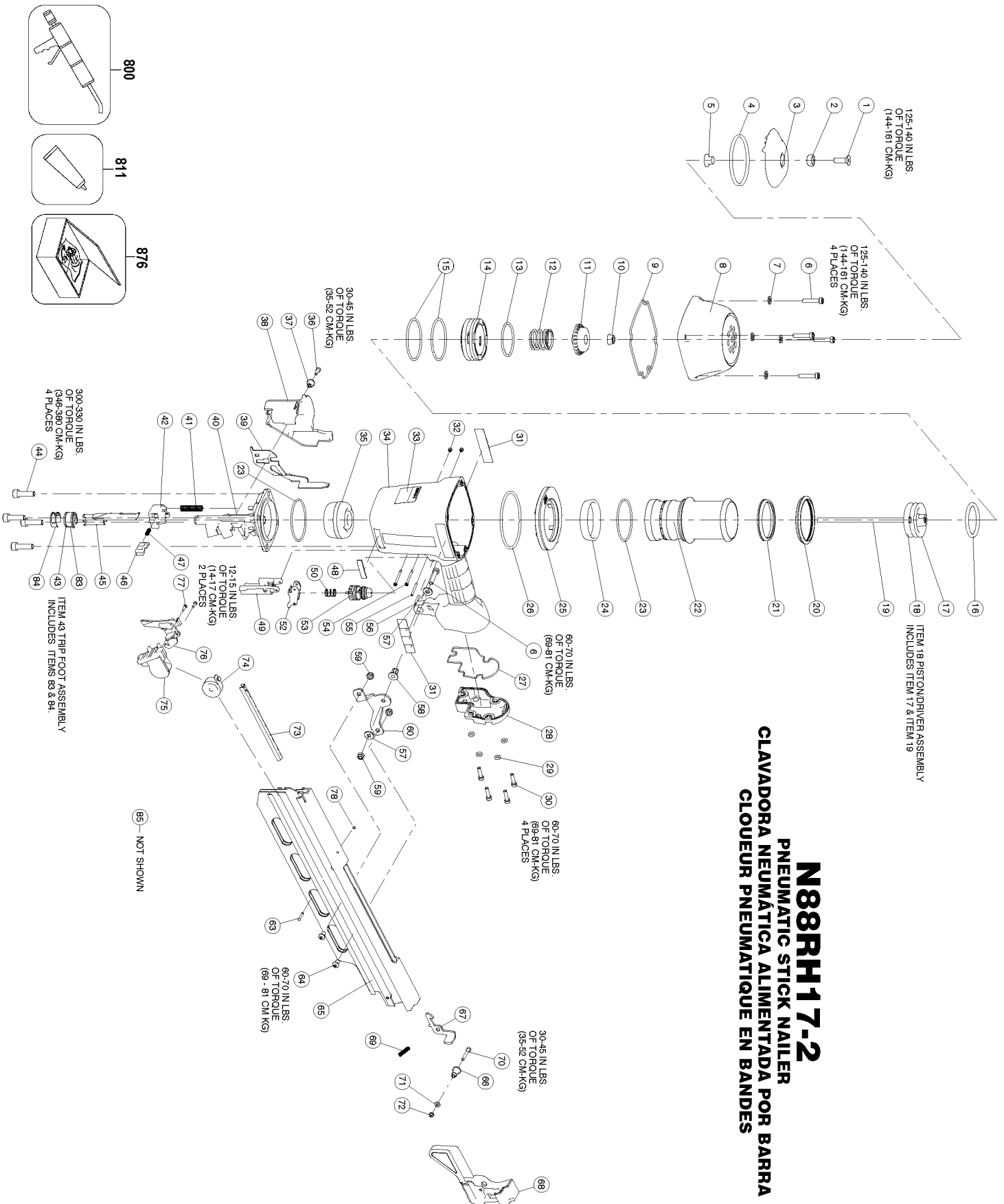

Parts List for N88RH17-2 Type 0

Item Number	Part Number	Description	Qty Required
1	MSF8125-25	SCREW-SFHCS M8 X 1.2	1
2	108555	MOUNT-SHOCK	1
3	112633	COVER-EXHAUST	1
4	116961	SEAL-COVER EXHAUST	1
5	108418	SPACER-COVER EXHAUST	1
6	MSC6100-30	SCREW-SHCS-M6X1.00X3	5
7	MPW6.3	WASHER-PWN M6	4
8	108559	CAP-MACHINING	1
9	108416	SEAL-FRAME	1
10	103859	NUT-HFN-M8X1.25	1
11	107236	BUMPER-PISTON STOP	1
12	107235	SPRING-COMPRESSION	1
13	112635	O-RING-1.988X.118	1
14	107234	HEAD VALVE	1
15	107658	O-RING-2.512X.118	2
16	851606-S	O-RING-1.850X.210	1
17	158582	ASSEMBLY-PISTON/DRIV	1
18	158547	PISTON-MAIN-RH FLANG	1
19	158548	DRIVER-RH FLANGED	1
20	107142	RETAINER	1
21	107141	SEAL-CYLINDER SLEEVE	1
22	144625	SLEEVE-CYLINDER	1
23	89673	O-RING	2
24	175520	SEAL-CHECK	1
25	108563	RING-CYLINDER SLEEVE	1
26	108718	O-RING-3.484X.139	1
27	108560	SEAL-END CAP	1

Parts List for N88RH17-2 Type 0

Item Number	Part Number	Description	Qty Required
28	108722	CAP-END	1
29	T50118	WASHER-PLAIN	4
30	MSC5080-20	SCREW-SOC HD. CAP M5	4
31	112733	PROTECTOR-FRAME	2
32	MHE3050-100	NUT-NYLON M3X.50	2
34	000000-00	No Longer Available	1
34	000000-00	No Longer Available	1
35	107231	BUMPER-DRIVE	1
36	MSC4070-12	SCREW-SHCS-M4X0.70X1	1
37	112632	BUSHING-TRIP COVER	1
38	116969	COVER-TRIP	1
39	116966	ARM-UPPER CONTACT	1
40	159971	NOSE	1
41	116970	SPRING-CONTACT ARM	1
42	000000-00	No Longer Available	1
43	121072	ASSEMBLY-TRIP FOOT	1
44	MSC8125-28	SCREW-SHCS M8X28	4
45	108227	ARM-LOWER CONTACT	1
46	108225	CASTING-PLUNGER	1
47	115230	SPRING-HOUSING	1
48	116964	LABEL-MAGNESIUM	1
49	000000-00	No Longer Available	1
50	100387	SPRING-COMPRESSION	1
52	107582	ASSEMBLY-S.T.TRIGGER	1
53	TVA11	KIT-TRIGGER VALVE	1
54	108562	SCREW-TRIGGER PIVOT	2
55	100298	PIN-SPIRAL M3X30	1

Parts List for N88RH17-2 Type 0

Item Number	Part Number	Description	Qty Required
56	MPP030020	PIN-SPIRAL M3X20MM	1
57	MPW6.2	WASHER.SPECIAL	2
58	123859	BUSHING-FLANGED ISOL	1
59	MHE6100-100	NUT-ESN M6X1	2
60	159973	BRACKET-N88RH17	1
63	121407	PIN-SPECIAL	1
64	MSB6100-12	SCREW-SBHCS-M6X1.00X	2
65	160168	MAGAZINE-N88RH17	1
66	121472	SPACER-PUSHER LATCH	1
67	120875	LATCH-PUSHER	1
68	159974	CAP END-MAGAZINE	1
69	120878	SPRING- PUSHER LATCH	1
70	100261	SCREW	1
71	MPW4	WASHER-PWN-M4	1
72	MHE4070-100	ELASTIC STOP NUT-M4	1
73	159976	LINER-NAIL GUIDE	1
74	115143	SPRING-CONSTANT FORC	1
75	120945	HANDLE-PUSHER	1
76	000000-00	No Longer Available	1
77	100209	SCREW	2
78	89013	O-RING	1
80	112630	SHIELD-DUST	1
81	112631	SPRING-CLIP	1
83	121070	FOOT-TRIP	1
84	121071	CLIP-TRIP FOOT	1
800	100653	LUBE (2CC)	1
800	100679	LUBE (1LB.CAN)	1

Parts List for N88RH17-2 Type 0

Item Number	Part Number	Description	Qty Required
811	851385	LOCTITE	1
876	N88ORK	REPAIR KIT	1