

# ROLAIR

SCHMATIC FOR  
PMP22K24

PRODUCTION PRIOR TO 8/02

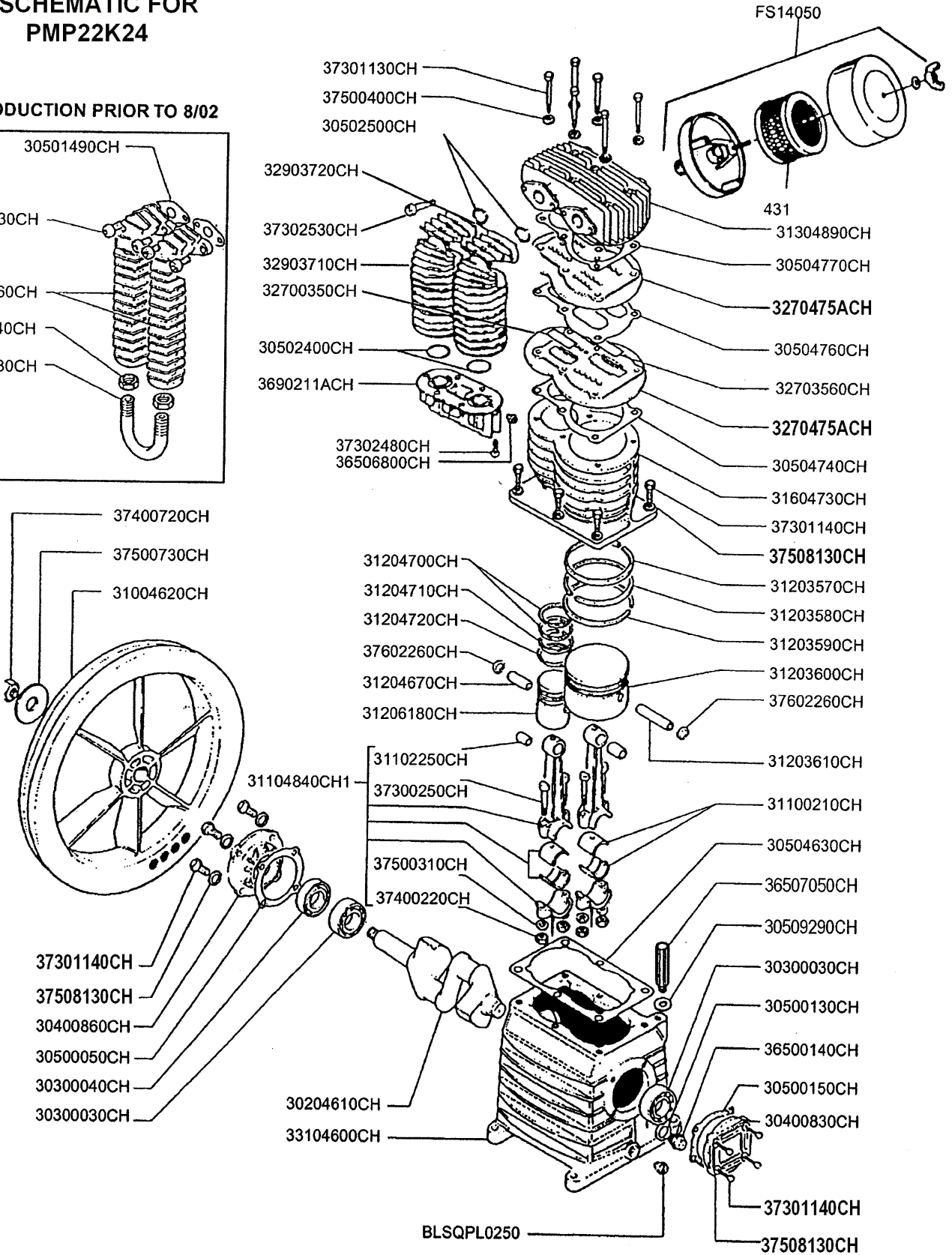

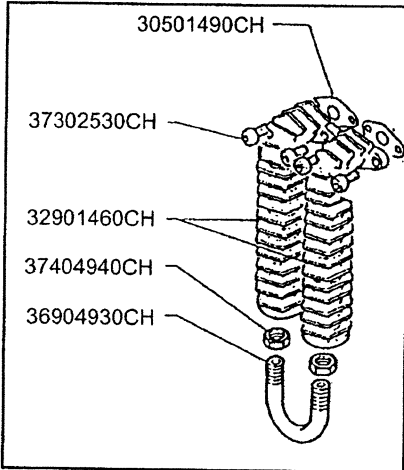
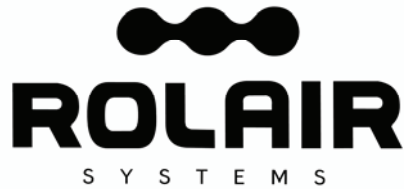

## PARTS LIST FOR PMP22K24

| Description             | Part #      | Qty. | Description                                   | Part #     | Qty. |
|-------------------------|-------------|------|---|------------|------|
| Crankshaft              | 30204610CH  | 1    | Left Intercooler                              | 32903710CH | 1    |
| Bearing                 | 30300030CH  | 2    | Right Intercooler                             | 32903720CH | 1    |
| Oil Seal                | 30300040CH  | 1    | Crankcase                                     | 33104600CH | 1    |
| Bearing Carrier         | 30400830CH  | 1    | Sight Gauge                                   | 36500140CH | 1    |
| Bearing Carrier         | 30400860CH  | 1    | 3/8" Breather/Oil Fill Plug                   | 36507050CH | 1    |
| Gasket                  | 30500050CH  | 1    | Plug  | 36506800CH | 1    |
| Gasket                  | 30500130CH  | 1    | Connector                                     | 3690211ACH | 1    |
| Gasket                  | 30500150CH  | 1    | Bolt  | 37300250CH | 4    |
| O-Ring                  | 30502400CH  | 2    | Bolt  | 37301130CH | 6    |
| O-Ring                  | 30502500CH  | 2    | Bolt  | 37301140CH | 14   |
| Gasket                  | 30504630CH  | 1    | Bolt  | 37302480CH | 6    |
| Gasket                  | 30504740CH  | 1    | Bolt  | 37302530CH | 4    |
| Gasket                  | 30504760CH  | 1    | Nut   | 37400220CH | 4    |
| Gasket                  | 30504770CH  | 1    | Nut   | 37400720CH | 1    |
| O-Ring                  | 30509290CH  | 1    | Washer  | 37500310CH | 4    |
| Flywheel                | 31004620CH  | 1    | Washer  | 37508130CH | 14   |
| Bearing Shell           | 31100210CH  | 2    | Washer  | 37500400CH | 6    |
| Bushing*                | 31102250CH  | 2    | Washer  | 37500730CH | 1    |
| Connecting Rod Assembly | 31104840CH1 | 2    | Snap Ring                                     | 37602260CH | 4    |
| Ring - LP               | 31203570CH  | 1    | Filter Element                                | 431        | 1    |
| Ring - LP               | 31203580CH  | 1    | Plug  | BLSQPL0250 | 1    |
| Ring - LP               | 31203590CH  | 1    | Silencer/Filter Assembly                      | FS14050    | 1    |
| Piston - LP             | 31203600CH  | 1    | Ring Set                                      | K24RINGS   | 1    |
| Piston Pin - LP         | 31203610CH  | 1    | Gasket Set                                    | K24GASKETS | 1    |
| Piston Pin - HP         | 31204670CH  | 1    | Valve Plate Assembly                          | 2400VK24   | 1    |
| Ring - HP               | 31204700CH  | 2    | <b>INTERCOOLER/AFTERCOOLER PARTS PRIOR TO</b> |            |      |
| Ring - HP               | 31204710CH  | 1    | <b>AUGUST 2002</b>                            |            |      |
| Ring - HP               | 31204720CH  | 1    | Gasket  | 30501490CH | 2    |
| Piston - HP             | 31206180CH  | 1    | Intercooler                                   | 32901460CH | 2    |
| Head                    | 31304890CH  | 1    | Connector                                     | 36904930CH | 1    |
| Cylinder                | 31604730CH  | 1    | Bolt  | 37302530CH | 4    |
| Valve - HP              | 32700350CH  | 2    | Nut   | 37404940CH | 2    |
| Valve - LP              | 32703560CH  | 2    |   |            |      |
| Valve Plate             | 3270475ACH  | 2    |   |            |      |

\*Bushing is not machined to fit piston pin if ordered separate from connecting rod.



606 South Lake Street > P.O. Box 346 > Hustisford, WI 53034-0346 > 920.349.3281 > fax 920.349.3691 > www.rolair.com