



SERVICE PARTS LIST

BULLETIN NO.
54-06-1125

SPECIFY CATALOG NO. AND SERIAL NO. WHEN ORDERING PARTS		REVISED BULLETIN	DATE
3/8" 2800 RPM MAGNUM HOLE-SHOOTER			Sept. '96
CATALOG NO. 0232-02	STARTING SERIAL NO. 923A	WIRING INSTRUCTION	
		58-01-1654	

EXAMPLE:
Component Parts (Small #)
Are Included When Ordering
The Assembly (Large #).

00/0

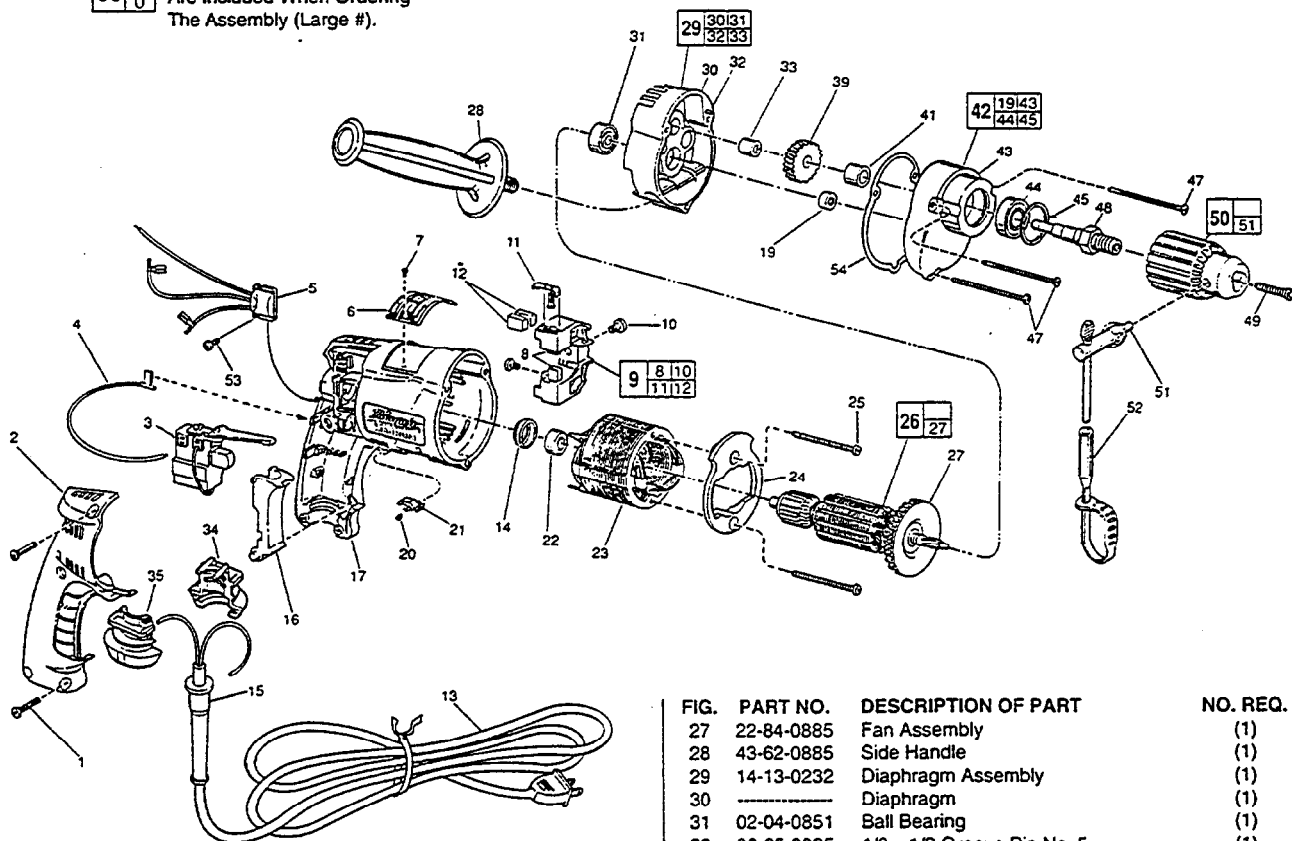

FIG.	PART NO.	DESCRIPTION OF PART	NO. REQ.
1	06-82-7266	7-1/8 x 11/16" Pan Hd. Plastiite T-20	(5)
2	31-15-0402	Handle Cover	(1)
3	23-66-1665	Trigger Speed Control Reversing Switch	(1)
4	23-94-6245	2-3/8" Lead Assembly	(1)
5	14-20-0765	Remote Electronic Assembly	(1)
6	12-99-0145	Nameplate Blank	(1)
7	06-72-1720	Nameplate Rivet	(2)
8	22-16-0275	Carbon Brush	(2)
9	22-22-0351	Brush Holder Assembly	(1)
10	31-75-0040	Brush Holder Screw	(2)
11	22-20-0345	Brush Spring Assembly	(2)
12	22-16-0275	Carbon Brush (Spares)	(2)
13	22-64-0215	Cord Set	(1)
14	22-72-0100	Bearing Cup	(1)
15	44-76-0210	Cord Protector	(1)
16	45-72-0080	Trigger	(1)
17	14-38-0545	Motor Housing Assembly	(1)
19	42-40-0050	Bushing	(1)
20	40-50-0085	Lock Button Spring	(1)
21	42-42-0460	Lock Button	(1)
22	02-04-0645	Ball Bearing	(1)
23	18-11-0075	120 Volt Field	(1)
24	42-14-0395	Baffle	(1)
25	06-82-7398	7-18 x 2-1/16" Pan Hd. Plastiite T-20	(2)
26	16-10-0805	120 Volt Armature Assembly	(1)

FIG.	PART NO.	DESCRIPTION OF PART	NO. REQ.
27	22-84-0885	Fan Assembly	(1)
28	43-62-0885	Side Handle	(1)
29	14-13-0232	Diaphragm Assembly	(1)
30	-----	Diaphragm	(1)
31	02-04-0851	Ball Bearing	(1)
32	06-65-0825	1/8 x 1/2 Groove Pin No. 5	(1)
33	02-50-2020	Needle Bearing	(1)
34	31-17-0260	Cord Clamp Half	(1)
35	31-17-0270	Cord Clamp Half	(1)
39	32-75-2915	Spindle Gear	(1)
41	45-36-1105	Spacer	(1)
42	14-30-0232	Gear Case Assembly	(1)
43	-----	Gear Case	(1)
44	02-04-1229	Ball Bearing	(1)
45	34-80-2300	Retaining Ring	(1)
47	06-82-7380	7-18 x 1-7/8" Pan Hd. Plastiite T-20	(3)
48	38-50-6100	Spindle - Single Reduction	(1)
49	45-04-0750	Chuck Retaining Screw	(1)
50	48-66-0797	3/8" Chuck	(1)
51	48-66-3240	Chuck Key	(1)
52	48-66-4040	Key Holder	(1)
53	06-82-7212	4-20 x 1/4" Pan Hd. Plastiite T-10	(1)
54	43-44-0913	Gasket	(1)
	23-94-6230	4-1/8" Lead Assembly	(1)
	23-94-6235	4-1/8" Lead Assembly	(1)
	23-94-6240	3-3/8" Lead Assembly	(1)
	10-98-5986	Warning Label	(1)

FIG. LUBRICATION
30 Place in Diaphragm, 5/8 Oz. Type "L" Grease No. 49-08-4170, Near Needle Bearing #33.

FIG. NOTES
22 Ball Bearing Seal Towards Armature.

MILWAUKEE ELECTRIC TOOL CORPORATION
13135 W. LISBON RD., BROOKFIELD, WI 53005