



SERVICE PARTS LIST

BUL. 54-06-3401

5/16" PISTOL DRILL

REVISED BUL 679-2 DATE Feb. '68

Catalog No. 0350

Starting Serial No. **79-1085**

WIRING INSTR. **58-01-0020**

Both Model and Serial No. must be furnished to obtain correct parts.

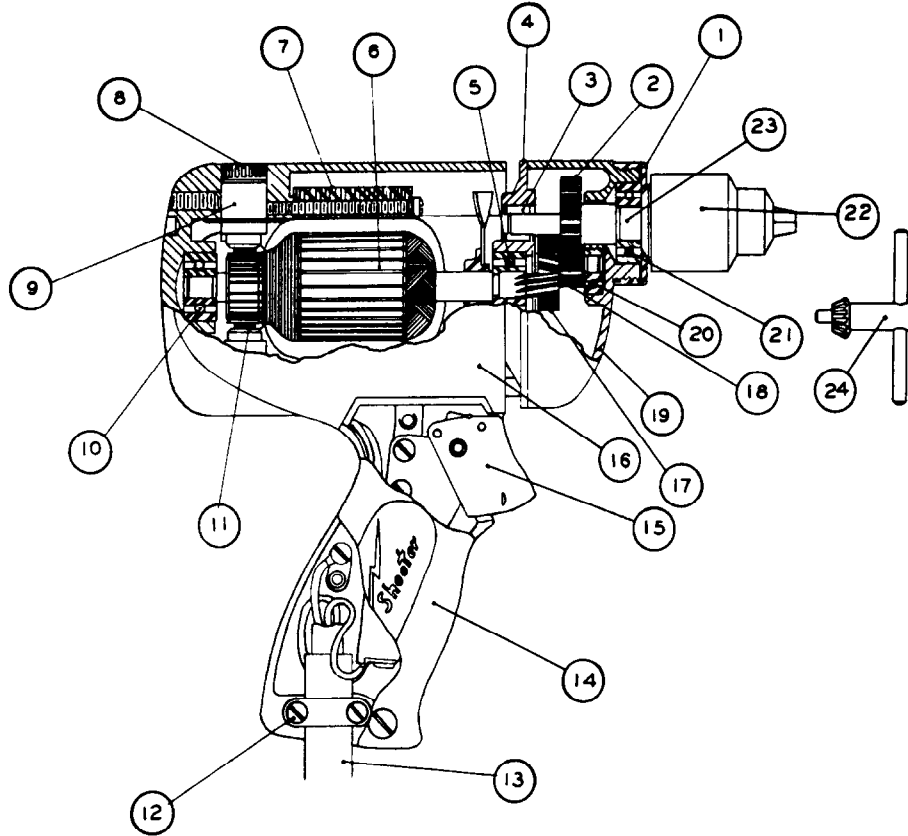

ILLUSTRATED PARTS

FIG.	PART NO.	DESCRIPTION OF PART
1	42-52-0060	Bearing Cap
2	32-75-1361	Spindle Gear
3	02-50-1640	Needle Bearing
4	28-28-0221	Diaphragm
* 5	02-04-0740	Ball Bearing (Pinion End)
6	16-22-1110	Armature Assembly
7	18-22-1030	Field Assembly
8	23-44-0020	Brush Retaining Cap
9	22-22-0050	Brush Holder Assembly
10	02-04-0740	Ball Bearing
11	22-18-0090	Carbon Brush Assemblies
12	28-17-0400	Cord Clamp

FIG.	PART NO.	DESCRIPTION OF PART
13	22-64-0170	Cord Set
14	28-20-3171	Switch Cover Plate
15	23-66-0270	Switch
* 16	28-50-4601	Motor Housing (Incl. item 14 & scrs.)
17	32-40-1121	Intermediate Gear
18	36-66-1551	Intermediate Pinion Shaft
19	28-14-0361	Gear Case
20	02-04-0640	Ball Bearing
21	02-04-1020	Ball Bearing
22	48-66-0500	Chuck (3/8"-24 Thread)
23	38-50-1051	Spindle
24	48-66-3240	Chuck Key

MISCELLANEOUS PARTS NOT SHOWN

PART NO.	DESCRIPTION OF PART
48-66-4040	Rubber Flex Chuck Key Holder
44-66-0110	Air Intake Cover Plates (2)
06-81-8650	6-32x1/4" Rd. Hd. Sems Ventilating Plate Sc. (4)
12-98-0600	Name Plate
06-81-4300	3-48x3/16" Rd. Hd. Name Plate Screws
06-81-6100	8-32x7/16" Fil. Hd. Cord Clamp Sem
06-42-0400	Woodruff Key
06-83-2670	1/4"-20x1/2" Hd. less Slotted Brush Holder Set Screws (2)
48-03-0010	Attachment Plug Adaptor
06-81-0900	8-32x7/16 Fil. Hd. Cord Clamp Scr.

PART NO.	DESCRIPTION OF PART
06-81-8625	6-32x1/4" (Brass) Rd. Hd. Ground Screw Sems
06-81-6550	8-32x1-1/2" Fil. Hd. Gear Case Screws Sems (2)
06-81-6300	8-32x7/8" Fil. Hd. Sems Gear Case Screws (2)
06-81-5950	6-32x1-7/8" Fil. Hd. Sems Field Screws (2)
06-81-5400	8-32x5/16" Binder Hd. Switch Mtg. Scs. (2)
06-81-3700	8-32x7/8" Oval Hd. Handle Cover Screws
06-81-3650	8-32x3/4" Oval Hd. Handle Cover Scs. (Top) (2)
06-42-0800	Woodruff Key
02-50-1210	Needle Bearing
*06-97-1800	Switch Lock Washer (4)