



SERVICE PARTS LIST

BUL. 54-08-1070

1/2" ELECTRIC DRILL

REVISED BUL 6126-1 DATE FEB. '68

Catalog No. 1000-1

Starting Serial No. 126-1001

WIRING INSTR.

Both Model and Serial No. must be furnished to obtain correct parts.

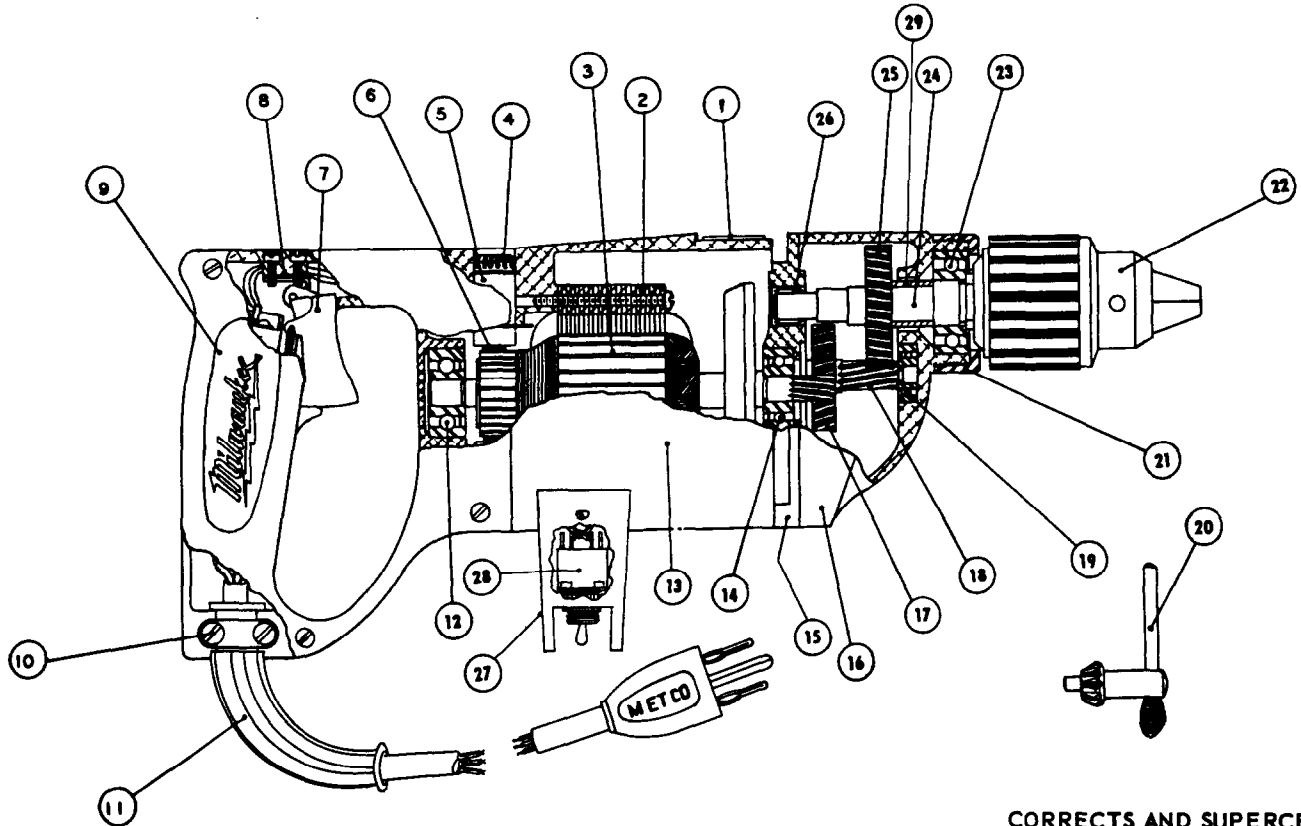

CORRECTS AND SUPERCEDES SERVICE BULLETIN 6126-1 DATED 11-20-57

FIG. PART NO.		DESCRIPTION OF PART	ILLUSTRATED PARTS		FIG. PART NO.		DESCRIPTION OF PART
1	12-98-0800	Name Plate	16	28-14-0681	16	28-14-0681	Gear Case
2	18-42-1041	Field Assembly	17	32-40-1241	17	32-40-1241	Intermediate Gear
3	16-42-1210	Armature Assembly	18	36-66-2001	18	36-66-2001	Intermediate Pinion
4	23-44-0060	Brush Retaining Screw (2)	19	02-04-0640	19	02-04-0640	Inter. Shaft Ball Bearing
5	22-22-0080	Brush Holder Assembly (2)	20	48-66-3280	20	48-66-3280	Chuck Key
6	22-18-0100	Carbon Brush Assembly (2)	21	42-52-0071	21	42-52-0071	Bearing Cap
7	23-66-0230	Switch	22	48-66-1360	22	48-66-1360	1/2" Chuck
8	45-36-0110	Switch Spacer	23	02-04-1560	23	02-04-1560	Ball Bearing
9	28-20-3141	Handle Cover	24	38-50-3651	24	38-50-3651	Spindle
10	28-17-0400	Cord Clamp Strap	25	32-75-1601	25	32-75-1601	Spindle Gear
11	22-64-0170	Cord Set	26	02-50-2110	26	02-50-2110	Needle Bearing
12	02-04-0970	Ball Bearing (Comm. End)	27	28-50-7031	27	28-50-7031	Reversing Switch Housing
13	28-50-4482	Motor Housing	28	23-66-0220	28	23-66-0220	Reversing Switch
14	02-04-0940	Ball Bearing (Pinion End)	29	45-36-0210	29	45-36-0210	Spindle Gear Spacer
15	28-28-0581	Diaphragm					
MISCELLANEOUS PARTS NOT SHOWN							
SIZE OR PART NO.	DESCRIPTION OF PART	SIZE OR PART NO.	DESCRIPTION OF PART	SIZE OR PART NO.	DESCRIPTION OF PART	SIZE OR PART NO.	DESCRIPTION OF PART
02-50-1640	Needle Bearing	06-81-6100	8-32x1/2 Fil.Hd.Sems Cord Clamp Strap Scs. (2)	06-81-6100	8-32x1/2 Fil.Hd.Sems Cord Clamp Strap Scs. (2)	06-81-6100	8-32x1/2 Fil.Hd.Sems Cord Clamp Strap Scs. (2)
43-62-0160	Handle	06-81-8625	6-32x1/4 Rd.Hd.Sems Ground Screw (Brass)	06-81-8625	6-32x1/4 Rd.Hd.Sems Ground Screw (Brass)	06-81-8625	6-32x1/4 Rd.Hd.Sems Ground Screw (Brass)
44-90-0130	Handle Ring	06-81-6350	8-32x1 Fil.Hd.Sems Gear Case Screws	06-81-6350	8-32x1 Fil.Hd.Sems Gear Case Screws	06-81-6350	8-32x1 Fil.Hd.Sems Gear Case Screws
06-42-1200	Woodruff Keys (3)	06-81-6650	8-32x1 1/4 Fil.Hd.Sems Gear Case Screws (2)	06-81-6650	8-32x1 1/4 Fil.Hd.Sems Gear Case Screws (2)	06-81-6650	8-32x1 1/4 Fil.Hd.Sems Gear Case Screws (2)
06-81-8400	4-40x1/4 Rd.Hd.Name Pl.Scs.Sems (2)	06-81-6600	8-32x1 1/2 Fil.Hd.Sems Field Screws (2)	06-81-6600	8-32x1 1/2 Fil.Hd.Sems Field Screws (2)	06-81-6600	8-32x1 1/2 Fil.Hd.Sems Field Screws (2)
06-81-5800	6-32x5/16 Fil.Hd.Sems Sw.Mtg. Scs.(2)	06-83-2650	1/4-20x3/8 Hd'less Brush Holder Set Screws (2)	06-83-2650	1/4-20x3/8 Hd'less Brush Holder Set Screws (2)	06-83-2650	1/4-20x3/8 Hd'less Brush Holder Set Screws (2)
23-86-0110	Brush Holder Insul. Washer (2)	06-81-3700	8-3 2x7/8 Oval Hd. Handle Cover Screws (4)	06-81-3700	8-3 2x7/8 Oval Hd. Handle Cover Screws (4)	06-81-3700	8-3 2x7/8 Oval Hd. Handle Cover Screws (4)
23-16-0050	Switch Insulator	06-75-3150	1/4-20x1 Left Hd.Allen Hd.Cap Sc.(Chuck Ret.Sc.)	06-75-3150	1/4-20x1 Left Hd.Allen Hd.Cap Sc.(Chuck Ret.Sc.)	06-75-3150	1/4-20x1 Left Hd.Allen Hd.Cap Sc.(Chuck Ret.Sc.)
48-03-0010	Attach. Plug Adaptor						

Numbers in brackets indicate number required.