



SERVICE PARTS LIST

BUL. 54-08-2121

1/2" ELECTRIC DRILL

REVISED BUL 6133-2 DATE FEB. '68

Catalog No. 1100-1

Starting Serial No. 133-4138

WIRING INSTR.

Both Model and Serial No. must be furnished to obtain correct parts.

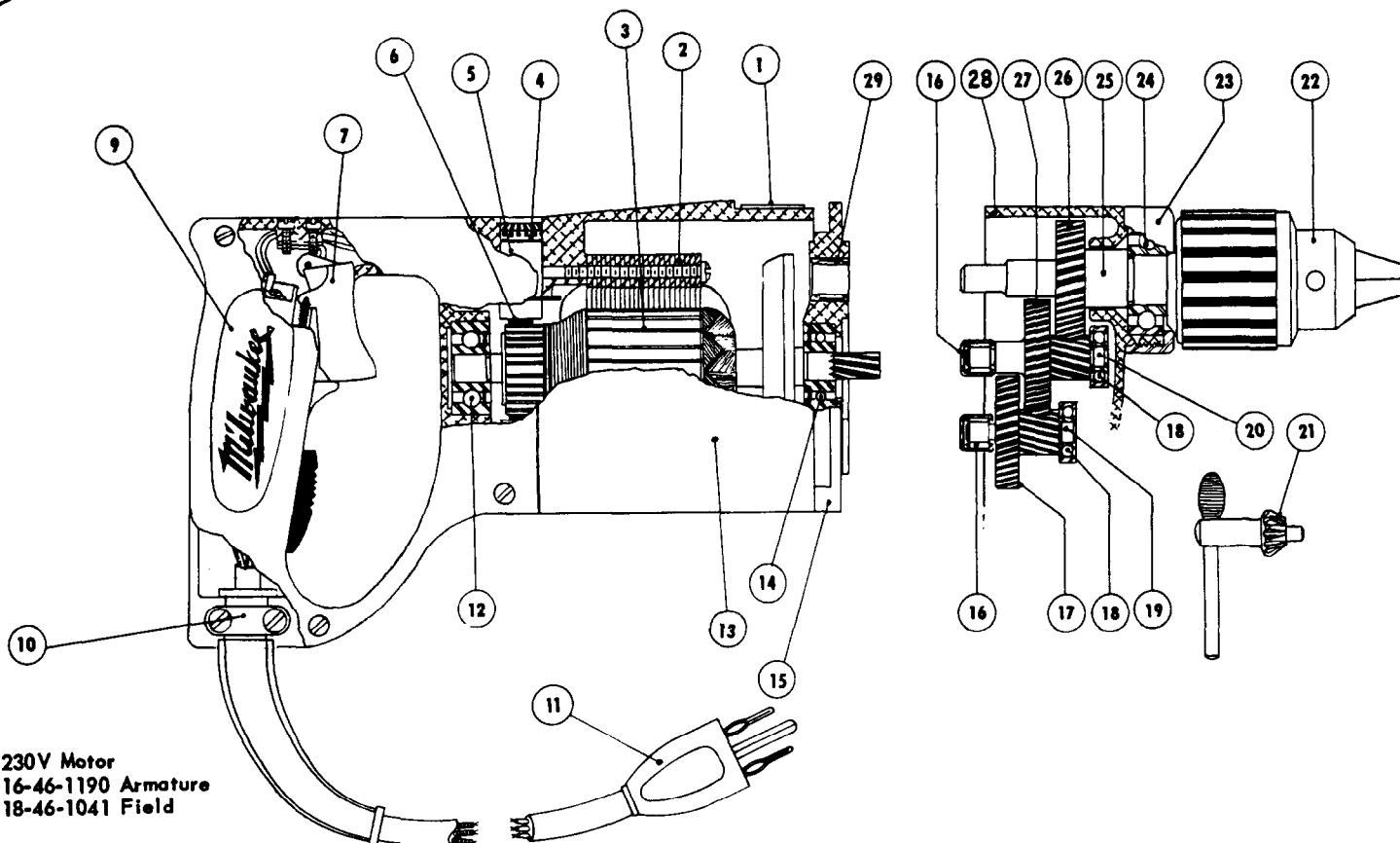

230V Motor
16-46-1190 Armature
18-46-1041 Field

ILLUSTRATED PARTS

FIG.	PART NO.	DESCRIPTION OF PART
1	12-98-0800	Name Plate
2	18-42-1041	Field Assembly
3	16-42-1210	Armature Assembly
4	23-44-0060	Brush Retaining Screw
5	22-22-0080	Brush Holder Assembly
6	22-18-0100	Carbon Brush Assembly
7	23-66-0440	Switch
9	28-20-3141	Handle Cover
10	28-17-0400	Cord Clamp Strap
11	22-64-0170	Cord Set
12	02-04-0970	Ball Brg. (Comm. End)
13	28-50-4488	Motor Housing
14	02-04-0940	Ball Brg. (Pinion End)
15	28-28-0661	Diaphragm
16	02-50-1640	Needle Bearing

FIG.	PART NO.	DESCRIPTION OF PART
17	32-40-1241	Intermediate Gear
18	02-04-0640	Ball Bearing
19	36-66-2801	Intermediate Pinion Shaft
(2)	20	36-66-2901 Intermediate Pinion Shaft
(2)	21	48-66-3280 Chuck Key
(2)	22	48-66-1360 Chuck (1/2-20 Thread 3 Jaw)
23	42-52-0071	Bearing Cap
24	02-04-1560	Ball Bearing
25	38-50-3651	Spindle
26	32-75-2061	Spindle Gear
27	32-75-2041	Spindle Gear
28	28-14-0961	Gear Case
29	02-50-2110	Needle Bearing

(2) MISCELLANEOUS PARTS NOT SHOWN

PART NO.	DESCRIPTION OF PART
45-36-0210	Spacer
43-62-0160	Handle
44-90-0130	Handle Ring
06-42-0800	Woodruff Keys
06-81-8400	4-40x1/4 Rd.Hd.Name Plate Screws
06-81-5790	6-32x1/4 Fil. Hd. Sw. Mtg. Sems
23-86-0110	Brush Holder Insul. Washer
48-03-0010	Attachment Plug Adaptor
06-75-3150	1/4-20x1 L.H. Allen Hd. Cap Rev. Chuck Sc.

PART NO.	DESCRIPTION OF PART
06-81-6150	Cord Clamp Strap Screws 8-32x1/2" Fil.Hd. (2)
06-81-8625	Ground Screw (Brass) 6-32x1/4" Rd.Hd. (2)
(3) 06-81-6350	Gear Case Screws (Sem) 8-32x1" Fil.Hd. (2)
(2) 06-81-6650	Gear Case Screws 8-32x1 1/2" Fil.Hd. (2)
(2) 06-83-2650	1/4-20x3/8 Hd'less Brush Holder Set Scs. (2)
(2) 06-81-3700	8-32x7/8 Oval Hd. Handle Cover Screws (4)
06-81-6600	8-32x1 1/4" Fil.Hd. Field Screws (Sem) (2)

Numbers in brackets indicate number required.