

Illustration - Type E

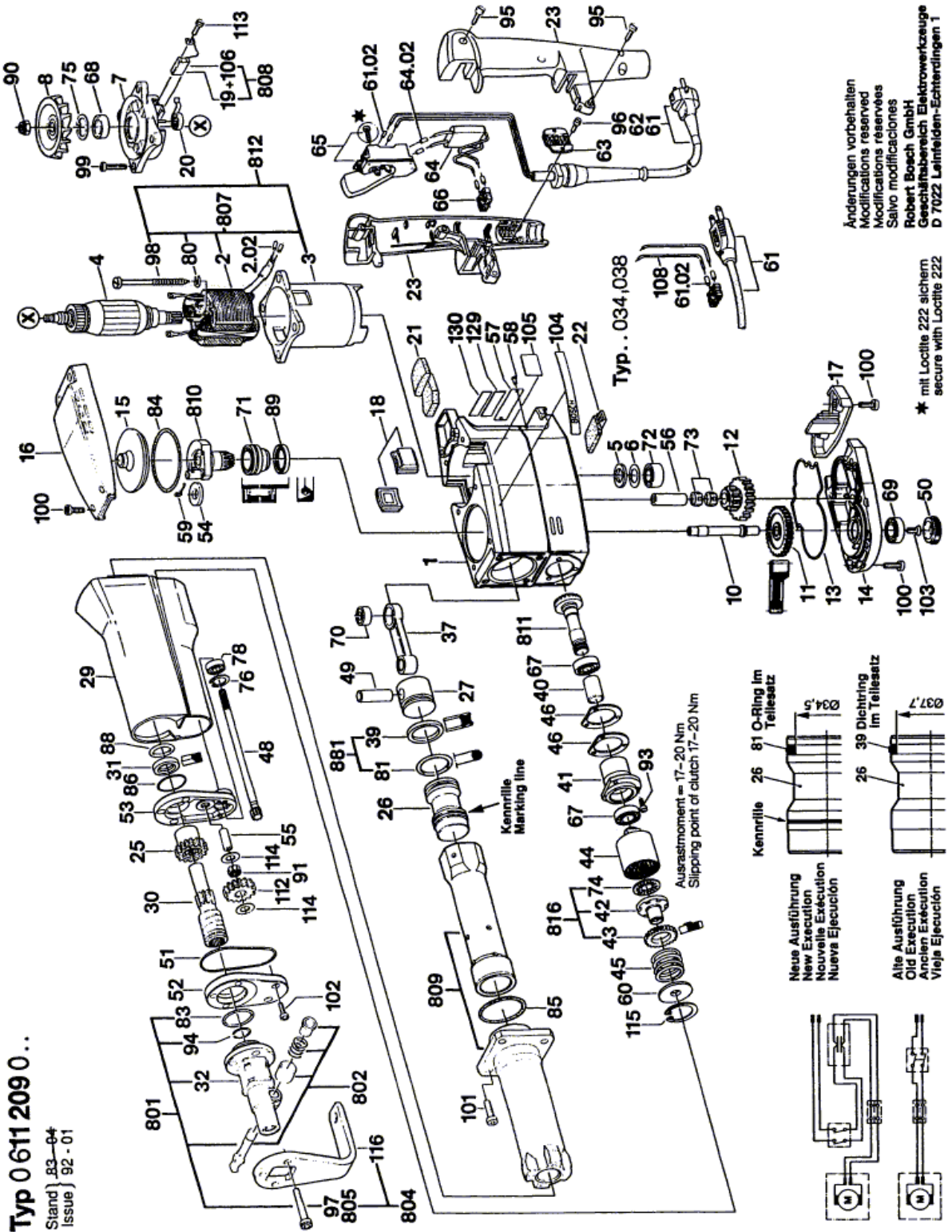
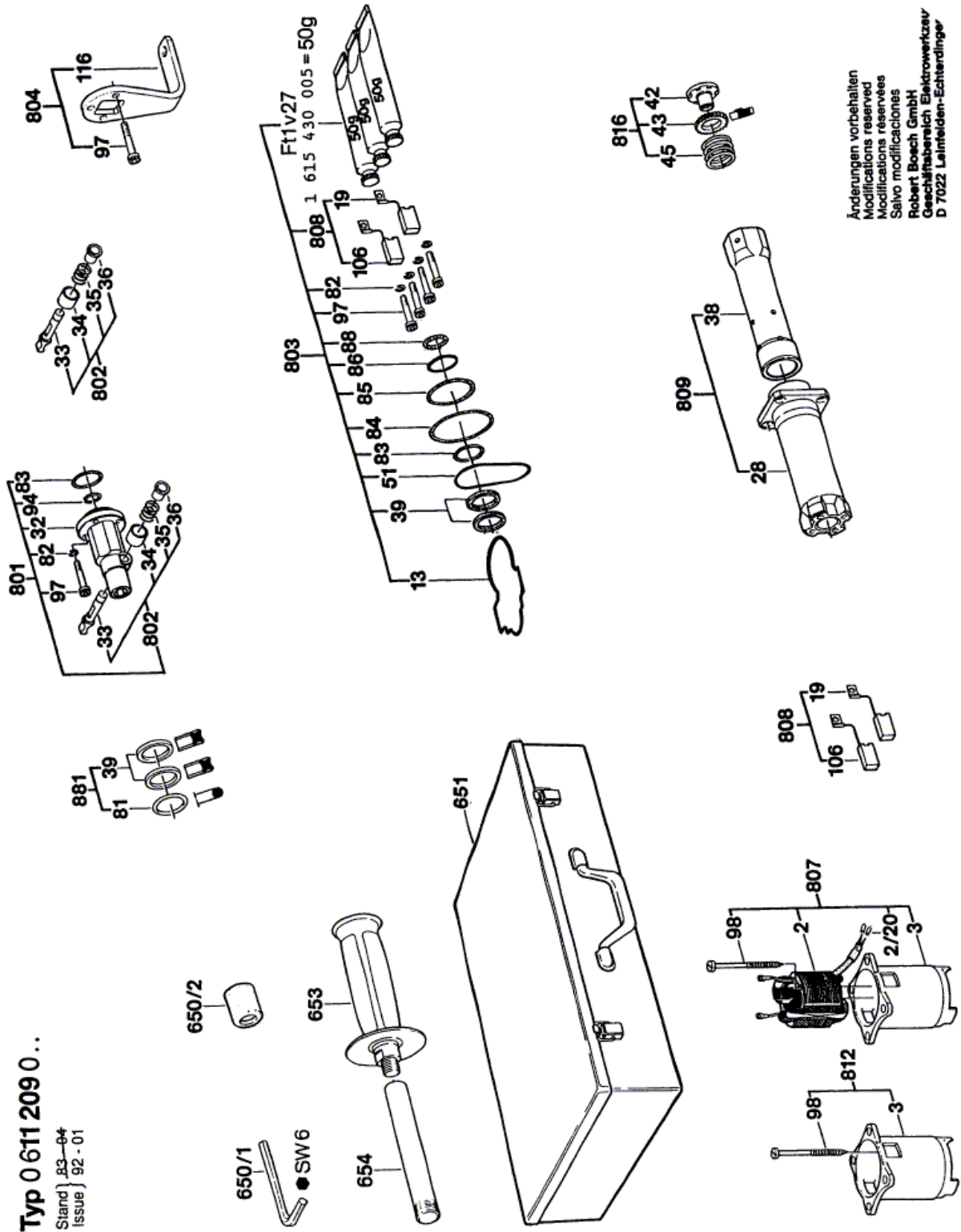

Illustration - Type E



Information subject to change without further notice.

## Rotary Hammer - 0 611 209 034 - 11209

www.powertools-aftersaleservice.com



**BOSCH**

Item	Part Number	Description	Illustration	Price	Quantity	Price Group
1	1 615 106 036	Motor Housing	1	-,-	1	56
2	1 617 031 010	Field 110-115V	1	-,-	1	48
2/20	1 900 452 012	End Splice DIN 46 228-A1-6	2	-,-	4	10
4	1 614 011 020	Armature 110-115V	1	-,-	1	56
5	1 610 108 012	Sealing disk	1	-,-	1	11
6	1 610 102 013	Shim 1,0 MM THICK	1	-,-	1	11
7	1 615 805 060	Bearing Flange	1	-,-	1	42
8	1 616 610 047	Fan	1	-,-	1	21
10	1 613 159 007	Wheel Shaft	1	-,-	1	37
11	1 616 317 029	Cylindrical Gear Z=45	1	-,-	1	41
12	1 616 328 025	Cylindrical Gear Z=47/21	1	-,-	1	41
13	1 611 015 023	Sealing Frame	1	-,-	1	17
14	1 615 808 050	Gear Cover	1	-,-	1	39
15	1 615 500 168	Sealing cap	1	-,-	1	14
16	1 615 500 276	Fan Cover	1	-,-	1	36
17	1 615 500 261	Switch Cover	1	-,-	1	21
18	1 615 500 282	Sealing cap	1	-,-	2	13
20	1 614 652 000	Spiral Spring	1	-,-	2	12
21	1 612 392 001	Rubber Plate	1	-,-	1	16
22	1 612 392 000	Rubber Plate	1	-,-	1	16
23	1 615 133 025	Handle BLACK	1	-,-	1	31
25	1 616 490 024	Carrier Z=11/31	1	-,-	1	40
26	1 618 710 058	Striker	1	-,-	1	38
27	1 618 700 047	Hammer Piston	1	-,-	1	32
29	1 615 190 006	Protective Tube	1	-,-	1	-
30	1 618 598 100	Bit holder Z=12	1	-,-	1	45
31	1 610 114 015	Stop Disc	1	-,-	1	22
32	1 618 597 036	Toolholder	1	-,-	1	-
37	1 612 001 029	Connecting Rod	1	-,-	1	20
39	1 610 280 004	Seal ring	1	-,-	2	-
40	1 610 400 020	Spacer Sleeve	1	-,-	1	14
41	1 615 801 022	Bushing	1	-,-	1	36
44	1 616 409 005	Clutch Element SW22	1	-,-	1	43

Item	Part Number	Description	Illustration	Price	Quantity	Price Group
45	1 614 619 006	Compression Spring	1	-,-	1	19
46	1 610 134 004	Shim Ø40,2xØ60x0,3 MM	1	-,-	2	16
48	1 613 060 009	Toothed Shaft Z= 8/8	1	-,-	1	42
49	1 610 300 058	Piston Pin	1	-,-	1	14
50	1 613 465 003	Screw Plug	1	-,-	1	25
51	1 610 210 048	Seal ring	1	-,-	1	14
52	1 615 806 040	Gear Housing	1	-,-	1	-
53	1 615 806 042	Gear Housing	1	-,-	1	-
54	1 610 113 005	Cover Disc Ø12xØ26x2,0 MM	1	-,-	1	11
55	1 610 300 052	Bearing bolt	1	-,-	1	17
56	1 610 300 057	Bearing bolt	1	-,-	1	17
57	1 601 106 032	Nameplate 26x52 MM	1	-,-	1	13
58	2 917 721 034	Round-Head Grooved Pin 2x6 DIN 1476-ST	1	-,-	2	10
59	1 904 681 350	Split Pin 3,2x18 DIN 94-ST	1	-,-	1	11
60	1 610 101 010	Cover Disc 2,0 MM THICK	1	-,-	1	14
61	1 604 460 092	Power supply cord USA/CDN 2,15m 2 x 2,08mm SJ 14/2	1	-,-	1	28
61/02	1 900 452 003	End Splice DIN 46 228-A2,5-7	N/A	-,-	2	11
62	3 600 703 011	Grommet Ø9,2-Ø12x120 MM	1	-,-	1	13
62	1 600 703 009	Grommet Ø11,5-Ø15,0x150 MM	1	-,-	1	15
63	1 611 302 006	Fastening Clamp	1	-,-	1	12
65	1 617 200 017	On-Off Switch	1	-,-	1	33
66	1 611 091 002	connecting terminal 2-POLE	1	-,-	1	11
67	1 900 905 163	groove ball bearing 17x35x10	1	-,-	2	23
68	1 610 905 001	groove ball bearing 10x32x12	1	-,-	1	26
69	1 900 900 302	groove ball bearing 12x32x10	1	-,-	1	29
70	1 610 910 049	Needle-Roller Bearing	1	-,-	1	32
71	1 610 910 060	Needle-Roller Bearing	1	-,-	1	33
72	1 610 910 007	Needle-Roller Bearing	1	-,-	1	29
73	1 610 913 001	Needle-Roller Assembly	1	-,-	2	19
74	1 600 920 000	Thrust Needle Rim	1	-,-	1	14
75	2 916 660 013	Spring retaining ring DIN 472-32x1,2 MM	1	-,-	1	11
76	2 916 660 010	Spring retaining ring DIN 472-26x1,2 MM	1	-,-	1	10
78	1 900 905 159	groove ball bearing 10x26x8	1	-,-	1	32
80	2 916 680 006	Spring Lock Washer DIN 127-B 5	1	-,-	2	10
81	1 600 150 006	Spring Washer DIN 137-A4	1	-,-	2	13
83	1 900 210 136	O-Ring 35x2,5MM	1	-,-	1	15
84	1 900 210 160	O-Ring 70x3 MM	1	-,-	1	18
85	1 900 210 152	O-Ring 55x3 MM	1	-,-	1	15
86	1 900 210 130	O-Ring 30x2 MM	1	-,-	1	15
88	1 610 210 042	O-Ring 22,0x6,0 MM	1	-,-	1	11
89	2 916 740 053	Shaft Seal A 30x42x7 DIN 3760	1	-,-	1	26
90	2 915 061 005	Hex Nut DIN 985-M8-8	1	-,-	1	13
91	1 610 913 006	Needle-Roller Assembly	1	-,-	1	17
93	2 910 141 154	Hex Socket Head Cap Screw DIN 912-M5x12-8.8	1	-,-	3	11
93	2 910 141 122	Hex Socket Head Cap Screw DIN 912-M 4x12-8.8	1	-,-	3	10
94	2 916 601 012	Retaining ring DIN 9045-24	1	-,-	1	14
95	2 910 211 220	Tapping Screw DIN 7971-B 3,9x19	1	-,-	5	11
96	2 910 021 118	Socket head cap screw DIN 84-AM4x8-8.8	1	-,-	2	10
98	2 910 011 179	Socket head cap screw DIN 84-B5x65-5.8	1	-,-	2	-
99	2 910 021 204	Socket head cap screw DIN 84-AM6x28-8.8	1	-,-	4	10
100	2 910 141 199	Hex Socket Head Cap Screw DIN 912-M6x18-8.8	1	-,-	12	15

Item	Part Number	Description	Illustration	Price	Quantity	Price Group
101	2 910 141 244	Hex Socket Head Cap Screw DIN 912-M8x25-8.8	1	-,-	4	11
102	2 910 141 158	Hex Socket Head Cap Screw DIN 912-M5X16-8.8	1	-,-	2	10
103	2 910 540 238	Countersunk-Head Screw M 8x16 DIN 7991-8.8	1	-,-	1	13
104	1 611 110 162	Manufacturer's nameplate	1	-,-	2	-
105	1 601 110 058	Reference Plate DOUBLE INSULATION	1	-,-	1	11
108	1 614 437 008	Connecting Cable	1	-,-	2	13
112	1 616 317 027	Cylindrical Gear Z=31	1	-,-	1	37
113	2 910 021 120	Socket head cap screw DIN 84-AM4x10-8.8	1	-,-	2	10
114	1 600 101 641	Shim 0,3 MM THICK	1	-,-	2	13
115	2 916 660 020	Spring retaining ring DIN 472-45x1,75MM	1	-,-	1	11
650/1	1 907 950 007	Offset Screwdriver DIN 911;SW6	N/A	-,-	1	15
650/2	2 600 508 019	Protective Cap	N/A	-,-	1	11
651	1 615 438 107	Carrying Case	2	-,-	1	-
652	2 600 508 019	Protective Cap	N/A	-,-	1	11
653	1 602 025 022	Auxiliary Handle M14 BLACK	2	-,-	1	26
653	1 602 025 030	Auxiliary Handle M14, Ø37x115 MM BLACK	2	-,-	1	28
801	1 617 000 056	Tool Holder Set	1	-,-	1	-
802	1 617 000 014	Locking Bolt Set	1	-,-	1	32
803	1 617 000 055	Parts Set	2	-,-	1	39
804	1 617 000 080	Parts Set	1	-,-	1	-
805	1 617 000 081	Parts Set	1	-,-	1	-
807	1 617 031 010	Field 110-115V	1	-,-	1	48
808	1 617 014 110	Carbon-Brush Set	1	-,-	1	28
809	1 617 031 014	Parts Set	1	-,-	1	55
810	1 616 110 029	Eccentric Cog Wheel Z=36	1	-,-	1	58
811	1 616 333 016	Bevel Gear Z=28	1	-,-	1	42
812	1 617 000 059	Pole housing	1	-,-	1	28
816	1 617 000 091	Parts Set	1	-,-	1	44