

Universal Rotary Hammer - 0 611 214 734 - 11214 VS

www.powertools-aftersaleservice.com



BOSCH

Item	Part Number	Description	Illustration	Price	Quantity	Price Group
2	1 614 220 091	Field 110-115V	1	-,-	1	43
4	1 617 200 040	On-Off Switch	1	-,-	1	38
5	1 604 460 092	Power supply cord USA/CDN 2,15m 2 x 2,08mm SJ 14/2	1	-,-	1	28
6	1 610 703 053	Grommet Ø9,7-Ø12x89 MM	1	-,-	1	13
6	3 600 703 011	Grommet Ø9,2-Ø12x120 MM	1	-,-	1	13
7	1 611 034 019	Fastening Clamp	1	-,-	1	11
9	1 611 110 484	Manufacturer's nameplate	1	-,-	1	16
13	1 610 905 009	groove ball bearing 9x26x8	1	-,-	1	27
14	1 610 905 008	groove ball bearing 12x32x10	1	-,-	1	29
15	1 616 610 067	Fan	1	-,-	1	16
16	1 611 110 485	Manufacturer's nameplate	1	-,-	1	18
17	1 610 500 013	Friction Washer	1	-,-	1	13
18	1 610 210 040	O-Ring 16,0x5,0 MM	1	-,-	1	11
20	1 618 597 054	Toolholder	2	-,-	1	-
21	1 613 124 014	Locking Bolt	2	-,-	1	-
22	1 610 506 006	Guide Bushing	2	-,-	1	-
23	1 614 616 002	Compression Spring	2	-,-	1	-
24	1 610 320 002	Guide Bushing	2	-,-	1	-
26	1 618 598 150	Bit holder Ø 19 MM	1	-,-	1	49
27	1 610 103 018	Stop Disc Ø 26 MM	1	-,-	1	24
28	1 610 113 011	Supporting Disc	1	-,-	1	13
30	1 610 523 001	Damping Bushing	1	-,-	1	23
31	1 610 309 002	Damping Bushing	1	-,-	1	13
32	1 610 101 616	Supporting Disc 1,5 MM THICK	1	-,-	2	11
33	1 616 317 031	Cylindrical Gear Z=57/8	1	-,-	1	38
34	1 615 806 073	Hammer Pipe	1	-,-	1	47
35	1 618 710 048	Striker	1	-,-	1	30
36	1 614 616 005	Compression Spring	1	-,-	1	14
37	1 618 700 053	Hammer Piston	1	-,-	1	33
38	1 615 190 010	Covering hood	1	-,-	1	30
39	1 611 015 030	Sealing Frame	1	-,-	1	16
40	1 615 808 059	Bearing cover	1	-,-	1	30
41	1 613 219 001	Piston Pin	1	-,-	1	21

Item	Part Number	Description	Illustration	Price	Quantity	Price Group
42	1 614 336 005	Brush Holder	1	-,-	1	24
43	1 615 808 068	Bearing cover BLUE	1	-,-	1	30
44	1 611 015 032	Frame	1	-,-	1	12
45	1 615 133 027	Handle BLACK	1	-,-	1	37
46	1 615 500 269	Handle Cover BLACK	1	-,-	1	38
48	1 616 333 018	Bevel Gear Z=35	1	-,-	1	38
49	1 615 819 011	Drive bearing	1	-,-	1	43
52	1 615 820 086	Bearing Flange	1	-,-	1	38
53	1 611 015 031	Sealing Frame	1	-,-	1	18
56	1 613 060 012	Toothed Shaft Z=10	1	-,-	1	31
59	1 610 591 010	Plug	1	-,-	1	11
60	1 612 026 022	Clamp Handle	1	-,-	1	23
61	2 917 550 138	Straight Pin 5M6x70 RIKO DIN 6325	1	-,-	1	15
62	1 614 680 003	Holding Spring	1	-,-	1	11
63	1 611 329 008	Control Fork	1	-,-	1	24
64	1 610 102 620	Supporting Disc 1,0 MM THICK	1	-,-	1	14
65	1 610 101 617	Supporting Disc 2,5 MM THICK	1	-,-	1	13
66	1 610 101 615	Supporting Disc 0,5 MM THICK	1	-,-	2	13
68	1 610 101 618	Shim 0,3 MM THICK	1	-,-	1	11
68	1 610 101 621	Shim 0,1 MM THICK	1	-,-	1	11
72	1 615 500 284	Sealing cap BLUE	1	-,-	2	13
73	1 610 210 082	Clamping Ring	1	-,-	1	12
74	1 614 652 000	Spiral Spring	1	-,-	2	12
75	1 615 190 011	Socket Housing	1	-,-	1	12
76	1 614 443 005	Connecting Cable L=150 MM BLUE	1	-,-	1	14
77	1 614 443 004	Connecting Cable L=125 MM GRAY	1	-,-	1	14
78	1 614 431 022	Connecting Cable L=35 MM WHITE	1	-,-	2	12
80	1 617 233 007	Control device 100-115V	1	-,-	1	44
81	1 614 616 007	Compression Spring	1	-,-	1	12
82	1 614 616 006	Compression Spring	1	-,-	1	11
84	1 602 025 07H	Auxiliary Handle	2	-,-	1	23
84	1 612 025 019	Auxiliary Handle M8	2	-,-	1	19
85	1 618 040 076	Support clamp	2	-,-	1	31
86	1 613 521 003	Stud bolt M8	2	-,-	1	23
87	1 611 316 003	Clamping Band Ø43 MM	2	-,-	1	13
88	1 613 100 012	Straight Pin	2	-,-	1	11
89	1 613 480 009	Wing Screw M6x25 MM	2	-,-	1	11
90	1 613 300 006	Hex Nut M6	2	-,-	1	11
91	1 611 030 009	Clamping Plate	2	-,-	1	14
92	2 917 550 118	Straight Pin 5M6x12 RIKO DIN 6325	1	-,-	1	11
98	1 610 900 023	groove ball bearing	1	-,-	1	24
99	1 610 910 068	Needle bearing	1	-,-	2	23
100	2 600 910 001	Needle-Roller Bearing Ø14 MM	1	-,-	2	16
101	2 600 910 000	Needle bearing	1	-,-	1	18
103	2 916 690 007	Spring Lock Washer DIN 128-A8-FST	1	-,-	5	10
105	1 614 601 004	Retaining ring	1	-,-	1	11
108	1 900 210 104	O-Ring 8x2 MM	1	-,-	1	11
110	1 600 210 004	O-Ring 54,0x3,0 MM	1	-,-	1	12
111	1 610 210 078	O-Ring 26,0x3,0 MM	1	-,-	2	13
112	1 610 210 079	O-Ring 22,0x4,0 MM	1	-,-	1	16
113	1 610 210 080	O-Ring 27,5x10,5 MM	1	-,-	1	19
114	1 610 210 077	O-Ring 41,0x3,0 MM	1	-,-	1	12
115	1 610 210 081	O-Ring 10,0x1,0 MM	1	-,-	1	15

Item	Part Number	Description	Illustration	Price	Quantity	Price Group
117	2 910 141 262	Hex Socket Head Cap Screw DIN 912-M8x80-8.8	1	-,-	3	10
118	2 910 141 244	Hex Socket Head Cap Screw DIN 912-M8x25-8.8	1	-,-	2	11
120	2 910 211 038	Tapping Screw DIN 7971-ST4,8x38-F	1	-,-	2	11
122	1 603 435 008	Tapping Screw BZ4,8x63 MM	1	-,-	2	11
123	2 910 211 236	Tapping Screw DIN 7971-ST4,8x25-C	1	-,-	4	10
125	2 910 601 118	Tapping Screw DIN 7972-B3,9x13	1	-,-	2	10
126	2 910 211 011	Tapping Screw DIN 7971-BZ3,5x13	1	-,-	8	10
128	2 910 021 118	Socket head cap screw DIN 84-AM4x8-8.8	1	-,-	2	10
129	2 603 410 001	Socket head cap screw M3x6,5-4.8	1	-,-	2	11
130	1 601 110 449	Nameplate CAUTION	1	-,-	1	11
149	1 610 108 014	Felt Disc	1	-,-	1	14
650	1 615 438 132	Carrying Case	2	-,-	1	-
655/10	1 610 508 014	Protective Cap	2	-,-	3	-
655/10	1 610 508 001	Sealing cap Ø15xØ27,5x36 MM	2	-,-	3	-
655/20	1 610 508 013	Protective Cap	2	-,-	2	-
655/20	1 610 508 009	Protective Cap	2	-,-	2	-
801	1 617 000 938	Assembly Of Service Parts	1	-,-	1	52
810	1 617 014 120	Carbon-Brush Set	1	-,-	1	32
819	1 617 000 123	Hex Socket Head Cap Screw DIN 912-M6x25-10.9	1	-,-	1	17
820	1 617 000 913	Tool Holder Set	1	-,-	1	50
821	1 617 000 014	Locking Bolt Set	1	-,-	1	33
830	1 614 011 039	Armature 100-115V	1	-,-	1	52
850	1 617 000 927	Parts Set	1	-,-	1	44
879	1 613 001 008	Depth-Gauge SW 6x330 MM	2	-,-	1	21
880	1 617 000 160	Modification Set 100-115V	1	-,-	1	45
884	1 612 025 039	Auxiliary Handle	2	-,-	1	37
888	1 601 11A 3H3	Nameplate	1	-,-	1	13
894	1 617 000 169	Needle-Roller Assembly	1	-,-	1	19
895	1 610 101 008	Thrust Bearing Disc 1,0 MM THICK	1	-,-	1	11
897	1 617 000 181	Wear and Tear Part Set	1	-,-	1	35
898	1 617 000 182	Wear and Tear Part Set	1	-,-	1	38
899	1 610 910 068	Needle bearing	1	-,-	1	23

Illustration - Type E

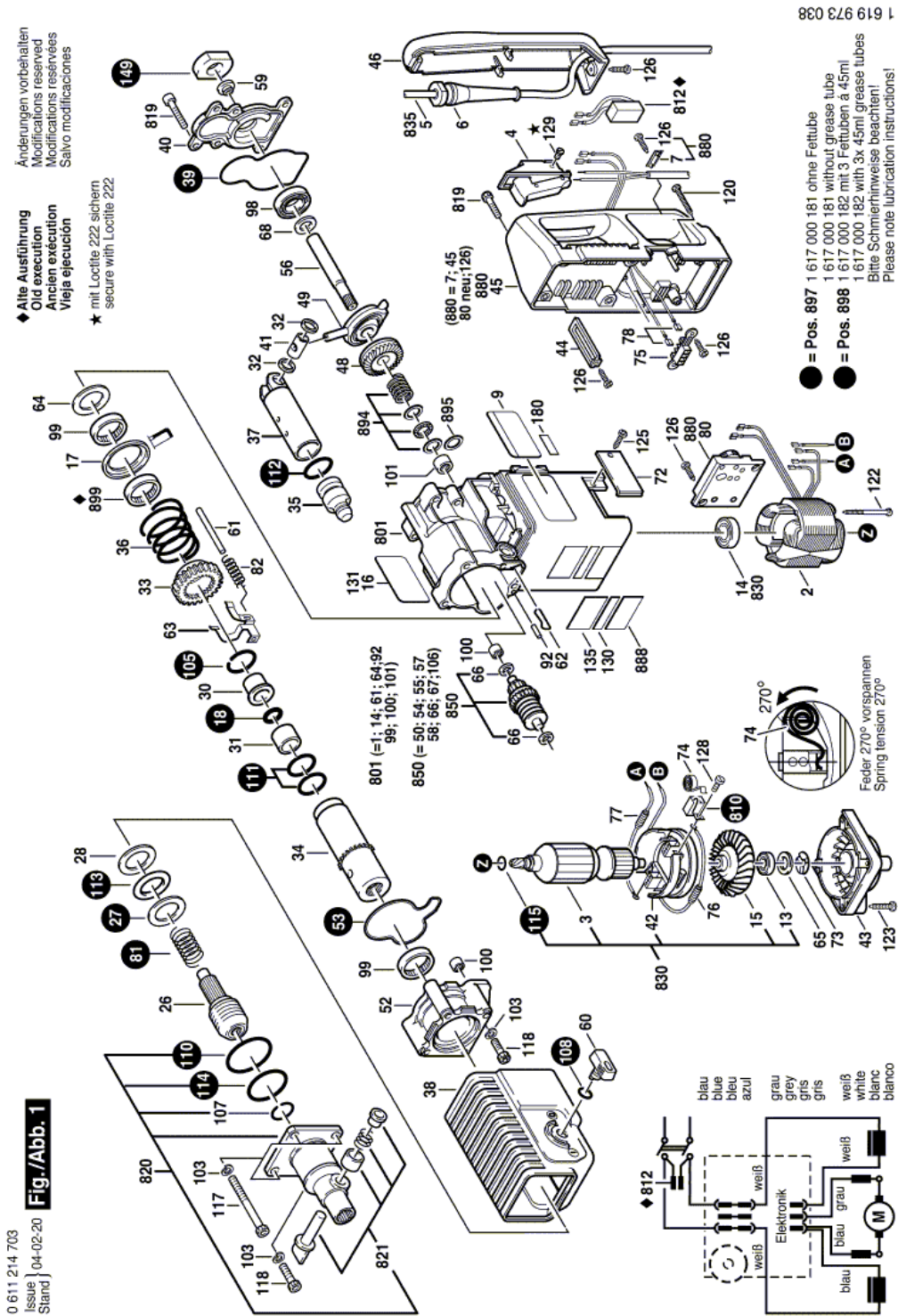

860 826 616 1

Illustration - Type E

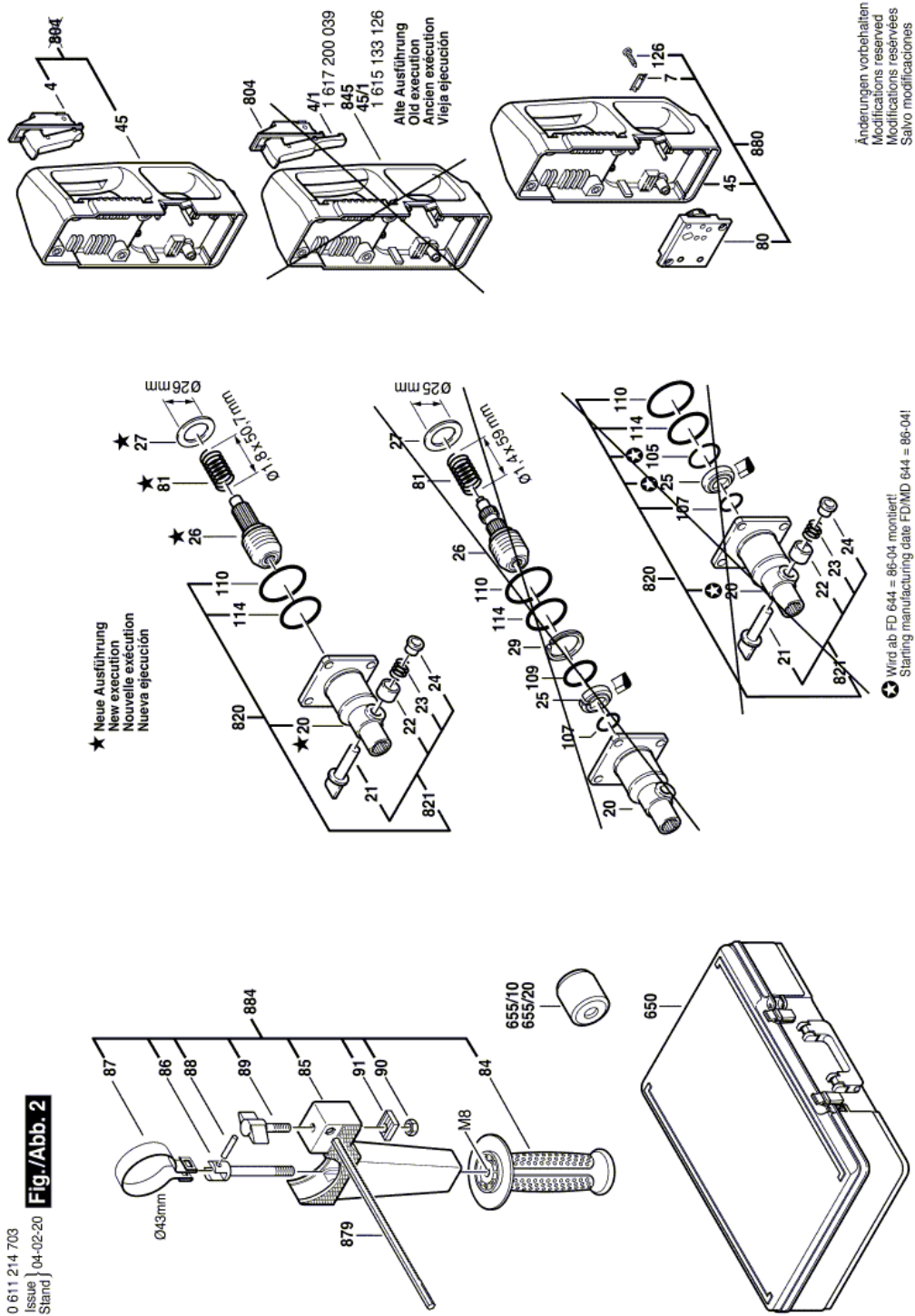

Information subject to change without further notice.