



# SERVICE PARTS LIST

**BUL. 54-08-2220**

## 1/2" ELECTRIC DRILL

REVISED BUL 6134-1      DATE FEB. '68

**Catalog No. 1200-1**

Starting Serial No. **134-1001**

WIRING INSTR.

Both Model and Serial No. must be furnished to obtain correct parts.

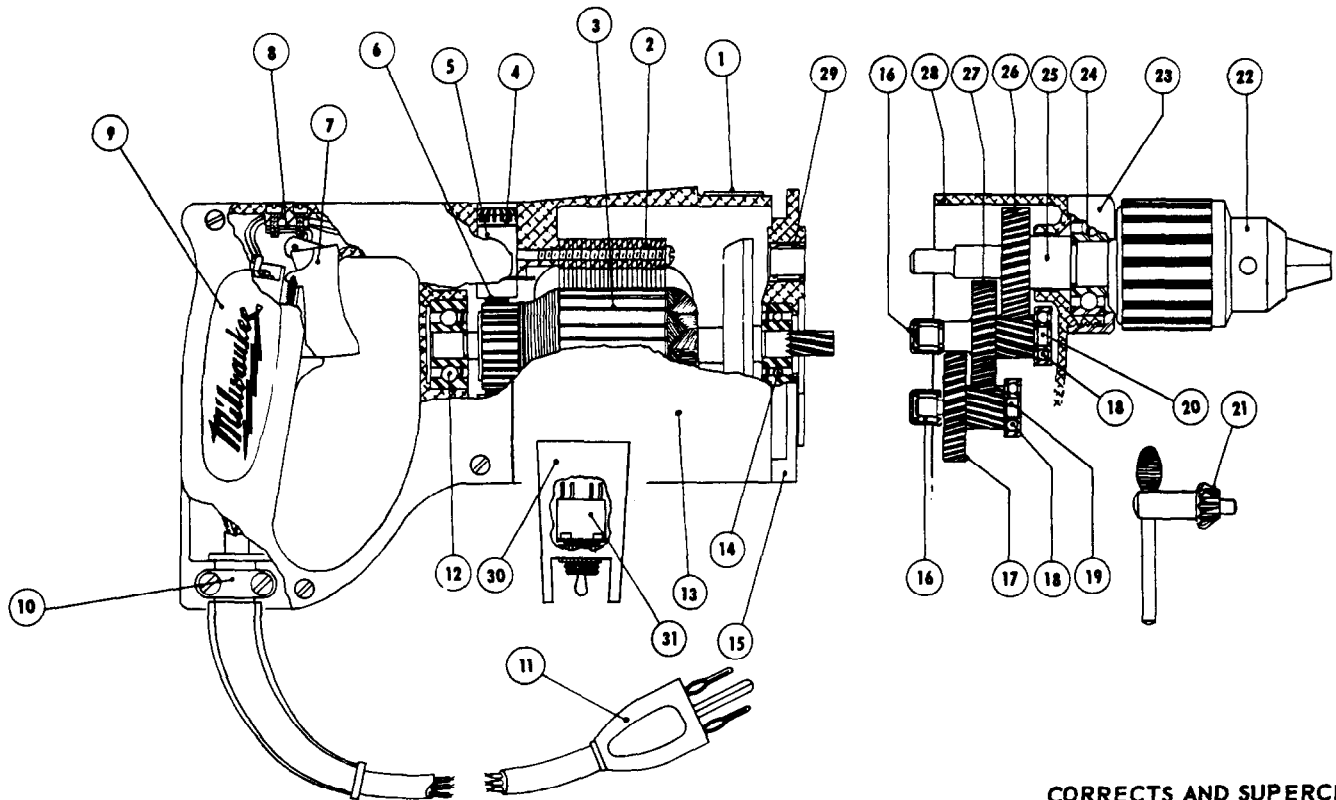

**CORRECTS AND SUPERCEDES  
SERVICE BULLETIN 6134-1  
DATED 9/15/58**

**FIG. PART NO. DESCRIPTION OF PART**

1	12-98-0800	Name Plate
2	18-42-1041	Field Assembly
3	16-42-1210	Armature Assembly
4	23-44-0060	Brush Retaining Screw
5	22-22-0080	Brush Holder Assembly
6	22-18-0100	Carbon Brush Assembly
7	23-66-0230	Switch
8	45-36-0110	Switch Spacer
9	28-20-3141	Handle Cover
10	28-17-0400	Cord Clamp Strap
11	22-64-0170	Cord Set
12	02-04-0970	Ball Bearing (Comm. End)
13	28-50-4482	Motor Housing
14	02-04-0940	Ball Bearing (Pinion End)
15	28-28-0661	Diaphragm
16	02-50-1640	Ball Bearing

**ILLUSTRATED PARTS**

FIG.	PART NO.	DESCRIPTION OF PART
17	32-40-1241	Intermediate Gear
18	02-04-0640	Ball Bearing
19	36-66-2801	Intermediate Pinion Shaft
(2)	20	36-66-2401 Intermediate Pinion Shaft
(2)	21	48-66-3280 Chuck Key
(2)	22	48-66-1360 Chuck (1/2-20 Thread 3-Jaw)
23	42-52-0071	Bearing Cap
24	02-04-1560	Ball Bearing
25	38-50-3651	Spindle
26	32-75-1861	Spindle Gear
27	32-75-2041	Spindle Gear
28	28-14-0961	Gear Case
29	02-50-2110	Needle Bearing
30	28-50-7031	Reverse Switch Housing
31	23-66-0220	Reverse Switch

**MISCELLANEOUS PARTS NOT SHOWN**

PART NO.	DESCRIPTION OF PART
43-62-0160	Handle
44-90-0130	Handle Ring
06-42-0800	Woodruff Keys
06-81-8400	4-40x1/4 Rd.Hd. Name Plate Screws
06-81-5800	6-32x5/16 Fil.Hd. Sems Switch Mounting Scs.
23-86-0110	Brush Holder Insul. Washer
23-16-0050	Switch Insulator
48-03-0010	Attachment Plug Adaptor

PART NO.	DESCRIPTION OF PART	
06-81-6150	8-32x1/2" Fil.Hd.Sems Cord Clamp Strap Screws	(2)
06-81-8625	6-32x1/4" Rd.Hd. Ground Screw (Brass)	
(3)	06-81-6350 8-32x1 Fil.Hd. Sems Gear Case Screws	
(2)	06-81-6650 8-32x1 3/4 Fil.Hd. Sems Gear Case Screws	(2)
(2)	06-81-6600 8-32x1 3/4 Fil.Hd. Sems Field Screws	(2)
(2)	06-83-2650 1/4-20x3/8 Hd'less Brush Holder Set Screws	(2)
(4)	06-81-3700 8-32x7/8 Oval. Hd. Handle Cover Screws	(4)

Numbers in brackets indicate number required.