



SERVICE PARTS LIST

BUL. 54-08-5000

POWER PAC

REVISED BUL 6231-1 DATE May '68

Catalog No. 1300

Starting Serial No. **231-1001**

WIRING INSTR. **58-01-0250**

Both Model and Serial No. must be furnished to obtain correct parts

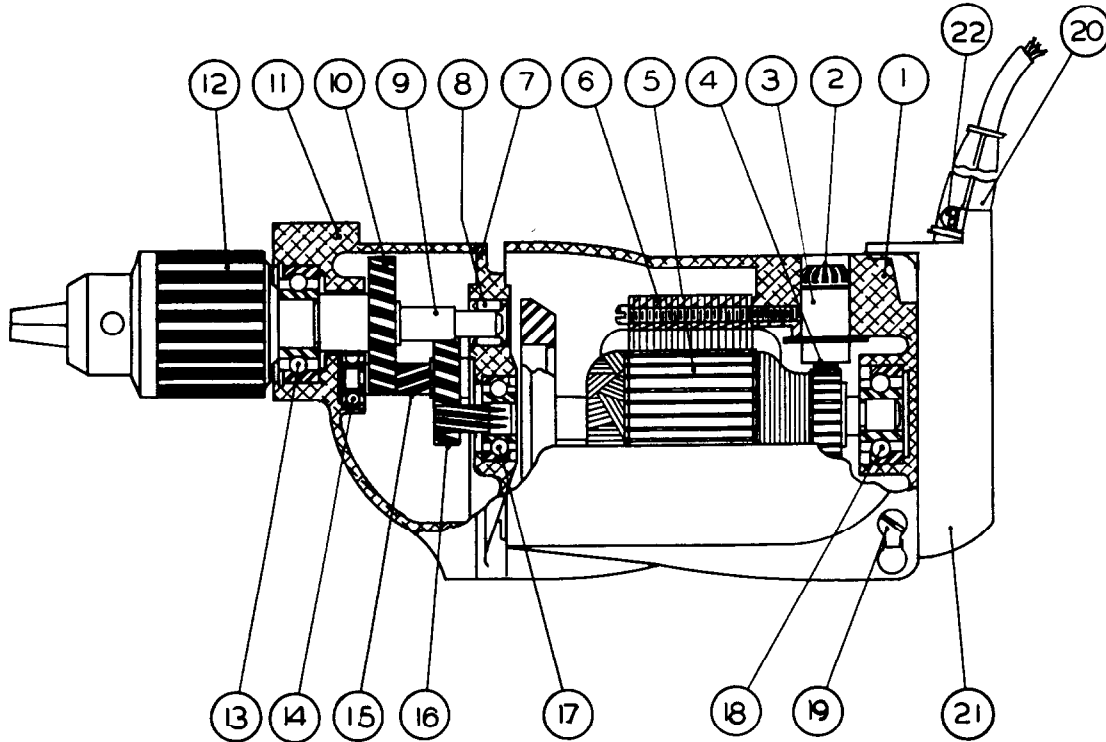

ILLUSTRATED PARTS

FIG. 1	PART NO. 28-50-4642	DESCRIPTION OF PART Motor Housing		FIG. 13	PART NO. 02-04-1560	DESCRIPTION OF PART Spindle Ball Bearing
2	23-44-0060	Brush Retaining Screw (2)		14	02-04-0640	Int. Shaft Ball Bearing
3	22-22-0080	Brush Holder Assembly (2)		15	36-66-2451	Int. Pinion Shaft
4	22-18-0100	Carbon Brush Assembly (2)		16	32-40-1241	Intermediate Gear
5	16-42-1040	Armature Assembly		17	02-04-0940	Ball Bearing (Pinion End)
6	18-42-1160	Field Assembly		18	02-04-0970	Ball Bearing (Comm. End)
7	28-28-0581	Diaphragm		19	42-70-0080	Key Clip
8	02-50-2110	Needle Bearing		20	22-64-0170	Cord Set
9	38-50-2551	Spindle		21	28-50-1381	Cord Set Housing
10	32-75-1881	Spindle Gear		22	28-17-0400	Cord Clamp
11	28-14-0761	Gear Case				
*12	48-66-0300	Chuck				

MISCELLANEOUS PARTS NOT SHOWN

PART NO. 02-50-1640	DESCRIPTION OF PART Needle Bearing	PART NO. 23-86-0110	DESCRIPTION OF PART Brush Holder Insulating Washer (2)
12-98-0800	Name Plate	*48-66-3200	Chuck Key
06-42-0800	Woodruff Keys	06-81-4300	3-48x3/16 Rd.Hd. Name Plate Screws (2)
*06-81-6150	8-32x1/2 Fil.Hd. Cord Clamp Screw (2)	06-81-6350	8-32x1 Fil.Hd. Sems Gear Case Screws
06-81-7150	10-24x1-3/8 Fil.Hd. Sems Cord Hsg. Scs. (2)	06-81-8625	6-32x1/4 Brass Rd.Hd. Ground Sems
06-81-8650	6-32x1/4 Rd.Hd. Sems Key Clip Screw	06-81-6650	8-32x1-3/4 Fil.Hd. Sems Gear Case Scrs. (2)
*06-42-1200	Woodruff Key	*34-80-2500	Retaining Ring
06-81-6600	8-32x1-3/4 Fil. Hd. Field Screw (2)	06-83-2650	1/4-20x3/8 Hd'less Brush Holder Set Screw(2)