



SERVICE PARTS LIST

1/2" ELECTRIC DRILL

Catalog No. 1650-1

Starting Serial No. 142-16466

Specify Catalog and Serial No. when ordering parts

BUL.54-10-2026

REVISED BUL.
54-10-2025

DATE
Dec. '73

WIRING INSTRUCTIONS
58-01-0530

450 R.P.M.

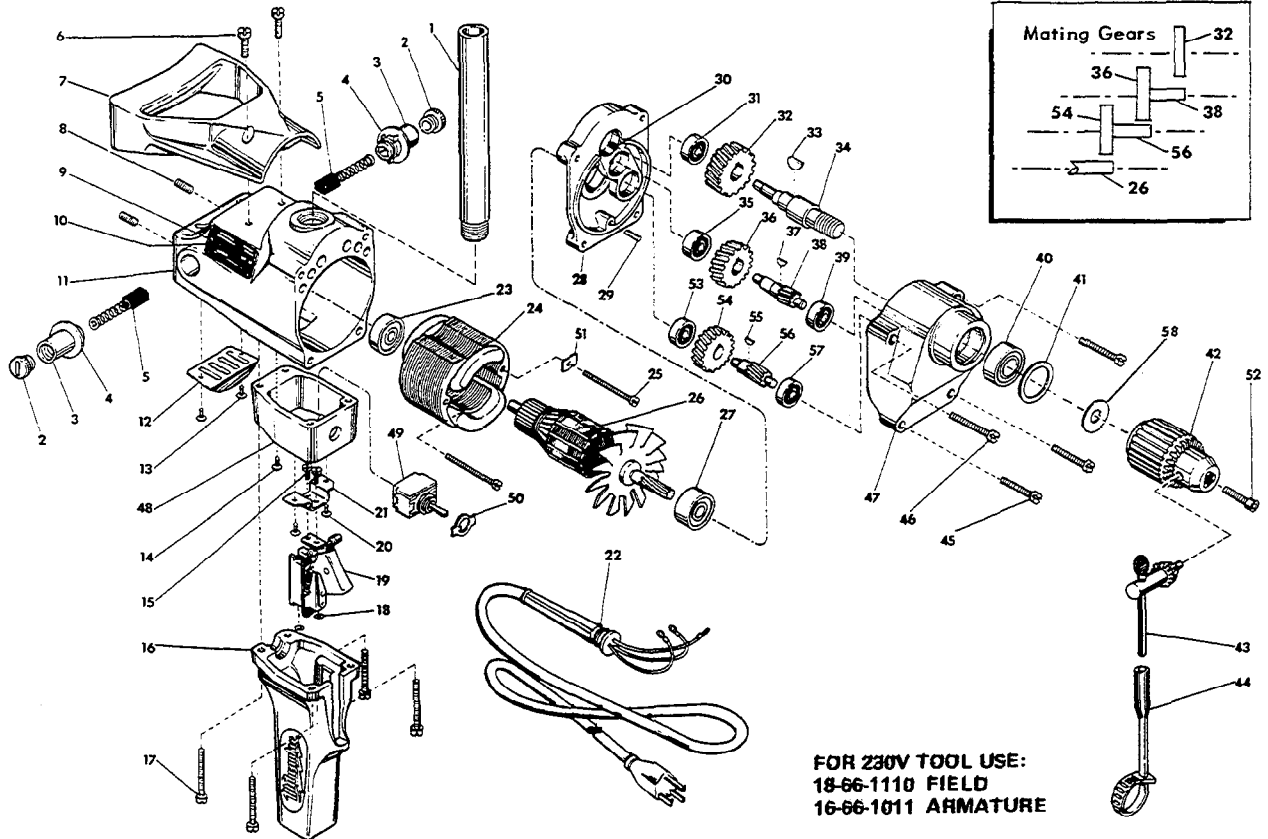

**FOR 230V TOOL USE:
18-66-1110 FIELD
16-66-1011 ARMATURE**

FIG.	PART NO.	DESCRIPTION OF PART	NO. REQ.
1	43-62-0230	Pipe Handle	
2	23-44-0065	Brush Retaining Screw	(2)
3	22-22-0120	Brush Holder	(2)
4	23-86-0130	Washer	(2)
5	22-18-0170	Carbon Brush	(2)
6	06-81-7500	12-24x5/8 Fil. Hd. Sem	(2)
7	28-44-7041	Spade Handle	
8	06-83-2670	1/4-20x1/2 Knrl. Set Screw	(2)
★ 9	06-85-0200	6x1/4 Rd. Hd. T Type Z Screw	(2)
★ 10	12-99-0010	Nameplate	
11	28-50-4646	Motor Housing	
12	44-66-0140	Cover Plate	
13	06-81-8650	6-32x1/4 Rd. Hd. Sem	(2)
14	06-81-8625	6-32x1/4 Ground Screw	
15	06-81-5800	6-32x5/16 Fil. Hd. Sem	(2)
16	28-44-9121	Switch Handle	
17	06-81-7590	12-24x1-3/4 Fil. Hd. Sem	(4)
18	06-97-1800	Lock Washer	(4)
19	23-66-0190	Switch	
20	06-81-8650	6-32x1/4 Rd. Hd. Sem	(2)
21	42-36-0180	Switch Bracket	
22	22-64-0170	Cord Set	
23	02-04-0970	Ball Bearing	
24	18-62-1110	115 Volt Field	
25	06-81-6700	8-32x1-7/8 Fil. Hd. Sem	(2)
26	16-62-1150	115 Volt Armature	
27	02-04-1070	Ball Bearing	
28	28-28-0701	Diaphragm (Includes Fig. 29 & 30)	
29	06-65-0625	3/16x1/2 Groove Pin	

FIG.	PART NO.	DESCRIPTION OF PART	NO. REQ.
30	45-30-0060	Brg. Retaining Slug	(3)
31	02-04-0820	Ball Bearing	
32	32-75-2701	Spindle Gear	
33	06-42-2000	Woodruff Key	
★ 34	38-50-2661	Spindle	
35	02-04-0820	Ball Bearing	
36	32-44-1161	Intermediate Gear	
37	06-42-0800	Woodruff Key	
38	36-66-2252	Intermediate Shaft	
39	02-04-0820	Ball Bearing	
40	02-04-1650	Ball Bearing	
41	34-80-2500	Retaining Ring	
42	48-66-1380	1/2" Reversing Chuck	
43	48-66-3280	Chuck Key	
44	48-66-4040	Key Holder	
45	06-81-7450	10-32x1-3/16 Fil. Hd. Sem	(2)
46	06-81-7460	10-32x1-7/16 Fil. Hd. Sem	(2)
47	28-14-0762	Gear Case	
48	28-50-7081	Reversing Switch Housing	
49	23-66-0198	Switch	
50	22-75-0055	Switch Dial	
51	42-68-0090	Clamp	
52	06-75-3150	1/4-20x1 Skt. Cap Screw	
53	02-04-0820	Ball Bearing	
54	32-42-1221	Intermediate Gear	
55	06-42-0800	Woodruff Key	
56	36-66-2201	Intermediate Shaft	
57	02-04-0820	Ball Bearing	
★ 58	45-88-0365	Chuck Spacer Washer	
★ 59	12-98-7081	Caution Plate (Not Shown)	