



# SERVICE PARTS LIST

BUL. 54-12-4011

7/8" ELECTRIC DRILL

REVISED BUL. 668-2 DATE FEB. '68

MODEL NO. **K-783**

Starting Serial No. **68-1100**

WIRING INSTR.

Both Model and Serial No. must be furnished to obtain correct parts.

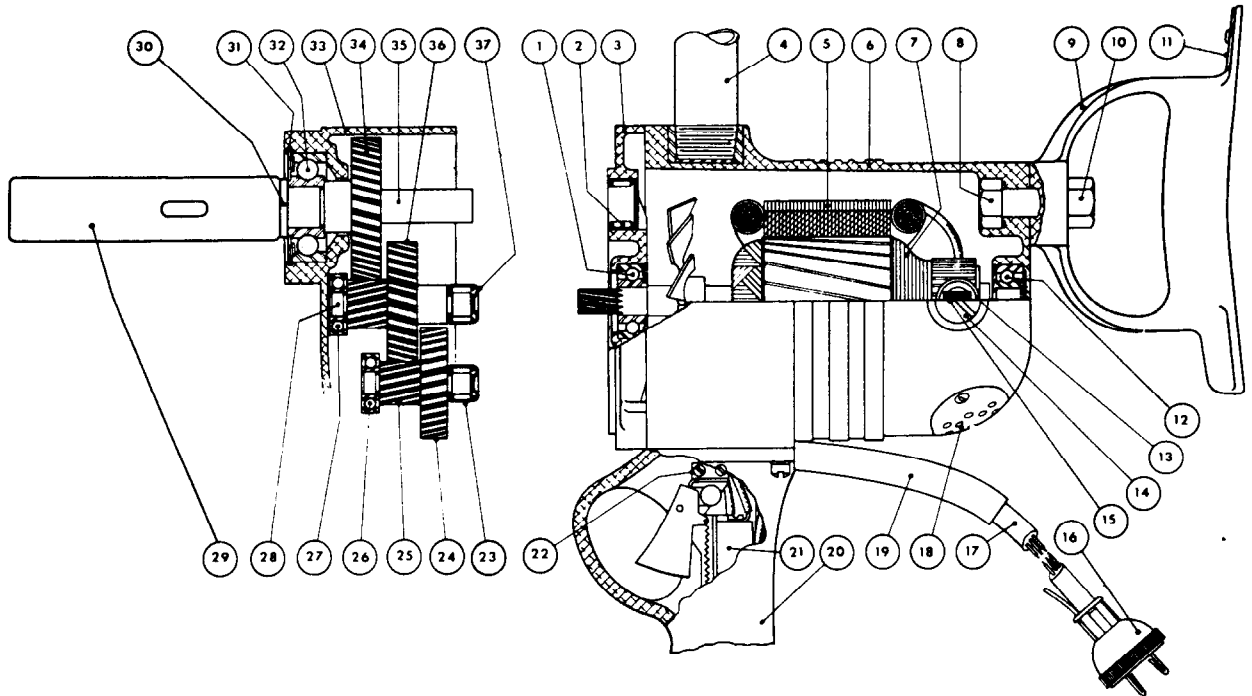

ILLUSTRATED PARTS

Fig. Part No.	Name of Part	Fig. Part No.	Name of Part
1	WC8011 Armature Ball Brg. (Pinion End)	20	88D1-1A Switch Handle
2	MH-1081 Spindle Needle Bearing	21	CH8636K1 Switch
3	3D-2 Diaphragm	22	88D-23 Switch Bracket
4	88D-43 Pipe Handle	23	MH681 1st Inter. Shaft Needle Bearing
5	56V-700 Field Assembly	24	89D-14 1st Inter. Gear
6	23D-1 Motor Housing	25	3D-131 1st Inter. Pinion Shaft
7	3D-600A Armature Assembly	26	ND7039 1st Inter. Shaft Ball Bearing
8	1/2"-13x1-1/2" Spade Handle Bolt (Hex Hd.)	27	ND7039 2nd Inter. Shaft Ball Bearing
9	88D1-3A Spade Handle	28	3D-132 2nd Inter. Pinion Shaft
10	1/2"-13 Spade Handle Jam Nut	29	#2 Morse Taper Socket
11	88D1-6 Spade Handle Key Clip	30	88D-16 Chuck Washer
12	WC8500 Armature Ball Brg. (Comm. End)	31	RR-185 Spindle Ball Brg. Retg. Ring
13	88D-320 Brush Holder Assembly	32	ND8603 Spindle Ball Bearing
14	88D-400 Brush Retaining Screw Assembly	33	3D-3 Gear Case
15	88D-370 Carbon Brush Assemblies (set 2)	34	78K-11 Spindle Gear
16	2 Prong Attachment Plug	35	3D-8 Spindle
17	S#16-3 Cord (3-Wire) (per Ft.)	36	78K-11 2nd Intermediate Gear
18	23D-41 Air Intake Cover Plate	37	MH681 2nd Intermediate Shaft Needle Brg.
19	88D-48 Cord Protector Tube		

MISCELLANEOUS PARTS (NOT SHOWN)

Size or Part No.	Description of Part	Size or Part No.	Description of Part
K-783	Name Plate	1/4"-20x1/2" Hdless	Brush Holder Set Screws (2)
#2	Drift	6-32x1/4" Rd. Hd.	Brass Ground Wire Screws (1)
#4x5/16" Driv-In	Spade Handle Key Clip	#8	Kantlink Lock Washers (2)
6-32x1/4" Rd. Hd.	Switch Mounting Screws (2)	#14	Kantlink Lock Washers (10)
6-32x1/4" Fil.Hd.	Switch Bracket Screws (2)	#2	Woodruff Key (1)
#4x5/16" Driv-In	Name Plate Screws (2)	#3	Woodruff Keys (2)
#6x1/4" P.K.	Air Intake Plate Screws (2)	1/2" Cap.	Chuck (5/8-16 Thread)
1/4"-20x1/4" Fil.Hd.	Gear Case Screws (2)	5/8" Cap.	Chuck (5/8-16 Thread)
1/4"-20x1-3/4" Fil.Hd.	Gear Case Screws (2)	3/4" Cap.	Chuck (5/8-16 Thread)
8-32x2-1/2" Rd. Hd.	Field Screws (2)	1/2" & 5/8"	Chuck Key
1/4"-20x3/4" Fil.Hd.	Switch Handle Screws (4)	3/4"	Chuck Key

Prices are subject to change without notice.