



SERVICE PARTS LIST

BULLETIN NO.
54-30-0401

SPECIFY CATALOG NO. AND SERIAL NO. WHEN ORDERING PARTS

MAG STAND CONTROL PANEL 23-35-0252

REVISED BULLETIN	DATE
	Jan. '87
WIRING INSTRUCTION SEE BELOW	

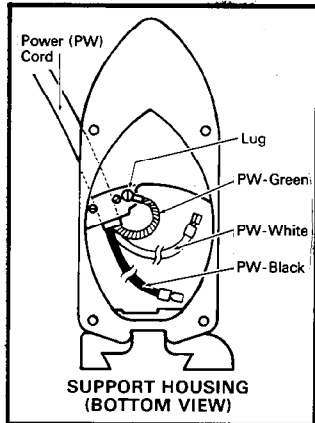
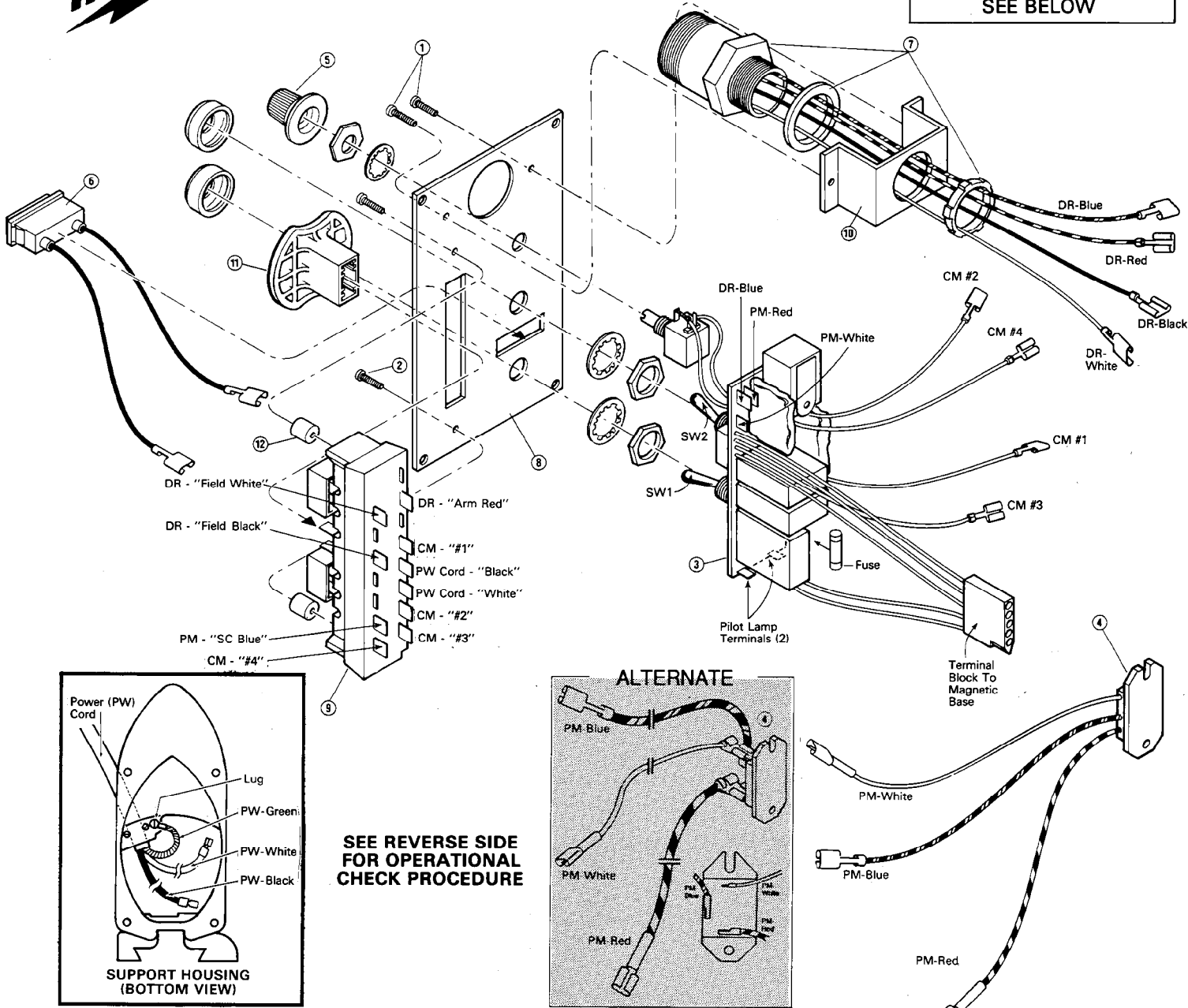

**SEE REVERSE SIDE
FOR OPERATIONAL
CHECK PROCEDURE**

WIRING PROCEDURE:

1. Wire Nos. CM-1, CM-2, CM-3 and CM-4 from Control Module (fig. 3) fasten to correspondingly numbered terminals on back of Drill Switch Assembly (fig. 9).
2. DR-Black, DR-White and DR-Red wires from Drill Receptacle Assembly (fig. 7) fasten, respectively, to "Field Black", "Field White" and "Arm Red" terminals on back of Drill Switch Assembly (fig. 9).
3. DR-Blue wire from Drill Receptacle Assembly (fig. 7) fastens to DR-Blue terminal, as shown, on Control Module (fig. 3).
4. PM-Blue wire from Power Module (fig. 4) fastens to "SC Blue" terminal on back Switch Assembly (fig. 9).
5. PM-Red and PM-White wires from Power Module (fig. 4) fasten, respectively to PM-Red and PM-White terminals, as shown, on Control Module (fig. 3).
6. Black wires from Pilot Lamp (fig. 6) fasten to "Pilot Lamp" terminals on Control Module (Fig. 3).
7. "Power Cord" Black and White lead wires fasten to corresponding labeled "PW Cord" (Black/White) terminals on back of drill switch assembly (Fig. 9). Power Cord Green wire fastens to lug on the bottom/inside of the Support Housing (See Insert Above).

FIG.	PART NO.	DESCRIPTION OF PART	NO. REQ.
1	06-85-0400	6-20 x 3/4 Type 25 Phillips Pan Hd. Screw	2
2	06-85-0410	6-20 x 3/4 Pan Hd. Plastite Screw	2
3	14-20-0012	Control Module Includes:	
	22-89-0160	Slo-Blo Fuse	1
4	14-20-0212	Power Module	1
5	23-18-0080	Drill Speed Control Knob	1
6	23-26-0080	Pilot Lamp Assembly	1
7	23-33-0230	Drill Receptacle Assembly (Socket, rubber washer and nut)	1
8	23-35-0260	Panel Blank	1
9	23-66-0936	Drill Switch Assembly	1
10	42-36-0410	Receptacle Mounting Bracket	1
11	42-42-0270	Switch "OFF" Button	1
12	45-36-0770	Switch Spacer	2

MILWAUKEE ELECTRIC TOOL CORPORATION
13135 W. LISBON RD., BROOKFIELD, WIS. 53005