

JLH Series Lever Hoists (JLH-80/100/160/250/320/630/900)

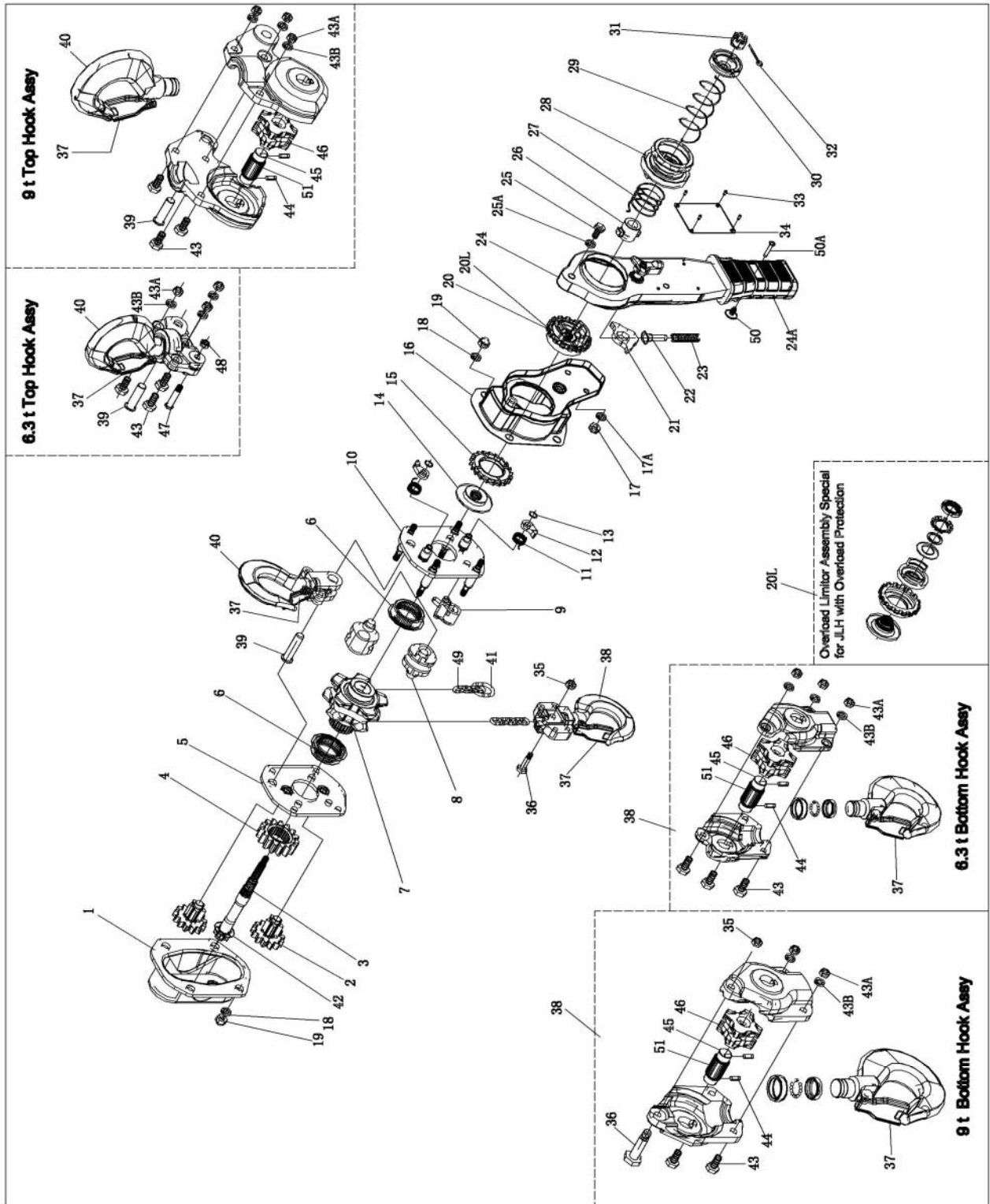

Parts List: JLH-320 (3.2 Ton)

Parts listed under each assembly are parts that make up that assembly.

Index No.	Part No.	Description	Size	Qty
1	JLH320-1	Gear Case Assembly (3.2, 6.3, 9 Ton)		1
		Gear Case		1
		Bushing		3
		Cover Plate		1
2	JLH320-2	Spur Gear Assembly (3.2, 6.3, 9 Ton)		2
		Spur Gear		2
		Pinion Gear		2
3	JLH320-3	Driving Shaft (3.2, 6.3, 9 Ton)		1
	JLH320-3-1	Driving Shaft (3.2, 6.3, 9 Ton) <i>(models from 02-01-2009 and forward)</i>		1
4	JLH320-4	Load Gear (3.2, 6.3, 9 Ton)		1
5	JLH320-5	Gear Side Plate Assembly (3.2, 6.3, 9 Ton)		1
		Gear Side Plate		1
		Bushing		2
6	JLH320-6	Caged Roller Bearings (3.2, 6.3, 9 Ton)	Ø40xØ50x15mm	2
7	JLH320-7	Load Sheave (3.2, 6.3, 9 Ton)		1
8	JLH320-8	Guide Roller (3.2, 6.3, 9 Ton)		2
9	JLH320-9	Stripper (3.2, 6.3, 9 Ton)		1
10	JLH320-10	Lever Side Plate Assembly (3.2, 6.3, 9 Ton)		1
		Lever Side Plate		1
		Stay Bolt		4
		Pawl Pin		2
11	JLH320-11	Pawl Spring (3.2, 6.3, 9 Ton)		2
12	JLH320-12	Pawl (3.2, 6.3, 9 Ton)		2
13	JLH320-13	Snap Ring (3.2, 6.3, 9 Ton)	Ø 10mm	2
14	JLH320-14	Disc Hub (3.2, 6.3, 9 Ton)		1
15	JLH320-15	Ratchet Disc (3.2, 6.3, 9 Ton)		1
16	JLH320-16	Brake Cover Assembly (3.2, 6.3, 9 Ton)		1
		Brake Cover		1
		Handle Case		1
		Bushing		1
		Thread Housing		1
17	JLH320-17	Hex Nut (3.2, 6.3, 9 Ton)	M8	2
17A	JLH320-17A	Lock Washer (3.2, 6.3, 9 Ton)	8mm	2
18	JLH80-18	Lock Washer (0.8 to 9 Ton)	8mm	8
19	JLH80-19	Acorn Nut (0.8 to 9 Ton)	M8	8
20	JLH320-20	Change Over Gear (3.2, 6.3, 9 Ton)		1
	JLH320-20-1	Change Over Gear (3.2, 6.3, 9 Ton) <i>(models from 02-01-2009 and forward)</i>		1
20L	JLH320-20L	Overload Limiter Assembly (For JLH-320WO-10 only)		1
	JLH320-20L-1	Overload Limiter Assembly (For JLH-320WO-10 only) <i>(models from 02-01-2009 and forward)</i>		1
		Overload Limiting Plate		1
		Change Over Gear		1
		Pressure Plate		1
		Dish Spring		1
		Adjusting Nut	M22x1.25-7H	1
21	JLH320-21	Change Over Pawl (3.2, 6.3, 9 Ton)		1
22	JLH320-22	Spring Shaft (3.2, 6.3, 9 Ton)		1
23	JLH320-23	Spring (3.2, 6.3, 9 Ton)		1
24	JLH320-24	Lever Handle Assembly (3.2, 6.3, 9 Ton)		1
		Lever Handle		1
		Selector Lever		1
		Change Over Shaft		1
		Bolt		2
		Spring Seat		1
		Bushing		1

24A	JLH320-24A	Rubber Grip (3.2, 6.3, 9 Ton)	1
25	JLH320-25	Hex Cap Screw (2.5, 3.2, 6.3, 9 Ton) M8 x 14	1
25A	JLH320-25A	Lock Washer (2.5, 3.2, 6.3, 9 Ton) 8mm	1
26	JLH320-26	Cam (3.2, 6.3, 9 Ton)	1
	JLH320-26-1	Cam (3.2, 6.3, 9 Ton) (models from 05-01-2008 to 01-31-2009)	1
	JLH320-26-2	Cam (3.2, 6.3, 9 Ton) (models from 02-01-2009 and forward)	1
27	JLH320-27	Twisting Spring I (3.2, 6.3, 9 Ton)	1
28	JLH320-28	Hand Wheel (3.2, 6.3, 9 Ton)	1
	JLH320-28-1	Hand Wheel (3.2, 6.3, 9 Ton) (models from 02-01-2009 and forward)	1
28L	JLH320-28L	Hand Wheel (3.2, 6.3, 9 Ton)	1
29	JLH320-29	Twisting Spring II (3.2, 6.3, 9 Ton)	1
30	JLH320-30	Twisting Spring Housing (3.2, 6.3, 9 Ton)	1
31	JLH320-31	Castle Nut (3.2, 6.3, 9 Ton) M10	1
32	JLH80-32	Split Pin (0.8 to 9 Ton) 2 x 18mm	1
33	JLH80-33	Rivet (0.8 to 9 Ton) 3 x 6mm	4
34	JLH320-34	Name Plate	1
35	JLH320-35	Lock Nut M6	1
36	JLH320-36	Bottom Hook Shaft	1
37	JLH320-37	Safety Latch Kit	2
		Safety Latch	2
		Double Spring	2
		Socket Cap Screw M6 x 33	2
		Lock Nut M6	2
38	JLH320-38	Bottom Hook Holder Assembly (incls.35 & 36)	1
	JLH320-38-1	Bottom Hook Holder Assembly (incls. 35 & 36) with Thrust Bearing (models from 09-15-2009 and forward)	1
	JLH320-38PH	Bottom Point Hook Assembly (incls. 35 & 36)	1
		Bottom Hook	1
		Safety Latch	1
		Double Spring	1
		Socket Cap Screw M6 x 33	1
		Lock Nut M6	1
		Bottom Hook Holder	1
		Rivet 7 x 25mm	4
39	JLH320-39	Top Hook Shaft (3.2, 6.3, 9 Ton)	1
40	JLH320-40	Top Hook Holder Assembly	1
	JLH320-40PH	Top Point Hook Assembly	1
		Top Hook	1
		Safety Latch	1
		Double Spring	1
		Socket Cap Screw M6 x 33	1
		Lock Nut M6	1
		Top Hook Holder	1
		Rivet 7 x 25mm	2
41	JLH320-41	Chain Stop (3.2, 6.3, 9 Ton)	1
42	JLH320-42	Drive Shaft Washer (3.2, 6.3, 9 Ton)	1
49	JLH320-49	Load Chain (3.2, 6.3, 9 Ton) – specify length Ø10 x 18mm	1
50	JLH320-50	Rubber Grip Fastening (3.2, 6.3, 9 Ton)	1
50A	JLH320-50A	Fastening Screw (3.2, 6.3, 9 Ton)	1

Note: Top and bottom hooks are sold as an assembly only. Both standard and point hooks are available for the 3.2 ton model, as listed above.

When ordering replacement chain (#49), specify length.