



SERVICE PARTS LIST

| | | | |
|---|---------------------------------|--------------------|-----------|
| SPECIFY CATALOG NO. AND SERIAL NO. WHEN ORDERING PARTS | | REVISED BULLETIN | DATE |
| 1-1/2" (40mm) ROTARY HAMMER | | 55-24-6001 | Aug. 2006 |
| CAT. NO. 5315-55 (PHE 40SQ) | STARTING SERIAL NO. 891C | WIRING INSTRUCTION | |
| PRODUCT NUMBER 4000 4000 46 | | 58-03-1857 | |
| See wiring instruction for terminals, connectors and end wire preparation | | | |

| FIG. | PART NO. | DESCRIPTION OF PART | NO. REQ. |
|------|------------|---------------------|----------|
| 1 | 02-04-0845 | Ball Bearing | (1) |
| 3 | 22-84-0875 | Fan | (1) |
| ★ 4 | 02-04-1206 | Ball Bearing | (1) |

▲ SEE BACK PAGE OF THIS BULLETIN FOR ADDITIONAL LUBRICATION AND SERVICE NOTES

● = Component of the Hammer Service Kit No. 14-46-9266

★ = Part number change from previous service parts list.

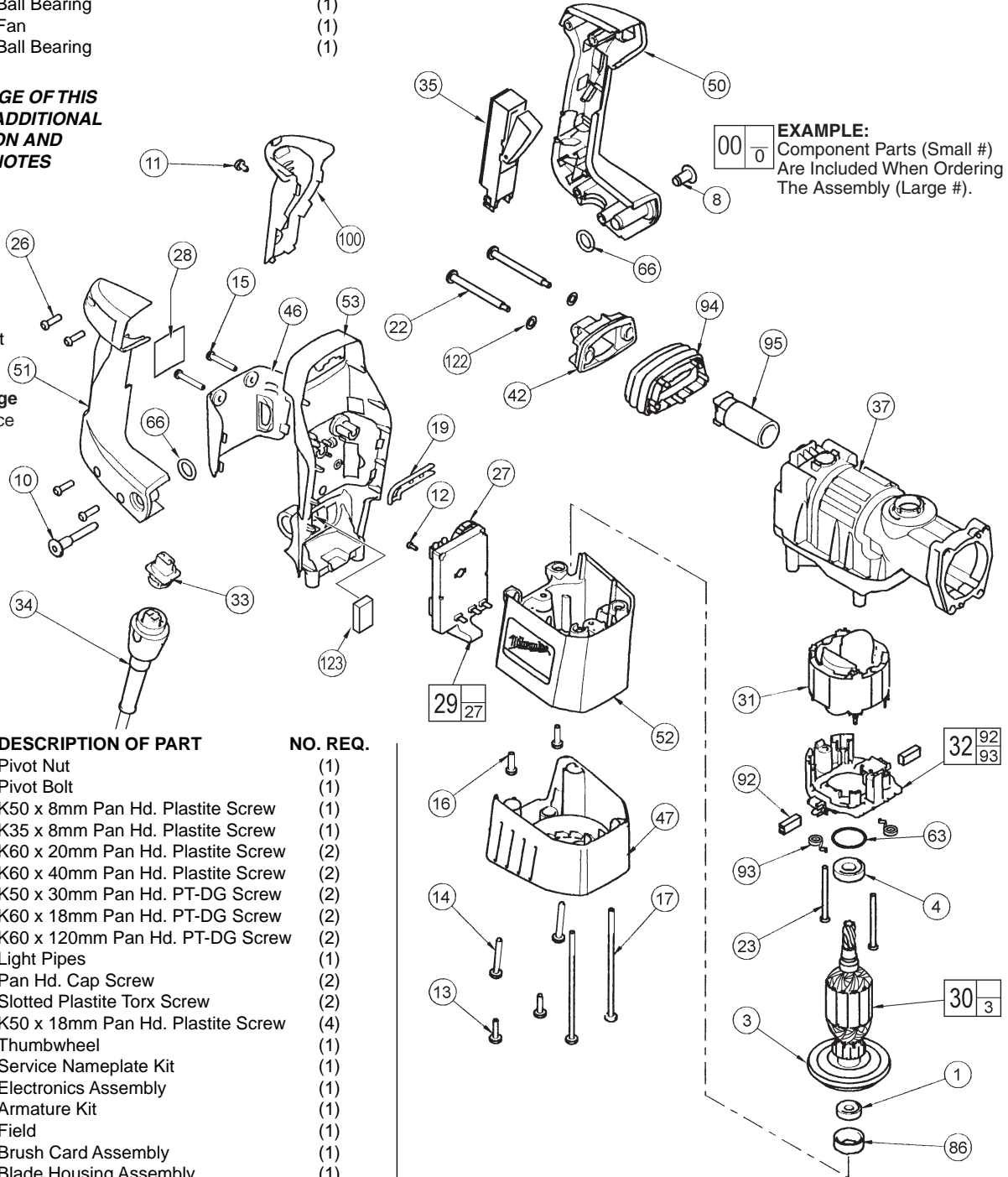

EXAMPLE:
 Component Parts (Small #)
 Are Included When Ordering
 The Assembly (Large #).

| FIG. | PART NO. | DESCRIPTION OF PART | NO. REQ. |
|------|------------|-----------------------------------|----------|
| 8 | 05-59-0100 | Pivot Nut | (1) |
| 10 | 05-77-0100 | Pivot Bolt | (1) |
| 11 | 05-88-3650 | K50 x 8mm Pan Hd. Plastite Screw | (1) |
| 12 | 05-88-5910 | K35 x 8mm Pan Hd. Plastite Screw | (1) |
| 13 | 05-88-5930 | K60 x 20mm Pan Hd. Plastite Screw | (2) |
| 14 | 05-88-5940 | K60 x 40mm Pan Hd. Plastite Screw | (2) |
| 15 | 05-88-9920 | K50 x 30mm Pan Hd. PT-DG Screw | (2) |
| 16 | 05-88-9930 | K60 x 18mm Pan Hd. PT-DG Screw | (2) |
| 17 | 05-88-9940 | K60 x 120mm Pan Hd. PT-DG Screw | (2) |
| 19 | 31-01-0065 | Light Pipes | (1) |
| 22 | 06-81-1805 | Pan Hd. Cap Screw | (2) |
| 23 | 06-82-7375 | Slotted Plastite Torx Screw | (2) |
| 26 | 06-95-6290 | K50 x 18mm Pan Hd. Plastite Screw | (4) |
| 27 | 31-01-0035 | Thumbwheel | (1) |
| 28 | 12-20-1237 | Service Nameplate Kit | (1) |
| ★ 29 | 14-20-0841 | Electronics Assembly | (1) |
| ★ 30 | 16-30-0642 | Armature Kit | (1) |
| 31 | 18-30-1040 | Field | (1) |
| ★ 32 | 22-22-1531 | Brush Card Assembly | (1) |
| 33 | 22-56-1030 | Blade Housing Assembly | (1) |
| 34 | 22-64-0677 | Quik-Lok Cord Set | (1) |
| 35 | 23-66-2195 | Switch | (1) |
| 37 | 28-14-2541 | Crankcase Assembly | (1) |
| 42 | 31-10-0140 | Upper Handle Mount | (1) |
| 46 | 31-15-0613 | Module Cover | (1) |
| 47 | 31-15-2053 | Motor Cover | (1) |
| 50 | 31-44-2211 | Left Handle Half | (1) |
| 51 | 31-44-2221 | Right Handle Half | (1) |
| 52 | 31-50-5101 | Motor Housing | (1) |
| 53 | 31-55-0281 | Rear Shroud | (1) |
| ★ 63 | 34-40-4215 | O-Ring | (1) |
| 66 | 34-40-4490 | O-Ring | (2) |
| 86 | 42-96-0125 | ● Bearing Cup | (1) |

| FIG. | PART NO. | DESCRIPTION OF PART | NO. REQ. |
|------|------------|---|----------|
| ★ 92 | 22-18-1353 | ● Carbon Brush Kit (Includes 2 Brushes) | (1) |
| 93 | 40-50-2220 | Brush Spring | (2) |
| 94 | 43-87-0035 | Bellows | (1) |
| 95 | 43-87-0060 | Isolation Module Assembly | (1) |
| 100 | 44-52-0590 | Cushion Grip | (1) |
| 122 | 45-88-8555 | Rubber Washer | (2) |
| 123 | 45-06-0535 | Handle Seal | (1) |

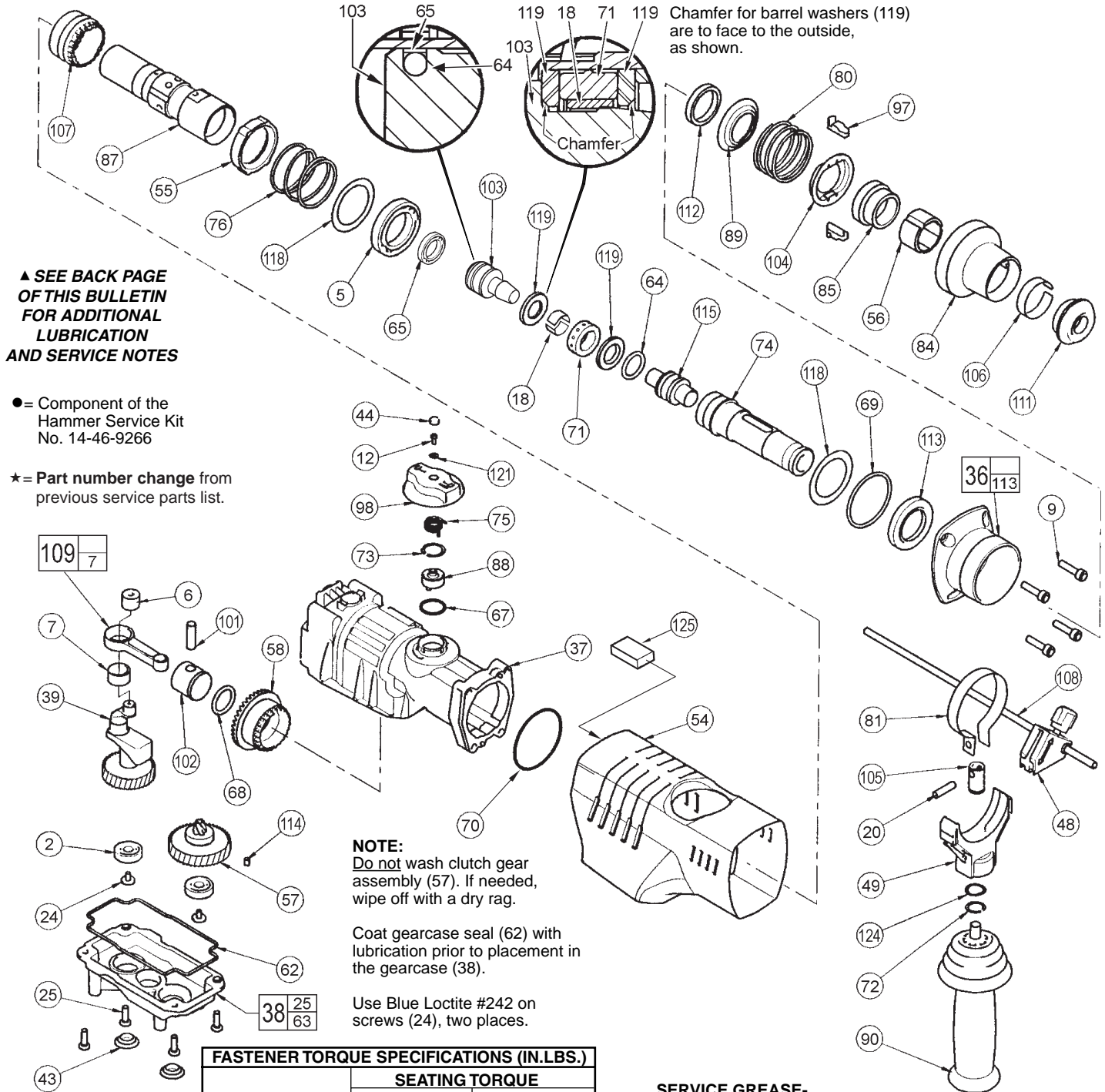

| FASTENER TORQUE SPECIFICATIONS (IN.LBS.) | | |
|--|----------------|--------------|
| FIG. NO. | SEATING TORQUE | |
| | MINIMUM | MAXIMUM |
| 9 | 120 | 140 |
| 10 | 20 | 25 |
| 11 | 3 | 6 |
| 12 | 4 | 8 |
| 13 | 20 | 25 |
| 14 | 20 | 25 |
| 15 | 15 | 20 |
| 16 | 50 | 55 |
| 17 | 30 | 35 |
| 22 | 30 | 35 |
| 23 | 12 | 17 |
| 24 | 20 | 25 |
| 25 | 45 | 50 |
| 26 | 15 | 20 |
| 74 | 130 FT. LBS. | 200 FT. LBS. |
| 87 | 130 FT. LBS. | 200 FT. LBS. |
| Switch Screws | 4 | 6 |

SERVICE GREASE-

● "S2" Grease, No. 49-08-5265 7 oz. tube

● **14-46-9266 HAMMER SERVICE KIT**

THIS KIT CONTAINS:

- | | | |
|---|------------|------------------------|
| 2 | 31-12-0040 | Cap Plug |
| 1 | 34-40-0240 | Gearcase Seal |
| 2 | 34-40-4350 | O-Ring |
| 1 | 34-40-4475 | Cap Seal |
| 1 | 34-40-4215 | O-Ring |
| 1 | 34-40-4510 | O-Ring |
| 1 | 34-40-4530 | O-Ring |
| 1 | 34-40-4570 | Damping Washer |
| 1 | 42-96-0125 | Bearing Cup |
| 2 | 45-22-0680 | Split Sleeve |
| 1 | 22-18-1353 | Carbon Brush Kit |
| 1 | 49-08-5265 | "S2" Grease, 7oz. Tube |

● **22-18-1353 CARBON BRUSH SERVICE KIT**

THIS KIT CONTAINS:

- | | | |
|---|-------|--------------|
| 2 | ----- | Carbon Brush |
|---|-------|--------------|

| FIG. | PART NO. | DESCRIPTION OF PART | NO. REQ. |
|-------|------------|----------------------------------|----------|
| 2 | 02-04-0911 | Ball Bearing | (2) |
| 5 | 02-08-0640 | Ball Bearing | (1) |
| ★ 6 | 02-50-2755 | Needle Bearing | (1) |
| 7 | 02-50-4020 | Needle Bearing | (1) |
| 9 | 05-74-0625 | M6 Socket Head Cap Screw | (4) |
| 12 | 05-88-5910 | K35 x 8mm Pan Hd. Plastite Screw | (1) |
| 18 | 45-22-0680 | ● Split Sleeve | (2) |
| 20 | 06-65-1660 | Dowel Pin | (1) |
| 24 | 06-82-8842 | Slotted Taptite Torx Screw | (2) |
| 25 | 05-88-9910 | K50 x 22mm PT-DG Screw | (4) |
| 36 | 14-52-0030 | SDS-Max Nose Service Assembly | (1) |
| 37 | 28-14-2541 | Crankcase Assembly | (1) |
| 38 | 14-46-2565 | Gearcase Service Kit | (1) |
| ★ 39 | 14-09-0161 | Crankshaft Assembly | (1) |
| 43 | 31-12-0040 | ● 5/8 Cap Plug | (2) |
| 44 | 31-12-0185 | Screw Cap | (1) |
| 48 | 14-34-0551 | Depth Rod Mount Assembly | (1) |
| 49 | 31-44-2000 | Side Handle Housing | (1) |
| 54 | 31-55-0301 | Main Shroud | (1) |
| 55 | 31-58-0150 | Locking Ring | (1) |
| 56 | 31-86-0100 | Spacer | (1) |
| ★ 57 | 14-08-0211 | Clutch Gear Assembly | (1) |
| 58 | 32-30-0060 | Drive Gear | (1) |
| 62 | 34-40-0240 | ● Gearcase Seal | (1) |
| 64 | 34-40-4350 | ● O-Ring | (2) |
| 65 | 34-40-4475 | ● Capseal | (1) |
| 67 | 34-40-4500 | O-Ring | (1) |
| 68 | 34-40-4510 | ● O-Ring | (1) |
| 69 | 34-40-4520 | O-Ring | (1) |
| 70 | 34-40-4530 | ● O-Ring | (1) |
| 71 | 34-40-4570 | ● Damping Washer | (1) |
| 72 | 34-60-2580 | External Retaining Ring | (1) |
| 73 | 34-80-5010 | Retaining Ring | (1) |
| 74 | 38-50-6250 | Spindle | (1) |
| 75 | 40-50-0370 | Shift Spring | (1) |
| 76 | 40-50-0380 | Compression Spring | (1) |
| 80 | 40-50-8870 | Key Spring | (1) |
| 81 | 42-16-0125 | Side Handle Band | (1) |
| 84 | 42-76-0710 | Chuck Collar | (1) |
| 85 | 42-76-0715 | Collar | (1) |
| 87 | 42-98-0260 | Barrel | (1) |
| 88 | 14-14-0170 | Shift Disk Assembly | (1) |
| 89 | 43-34-0440 | Spring Flange | (1) |
| 90 | 14-34-0516 | Side Handle Assembly | (1) |
| 97 | 43-96-0220 | Keys | (2) |
| 98 | 14-34-0180 | Shift Knob Assembly | (1) |
| 101 | 44-60-1710 | Wrist Pin | (1) |
| 102 | 44-62-0230 | Piston | (1) |
| 103 | 44-82-0220 | Ram | (1) |
| 104 | 44-86-0610 | Key Retaining Ring | (1) |
| 105 | 44-86-0620 | Band Retainer | (1) |
| 106 | 44-90-0005 | Seal Retaining Ring | (1) |
| 107 | 44-90-0175 | Shift Ring | (1) |
| 108 | 44-94-0165 | Depth Gauge Rod | (1) |
| 109 | 44-94-0395 | Connecting Rod Assembly | (1) |
| 111 | 45-06-0555 | Dust Seal | (1) |
| 112 | 45-06-0685 | Felt Seal | (1) |
| 113 | ----- | Spindle Seal | (1) |
| 114 | 45-30-0060 | Retaining Slug | (1) |
| 115 | 45-56-2640 | SDS-Max Striker | (1) |
| 118 | 45-88-1565 | Washer | (2) |
| 119 | 45-88-4005 | Barrel Washer | (2) |
| 121 | 45-88-7170 | Washer | (1) |
| 124 | 45-88-8730 | Wave Washer | (1) |
| ★ 125 | 44-52-0041 | Breather Pad | (1) |

NOTE: Check the clutch torque. Clutch must slip at 40 to 50 ft.lbs. at the spindle, checked clockwise as viewed from the front of the tool.

▲ SEE BACK PAGE OF THIS BULLETIN FOR ADDITIONAL LUBRICATION AND SERVICE NOTES

Press Needle Bearing (7) in Connecting Rod (109) so that the same amount sticks out on both sides of the Rod.

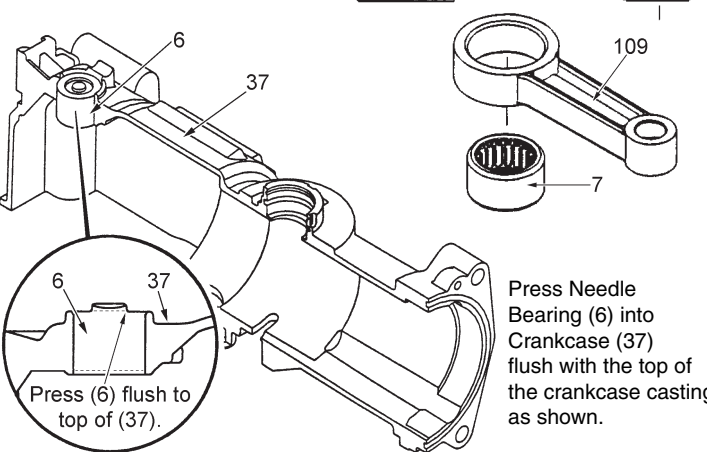

LUBRICATION NOTES: (TYPE "S2" GREASE, NO. 49-08-5265)

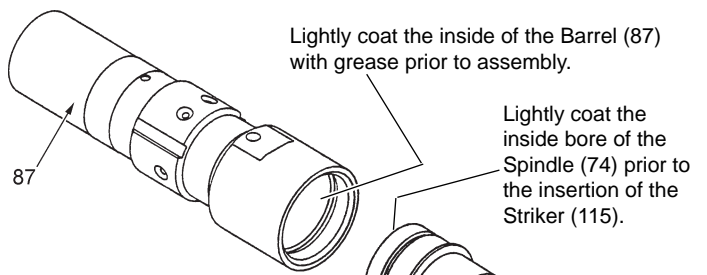
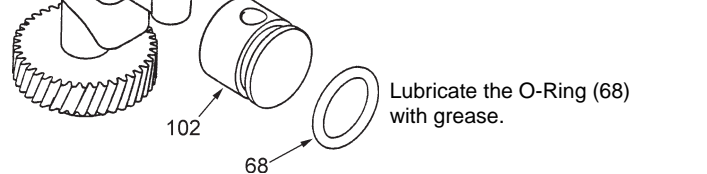
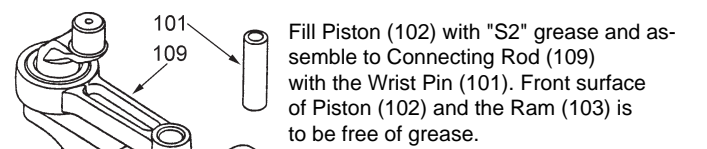

See back page for special service tool and torque values

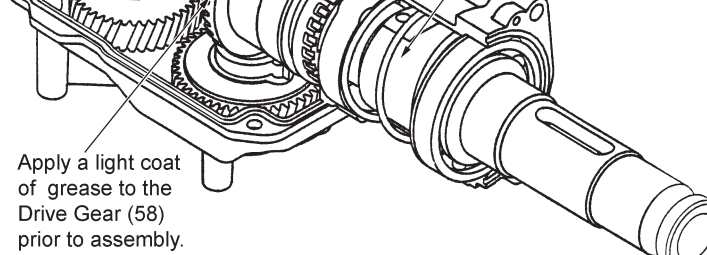
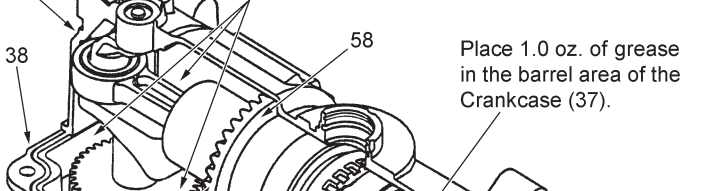
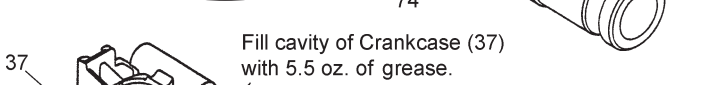

Prior to assembly, apply a light coat of grease to the Gearcase Seal (62) and O-Rings (63, 64, 67, 68 and 70).

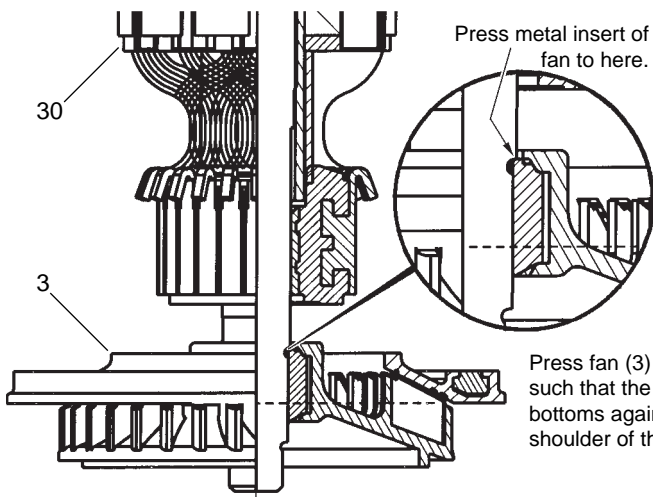

Press fan (3) onto armature (30) such that the metal insert of the fan bottoms against the fan journal shoulder of the armature shaft.

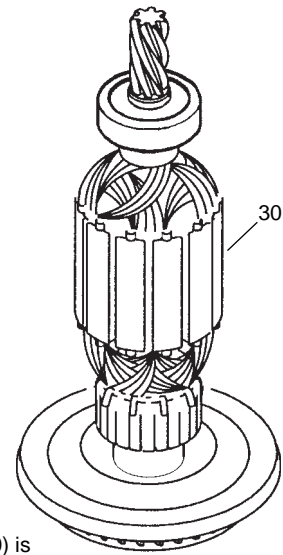

After the armature assembly (30) is installed into the tool, the bearing cup (86) is to be placed on the rear armature bearing (1), (already pressed onto the armature shaft), prior to assembling the motor cover (47) to the tool.

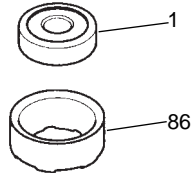

NOTE: Do not dislodge the bearing cup from the bearing during assembly.

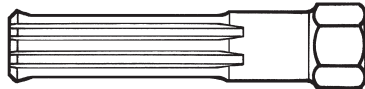

61-10-2060 SDS-MAX Shank



3/4"
[19mm]
Hex

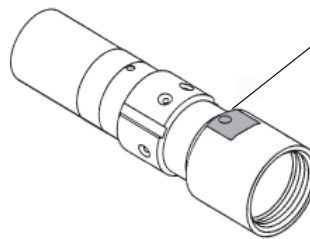

Barrel

when tightened in a vise, **extra care** should be taken not allowing the barrel to turn and mar or burr it's finished cylindrical surface.

no loctite® is required on threads of spindle or barrel.

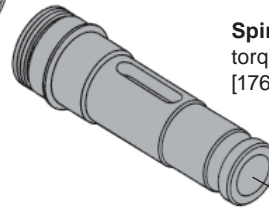

Spindle

torque to 130-160 ft.-lbs.
[176-217 Newton-meters]

BARREL / SDS MAX SPINDLE SERVICING-

To aid in the servicing of the Barrel and Spindle of the 5315-55 SDS-MAX Rotary Hammer, a Service Tool No. 61-10-2060 has been developed [see illustrations].

- clamp the flats of the Barrel in a vise.
- use a 3/4" [19mm] socket on the hex of Service Tool to either remove [turning counter-clockwise] or install [turning clockwise] the Spindle.

SERVICE NOTE:

SLIP CLUTCH VALUES

When servicing this SDS-MAX Rotary Hammer, the static torque required to slip the clutch mechanism should be checked. It must not exceed the maximum value shown below:

- block armature from rotating.
- using service tool and ft.-lb [newton-meter] torque wrench with 3/4" [19mm] socket, check the static torque required to slip the Spindle / Clutch Mechanism of the Rotary Hammer.
- **the torque for the 5315-55 should be 40-50 ft.-lb. [52-68 Nm].**