



SERVICE PARTS LIST

BULLETIN NO.
54-24-0172

SPECIFY CATALOG NO. AND SERIAL NO. WHEN ORDERING PARTS		REVISED BULLETIN 54-24-0171	DATE May '92
1/2" REV. MAGNUM HAMMER-DRILL			
CATALOG NO. 5374-1	STARTING SERIAL NO. 715-25028	WIRING INSTRUCTION 58-01-1074	

EXAMPLE:
Component Parts
(Small #) Are Included
When Ordering The
Assembly (Large #).

00 0

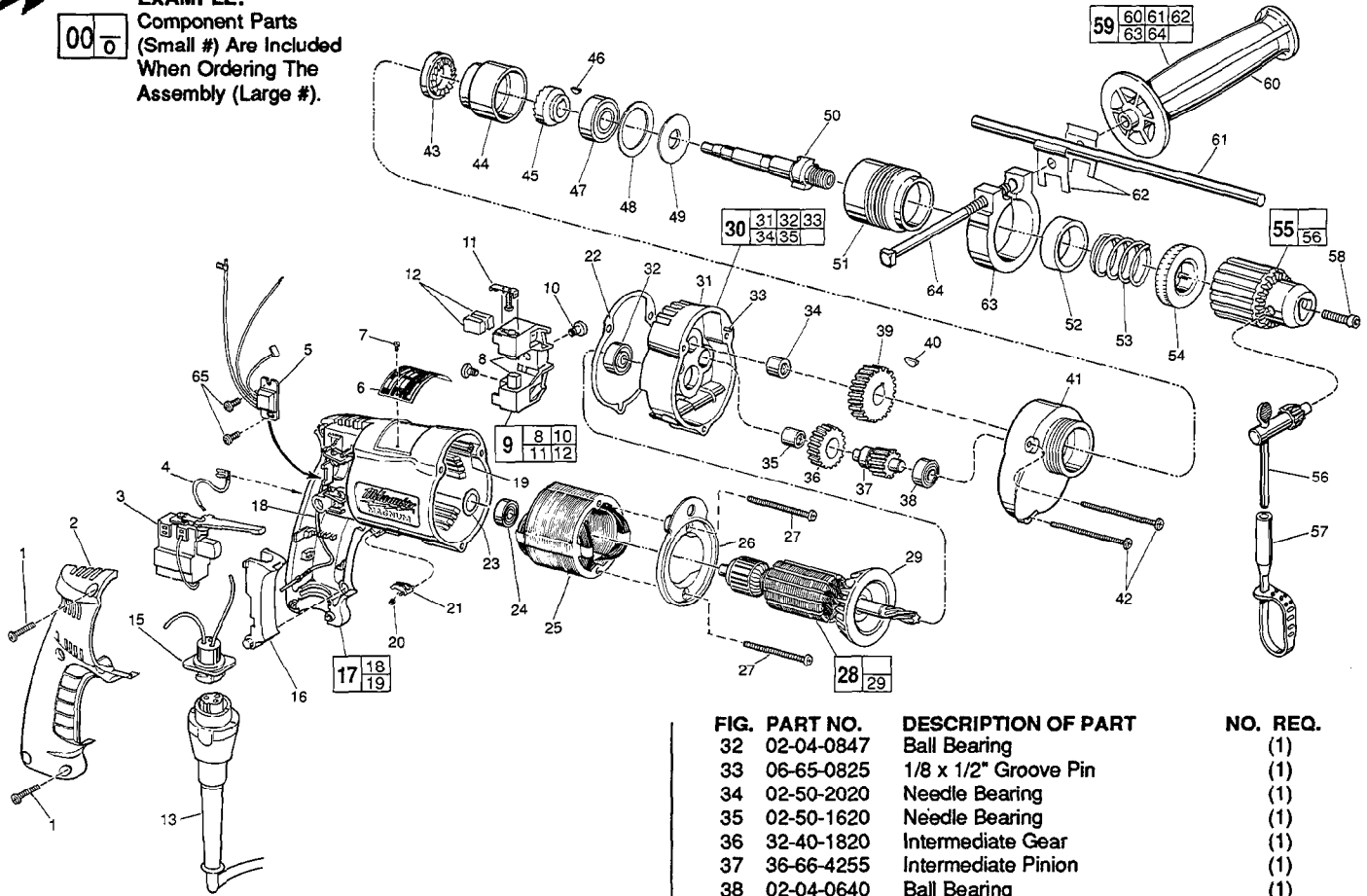

FIG.	PART NO.	DESCRIPTION OF PART	NO. REQ.
★ 1	06-82-7266	7-18 x 11/16" Plastite Screw T-20	(5)
2	31-15-0101	Handle Cover	(1)
3	23-66-1665	Trigger Speed Control Reversing Switch	(1)
★ 4	23-94-6245	2-1/4" Lead Assembly	(1)
5	14-20-0245	Remote Electronic Assembly	(1)
6	12-99-0225	Nameplate Blank	(1)
7	06-85-0200	Nameplate Screw	(2)
8	22-16-0300	Carbon Brush	(2)
9	22-22-0355	Brush Holder Assembly	(1)
★ 10	31-75-0040	Brush Holder Screw	(2)
★ 11	22-20-0355	Brush Spring Assembly	(2)
12	22-16-0300	Carbon Brush (Spares)	(2)
13	48-76-4008	8 Foot Quik-Lok Cord Set	(1)
15	22-56-0302	Pin Housing Assembly	(1)
16	45-72-0080	Trigger	(1)
★ 17	14-38-0357	Motor Housing Assembly	(1)
18	23-94-9686	Ground Wire Assembly	(1)
★ 19	44-60-1290	Grounding Pin	(1)
20	40-50-0085	Lock Button Spring	(1)
21	42-42-0150	Lock Button	(1)
22	43-44-0576	Gasket	(1)
23	45-88-7800	Gasket Washer	(1)
24	02-04-0645	Ball Bearing	(1)
★ 25	18-10-0055	120 Volt Field	(1)
26	31-05-0065	Baffle	(1)
27	06-82-7380	7 x 1-7/8" Pan Hd. Screw T-20	(2)
28	16-10-0500	120 Volt Armature	(1)
29	22-84-0650	Fan Assembly	(1)
★ 30	14-13-0460	Diaphragm Assembly	(1)
★ 31	28-28-2010	Diaphragm	(1)

FIG.	PART NO.	DESCRIPTION OF PART	NO. REQ.
	32	02-04-0847	Ball Bearing (1)
	33	06-65-0825	1/8 x 1/2" Groove Pin (1)
	34	02-50-2020	Needle Bearing (1)
	35	02-50-1620	Needle Bearing (1)
	36	32-40-1820	Intermediate Gear (1)
	37	36-66-4255	Intermediate Pinion (1)
	38	02-04-0640	Ball Bearing (1)
	39	32-75-3190	Spindle Gear (1)
	40	06-42-0800	Woodruff Key (1)
	41	28-14-1795	Gear Case (1)
★ 42	06-82-7411	7-18 x 2-3/16" Pan Hd Plastite T-20	(3)
	43	44-84-0165	Fixed Ratchet (1)
	44	42-52-0250	Bearing Housing (1)
	45	44-84-0160	Rotating Ratchet (1)
	46	06-42-1200	Woodruff Key (1)
	47	02-04-1536	Ball Bearing (1)
	48	45-88-7350	Bearing Retainer Washer (1)
	49	45-88-7365	Spring Support Washer (1)
	50	38-50-5575	Spindle (1)
	51	45-22-0405	Sleeve (Left Hand Thread) (1)
	52	45-88-7375	Felt Washer (1)
	53	40-50-4950	Spring (1)
	54	42-76-0200	Locking Collar (1)
	55	48-66-1365	1/2" Reversing Chuck (1)
	56	48-66-3280	Chuck Key (1)
	57	48-66-4040	Key Holder (1)
	58	06-75-3150	1/4-20 x 1" Socket Hd. Screw L.H. Thread (1)
	59	14-34-0250	Side Handle Assembly (1)
	60	43-62-0865	Side Handle (1)
	61	44-94-0161	Depth Rod (1)
★ 62	42-68-0390	Depth Gauge Clamp (2)	
★ 63	25-82-0140	Clamping Collar (1)	
	64	42-32-0161	5/16-18 x 3-1/2" Square Hd. Bolt (1)
	65	06-82-7212	4-20x1/4" Pan Hd. Plastite T-10 (2)
		10-98-5986	Warning Label (1)

FIG. LUBRICATION

41 1-1/2 Oz. Type "E" Grease, No. 49-08-4122

MILWAUKEE ELECTRIC TOOL CORPORATION
13135 W. LISBON RD., BROOKFIELD, WI 53005