



SERVICE PARTS LIST

BUL. 54-27-0100	
REVISED BUL.	DATE
	APRIL '79
WIRING INSTRUCTIONS	
58-01-0690	

Catalog No. 5410

Starting Serial No. 447-1001

Specify Catalog and Serial No. when ordering parts

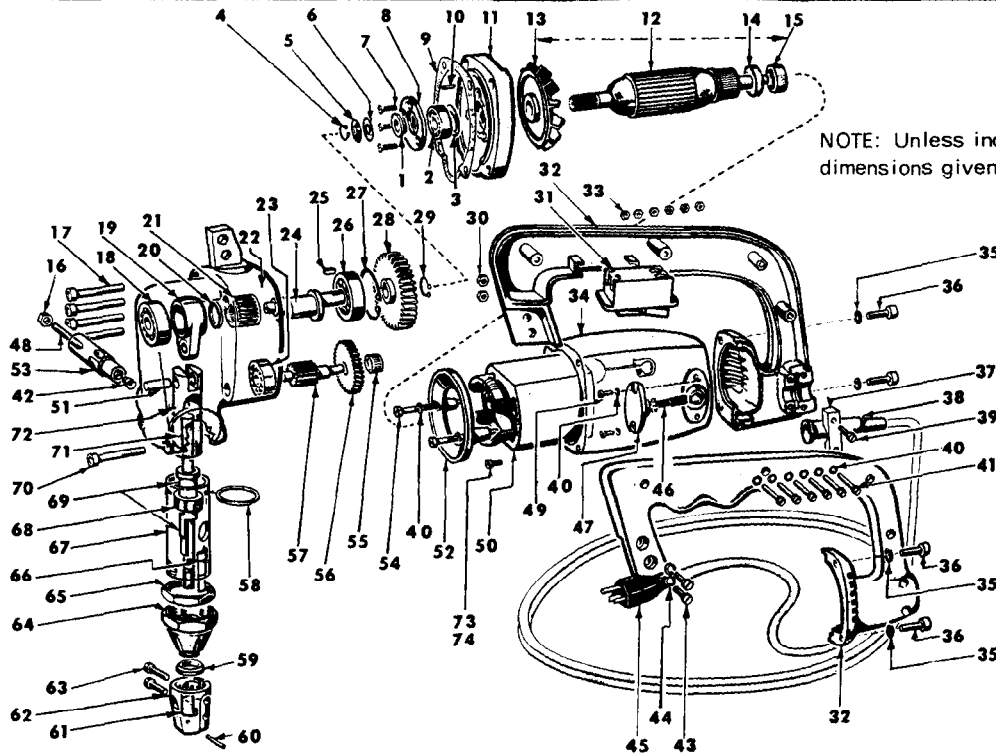

NOTE: Unless indicated otherwise, dimensions given are in millimeters

FIG.	PART NO.	DESCRIPTION OF PART	NO.	REQ.	FIG.	PART NO.	DESCRIPTION OF PART	NO.	REQ.
1	45-06-0175	Sealing Ring	1		42	43-33-0100	Grease Nipple	1	
2	02-04-0930	Ball Bearing	1		43	05-81-0525	Pan Hd. Screw 5x25	2	
3	45-36-0700	Ring Spacer	1		44	05-90-0105	Lock Washer 5	2	
4	34-60-0820	Retaining Ring	1		45	22-64-0715	Cord Set	1	
5	40-50-0065	Saucer Spring	1		46	22-18-0485	Carbon Brush	2	
6	45-14-0130	Shim Washer	1		47	31-12-0090	Brush Holder Cap	2	
7	05-80-0410	Flat Hd. Screw 4x10	3		48	05-89-0010	Set Screw 6x25	1	
8	44-86-0180	Bearing Retainer	1		49	05-82-0410	Fillister Hd. Screw 4x10	4	
9	43-44-0405	Diaphragm Gasket	1		50	18-22-1190	110 Volt Field	1	
10	44-60-0400	Cylindrical Pin	1		51	44-60-0415	Piston Pin	1	
11	28-28-1470	Diaphragm	1		52	31-05-0040	Air Deflector Baffle	1	
12	16-22-1310	110 Volt Armature (Includes Figs. 13 thru 15)	1		53	42-36-0720	Carrier Rod Bracket	1	
13	-	Fan	1		54	05-81-0450	Pan Hd. Screw 4x50	2	
14	31-86-0140	Insulating Spacer	1		55	02-50-1675	Needle Bearing	1	
15	02-04-0705	Ball Bearing	1		56	32-40-1635	Intermediate Gear	1	
16	05-55-0008	Hex Nut 8	1		57	32-40-1645	Intermediate Gear	1	
17	05-74-0560	Socket Hd. Screw 5x60	4		58	44-90-4225	Sleeve Sealing Ring	1	
18	02-04-1235	Ball Bearing	1		59	48-79-0020	Die 2	1	
19	44-94-0205	Connecting Rod	1		60	44-60-0410	Cylindrical Pin	1	
20	44-90-4240	Clamping Ring	1		61	43-78-0210	Die Carrier Hub	1	
21	02-50-4038	Needle Bearing	1		62	43-72-0070	Die Carrier	1	
22	28-14-1365	Gear Case	1		63	05-84-0615	Socket Hd. Screw 6x15	2	
23	02-04-0905	Ball Bearing	1		64	43-56-0200	Punch Guide	1	
24	43-16-0090	Eccentric Shaft	1		65	44-40-0370	Lock Nut	1	
25	43-96-0095	Key	1		66	45-60-0310	Supporting Shell	1	
26	02-04-1295	Ball Bearing	1		67	45-22-0330	Sleeve	1	
27	34-80-2235	Retaining Ring	1		68	45-04-0440	Blade Retaining Screw	1	
28	32-48-0025	Mechanism Gear	1		69	48-44-0250	Nibbler Punch	1	
29	34-60-0830	Retaining Ring	1		70	05-74-0640	Socket Hd. Screw 6x40	2	
30	05-55-0005	Hex Nut 5	2		71	49-52-0250	Carrier Rod	1	
31	23-66-0900	Switch	1		72	44-62-0125	Piston	1	
32	31-44-0310	Handle Set (Both Halves)	1		73	05-81-0408	Pan Hd. Ground Screw 4x8	1	
33	05-55-0104	Hex Nut 4	6		74	06-97-2000	Lock Washer	1	
34	28-50-6150	Motor Housing	1				NOT SHOWN		
35	05-90-0105	Lock Washer 5	4				05-82-0408	Switch Screw 4x8	4
36	06-81-0518	Pan Hd. Screw 5x18	4				49-96-4720	Open End Wrench	1
37	31-17-0055	Cord Clamp	1				49-96-0300	Socket Wrench Set	1
38	23-82-0270	Cord Entry Sleeve	1				49-96-6500	Nibbler Punch Wrench	1
39	05-81-0412	Pan Hd. Screw 4x12	2				12-98-7090	Nameplate	1
40	05-90-0004	Lock Washer 4	12				12-98-7080	Warning Plate	1
41	05-81-0422	Pan Hd. Screw 4x22	6						