



# SERVICE PARTS LIST

**BULLETIN NO.  
54-40-0110**

SPECIFY CATALOG NO. AND SERIAL NO. WHEN ORDERING PARTS		REVISED BULLETIN	DATE
<b>SPEED CONTROL BANDSAW</b>			Oct. '82
<b>CATALOG NO. 6227</b>	<b>STARTING SERIAL NO. 674-1001</b>	<b>WIRING INSTRUCTION 58-01-0725</b>	
<b>CAT. NO. 6227-6</b>	<b>START SER. NO. 674-01001</b>	<b>BILINGUAL LABEL</b>	<b>10-98-6120</b>

FIG.	PART NO.	DESCRIPTION OF PART	NO. REQ.	FIG.	PART NO.	DESCRIPTION OF PART	NO. REQ.
1	22-64-0155	Cord Set	(1)	46	45-88-7165	Pulley Hub Washer	(4)
2	44-76-0120	Cord Protector	(1)	47	34-60-1400	Snap Ring	(2)
3	31-17-0155	Cord Clamp	(1)	48	06-95-0335	1/4-20 x 1/2" Fil. Hd. Taptite Screw	(3)
4	06-95-0216	8-16 x 5/8" Plastite Pan Hd. Screw	(2)	49	28-20-1221	Blade Pulley Cover	(2)
5	06-95-0575	1/4-20 x 7/8" Pan Hd. Screw	(6)	50	42-40-0580	Sleeve Bearing	(4)
6	31-44-0490	Right Handle Half	(1)	51	06-57-5000	1/4-20 Lock Nut	(2)
7	06-95-0216	8-16 x 5/8" Plastite Pan Hd. Screw	(4)	52	02-50-1630	Needle Bearing	(1)
8	23-66-0765	Variable Speed Switch - Includes Remote Assembly	(1)	53	06-75-2110	10-24 x 7/8" Skt. Hd. Screw	(2)
9	06-95-0209	8-32 x 3/8" Taptite Screw	(1)	54	02-25-0260	Cam Follower	(6)
10	31-44-0495	Left Handle Half	(1)	55	42-28-0205	Front Blade Guide Block	(1)
11	06-81-5502	8-32 x 3/8" Binder Hd. Sem.	(1)	56	28-41-0500	Front Pulley Guard	(1)
12	28-62-0031	Blade Release Lever	(1)	57	06-75-2405	10-32 x 5/8" Socket Hd. Screw	(2)
13	06-42-2200	Woodruff Key	(1)	58	14-73-0160	Blade Release Shaft Assembly	(1)
14	45-88-7105	Wave Washer	(1)	59	02-50-3230	Needle Bearing	(1)
15	06-75-4675	3/8-16 x 1" Socket Hd. Screw	(1)	60	48-39-0360	Bandsaw Blade	(1)
16	31-44-0330	Front Handle	(1)	61	45-04-0450	Shoulder Screw	(1)
17	23-44-0130	Brush Retaining Screw	(2)	62	43-54-0250	Blade Guard	(1)
18	22-18-0450	Carbon Brush Assembly	(2)	63	06-81-5692	10-24 x 1/2" Pan Hd. Sem.	(1)
19	22-22-0285	Brush Holder Assembly	(2)	64	06-83-2686	1/4-20 x 3/4" Set Screw	(1)
20	06-95-5200	Ground Screw	(1)	65	32-90-0101	Worm Gear	(1)
21	02-04-0911	Ball Bearing	(1)	66	02-04-2000	Ball Bearing	(1)
22	31-55-0140	Coil Shield	(1)	67	34-40-3115	O-Ring	(1)
23	31-05-0170	Fan Baffle	(1)	68	43-76-0360	Worm Gear Shaft Housing	(1)
24	28-28-1480	Diaphragm	(1)	69	02-50-6400	Needle Bearing	(1)
25	06-65-1206	3/16 x 3/4" Groove Pin	(1)	70	06-42-2200	Woodruff Key	(1)
26	02-04-1040	Ball Bearing	(1)	71	36-66-0510	Worm Gear Shaft	(1)
27	16-50-0100	120V Armature	(1)	72	42-60-0140	Roller Chain	(1)
28	06-95-3290	8-16 x 1-7/8" Plastite Screw	(2)	73	06-81-7875	1/4-20 x 1-1/4" Fil. Hd. Screw	(3)
29	18-50-0100	120V Field	(1)	74	31-88-0020	Sprocket	(1)
30	23-16-0425	Field Insulator	(1)	75	06-81-5140	10-24 x 1/2" Button Skt. Hd. Screw	(2)
31	28-50-6240	Motor Housing	(1)	76	42-38-0030	Bumper	(1)
32	28-90-0190	Pulley Support	(1)	77	42-28-0210	Rear Blade Guide Block	(1)
33	06-95-0600	1/4-20 x 1" Pan Hd. Taptite Screw	(4)	78	28-14-1380	Gear Case	(1)
34	45-36-0720	Retaining Plate Spacer	(4)	79	12-99-0250	Nameplate Blank	(1)
35	06-81-3105	5/16-18 x 1" Phil Flat Hd. Screw	(2)	80	06-85-0200	Nameplate Screw	(2)
36	44-52-0120	Blade Becking Pad	(1)	81	06-95-1800	1/4-20 x 1-5/16" Phil. Drive Screw	(4)
37	42-12-0070	Blade Pulley Axle	(2)	82	02-04-1030	Ball Bearing	(1)
38	44-66-0550	Pulley Guard Retaining Plate	(2)	83	45-36-1005	Spacer	(1)
39	40-50-0710	Blade Tension Spring	(2)	84	32-91-0111	Worm	(1)
40	42-18-0190	Blade Tension Bar	(2)	85	45-36-1000	Spacer	(1)
41	06-75-0255	1/4-20 x 4" Hex. Hd. Screw	(2)	86	36-18-0040	Worm Drive Shaft	(1)
42	06-95-3800	1/4-20 x 1-1/4" Flat Hd. Taptite Screw	(4)	87	06-42-1200	Woodruff Key	(1)
43	06-75-0150	1/4-20 x 1" Hex. Hd. Screw	(2)	88	32-40-1680	Intermediate Gear	(1)
44	45-69-0010	Blade Pulley Tire	(2)	89	02-04-1020	Ball Bearing	(1)
45	28-95-0120	Blade Pulley	(2)				

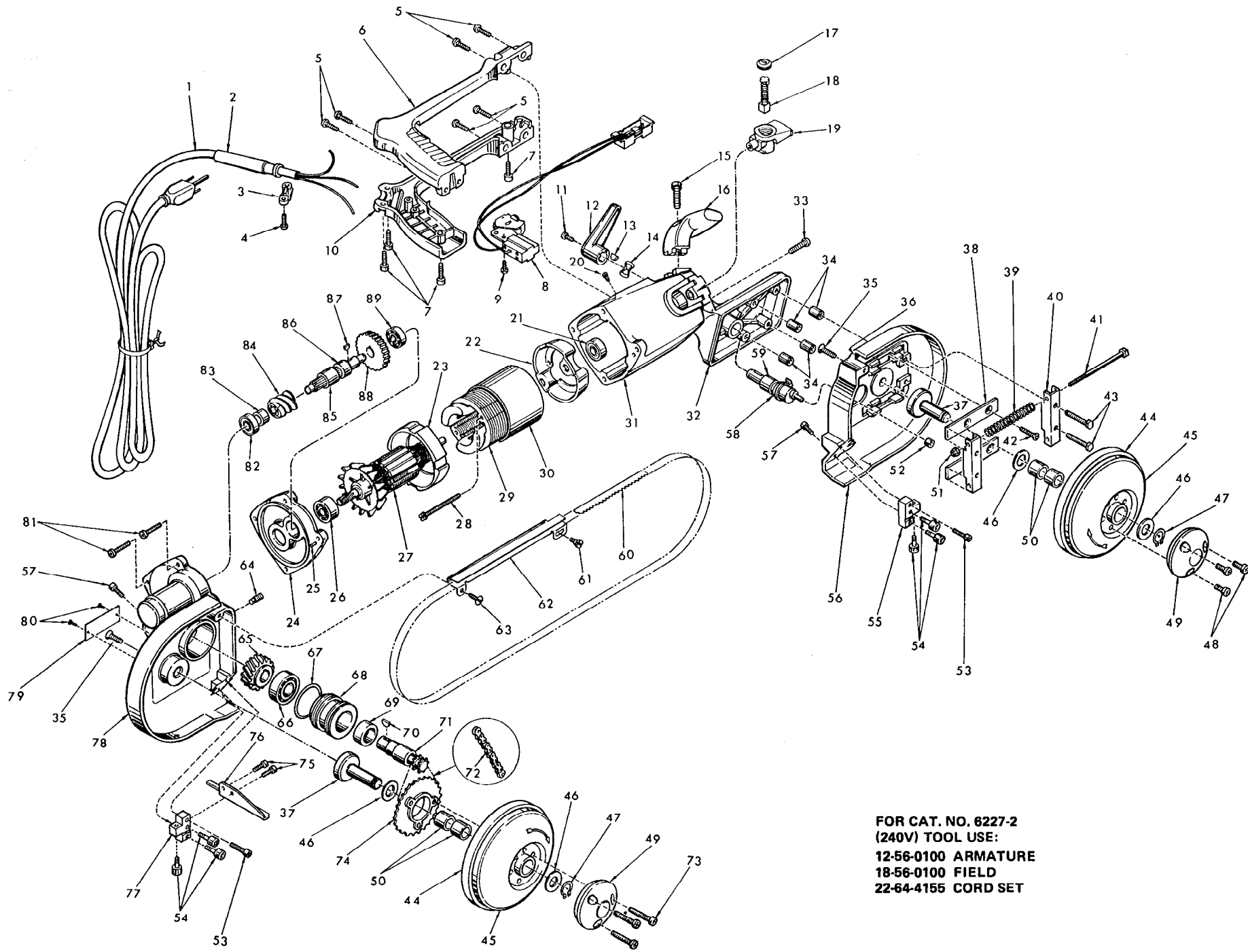

FOR CAT. NO. 6227-2  
 (240V) TOOL USE:  
 12-56-0100 ARMATURE  
 18-56-0100 FIELD  
 22-64-4155 CORD SET