



# SERVICE PARTS LIST

**BUL. 54-40-4101**

## ELECTRONICALLY CONTROLLED SAWZALL

REVISED BUL 6335-2 DATE May '68

**Catalog No. 6505**

Starting Serial No. **335-2456**

WIRING INSTR. **58-01-0540**

Both Model and Serial No. must be furnished to obtain correct parts.

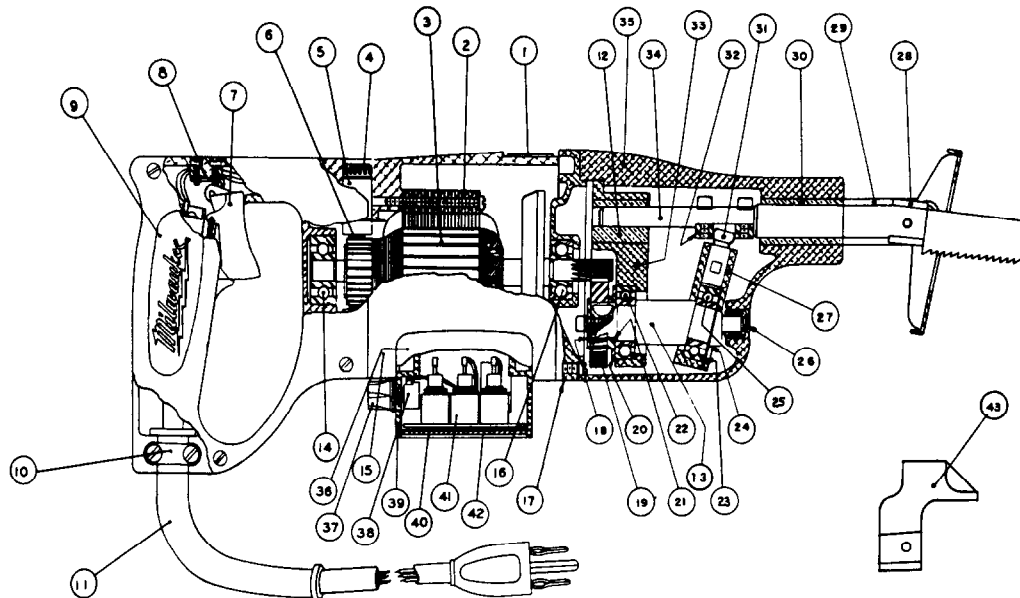

ILLUSTRATED PARTS

FIG.	PART NO.	DISCRIPTION OF PART	NO.REQ.	FIG.	PART NO.	DESCRIPTION OF PART	NO.REQ.
1	12-98-3000	Name Plate		24	34-60-1200	Retaining Ring	
2	18-42-1180	Field Assembly		25	02-04-1510	Ball Bearing	(2)
3	16-42-1340	Armature Assembly		26	02-50-1640	Needle Bearing	
4	23-44-0060	Brush Retaining Screw	(2)	27	28-72-9001	Wobble Plate	
5	22-22-0080	Brush Holder Assembly	(2)	28	42-68-0073	Blade Clamp	(2)
6	22-18-0100	Carbon Brush Assemblies	(2)	29	45-16-0055	Pivot Shoe Assembly	
7	23-66-0230	Switch		30	42-24-0091	Spindle Bearing	
★ 8	42-14-0090	Wire Baffle		31	45-58-0050	Ball End Stud	
9	28-20-3151	Handle Cover		32	42-28-0050	Reciprocating Spindle Block	
10	28-17-0400	Cord Clamp Strap		33	28-72-1001	Bearing Plate	
11	22-64-0170	Cord Set		34	38-50-2002	Reciprocating Spindle	
12	42-24-0101	Spindle Bearing		35	28-14-0571	Gear Case	
13	36-92-0601	Wobble Shaft		36	42-04-0140	Control Housing Adaptor	(2)
14	02-04-0970	Ball Bearing		★ 37	23-18-0070	Control Knob	
15	28-50-4492	Motor Housing (Incl. item 9 & Screws)		★ 38	23-38-5080	Variable Speed Resistor	
16	02-04-0940	Ball Bearing		★ 39	43-76-0132	Speed Control Housing	
17	28-28-0341	Diaphragm		40	12-98-6600	Speed Control Name Plate	
18	45-88-0180	Gear Retaining Washer		★ 41	23-37-0060	Speed Control Regulator (Incl. item 38)	
19	32-40-1101	Intermediate Gear		42	23-16-0280	Insulator	
20	44-86-0090	Bearing Retainer		43	48-03-2000	Off-Set Blade Adaptor (Incl. 28-02-0051, 42-68-0073 & scrs)	
21	45-36-0121	Gear Spacer		★ 44	14-38-0290	Speed Control Housing Assy. (Incl. items 37,39,41)	
22	02-04-1510	Ball Bearing	(2)				
23	34-80-2300	Retaining Ring					

MISCELLANEOUS PARTS NOT SHOWN

PART NO.	DESCRIPTION OF PART	NO.REQ.	PART NO.	DESCRIPTION OF PART	NO.REQ.
23-86-0110	Brush Holder Insulating Washer (Fiber)	(2)	06-81-9525	10-24x1/2 Truss Hd, Shoe Bracket Scrs. (Sems)	(4)
23-16-0280	Switch Insulator		06-81-2500	6-32x3/8 Flat Hd Bearing Ret. Screws	(2)
06-81-5800	6-32x5/16 Fil, Hd, Sems Switch Mtg. Scrs. (2)		06-81-0900	8-32x7/16 Brg. Retainer Plate Screw	(2)
06-81-8400	4-40x1/4 Rd, Hd, Name Plate Screws (Sems) (2)		06-81-8650	8-32x1-3/8 Fil, Hd, Gear Case Scrs. (Sems)	(2)
06-83-2645	1/4-20x3/8 Soc, Hd, Hd'less Set Scr, Self Locking		06-81-6650	8-32x1-3/4 Fil, Hd, Gear Case Scrs. (Sems)	(2)
06-83-2650	1/4-20x3/8 Brush Holder Set Screw	(2)	06-81-6150	8-32x1/2 Fil, Hd, Sem	
06-81-8625	6-32x1/4 Rd, Hd, Ground Wire Scr. (Sem) (Brass)		06-81-6600	8-32x1-3/4 Fil, Hd, Field Screws (Sems)	
06-75-2400	10-32x1/2 Socket Head Screws	(6)	★ 06-81-6150	8-32x1/2 Fil, Hd, Cord Clamp Strap Scrs. (Sems)	(2)
49-96-0070	Socket Screw Wrench		★ 06-97-1800	Lock Washer	(4)
★ 48-03-0010	Plug Adaptor		23-86-0050	Rubberized Retaining Washer	(2)
42-70-0050	Spring Clip		06-55-1800	Nut (1/4-32 Thread, Incl. with item 38)	
06-85-0050	No. 4x1/4 P.K. Pan Hd, Speed Control Name Plate Scr. (4)		06-85-0250	No. 6x3/8 P.K. Pan Hd, Regulator Mtg. Screws	(2)
06-81-3750	8-32x1" Oval Hd, Handle Cover Scrs. (2)		06-81-5875	6-32x1-1/8 Fil, Hd, Control Housing Mtg. Sems	(2)
06-97-3200	Lock Washer	(2)	06-97-3400	Lock Washer	(3)
06-81-3700	8-32x7/8 Oval Hd, Scrs. (2)		06-42-1200	No. 212 Woodruff Key	
42-14-0100	Wire Baffle		06-81-8650	6-32x1/4 Rd, Hd, Sem	