



SERVICE PARTS LIST

BUL. 54-42-2050

SCREWDRIVER

REVISED BUL. 6124-1 DATE Feb. '68

MODEL NO. 615BR

Starting Serial No. **124-1001**

WIRING INSTR.

Both Model and Serial No. must be furnished to obtain correct parts.

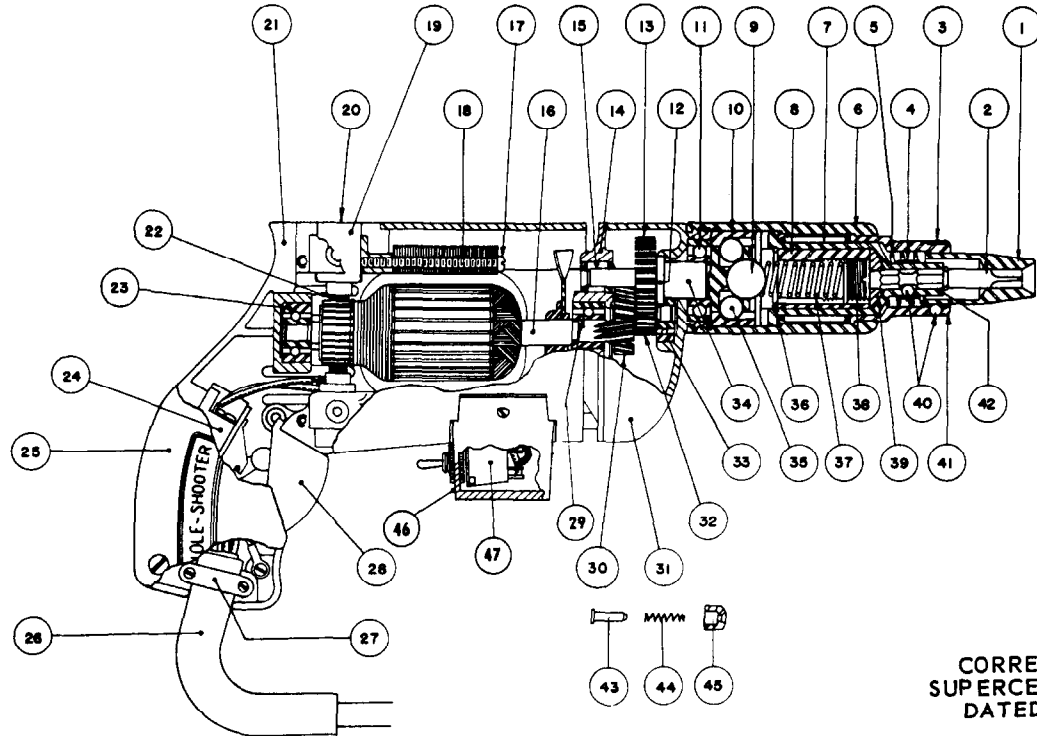

CORRECTS AND SUPERCEDES 6124-1 DATED 11/12/57

ILLUSTRATED PARTS

FIG.	PART NO.	DESCRIPTION OF PART	FIG.	PART NO.	DESCRIPTION OF PART
1	Specify Size	Finder Sleeves	25	3B1-1	Handle Cover
2	Specify Size	Hexagonal Bits	26	18G-8SR2	Cord Set
3	6A22-1	Finder Retaining Spring	27	8B1-3	Cord Clamp
4	6A21-1	Bit Retaining Spring	28	3B1-2	Switch Trigger
5	6A22-2	Finder Spring	29	WC87037	Armature Ball Brg. (Pinion End)
6	6A-20	Sleeve	30	6A-14	Intermediate Gear
7	B-1616	Clutch Assembly Needle Bearing	31	3A-3C	Gear Case
8	6A21-2A	Threaded Insert	32	1A-13	Intermediate Pinion Shaft
9	9/16 Dia.	Master Ball	33	ND36	Pinion Shaft Ball Bearing
10	6A8-1	Clutch Collar	34	6A-8A	Spindle
11	93L00	Spindle Ball Bearing	35	5/16 Dia.	Driving Balls each
12	XSO-219	Spindle Snap Ring	36	XRO-432	Retaining Ring
13	1A-111	Spindle Gear	37	6A21-4	Torque Limiting Spring (Normal)
14	3A-2C	Diaphragm	37a	6A21-5&-7	Torque Limiting Spring (Light&Heavy)
15	M-471	Spindle Needle Bearing	38	6A21-3	Adjusting Screw
16	7B-600R	Armature Assembly	39	6A21-6	Bit Backing Washer
17	#6-32x1 1/4 Fil.	Hd. Field Screws	40	5/32 Dia.	Bit and Finder Retaining Balls each
18	8B-700	Field Assembly	41	6A-22	Finder Guide
19	7B-320	Brush Holder Assembly	42	6A-21A	Chuck
20	3A-40	Brush Retaining Cap	43	3B15-1	Trigger Lock Shift
21	6BR-1	Motor Housing	44	3A15-4	Trigger Lock Spring
22	8B-370	Carbon Brush Assembly	45	3A15-2	Trigger Lock Button
23	WC87037	Ball Bearing	46	6B1-4	Reversing Switch Housing
24	8909K209	Switch	47	8908K355	Reversing Switch

MISCELLANEOUS PARTS NOT SHOWN

SIZE OR PART NO.	DESCRIPTION OF PART	SIZE OR PART NO.	DESCRIPTION OF PART
M-361	Int. Pinion Needle Bearing	#8-32x1-3/8 Fil. Hd.	Gear Case Screws (2)
#6-32x5/16 Fil. Hd.	Sem Switch Mounting Screw	#8-32x7/8 Fil. Hd.	Gear Case Screws (2)
#8-32x3/4 Fil. Hd.	Handle Cover Screws (3)	#4x1/4 Drive-In	Name Plate Screws (2)
#10-32x1/4 Hd'less	Slotted Brush Holder Screws(2)	615-1R	Name Plate
#8-32x1/2 Fil. Hd.	Cord Clamp Screws (2)	#201	Woodruff KeyScrews
#6-32x1/4 (Brass)	Rd. Hd.	#207	Woodruff Key
3PA-1	Attach. Plug Adaptor		