



# SERVICE PARTS LIST

**BUL. 54-42-4050**

## SCREWDRIVER

REVISED BUL. 6135-1 DATE Feb. '68

**Catalog No. 6620-1**

Starting Serial No. **135-1001**

WIRING INSTR.

Both Model and Serial No. must be furnished to obtain correct parts.

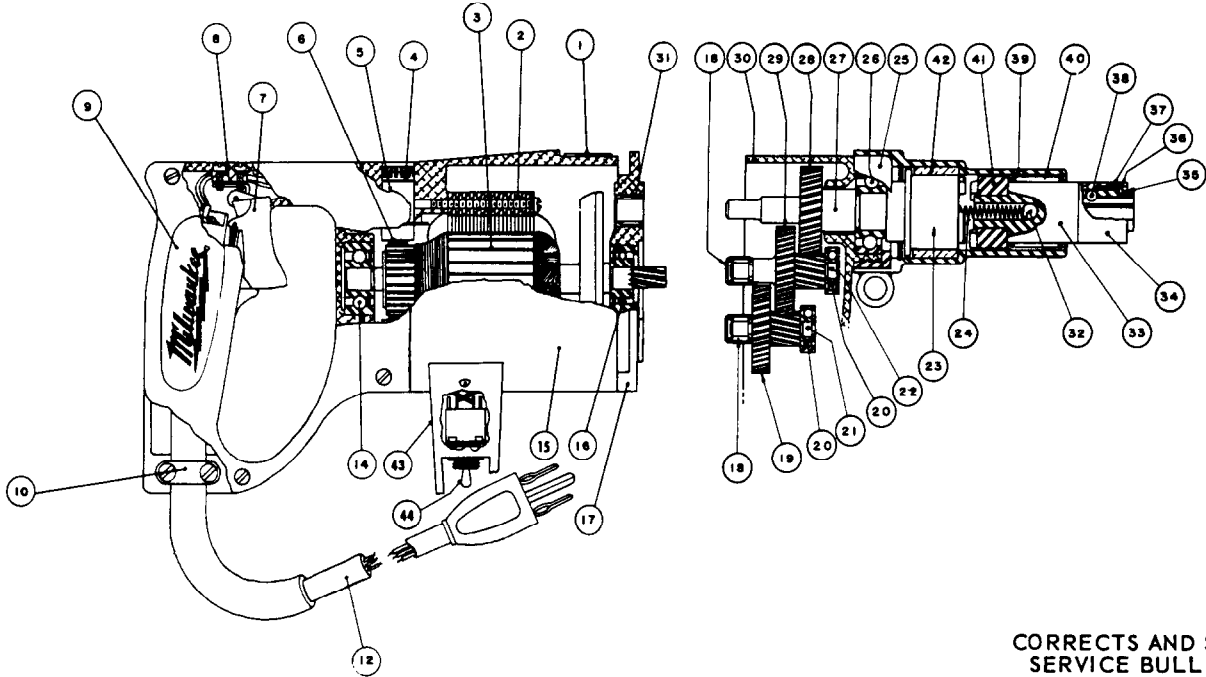

**CORRECTS AND SUPERCEDES SERVICE BULLETIN 6135-1 DATED 12/26/57**

### ILLUSTRATED PARTS

FIG.	PART NO.	DESCRIPTION OF PART
1	12-98-0800	Name Plate
2	18-42-1041	Field Assembly
3	16-42-1210	Armature Assembly
4	23-44-0060	Brush Retaining Screw
5	22-22-0080	Brush Holder Assembly
6	22-18-0100	Carbon Brush Assembly
7	23-66-0230	Switch
8	45-36-0110	Switch Spacer
9	28-20-3141	Handle Cover
10	28-17-0400	Cord Clamp Strap
12	22-64-0170	Cord Set
14	02-04-0970	Ball Bearing
15	28-50-4482	Motor Housing
16	02-04-0940	Ball Bearing
17	28-28-0661	Diaphragm
18	02-50-1640	Needle Bearing
19	32-40-1241	Intermediate Gear
20	02-04-0640	Ball Bearing
21	36-66-2801	Intermediate Pinion Shaft
22	36-66-2901	Intermediate Pinion Shaft
23	43-90-0060	Driving Jaw

FIG.	PART NO.	DESCRIPTION OF PART
24	40-50-0900	Separating Spring
25	42-52-0071	Bearing Cap
26	02-04-1560	Ball Bearing
(2)	27	38-50-3601 Spindle
(2)	28	32-75-2061 Spindle Gear
(2)	29	32-75-2041 Spindle Gear
30	28-14-0961	Gear Case
31	02-50-2110	Needle Bearing
32	02-02-0250	Ball
33	42-66-0165	Chuck Assembly
34	42-76-0090	Bit Retaining Collar
35	34-60-1300	Collar Stop Washer Retaining Ring
36	45-88-0070	Collar Stop Washer
37	40-50-1000	Collar Stop Spring
38	02-02-0180	Bit Retaining Ball
(2)	39	02-50-6440 Needle Bearing
40	45-22-0070	Sleeve Assembly
(2)	41	43-90-0050 Chuck Jaw
42	42-24-0080	Driving Jaw Bearing
43	28-50-7031	Switch Housing
44	23-66-0220	Reversing Switch

### MISCELLANEOUS PARTS NOT SHOWN

PART NO.	DESCRIPTION OF PART	PART NO.	DESCRIPTION OF PART
34-80-2800	Driving Jaw Retaining Ring	06-81-5800	6-32x5/16 Fil.Hd.Sems Switch Mounting Scs.(2)
43-62-0161	Handle	23-86-0110	Brush Holder Insul. Washer (2)
48-30-3250	Bit and Finder	23-16-0085	Switch Insulator
48-30-3275	Bit and Finder	06-81-6100	8-32x7/16 Fil.Hd.Sems Cord Clamp Strap Scs.(2)
48-30-3300	Bit and Finder	06-81-8625	6-32x1/4 Rd.Hd. Ground Screw (Brass)
48-32-2070	Square Driver (For Sockets)	06-81-6350	8-32x1 Fil.Hd. Gear Case Screws (Sem) (2)
06-75-0500	3/8"-16x1 Long Cap Screw	06-81-6650	8-32x1 1/4 Fil.Hd. Gear Case Screws (Sem) (2)
49-96-4060	9/16 Open End Wrench	06-81-6600	8-32x1 1/2 Fil.Hd. Field Screws (Sem) (2)
06-42-0800	Woodruff Keys	(3)	06-83-2650 1/4-20x3/8 Hd'less Brush Holder Set Screws(2)
06-81-8400	4-40x1/4" Rd.Hd.Name Plate Screws Sems	(2)	06-81-3700 8-32x7/8 Oval Hd. Handle Cover Screws (4)