



SERVICE PARTS LIST

BULLETIN NO.
54-42-0176

SPECIFY CATALOG NO. AND SERIAL NO. WHEN ORDERING PARTS		REVISED BULLETIN 54-42-0175	DATE Nov. '94
POSITIVE CLUTCH REV. SCREWDRIVER		WIRING INSTRUCTION 58-01-0032	
CATALOG NO. 6760-1	STARTING SERIAL NO. 830B		

EXAMPLE:
Component Parts (Small #) Are Included
When Ordering The Assembly (Large #).

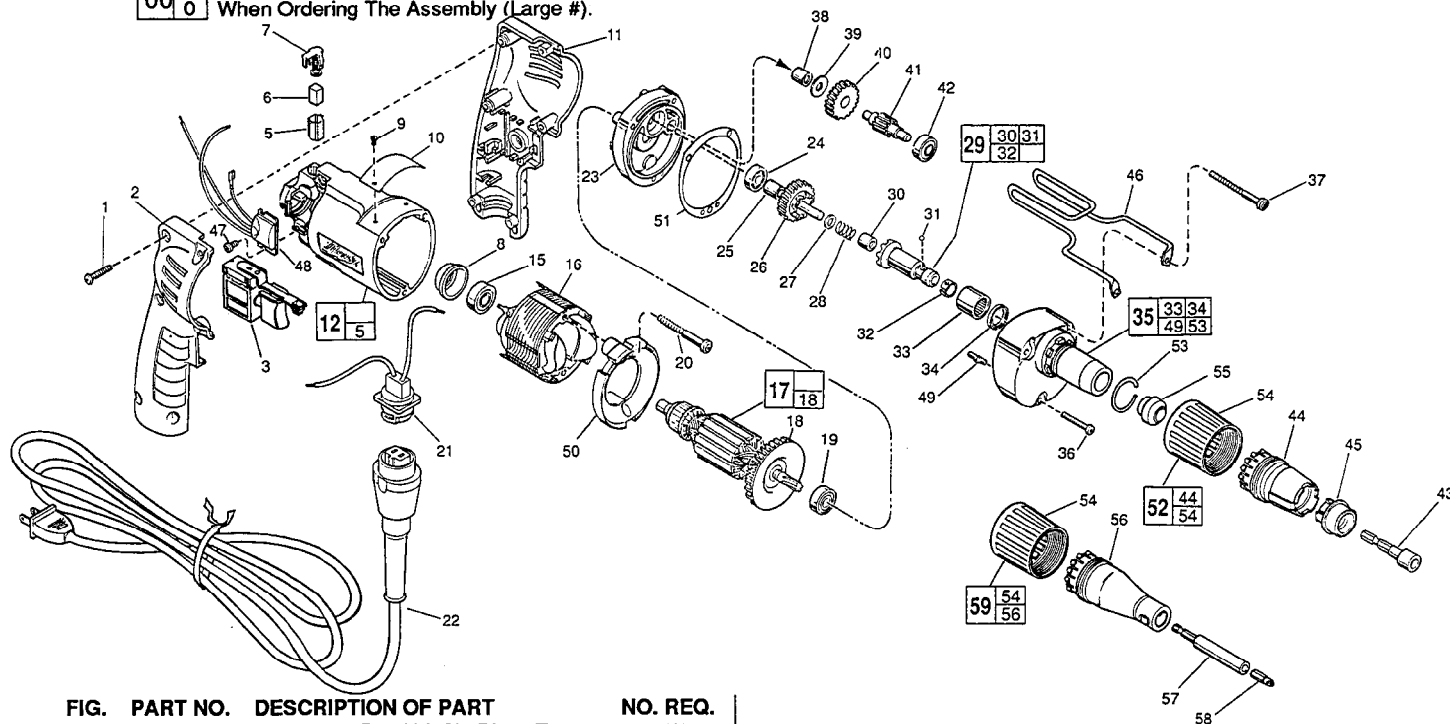

FIG.	PART NO.	DESCRIPTION OF PART	NO. REQ.
	1	06-82-7284 8-16 x 3/4" Pan Hd. Slit. Plast. T-20	(6)
	2	31-44-1845 Right Handle Half	(1)
	3	23-66-2145 Speed Control Switch	(1)
	5	22-20-0830 Brush Tube	(2)
	6	22-16-0275 Carbon Brush	(2)
	7	23-52-1570 Brush Spring Assembly	(2)
	8	22-72-0100 Bearing Cup	(1)
★	9	06-72-1720 Nameplate Rivet	(2)
	10	12-99-0860 Service Nameplate	(1)
	11	31-44-1840 Left Handle Half	(1)
★	12	14-38-0591 Motor Housing Assembly	(1)
	15	02-04-0645 Ball Bearing	(1)
	16	18-11-0150 120 Volt Field	(1)
	17	16-10-0690 120 Volt Armature	(1)
	18	22-84-0880 Fan Assembly	(1)
	19	02-04-0851 Ball Bearing	(1)
	20	06-82-7203 7-18 x 2-1/8" Pan Hd. Slit. Plast. T-20	(2)
	21	22-56-0665 Blade Housing Assembly	(1)
	22	48-76-5010 Cord Set	(1)
	23	28-28-1961 Diaphragm	(1)
	24	02-04-0645 Ball Bearing	(1)
	25	45-36-1280 Spacer	(1)
	26	32-10-4045 Clutch Gear Assembly	(1)
	27	45-88-0712 Thrust Washer	(1)
	28	40-50-6600 Separator Spring	(1)
	29	42-66-0775 Clutch Chuck Assembly	(1)
	30	02-50-2400 Needle Bearing	(1)
	31	02-02-0130 Steel Ball	(1)
	32	40-50-0510 Bit Retaining Spring	(1)
	33	02-50-4220 Needle Roller Bearing	(1)
	34	45-06-0570 Oil Seal	(1)
	35	14-30-0740 Gear Case Assembly	(1)
	36	06-82-7344 7-18 x 1-1/2" Pan Hd. Slit. Plast. T-20	(1)
	37	06-82-7464 7-18 x 2-3/4" Pan Hd. Slit. Plast. T-20	(2)
	38	02-50-2410 Needle Bearing	(1)
	39	45-88-7990 Thrust Washer	(1)
	40	32-40-1612 Intermediate Gear	(1)
	41	36-66-4101 Intermediate Pinion Shaft	(1)
	42	02-04-0645 Ball Bearing	(1)

FIG.	PART NO.	DESCRIPTION OF PART	NO. REQ.
	43	49-66-3016 5/16" Hex Socket	(1)
	44	31-51-0100 Locator	(1)
	45	49-26-0400 1/4" Tek Guide	(1)
		49-26-0405 5/16" Tek Guide	(1)
		49-26-0410 3/8" Tek Guide	(1)
	46	42-70-5080 Belt Clip	(1)
	47	06-82-7212 4-20 x 1/4" Pan Hd. Slit. Plast. T-10	(1)
	48	14-20-0750 Remote Electronic Assembly	(1)
	49	06-65-0825 1/8 x 1/2 Groove Pin 5	(1)
	50	42-14-0380 Baffle	(1)
	51	43-44-0925 Gasket	(1)
	52	49-26-1080 Locator Assembly	(1)
	53	44-90-0401 Locator Ring	(1)
	54	31-58-0510 Locator Sleeve	(1)
	55	30-37-0045 Guide	(1)
	56	31-51-0090 Locator	(1)
	57	48-32-3065 Magnetic Bit Holder	(1)
	58	48-32-1050 #2 Insert Bit	(1)
	59	49-26-1035 Locator Assembly	(1)

FIG. LUBRICATION
35 1-1/2 Oz. Type "E" Grease, No. 49-08-4122.
Place Near Intermediate Shaft Ball Bearing In Gear Case.

FIG. NOTES
1 Torque to 18-28 In./Lbs.
20,36,37 Torque to 15-20 In./Lbs.
47 Torque to 3-5 In./Lbs.
8 Place in motor housing before inserting armature.
30,33,38 Press only on end with manufacturer ID.
33 Press 13/16" from cast surface.
38 Press flush to casting surface.
34 Spring side towards rear of gear case.
15,42,24 Seal towards armature.
30 Press 11/64" from clutch face.

MILWAUKEE ELECTRIC TOOL CORPORATION
13135 W. LISBON RD., BROOKFIELD, WI 53005