



SERVICE PARTS LIST

BULLETIN NO.
55-42-6251

SPECIFY CATALOG NO. AND SERIAL NO. WHEN ORDERING PARTS		REVISED BULLETIN 55-42-6250	DATE June 2012
DEPTH LOCATING TEK DRIVER			
CATALOG NO. 6790-50	STARTING SERIAL NO. 179B	WIRING INSTRUCTION See Pages 2 & 3	

EXAMPLE:
Component Parts (Small #) Are Included
When Ordering The Assembly (Large #).

00
0

★ = Part number change from previous service parts list.

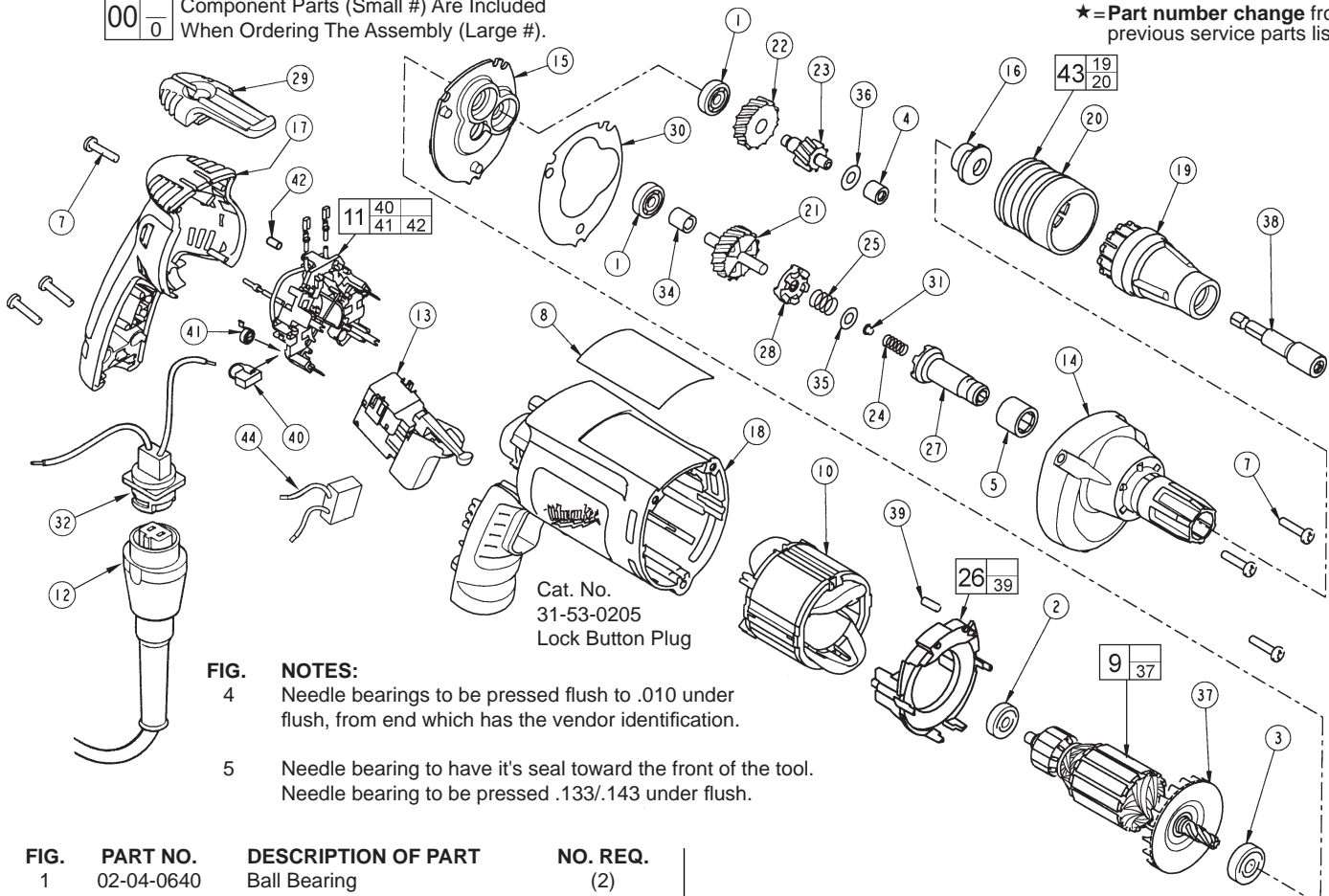

FIG. NOTES:

- 4 Needle bearings to be pressed flush to .010 under flush, from end which has the vendor identification.
- 5 Needle bearing to have it's seal toward the front of the tool. Needle bearing to be pressed .133/.143 under flush.

FIG.	PART NO.	DESCRIPTION OF PART	NO. REQ.
1	02-04-0640	Ball Bearing	(2)
2	02-04-0645	Ball Bearing	(1)
3	02-04-0852	Ball Bearing	(1)
4	02-50-2400	Needle Bearing	(1)
5	02-50-3245	Needle Bearing	(1)
7	06-82-7275	7-18 x 3/4 Slotted Plastite Torx T-20	(6)
8	12-99-2690	Service Nameplate	(1)
9	16-14-2205	Armature	(1)
10	18-04-2200	Field	(1)
11	22-18-1220	Brush Card Assembly	(1)
12	48-76-5012	Quik-Lok Cord Set	(1)
12	22-64-0684	Quik-Lok Cord Set (Australia)	(1)
★ 13	23-66-2615	Defond Switch (See page 2 wiring)	(1)
★ 13a	23-66-2135	Marquardt Switch (See page 3 wiring)	(1)
14	28-14-2380	Gearcase	(1)
15	28-28-2315	Diaphragm	(1)
16	30-37-0055	Tek Nose Guide	(1)
17	31-15-2030	Handle Halve	(1)
★ 18	31-50-4030	Motor Housing	(1)
19	31-51-0104	Tek Locator	(1)
20	31-58-0515	Snap Sleeve	(1)
21	32-10-0525	Clutch Gear Assembly	(1)
22	32-40-0100	Intermediate Gear	(1)
23	36-66-0120	Intermediate Shaft	(1)
24	40-50-0095	Separator Spring	(1)
25	40-50-8515	Bias Spring	(1)
26	42-14-0460	Baffle Assembly	(1)
27	42-66-0715	Clutch Chuck Assembly	(1)
28	42-70-0310	Drive Clutch	(1)
29	42-70-5280	Belt Clip	(1)
30	43-44-0985	Gasket	(1)
31	44-60-0505	Thrust Pin	(1)
32	22-56-1015	Blade Housing Assembly	(1)
34	45-36-1280	Spacer	(1)

FIG.	PART NO.	DESCRIPTION OF PART	NO. REQ.
35	45-88-0555	Clutch Thrust Washer	(1)
36	45-88-7990	Thrust Washer	(1)
37	22-84-0845	Fan Assembly	(1)
38	49-66-3016	5/16 Hex Socket	(1)
39	45-30-0030	Slug	(2)
40	22-18-1320	Brush Assembly	(2)
41	23-52-1610	Brush Spring	(2)
42	45-30-0035	Slug	(1)
43	49-26-1082	TEK Locator Assembly	(1)
44	22-33-0550	Suppressor	(1)

FIG. LUBRICATION:

- 21,25 Place .02 oz. (.5 grams) of type "Y" grease, No 49-08-5270, on bias spring. Place .02 oz. (.5 grams) total of grease in the clutch pockets of clutch gear.
- 14 Place .11 oz. (3.1 grams) of type "Y" grease on top of the inserted intermediate needle bearing. After inserting the pinion assembly, place .48 oz. (13.6 grams) of grease at the armature pinion location in the gearcase pocket and push down .20".
- 14,15 Apply a light film of type "Y" grease to needle and ball bearing pockets in diaphragm and gearcase prior to pressing bearings in.
- 24,31 Place .02 oz. (.5 grams) of type "Y" grease to clutch thrust washer, thrust pin and separator spring during assembly.

WIRING INSTRUCTIONS

TITLE	DOUBLE REDUCTION PISTOL GRIP TOOLS	BULLETIN
MILWAUKEE ELECTRIC TOOL CORP. 13135 WEST LISBON RD. BROOKFIELD, WIS.	DATE	

Route white field wire #5 from brush card between the post and the top of the rear bearing bore first and then around bearing bore as shown.

Route blue brush wire #9 and white brush wire #8 through wire traps and over rear bearing bore as shown.

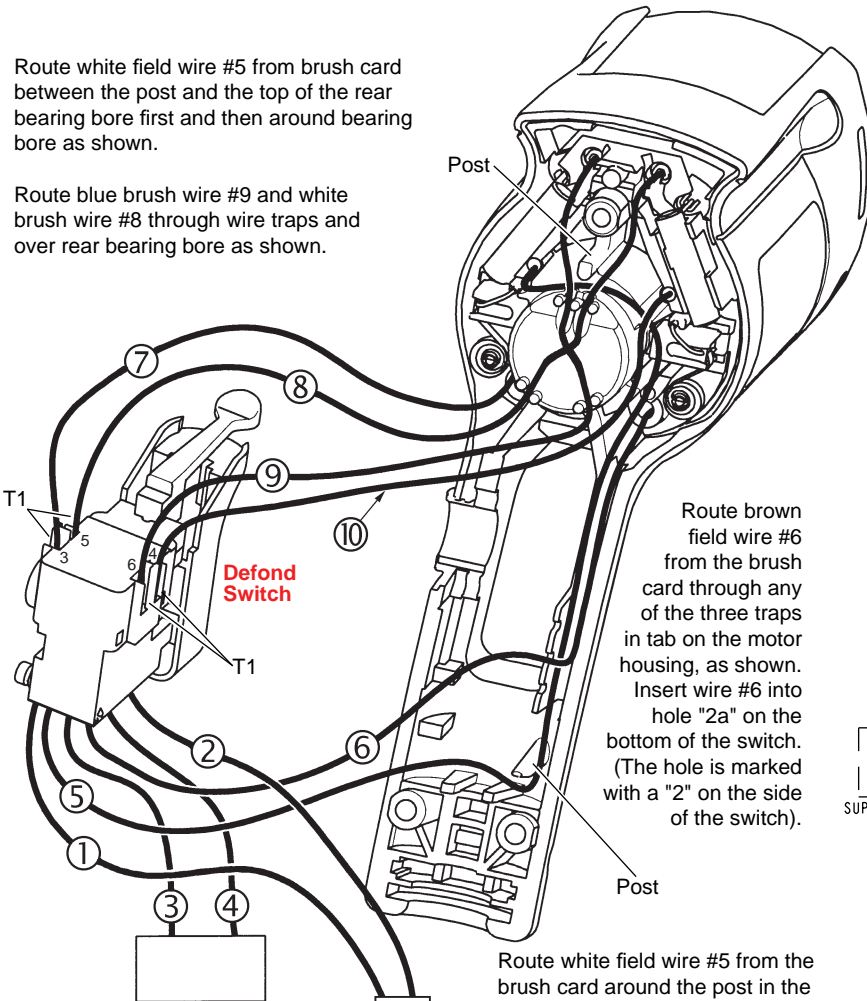

Route brown field wire #6 from the brush card through any of the three traps in tab on the motor housing, as shown. Insert wire #6 into hole "2a" on the bottom of the switch. (The hole is marked with a "2" on the side of the switch).

Insert black suppressor wires #3 and #4 into holes marked "1a" and "2b" on the bottom of the switch. Wires can go in either hole.

Fixed cord shown

Route white field wire #5 from the brush card around the post in the motor housing and into either hole "1a" on bottom of the switch.

Insert brown wire #1, from the cord or blade housing assembly, into the hole marked "2" on the bottom of the switch.

Insert blue wire #2, from the cord or blade housing assembly, into the hole marked "1" on the bottom of the switch.

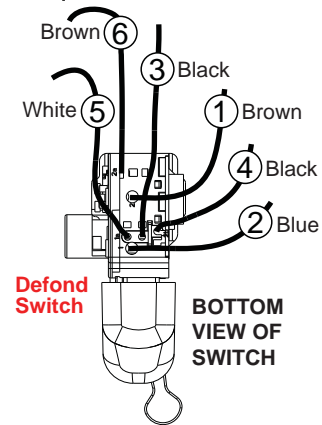

BOTTOM VIEW OF SWITCH

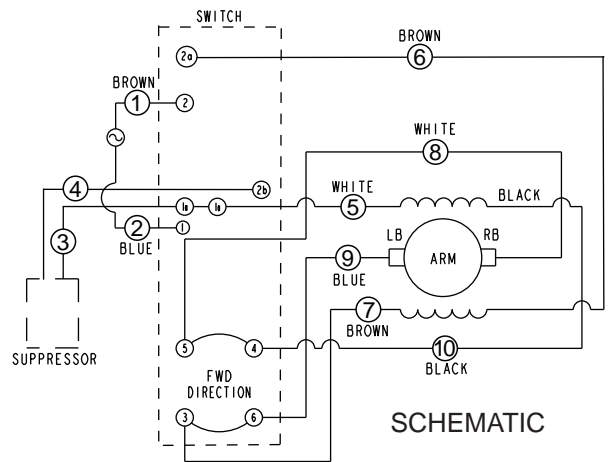

SCHEMATIC

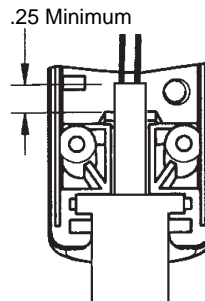

Fixed Cord Installation

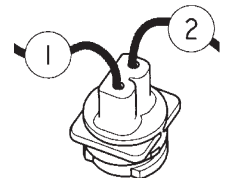

For double insulated tools with 2-wire quik-lok cords, orientate the blade housing assembly as shown and place blue wire #2 first into the bottom of the handle portion of the motor housing.

WIRING SPECIFICATIONS

Wire No.	Wire Color	Origin or Gauge	Length	Terminals, Connectors and 1 or 2 End Wire Preparation
1	Brown	*	----	* Component of cord set or blade housing assembly.
2	Blue	*	----	* Component of cord set or blade housing assembly.
3	Black	**	----	** Component of suppressor assembly.
4	Black	**	----	** Component of suppressor assembly.
5	White	***	----	*** Component of the brush card assembly.
6	Brown	***	----	*** Component of the brush card assembly.
7	Brown	***	----	*** Component of the brush card assembly.
8	White	***	----	*** Component of the brush card assembly.
9	Blue	***	----	*** Component of the brush card assembly.
10	Black	***	----	*** Component of the brush card assembly.

BULK LEAD WIRE - BULLETIN NO. 58-01-0003

TERMINAL DESCRIPTION

Code	Part No.	Qty.
T1	23-74-1060	

WIRING INSTRUCTIONS

TITLE	DOUBLE REDUCTION PISTOL GRIP TOOLS	BULLETIN
MILWAUKEE ELECTRIC TOOL CORP. 13135 WEST LISBON RD. BROOKFIELD, WIS.	DATE	

Route white field wire #5 from brush card between the post and the top of the rear bearing bore first and then around bearing bore as shown.

Route blue brush wire #9 and white brush wire #8 through wire traps and over rear bearing bore as shown.

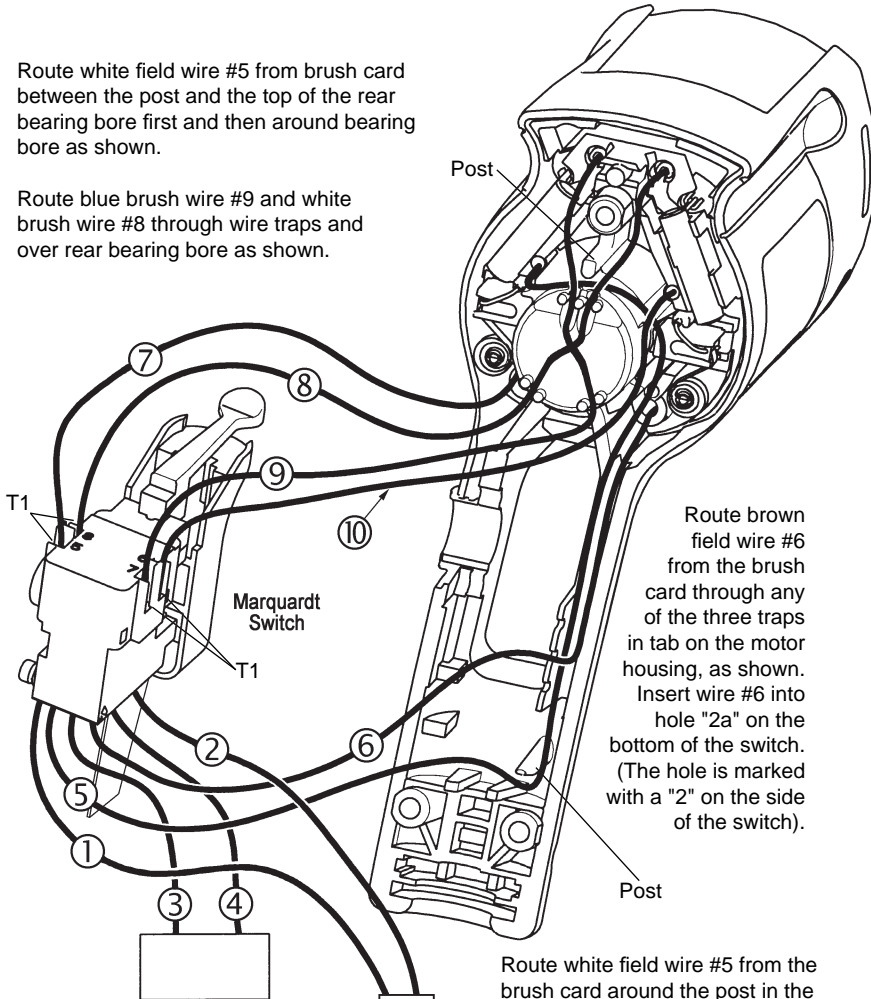

Route brown field wire #6 from the brush card through any of the three traps in tab on the motor housing, as shown. Insert wire #6 into hole "2a" on the bottom of the switch. (The hole is marked with a "2" on the side of the switch).

Route white field wire #5 from the brush card around the post in the motor housing and into either hole "1a" on bottom of switch.

Insert brown wire #1, from the cord or blade housing assembly, into the hole marked "2" on the bottom of the switch.

Insert blue wire #2, from the cord or blade housing assembly, into the hole marked "1" on the bottom of the switch.

Insert black suppressor wires #3 and #4 into holes marked "1a" and "2b" on the bottom of the switch. Wires can go in either hole.

Fixed cord shown

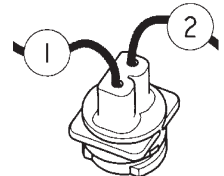
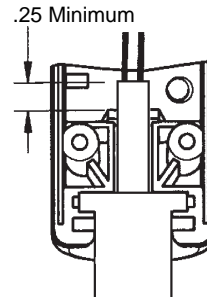
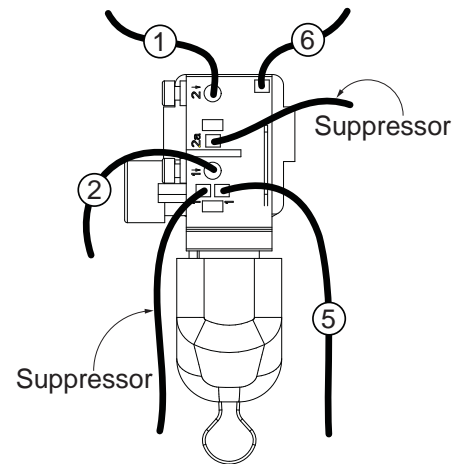
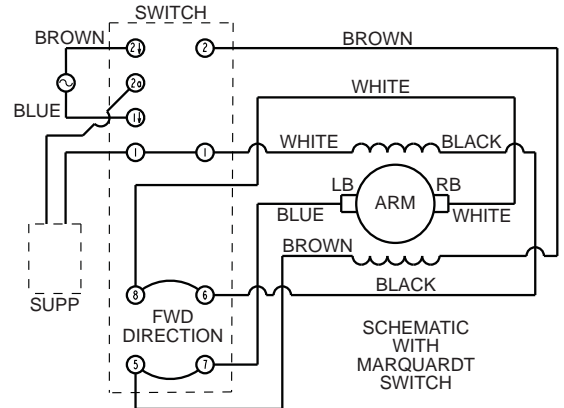

For double insulated tools with 2-wire quik-lok cords, orientate the blade housing assembly as shown and place blue wire #2 first into the bottom of the handle portion of the motor housing.

WIRING SPECIFICATIONS

Wire No.	Wire Color	Origin or Gauge	Length	Terminals, Connectors and 1 or 2 End Wire Preparation
1	Brown	*	----	* Component of cord set or blade housing assembly.
2	Blue	*	----	* Component of cord set or blade housing assembly.
3	Black	**	----	** Component of suppressor assembly.
4	Black	**	----	** Component of suppressor assembly.
5	White	***	----	*** Component of the brush card assembly.
6	Brown	***	----	*** Component of the brush card assembly.
7	Brown	***	----	*** Component of the brush card assembly.
8	White	***	----	*** Component of the brush card assembly.
9	Blue	***	----	*** Component of the brush card assembly.
10	Black	***	----	*** Component of the brush card assembly.

BULK LEAD WIRE - BULLETIN NO. 58-01-0003

TERMINAL DESCRIPTION

Code	Part No.	Qty.
T1	23-74-1060	