



Operating Instructions and Parts Manual

6-inch Bench Top Jointer

Model JJ-6HHBT



JET
427 New Sanford Road
LaVergne, Tennessee 37086
Ph.: 800-274-6848
www.jettools.com

Part No. M-718600
Edition 1 06/2020
Copyright © 2020 JET

13.1 JJ-6HHBT Jointer – Exploded View

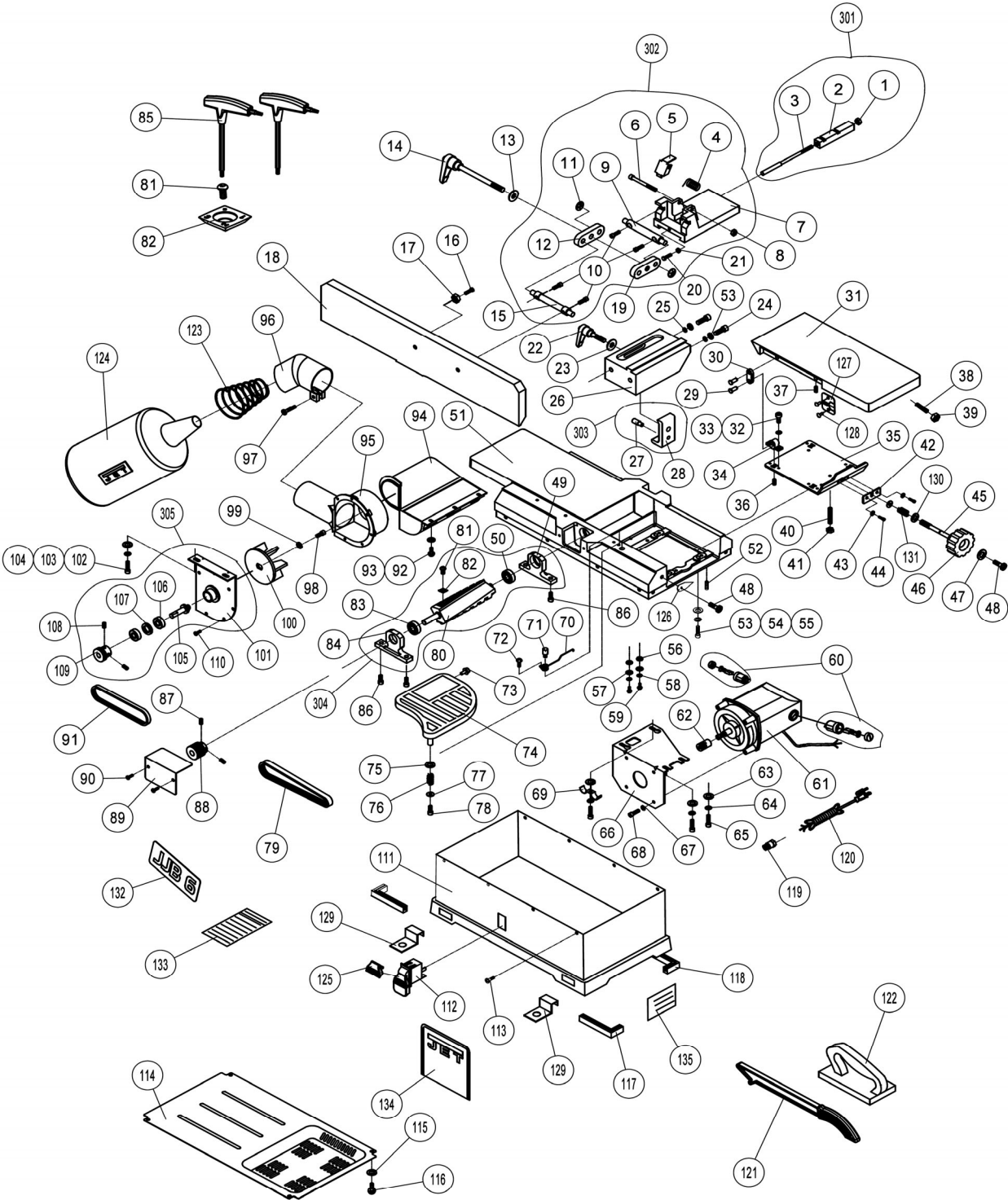

13.2 JJ-6HHBT Jointer – Parts List

Index No.	Part No.	Description	Size	Qty
1	TS-2311061	Hex Nut	M6	1
2	JJ6HHBT-002	Block		1
3	JJ6HHBT-003	Shaft		1
4	JJ6HHBT-004	Spring		1
5	JJ6HHBT-005	Limit Plate		1
6	TS-1503111	Socket Head Cap Screw	M6x50	1
7	JJ6HHBT-007	Fence Bracket		1
8	TS-2311061	Hex Nut	M6	1
9	JJ6HHBT-009	Bracket Shaft		1
10	TS-1503051	Socket Head Cap Screw	M6x20	4
11	JJ6HHBT-011	Push Nut		2
12	JJ6HHBT-012	Right Link		1
13	JJ6HHBT-013	Spacer		1
14	JJ6HHBT-014	Fence Tilting Handle		1
15	JJ6HHBT-015	Plate Shaft		1
16	TS-1481061	Hex Cap Screw	M5x25	1
17	TS-2331051	Cap Nut	M5	1
18	JJ6HHBT-018	Fence		1
19	JJ6HHBT-019	Left Link		1
20	TS-1481061	Hex Cap Screw	M5x25	1
21	TS-2331051	Cap Nut	M5	1
22	JJ6HHBT-022	Fence Sliding Handle		1
23	JJ6HHBT-023	Spacer		1
24	TS-1503041	Socket Head Cap Screw	M6x16	2
25	TS-2361061	Lock Washer	6	2
26	JJ6HHBT-026	Fence Support		1
27	JJ6HHBT-027	Pin		1
28	JJ6HHBT-028	Locking Plate		1
29	JJ6HHBT-029	Pin		8
30	JJ6HHBT-030	Bracket		4
31	JJ6HHBT-031	Infeed Table		1
32	TS-1502021	Socket Head Cap Screw	M5x10	8
33	TS-2361051	Lock Washer	5mm	8
34	JJ6HHBT-034	Connection Bracket		4
35	JJ6HHBT-035	Table Support Plate		1
36	TS-1522011	Socket Set Screw	M5x6	4
37	TS-2276081	Socket Set Screw	M6x8	4
38	TS-1523071	Socket Set Screw	M6x25	1
39	TS-2311061	Hex Nut	M6	1
40	TS-1523081	Socket Set Screw	M6x35	1
41	TS-2311061	Hex Nut	M6	1
42	JJ6HHBT-042	Support Plate		1
43	JJ6HHBT-043	Lock Washer	5mm	2
44	TS-1502021	Socket Head Cap Screw	M5x10	2
45	JJ6HHBT-045	Elevation Screw		1
46	JJ6HHBT-046	Handwheel		1
47	JJ6HHBT-047	Flat Washer	5mm	1
48	TS-1533032	Pan Head Machine Phillips Screw	M5x10	2
49	JJ6HHBT-049	Bearing Housing		1
50	BB-6201ZZ	Ball Bearing	6201-2Z	1
51	JJ6HHBT-051	Body With Outfeed Table		1
52	TS-1523051	Socket Set Screw	M6x16	4
53	TS-1550041	Flat Washer	6mm	6

Index No.	Part No.	Description	Size	Qty
54	TS-2361061	Lock Washer	6mm	4
55	TS-1503071	Socket Head Cap Screw	M6x30	4
56	JJ6HHBT-056	Serrated Washer	5mm	2
57	TS-1550031	Flat Washer	5mm	2
58	TS-2361051	Lock Washer	5mm	2
59	TS-1533032	Pan Head Machine Phillips Screw	M5x10	2
60	JJ6HHBT-060	Motor Brush		2
61	JJ6HHBT-061	Motor		1
62	JJ6HHBT-062	Motor Pulley		1
63	TS-1550041	Flat Washer	6mm	4
64	TS-2361061	Lock Washer	6mm	4
65	TS-1503031	Socket Head Cap Screw	M6x12	4
66	JJ6HHBT-066	Motor Support		1
67	TS-2361051	Lock Washer	5mm	4
68	TS-1503071	Socket Head Cap Screw	M5x10	4
69	JJ6HHBT-069	Cord Clamp		1
70	JJ6HHBT-070	Spring		1
71	JJ6HHBT-071	Pin		1
72	TS-1533032	Pan Head Machine Phillips Screw	M5x10	1
73	JJ6HHBT-073	Bumper		1
74	JJ6HHBT-074	Blade Guard		1
75	JJ6HHBT-075	Bushing		1
76	JJ6HHBT-076	Spring		1
77	TS-1550031	Flat Washer	5mm	1
78	TS-1503071	Socket Head Cap Screw	M5x10	1
79	JJ6HHBT-079	Drive Belt	5PJ170	1
80	JJ6HHBT-080	Cutterhead, Helical Body		1
81	JJ6HHBT-081	Knife Insert Screw		14
82	718601	Knife Inserts (sold in set of 5; includes #81 screws)		14
83	BB-6201ZZ	Ball Bearing	6201-ZZ	1
84	JJ6HHBT-084	Bearing Housing		1
85	JJ6HHBT-085	Star Point Screwdriver		2
86	TS-1504021	Socket Head Cap Screw	M8x12	4
87	TS-2276081	Socket Set Screw	M6x8	1
88	JJ6HHBT-088	Drive Pulley		1
89	JJ6HHBT-089	Cover		1
90	TS-1502011	Socket Head Cap Screw	M5x8	2
91	JJ6HHBT-091	Fan Belt	2PJ140	1
92	TS-1550031	Flat Washer	5mm	3
93	TS-1533032	Pan Head Machine Phillips Screw	M5x10	3
94	JJ6HHBT-094	Chip Collector		1
95	JJ6HHBT-095	Chip Exhaust		1
96	JJ6HHBT-096	Dust Chute		1
97	TS-2286252	Pan Head Machine Phillips Screw	M6x25	1
98	TS-1502021	Socket Head Cap Screw	M5x10	1
99	JJ6HHBT-099	Flat Washer	Ø15xØ5x2	1
100	JJ6HHBT-100	Fan		1
101	JJ6HHBT-101	Mounting Plate		1
102	TS-1550041	Flat Washer	M6	2
103	TS-2361061	Lock Washer	M6	2
104	TS-1503031	Socket Head Cap Screw	M6x12	2
105	JJ6HHBT-105	Fan Shaft		1
106	BB-6000ZZ	Ball Bearing	6000-ZZ	2
107	JJ6HHBT-107	Spacer		1
108	TS-1523031	Socket Set Screw	M6x10	1
109	JJ6HHBT-109	Fan Pulley		1

Index No.	Part No.	Description	Size	Qty
110	JJ6HHBT-110	Self-Tapping Screw	ST4.2x9.5	6
111	JJ6HHBT-111	Base		1
112	JJ6HHBT-112	Switch		1
113	TS-1513011	Socket Head Flat Screw	M5x10	13
114	JJ6HHBT-114	Cover		1
115	TS-1550021	Flat Washer	4mm	6
116	TS-1532032	Pan Head Machine Phillips Screw	M4x10	6
117	JJ6HHBT-117	Foot B		2
118	JJ6HHBT-118	Foot A		2
119	JJ6HHBT-119	Strain Relief		1
120	JJ6HHBT-120	Power Cord		1
121	JJ6HHBT-121	Push Stick		1
122	JJ6HHBT-122	Push Block		1
123	JJ6HHBT-123	Spring		1
124	JJ6HHBT-124	Filter Bag		1
125	JWBS10OS-25-1	Switch Safety Key		1
126	JJ6HHBT-126	Pointer		1
127	JJ6HHBT-127	Depth Scale		1
128	JJ6HHBT-128	Rivet		2
129	JJ6HHBT-129	Mounting Bracket (set of 4)		4
130	TS-1550071	Flat Washer	10mm	2
131	JJ6HHBT-131	Spring		1
132	JJ6HHBT-132	Model Label		1
133	JJ6HHBT-133	JET Warning Label		1
134	JJ6HHBT-134	JET Logo Label	4"x4"	1
135	JJ6HHBT-135	ID Label		1
	JJ6HHBT-136	Motor Label (not Shown)		1
301	JJ6HHBT-301	Block Assembly (#1 thru 3)		1
302	JJ6HHBT-302	Fence Bracket Assembly (#4 thru 12, #15, #19 thru 21)		1
303	JJ6HHBT-303	Locking Plate Assembly (#27, #28)		1
304	JJ6HHBT-304	Cutterhead Helical Assembly (#80 thru 85, #49, #50)		1
305	JJ6HHBT-305	Mounting Plate Assembly (#105 thru 110)		1

Note: Some parts may be listed for reference, but are only available as part of a larger assembly.