



Assembly Instructions and Parts List

Stand Extension for JWL-1221VS Lathes

Stock No. 719203A

WARNING Read and understand the entire owner's manual that accompanied your JWL-1221VS lathe before attempting assembly or operation of accessories.

Inspect contents for shipping damage. Report any damage or part shortages to your distributor. Do not discard shipping materials until accessory is set up and functioning properly.

Shipping contents

- 1 Cross bar
- 1 Leg
- 1 Bracket
- 2 Tube caps
- 2 Levelers with hex nut
- 1 Hardware package, includes:
 - 2 Socket head cap screws, 5/16x3/4
 - 2 Lock washers, 5/16
 - 2 Flat washers, 5/16
 - 6 Socket head cap screws, M8x80
 - 8 Flat washers, 8mm
 - 2 Hex nuts, M8

Tools required for assembly

6mm hex key ("Allen wrench")
Open-end wrenches, 13mm (1/2"); 14mm (9/16")

Assembly

Refer to exploded view on reverse side for parts clarification. Bracketed numbers refer to index numbers in exploded view.

Refer to documents M-719201 and M-719202A for instructions on assembling optional Bed Extension and Stand to lathe.

1. Install two levelers [5] into bottom of leg. A leveler can be adjusted for height and leveling of lathe. Tighten hex nut against leg to secure setting.

2. Install cross bar [4] to middle set of holes with screws and washers [7/8]. Make screws snug but *do not fully tighten yet*.
3. Install bracket [1] onto leg with screws, washers, and nuts [7/8/9]. Gussets on bracket should face inward. Multiple holes allow adjustment of lathe height. Make nuts snug but *do not fully tighten yet*.
4. Place lathe onto stand brackets, and secure with screws and washers [10/11/12]. Insert both screws first, then tighten each securely.
5. Fully tighten all screws and nuts in cross bar [4] and bracket [1].



JET

427 New Sanford Road
LaVergne, Tennessee 37086
Ph.: 800-274-6848
www.jettools.com

Manual No. M-719203A
Edition 1 03/2017

Copyright © 2017 JET, a Division of JPW Industries, Inc.

Specifications

| | |
|--------------------------------------|--|
| Stock no. | 719203A |
| Assembled dimensions (WxDxH) approx. | 571 x 584 x 800 mm (22.5 x 23 x 31-1/2 in.) <i>Stand with extension: 1333 x 584 x 800 mm (52.5 x 23 x 31-1/2 in.)</i> |
| Shipping dimensions (WxDxH) approx. | 790 x 660 x 200 mm (31.1 x 26 x 7.9 in.) |
| Net weight (approx.): | 10 kg (22 lbs) |
| Shipping weight (approx.): | 13 kg (28.6 lbs) |

719203A Stand extension for JWL-1221VS lathes

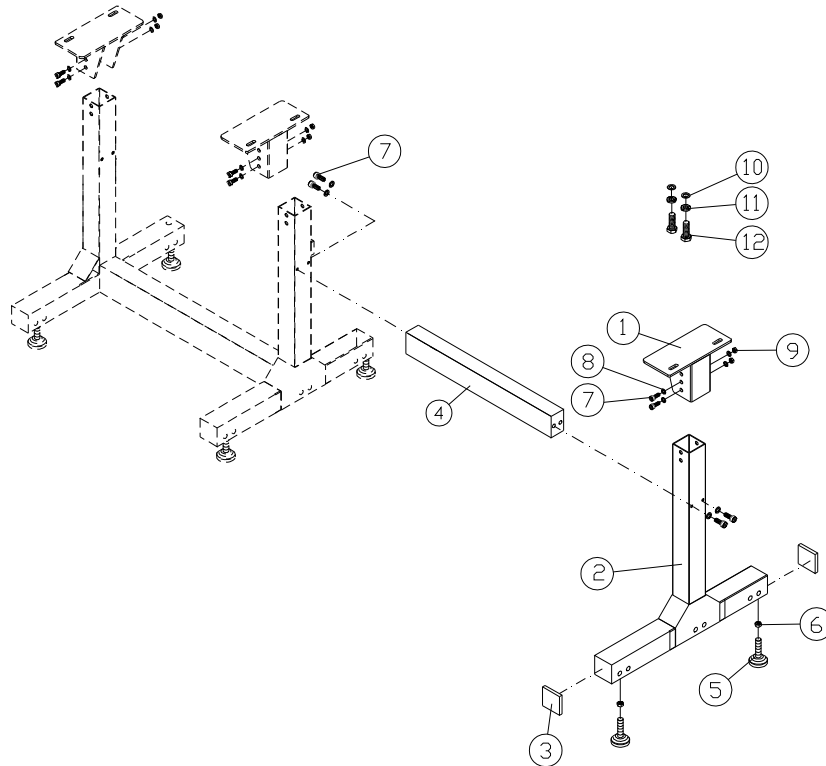

| Index No | Part No | Description | Size | Qty |
|----------|----------------|--|----------------|-----|
| 1 | JWL1221VSS-101 | Bracket | | 1 |
| 2 | JWL1221VSS-102 | Leg | | 1 |
| 3 | JWL1221VSS-103 | Tube Cap | | 2 |
| 4 | JWL1221VSS-204 | Cross Bar | | 1 |
| 5 | JWL1642-206 | Leveler | | 2 |
| 6 | TS-0561031 | Hex Nut | 3/8"-16 | 2 |
| 7 | F005301 | Hex Socket Hd Cap Screw SS | M8-1.25 x 80 | 6 |
| 8 | TS-1550061 | Flat Washer * | M8 | 8 |
| 9 | TS-1540061 | Hex Nut * | M8 | 2 |
| 10 | TS-0680031 | Flat Washer * | 5/16" | 2 |
| 11 | TS-0720081 | Lock Washer * | 5/16" | 2 |
| 12 | TS-0208041 | Socket Head Cap Screw * | 5/16"-18x 3/4" | 2 |
| | JWL1221VSS-HP | Hardware Package (includes items with *) | | |

Note: Hardware package may include extra fasteners.

To order parts or reach our service department, call 1-800-274-6848 Monday through Friday, 8:00 a.m. to 5:00 p.m. CST. Having the Model Number and Serial Number of your machine available when you call will allow us to serve you quickly and accurately.

Non-proprietary parts, such as fasteners, can be found at local hardware stores, or may be ordered from JET. Some parts are shown for reference only, and may not be available individually.