



SERVICE PARTS LIST

BULLETIN NO.
54-02-0130

SPECIFY CATALOG NO. AND SERIAL NO. WHEN ORDERING PARTS		REVISED BULLETIN	DATE
3/4 TON LEVER HOISTS			July '98
CATALOG NOS. 9682-20, 9683-20 and 9684-20	STARTING SERIAL NO. C-1NC	WIRING INSTRUCTION N/A	

00 0

EXAMPLE:
Component Parts
(Small #) Are Included
When Ordering The
Assembly (Large #).

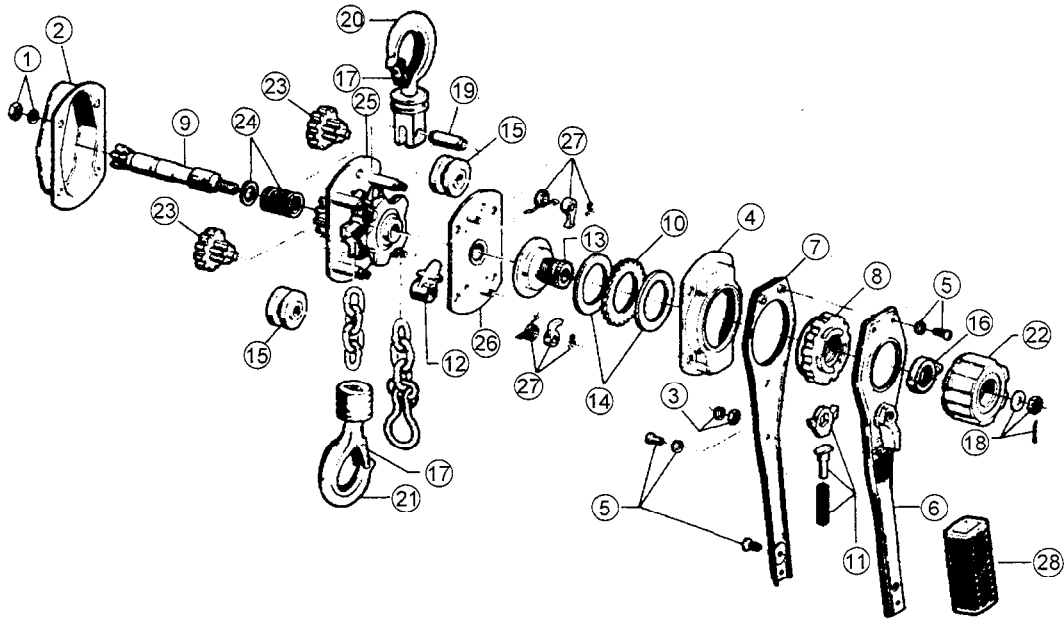

FIG.	PART NO.	DESCRIPTION OF PART	QTY	FIG.	PART NO.	DESCRIPTION OF PART	QTY
1	14-47-0970	Gear Cover Hardware Kit	(1)	17	14-47-0995	Hook Latch Kit (3/4 Ton)	(2)
2	42-92-1235	Gear Cover	(1)	18	14-47-0985	Brake Nut Washer	(1)
3	14-47-0975	Brake Cover Hardware Kit	(1)	19	44-60-1620	Upper Hook Pin	(1)
4	42-92-1250	Brake Cover	(1)	20	14-36-0280	Upper Hook Assembly	(1)
5	14-47-0980	Lever Hardware Kit	(1)	21	14-36-0285	Lower Hook Assembly	(1)
6	31-44-2140	Lever Assembly Front	(1)	22	43-98-0655	Free Chaining Knob	(1)
7	31-44-2145	Lever Assembly Rear	(1)	23	32-60-2680	Gear Set (3/4 Ton)	(1)
8	43-78-0545	Lever Ratchet Hub	(1)	24	40-50-8926	Spring with Seat	(1)
9	36-66-9691	Pinion Shaft	(1)	25	14-47-1045	Side Plate Assembly (Gear Side)	(1)
10	44-84-0300	Ratchet	(1)	26	14-47-1050	Side Plate Assembly (Brake Side)	(1)
11	14-47-0990	Hub Ratchet Pawl Kit	(1)	27	14-47-1055	Pawl with Spring and Retainer Ring	(2)
12	44-77-0130	Stripper	(1)	28	43-62-0255	Handle Grip	(1)
13	43-78-0540	Friction Hub	(1)	---	10-15-1525	Warning Tube, Spanish (not shown)	(1)
14	43-06-0700	Friction Disc	(2)	---	10-15-1530	Warning Tube, French (not shown)	(1)
15	43-56-0595	Chain Guide Roller	(2)	---	12-20-9682	Capacity / Warning Label (not shown)	(1)
16	43-56-0610	Cam Guide (3/4 Ton)	(1)	---	10-20-9700	Free Chaining Tag, English (not shown)	(1)
				---	10-20-9705	Free Chaining Tag, French (not shown)	(1)
				---	10-20-9710	Free Chaining Tag, Spanish(not shown)	(1)