

## Troubleshooting

If the stock being sanded is bowed, warped or otherwise inconsistent, be sure tables are lower than the conveyor surface.

If stock slips on conveyor belt, the tables may be positioned too high. Lower tables to allow stock to remain in contact with the conveyor belt.

## Parts List

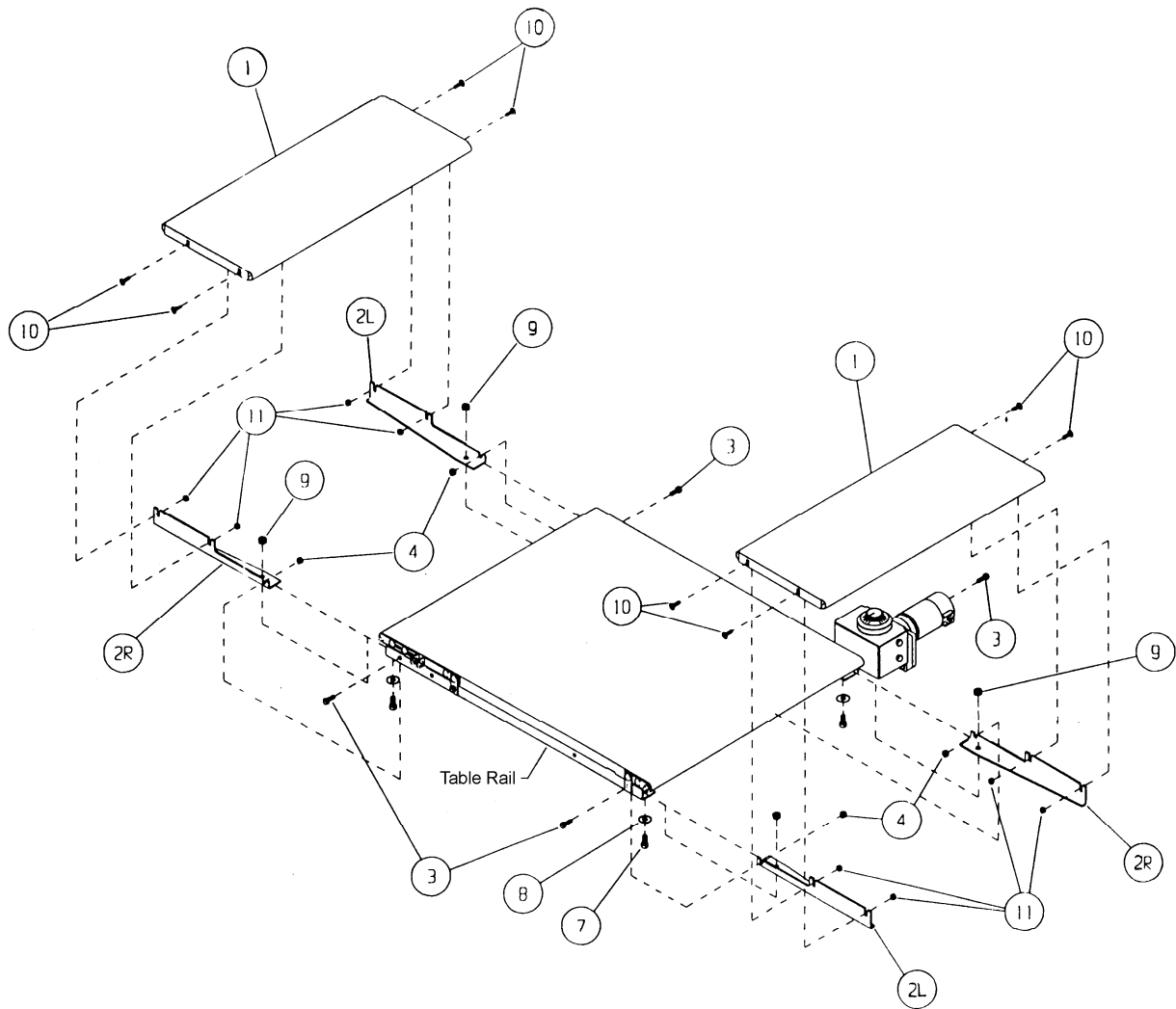

Index No.	Part No.	Description	Size	Qty
1.....	40-0329	Infeed/Outfeed Table		2
2L.....	40-0327	Mounting Bracket (LH)		2
2R.....	40-0328	Mounting Bracket (RH)		2
3.....	10-9103	Hex Head Bolt	5/16"-18x3/4"	2
4.....	12-0152	Square Nut	5/16"-18	2
7.....	10-9205	Hex Head Bolt	3/8"-16x1"	4
8.....	11-9103	Hardened Flat Washer	3/8"	4
9.....	12-0209	Flanged Lock Nut	3/8"-16	4
10.....	6714264	Round Head Square Neck Bolt	1/4"-20x3/4"	8
11.....	6514001	Hex Nut	1/4"-20	8
12.....	6861107	Flat Washer	1/4"	16