

PLANER - JOINTER

AH-115

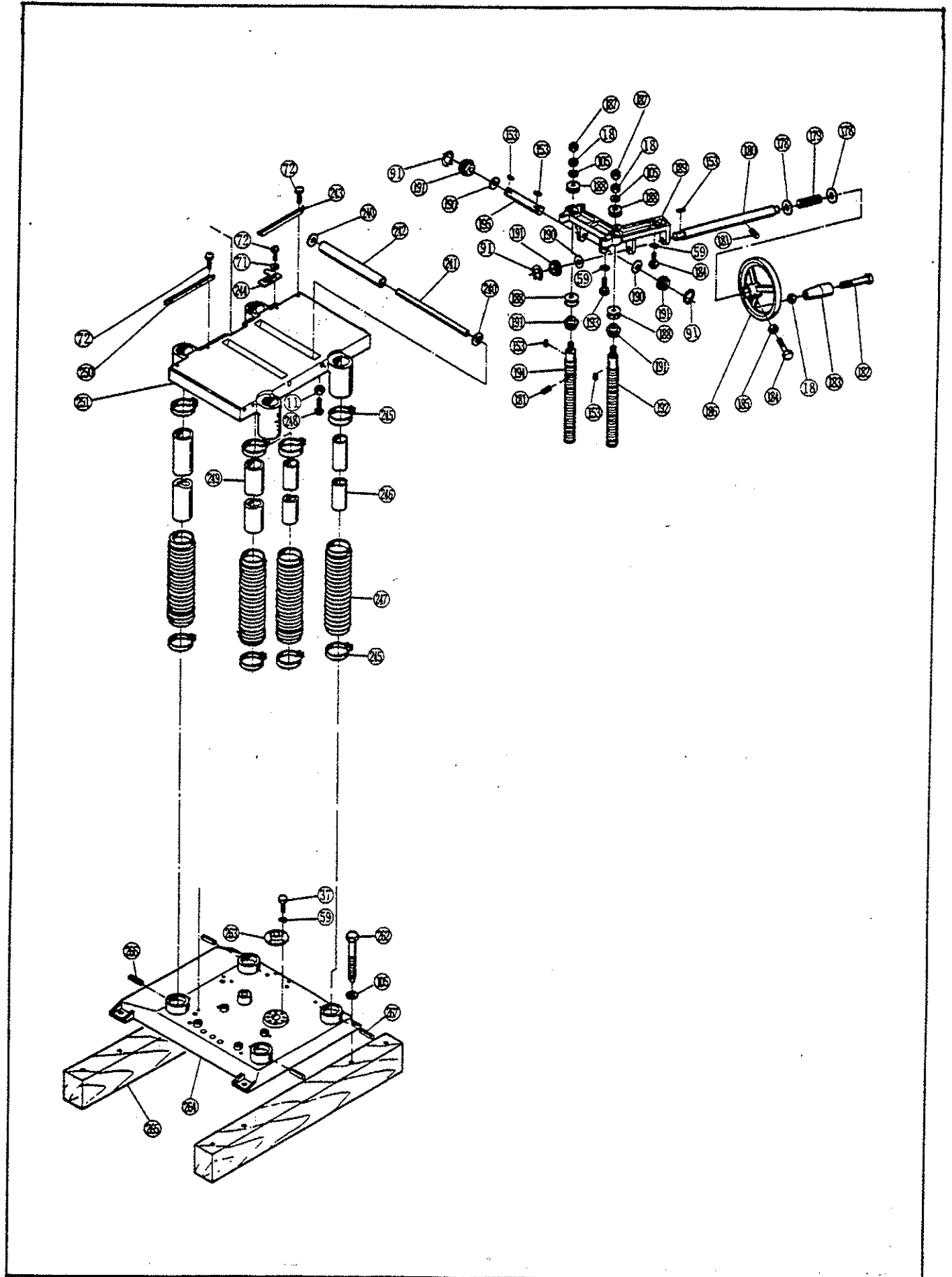

PLANER - JOINTER

AH-115

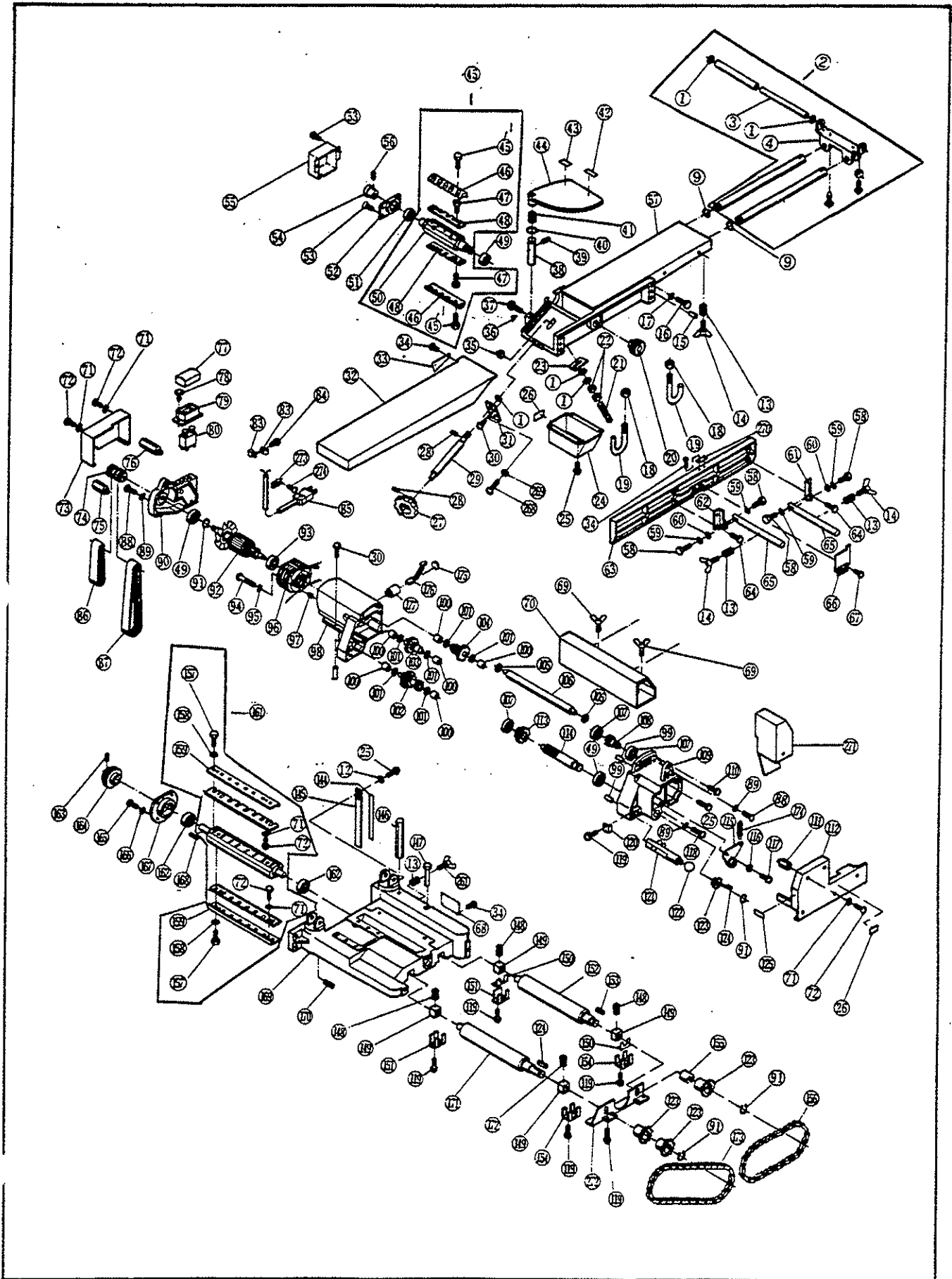

PARTS LIST FOR AFTER SALES SERVICE

MODEL AH115

REF	PART NO.	DESCRIPTION	QTY	REF	PART NO.	DESCRIPTION	QTY
1	9571200	WASHER	2	56	9404025	SPRING PIN	1
2	6080187	AUX. ROLLER ASSY	1	57	6850334	REAR SHOE	1
3	6151759	WASHER	1	58	9190816	HEX HEAD BOLT M8X16	2
4	9404022	SPRING PIN	1	39	9550800	SPRING WASHER M8	13
9	9512000	RETAINING RING	2	60	9570800	WASHER	2
11	9300600	HEX NUT M6	4	61	6151763	BRACKET (R)	1
12	9570600	WASHER	2	62	6151766	BRACKET (L)	1
13	6180004	SET SPRING	5	63	6190223	RULER	1
14	9240620	WING BOLT M6X20	4	64	9020516	PHILLIPS PAN SCREW M5X16	4
15	6120154	KNOCK PIN	6	65	6100383	BAR	2
16	9191040	HEX HEAD BOLT M10X40	4	66	6020100	CUTTER COVER	1
17	9551000	SPRING WASHER M10	4	67	9020512	PHILLIPS PAN SCREW M5X12	2
18	9301000	HEX NUT M10	6	68	6912337	NAME PLATE	1
19	6130584	SPIRAL BOLT M10X125	2	69	9020616	PHILLIPS PAN SCREW M6X16	2
20	6880168	PULLEY	1	70	6880723	EXHAUST PIPE	1
21	6130499	STUD BOLT	1	71	9570500	WASHER	7
22	9301200	HEX NUT M12	2	72	9020510	PHILLIPS PAN SCREW M5X10	12
23	6151768	PLATE	1	73	6880718	BELT COVER	1
24	6880694	DUST COVER	1	74	6860173	PULLEY (1)	1
25	9020612	PHILLIPS PAN SCREW M6X12	7	75	6130581	BELT COVER JOINT (A)	1
26	6920665	CAUTION LABEL	2	76	6130582	BELT COVER JOINT (B)	1
27	6831165	KNOB	1	77	6370249	SWITCH COVER	1
28	9404032	SPRING PIN	1	78	9020410	PHILLIPS PAN SCREW M4X10	4
29	6130554	HANDLE SHAFT	1	79	6151822	SWITCH COVER	1
30	9020620	PHILLIPS PAN SCREW M6X20	9	80	6550337	PUSH BUTTON SWITCH	1
31	6151781	BRACKET	1	83	6590271	CLIP	3
32	6850328	FRONT SHOE	1	84	9020414	PHILLIPS PAN SCREW M4X14	2
33	6920550	SCALE	1	85	6520234	CORD ASSY AWG#14X3X2	1
34	6120005	RIVET #2	8	86	6860184	POLY V-BELT	1
35	9321200	HEX NUT M12	1	87	6860185	POLY V-BELT	1
36	6950097	INDICATION PLATE	1	88	9000635	PHILLIPS PAN SCREW M6X35	8
37	9190820	HEX HEAD BOLT M8X20	7	89	9550600	SPRING WASHER M6	11
38	6100376	GUARD SHAFT	1	90	6801302	MOTOR COVER	1
39	9405032	SPRING PIN	1	91	9511500	RETAINING RING S-15	7
40	9511200	RETAINING RING S-12	1	92	6031668	ARMATURE	1
41	6180232	TORSION SPRING	1	93	9846201	BALL BEARING #6201LLB	1
42	6920660	SEAL	1	94	9000580	PHILLIPS PAN SCREW M5X80	2
43	6920647	CAUTION LABEL	1	95	9550500	SPRING WASHER M5	2
44	6880690	SAFETY GUARD	1	96	6501366	FIELD COIL	1
45	6940419	CUTTER BLOCK ASSY	1	97	9280508	CLAMP SCREW M5X8	2
45-1	6130316	HEX HEAD BOLT M6X20	10	98	6801298	MOTOR HOUSING	1
46	6940394	CUTTER CLAMP	2	100	6760002	OILLESS METAL	6
47	6130550	ADJUSTMENT SCREW M5X17	4	101	6900251	THRUST WASHER	6
48	6940420	CUTTER BLOCK	1	102	6050117	GEAR (4)	1
49	9846202	BALL BEARING #6202LLB	3	103	6050116	GEAR (3)	1
51	9846002	BALL BEARING #6002LLB	1	104	6050115	GEAR (2)	1
52	6330066	BEARING BRACKET	1	105	9571000	WASHER	8
53	9020620	PHILLIPS PAN SCREW M6X20	4	106	6860177	ROLLER	1
54	6220172	FIXING PLATE	1	107	9846200	BALL BEARING #6200LLB	3
55	6151821	STOPPER COVER	1	108	6050114	GEAR (1)	1

PARTS LIST FOR AFTER SALES SERVICE

MODEL AH115

REF	PART NO.	DESCRIPTION	QTY	REF	PART NO.	DESCRIPTION	QTY
9	6820682	GEAR CASE	1	187	9321000	HEX NUT M10	2
110	9020625	PHILLIPS PAN SCREW M6X25	2	188	9991102	THRUST BEARING	4
111	6130583	CHAIN COVER STUD	2	189	6190224	BRACKET	1
112	6880721	CHAIN COVER	1	190	6900514	BEVEL SPACER	3
113	6050119	GEAR (5)	1	191	6200321	BEVEL GEAR (A)	5
114	6100385	SPLINE SHAFT	1	192	6130562	BOLT (A)	1
115	6080498	PLATE ASS'Y	1	194	6130568	BOLT (B)	1
116	6900475	TENSION COLLAR	1	195	6100366	BEVEL SHAFT	1
117	9020616	PHILLIPS PAN SCREW M6X16	1	240	9571400	WASHER	4
118	9000860	PHILLIPS PAN SCREW M6X60	3	241	6100391	ROLLER SHAFT	2
119	9020514	PHILLIPS PAN SCREW M5X14	10	242	6860175	ROLLER ASS'Y	2
120	6151798	CLAMP PLATE	1	243	6151811	GUIDE (B)	1
121	6090272	CLUTCH LEVER ASS'Y	1	244	6950113	SCALE	1
122	6831237	KNOB	1	245	6151792	CLAMP	8
123	6860085	CHAIN SPROCKET	4	246	6960085	SLIDE BAR (B)	2
124	6100509	PARALLEL KEY	1	247	6390139	BELLOWS	4
125	6920638	SEAL	1	248	6130541	SET BOLT	4
144	6920596	SCALE	1	249	6960074	SLIDE BAR (A)	2
145	6950118	SCALE BAR	1	250	6151810	GUIDE	1
146	6100396	STOPPER BAR	1	251	6850340	PLANER TABLE	1
147	6100374	SCALE BAR	1	261	9240625	WING BOLT M6X25	1
148	6180288	COMPRESSION SPRING	3	262	6130738	SCREW	4
149	6760113	STRAIGHT METAL	4	263	6190460	BRACKET (A)	1
150	6370250	RUBBER PLATE	2	264	6850325	BED	1
151	6151789	METAL COVER (B)	2	265	6390135	WOODEN BED	2
152	6860179	FRONT ROLLER	1	266	9408075	SPRING PIN	4
153	6100282	PARALLEL KEY	7	267	9406075	SPRING PIN	2
	6151786	COVER	2	268	9020560	PHILLIPS PAN SCREW M5X60	1
	6900508	COLLAR	1	269	9300500	HEX NUT M5	1
156	6860162	CHAIN	1	270	6920650	INDICATION LABEL	1
157	6130539	CUTTER CLAMP BOLT	16	271	6880726	EXHAUST GUIDE	1
158	6900515	WASHER	16	272	6880714	CHAIN COVER	1
159	6940432	CUTTER PLATE	2	273	6560103	CORD CLAMP	1
161	6940422	CUTTER BLOCK ASS'Y (AUTO FEED)	1	275	6370238	RUBBER	1
162	9846304	BALL BEARING #6304LLB	2	276	9191035	HEX HEAD BOLT M10X35	1
163	9280610	CLAMP SCREW M6X10	1	278	6120082	RUBBER KNOCK	3
164	6860167	PULLEY	1	279	6930017	SEAL	1
165	9140620	PHILLIPS FLAT SCREW M6X20	4	280	6920651	SEAL (1)	1
166	9630600	TOOTHED LOCK WASHER M6	4	281	6920652	SEAL (2)	1
167	6190214	BEARING BRACKET	1	282	6900700	WAVE WASHER	1
168	6100404	PARALLEL KEY	1	—	6560014	TERMINAL	5
169	6330065	ROLLER HOUSING	11	—	6560114	CONNECTOR	1
170	9406060	SPRING PIN	2	—	6590115	VINYL TUBE	1
171	6860179	FRONT ROLLER	1				
172	6180289	COMPRESSION SPRING	1				
173	6860186	CHAIN	1				
174	6180277	TENSION SPRING	1	500	6660413	JOINTER BLADE	1
175	6570076	BRUSH CAP	2	501	6660553	PLANER BLADE	1
176	6540063	CARBON BRUSH SET	1	502	6240773	"T" TYPE WRENCH	1
177	6570017	BRUSH HOLDER	2	—	6240813	"L" TYPE WRENCH	1
178	9571800	WASHER	2	503	6240113	OPEN-END WRENCH	1
179	6180279	COMPRESSION SPRING	1	505	6950114	SETTING GAUGE	1
180	6100378	HANDLE SHAFT	1	506	6071923	BLADE ADJUSTMENT GAUGE	1
181	9405030	SPRING PIN	2	507	6100400	FIX BAR	1
182	6130779	GRIP SHAFT	1	508	6072523	SHARPENING HOLDER	1
	6831462	GRIP	1	508-1	9020514	PHILLIPS PAN SCREW M5X14	4
184	9190830	HEX HEAD BOLT M8X30	6	508-2	6900146	WASHER	4
185	9300800	HEX NUT M8	1	509	6080258	PUSH BLOCK	1
186	6831307	HANDLE	1				