

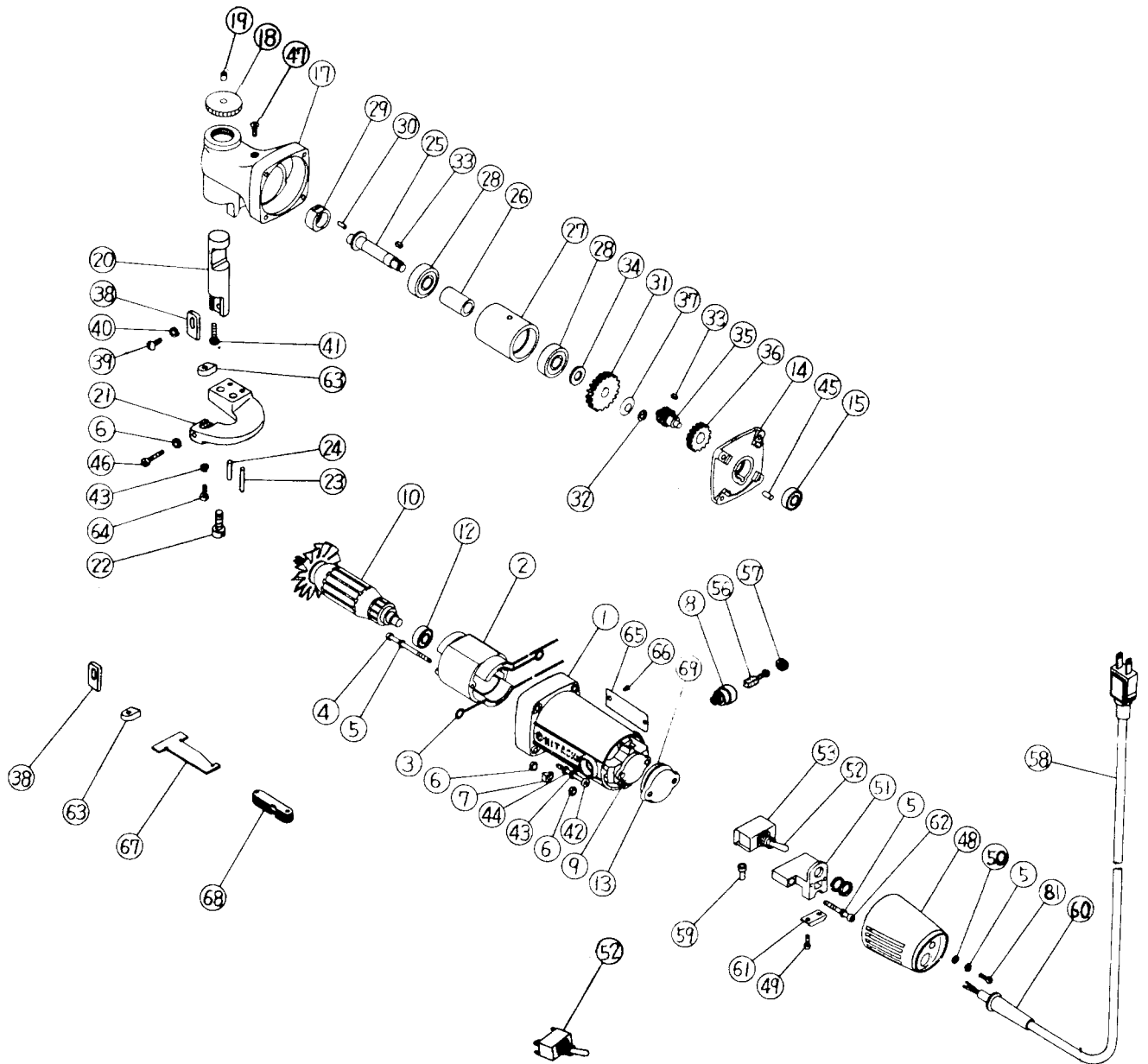

ELECTRIC TOOL PARTS LIST

■ 1/16" (1.6mm) ELECTRIC HAND SHEAR 1981·12·25
 Type C16 □ C16(A1)



PARTS (Prices are subject to change without notice)

C16 (A1)

Item No.	Code No.	Parts Name	Q'ty	Remarks	LIST PRICE US\$
1	937185	Housing	1		9.30
2	943000C	Stator Ass'y 115V	1	includ. 3	11.50
3	930003	Brush Terminal	2		0.50
4	955470	⊕Hd. Machine Screw M4 x 57	2		0.40
5	949453Z	Spring Lock Washer	6	for M4 (10 pcs.)	0.40
6	949554Z	Nut M4	5	(10 pcs.)	0.40
7	937187	Nut Cover	2		0.40
8	936904	Brush Holder	2		1.90
9	955471	Bearing Bush	1		2.00
10	955472C	Armature Ass'y 115V	1		29.00
12	939398	Ball Bearing (627ZZC2)	1		2.30
13	955473	Insulating Piece (B)	1		0.40
14	955474	Inner Cover Ass'y	1		10.50
15	939396	Ball Bearing (608ZZC2)	1		2.30
16	955521	Gear Cover (A) Ass'y	1	includ. 17 ~ 24	76.00
17	955522	Gear Cover (B) Ass'y	1		53.00
18	943114	Plug	1		1.70
19	941822	Oil Cup	1		0.40
20	943110	Piston	1		5.70
21	943120	Blade Holder	1		21.00
22	943117	Special Screw M8 x 20	2		0.40
23	949486Z	Pin D4 x 28	1	(10 pcs.)	0.40
24	949485Z	Pin D4 x 24	1	(10 pcs.)	0.40
25	955523	Spindle	1		6.40
26	955477	Distance Piece	1		0.80
27	955478	Bearing Cover	1		11.30
28	939447	Ball Bearing (6201ZZCM)	2		2.10
29	943108	Race	1		2.90
30	943109	Needle Roller D3.5 x 9.5	12		0.40
31	943006	Final Gear	1		2.60
32	955479	E-Type Retaining Ring	1	for D6 shaft	0.40
33	943007	Feather Key 3 x 3 x 6	2		1.10
34	943005	Washer	1		0.40
35	943011	Second Pinion	1		2.90
36	943012	First Gear	1		2.30
37	945213	Special Washer	1		0.40
38	943113	Moving Blade	2		4.50
39	943112	Set Screw	1		0.40
40	949455Z	Spring Lock Washer	1	for M6 (10 pcs.)	0.80
41	943111	Stopper	1		0.40
42	949248Z	⊕Hd. Machine Screw M5 x 40	4	(10 pcs.)	0.40
43	949454Z	Spring Lock Washer	5	for M5 (10 pcs.)	0.40
44	949424Z	Washer	4	for M5 (10 pcs.)	0.40
45	946362	Bearing Lock	1		0.40
46	943235	Flat Fillister Hd. Screw M4 x 22	1		0.40
47	949332Z	⊕Flat Hd. Screw M5 x 12	1	(10 pcs.)	1.90
48	937191	Tail Cover	1		0.40
49	949216Z	⊕Hd. Machine Screw M4 x 10	4	(10 pcs.)	0.40
50	949423Z	Washer	2	for M4 (10 pcs.)	0.40
51	937555	Switch Holder	1		1.30
52	937556	Single Pole Switch (Solder Type)	1		4.10
53	936697	Switch Insulator	1		0.40
56	999021	Carbon Brush	2		1.50

