

## ELECTRIC TOOL PARTS LIST

■ HAMMER DRILL  
Model DH 25V

1997 • 4 • 15  
(E5)

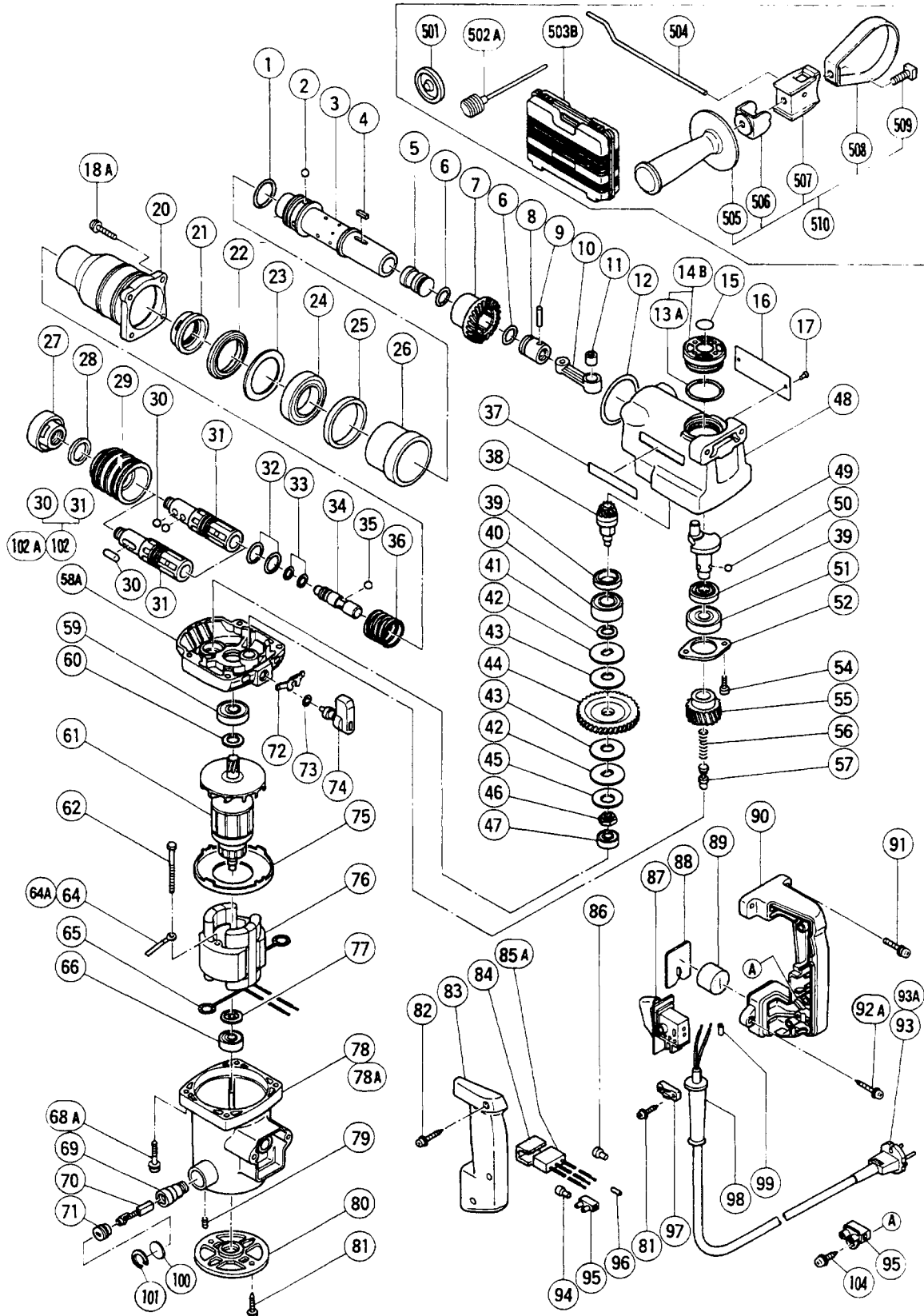

## PARTS

DH 25V

ITEM NO.	CODE NO.	DESCRIPTION	NO. USED	REMARKS	
1	872-767	O - RING (S - 32)	1		
2	944-941	STEEL BALL D7.94	3		
3	982-649	CYLINDER	1		
4	982-696	FEATHER KEY 3X3X15	2		
5	982-651	STRIKER	1		
6	971-760	O - RING	2		
7	982-650	THIRD GEAR	1		
8	982-648	PISTON	1		
9	971-821	PISTON PIN	1		
10	982-647	CONNECTING ROD ASS'Y	1	INCLUD.11	
11	956-406	NEEDLE BEARING (NTN 8Q - HK08 10D)	1		
12	980-744	O - RING (S - 55)	1		
13A	314-030	O - RING	1		
14B	314-031	OIL CAP ASS'Y	1	INCLUD.13A	
*	15	980-934Z	CAUTION PLATE (ENGLISH)	1	
*	15	992-830	CAUTION PLATE (GERMAN)	1	FOR FRG,AUT,SUI
	16		NAME PLATE	1	
	17	949-510	RIVET D2.5X4.8 (10 PCS.)	2	
	18A	992-253	HEX. SOCKET HD. BOLT (W/FLANGE) M5X25	4	
	20	984-061Z	CYLINDER CASE	1	
	21	982-660	CYLINDER CAP	1	
	22	982-659	OIL SEAL	1	
	23	982-658	WASHER (B)	1	
	24	690-7BB	BALL BEARING 6907	1	
	25	982-661	URETHANE RING	1	
	26	982-656	PIPE	1	
	27	971-769	FRONT CAP	1	
	28	982-697	URETHANE WASHER	1	
	29	982-663	SLIDE GRIP	1	
*	30	971-812	NEEDLE ROLLER	2	
*	30	959-151	STEEL BALL D7.14 (10 PCS.)	4	
*	31	984-068	RETAINER SLEEVE (E) (FOR ROUND SHANK)	1	FOR NEEDLE ROLLER TYPE
*	31	984-581	RETAINER SLEEVE (C) (FOR SQUARE SHANK)	1	FOR NEEDLE ROLLER TYPE
*	31	984-062Z	RETAINER SLEEVE (B) (FOR SQUARE SHANK)	1	FOR STEEL BALL TYPE
	32	982-655	O - RING (A)	2	
	33	982-653	O - RING (B)	2	
	34	982-652	SECOND HAMMER	1	
	35	959-151	STEEL BALL D7.14 (10 PCS.)	3	
	36	982-662	SPRING	1	
	37	957-561	HITACHI LABEL	1	
	38	982-641	THIRD PINION SLEEVE	1	
	39	981-851	OIL SEAL (B)	2	
	40	600-2VV	BALL BEARING 6002VVMPS2S	1	
	41	982-640	WASHER	1	
	42	982-643	SLIP PLATE	2	
	43	982-642	CLUTCH PLATE	2	
	44	982-645	SECOND GEAR	1	
	45	982-644	BELLEVILLE SPRING	1	
	46	982-639	SPECIAL NUT M10	1	
	47	627-VVM	BALL BEARING 627VVMC2EPS2S	1	
	48	984-060Z	CRANK CASE	1	

\*: ALTERNATIVE PARTS

## PARTS

DH 25V

ITEM NO.	CODE NO.	DESCRIPTION	NO. USED	REMARKS	
49	986-271	CRANK SHAFT	1		
50	959-154	STEEL BALL D5.556 (10 PCS.)	3		
51	620-2VV	BALL BEARING 6202VVCMP2S	1		
52	982-638	BEARING COVER	1		
54	983-162	SEAL LOCK HEX. SOCKET HD. BOLT M4X12	2		
55	986-272	FIRST GEAR	1		
56	986-270	SPRING	1		
57	986-273	CLUTCH SHAFT	1		
58A	986-278	GEAR COVER	1		
59	600-1VV	BALL BEARING 6001VVCMP2L	1		
60	971-736	WASHER (B)	1		
*	61	984-170U	ARMATURE ASS'Y 110V - 115V	1	INCLUD.59,60,66,77
*	61	984-170E	ARMATURE 220V - 230V	1	
*	61	984-170F	ARMATURE 240V	1	
62	953-174	HEX. HD. TAPPING SCREW D5X55	2		
*	64	986-277	INTERNAL WIRE	1	
*	64	971-776	INTERNAL WIRE	1	FOR SUI
*	64A	314-136	INTERNAL WIRE	1	FOR FIN
65	930-630	BRUSH TERMINAL	2		
66	608-VVM	BALL BEARING 608VVMC2EPS2L	1		
68A	992-254	HEX. SOCKET HD. BOLT (W/FLANGE) M5X50	4		
69	990-721	BRUSH HOLDER	2		
70	999-084	CARBON BRUSH (AUTO STOP TYPE) (1 PAIR)	2		
71	937-847	BRUSH CAP	2		
72	986-276	STOPPER SPRING	1		
73	872-654	O - RING (1AP - 10)	1		
74	986-275	CHANGE LEVER	1		
75	980-931	FAN GUIDE	1		
*	76	984-064P	STATOR ASS'Y 115V	1	INCLUD.65
*	76	984-064K	STATOR ASS'Y 220V - 230V	1	INCLUD.65
*	76	984-064N	STATOR ASS'Y 240V	1	INCLUD.65
*	76	984-064L	STATOR ASS'Y 240V	1	INCLUD.65 FOR AUS
77	982-631	WASHER (A)	1		
*	78	992-821	HOUSING ASS'Y	1	INCLUD.69,79 (TILL 2.1985 FOR AUS ONLY)
*	78A	992-831	HOUSING ASS'Y	1	INCLUD.69,79 SINCE 3.1985 FOR AUS
79	938-477	HEX. SOCKET SET SCREW M5X8	2		
80	984-058	TAIL COVER	1		
81	930-446	TAPPING SCREW (W/WASHER) D4X16	4		
82	956-636	TAPPING SCREW (W/WASHER) D4X25	3		
83	980-924Z	HANDLE COVER (B)	1		
*	84	930-153	SUPPORT (B)	1	FOR NOISE SUPPRESSOR
*	85A	994-273	NOISE SUPPRESSOR	1	
*	86	959-141	CONNECTOR 50092 (10 PCS.)	1	
*	87	980-922Z	SWITCH (2P PILLAR TYPE) W/LOCK	1	
*	87	995-256	SWITCH (2P PILLAR TYPE) W/LOCK	1	FOR USA
88	980-900	PLATE	1		
89	971-816	HANDLE PACKING	1	TILL 6.1986	
90	980-923Z	HANDLE (B)	1		
91	986-274	MACHINE SCREW (W/WASHERS) M5X25	2		
92A	985-620	TAPPING SCREW (W/FLANGE) D5X25	2		
*	93	500-239Z	CORD	1	(CORD ARMOR D10.1)

\*: ALTERNATIVE PARTS

**PARTS**

DH 25V

ITEM NO.	CODE NO.	DESCRIPTION	NO. USED	REMARKS	
* 93	500-227Z	CORD	1	(CORD ARMOR D8.8) FOR NGU,NZL	
* 93	500-232Z	CORD	1	(CORD ARMOR D8.8) FOR GBR,SAF	
* 93	500-235Z	CORD	1	(CORD ARMOR D8.8) FOR INA,KOR	
* 93	500-390Z	CORD	1	(CORD ARMOR D10.1) FOR ITA,FRG,FRA,HOL, DEN,SWE,FIN,AUT,NOR,CHN	
* 93	500-391Z	CORD	1	(CORD ARMOR D10.1) FOR SUI	
* 93	500-394Z	CORD	1	(CORD ARMOR D10.1) FOR SYR	
* 93	500-408Z	CORD	1	(CORD ARMOR D8.8) FOR AUS	
* 93	500-249Z	CORD	1	(CORD ARMOR D8.8) FOR USA	
* 93A	500-424Z	CORD	1	(CORD ARMOR D8.8) FOR SIN	
* 94	959-140	CONNECTOR 50091 (10 PCS.)	1		
* 95	938-307	PILLAR TERMINAL	1	EXCEPT FOR NZL,SAF	
* 95	310-290	HOLDER PLATE	1	FOR CHN	
* 96	981-373	TUBE (D)	1	FOR NOISE SUPPRESSOR	
	97	960-266	CORD CLIP	1	
* 98	953-327	CORD ARMOR D8.8	1		
* 98	938-051	CORD ARMOR D10.1	1		
* 99	981-373	TUBE (D)	1	FOR CORD	
* 100	992-832	WASHER	2	FOR AUS	
* 101	939-552	RETAINING RING FOR D19 HOLE (10 PCS.)	2	FOR AUS	
* 102	984-067	RETAINER SLEEVE ASS'Y (FOR SQUARE SHANK)	1	INCLUD.30,31 FOR NEEDLE ROLLER TYPE	
* 102A	995-255	RETAINER SLEEVE(E)ASS'Y(FOR ROUND SHANK)	1	INCLUD.30,31 FOR NEEDLE ROLLER TYPE	
* 104	309-470	TAPPING SCREW (W/FLANGE) D4X12 (BLACK)	1	FOR CHN	

**STANDARD ACCESSORIES**

ITEM NO.	CODE NO.	DESCRIPTION	NO. USED	REMARKS
501	971-787	DUST CUP	1	
502A		SYRINGE	1	
503B	312-645	CASE	1	
504	982-671	STOPPER ROD	1	
505	980-901	SIDE HANDLE	1	
506	980-905	ROD HOLDER	1	
507	980-902	SIDE HANDLE HOLDER	1	
508	982-667	BAND	1	
509	980-903	SQUARE BOLT M8	1	
510	982-666	SIDE HANDLE ASS'Y	1	INCLUD.505 -- 509

**OPTIONAL ACCESSORIES**

ITEM NO.	CODE NO.	DESCRIPTION	NO. USED	REMARKS
601	971-970	DRILL BIT (A) D5.0X119	1	
602	971-971	DRILL BIT (A) D5.0X159	1	
603	984-050	DRILL BIT (A) D5.5X119	1	
604	971-960	DRILL BIT (A) D6.0X159	1	
605	971-972	DRILL BIT (A) D6.5X119	1	
606	971-973	DRILL BIT (A) D6.5X159	1	

\* : ALTERNATIVE PARTS

**OPTIONAL ACCESSORIES**

DH 25V

ITEM NO.	CODE NO.	DESCRIPTION	NO. USED	REMARKS
607	984-051	DRILL BIT (A) D7.0X159	1	
608	971-961	DRILL BIT (A) D7.5X159	1	
609	971-974	DRILL BIT (A) D8.0X119	1	
610	971-975	DRILL BIT (A) D8.0X159	1	
611	971-993	DRILL BIT (A) D8.5X159	1	
612	971-962	DRILL BIT (A) D8.5X209	1	
613	984-052	DRILL BIT (A) D9.0X159	1	
614	971-976	DRILL BIT (A) D9.5X159	1	
615	971-977	DRILL BIT (A) D10.0X159	1	
616	971-963	DRILL BIT (A) D10.0X209	1	
617	971-994	DRILL BIT (A) D10.5X159	1	
618	971-978	DRILL BIT (A) D11.0X159	1	
619	971-979	DRILL BIT (A) D12.0X159	1	
620	971-980	DRILL BIT (A) D12.0X209	1	
621	971-981	DRILL BIT (A) D12.3X159	1	
622	971-982	DRILL BIT (A) D12.5X159	1	
623	971-995	DRILL BIT (A) D12.7X159	1	
624	971-983	DRILL BIT (A) D13.0X159	1	
625	984-053	DRILL BIT (B) D14.0X159	1	
626	971-984	DRILL BIT (B) D14.3X159	1	
627	971-985	DRILL BIT (B) D14.5X159	1	
628	984-054	DRILL BIT (B) D15.0X159	1	
629	971-986	DRILL BIT (B) D16.0X209	1	
630	971-987	DRILL BIT (B) D16.0X359	1	
631	971-967	DRILL BIT (B) D16.7X159	1	
632	984-055	DRILL BIT (B) D17.0X209	1	
633	971-988	DRILL BIT (B) D17.5X159	1	
634	971-996	DRILL BIT (B) D18.0X209	1	
635	971-989	DRILL BIT (B) D19.0X159	1	
636	971-964	DRILL BIT (B) D19.0X359	1	
637	971-965	DRILL BIT (B) D20.0X359	1	
639	971-990	DRILL BIT (B) D21.5X159	1	
640	971-991	DRILL BIT (B) D22.0X209	1	
641	971-992	DRILL BIT (B) D22.0X359	1	
642	980-690	DRILL BIT D24.0X200	1	
643	980-691	DRILL BIT D24.0X350	1	
644	980-692	DRILL BIT (B) D25.0X200	1	
645	980-693	DRILL BIT D25.0X350	1	
646	971-804	ANCHOR SETTING ADAPTER A W1/4"(ELECTRIC)	1	
647	971-805	ANCHOR SETTING ADAPTER A W5/16"(ELECTRIC)	1	
648	971-806	ANCHOR SETTING ADAPTER A W3/8"(ELECTRIC)	1	
649	971-807	ANCHOR SETTING ADAPTER B W1/4"(ELECTRIC)	1	
650	971-808	ANCHOR SETTING ADAPTER B W5/16"(ELECTRIC)	1	
651	971-809	ANCHOR SETTING ADAPTER B W3/8"(ELECTRIC)	1	
652	971-999	ANCHOR SETTING ADAPTER B W1/2"(ELECTRIC)	1	
653	971-794	ANCHOR SETTING ADAPTER A W1/4" (MANUAL)	1	
654	971-795	ANCHOR SETTING ADAPTER A W5/16" (MANUAL)	1	
655	971-796	ANCHOR SETTING ADAPTER A W3/8" (MANUAL)	1	
656	971-797	ANCHOR SETTING ADAPTER A W1/2" (MANUAL)	1	
657	971-798	ANCHOR SETTING ADAPTER A W5/8" (MANUAL)	1	
658	971-799	ANCHOR SETTING ADAPTER B W1/4" (MANUAL)	1	

\* : ALTERNATIVE PARTS

**OPTIONAL ACCESSORIES**

DH 25V

ITEM NO.	CODE NO.	DESCRIPTION	NO. USED	REMARKS
659	971 - 800	ANCHOR SETTING ADAPTER B W5/16" (MANUAL)	1	
660	971 - 801	ANCHOR SETTING ADAPTER B W3/8" (MANUAL)	1	
661	971 - 802	ANCHOR SETTING ADAPTER B W1/2" (MANUAL)	1	
662	971 - 803	ANCHOR SETTING ADAPTER B W5/8" (MANUAL)	1	
663	980 - 927	GREASE FOR HAMMER.HAMMER DRILL (500G)	1	
664	981 - 840	GREASE (A) FOR HAMMER.HAMMER DRILL (30G)	1	
665	950 - 272	DRILL CHUCK 13VLA	1	INCLUD.666
666	930 - 515	CHUCK WRENCH 10G	1	
667	944 - 477	COTTER	1	
668	982 - 672	CORE BIT (A) 25MM	1	
669	982 - 673	CORE BIT (A) 29MM	1	
670	982 - 674	CORE BIT (A) 32MM	1	INCLUD.671
671	982 - 686	GUIDE PLATE (FOR CORE BIT 32MM)	1	
672	982 - 675	CORE BIT (A) 35MM	1	INCLUD.673
673	982 - 687	GUIDE PLATE (FOR CORE BIT 35MM)	1	
674	982 - 676	CORE BIT (A) 38MM	1	INCLUD.675
675	982 - 688	GUIDE PLATE (FOR CORE BIT 38MM)	1	
676	982 - 677	CORE BIT (B) 45MM	1	INCLUD.677
677	982 - 689	GUIDE PLATE (FOR CORE BIT 45MM)	1	
678	982 - 678	CORE BIT (B) 50MM	1	INCLUD.679
679	982 - 690	GUIDE PLATE (FOR CORE BIT 50MM)	1	
680	982 - 679	CORE BIT (B) 65MM	1	INCLUD.681
681	982 - 691	GUIDE PLATE (FOR CORE BIT 65MM)	1	
682	982 - 680	CORE BIT (B) 80MM	1	INCLUD.683
683	982 - 692	GUIDE PLATE (FOR CORE BIT 80MM)	1	
684	982 - 681	CORE BIT (B) 90MM	1	INCLUD.685
685	982 - 693	GUIDE PLATE (FOR CORE BIT 90MM)	1	
686	982 - 682	CORE BIT SHANK (A)	1	FOR 38MM OR BELOW
687	982 - 683	CORE BIT SHANK (B)	1	FOR 45MM OR ABOVE
688	982 - 684	CENTER PIN (A)	1	FOR 38MM OR BELOW
689	982 - 685	CENTER PIN (B)	1	FOR 45MM OR ABOVE
690	984 - 065	CORE BIT SHANK (A) L300MM	1	
691	984 - 066	CORE BIT SHANK (B) L300MM	1	
692	971 - 810Z	A - TAPER SHANK ADAPTER	1	
693	971 - 811Z	B - TAPER SHANK ADAPTER	1	
694	936 - 728	WRENCH	1	
* 695	980 - 943Z	CHUCK ADAPTER (B) (SQUARE SHANK)	1	
* 695	980 - 953	CHUCK ADAPTER (E) (ROUND SHANK)	1	
-696A	992 - 834	SERVICE KIT (DH 25V)	1	INCLUD.2,6,12,18A,22,27,30,32,33,35,70, 664
697	308 - 471	GREASE FOR HAMMER.HAMMER DRILL (70G)	1	
698	944 - 575	SYRINGE	1	

\* : ALTERNATIVE PARTS