

ELECTRIC TOOL PARTS LIST

■ DISC GRINDER
Model G 10SD1

1994.1.7
(E3)

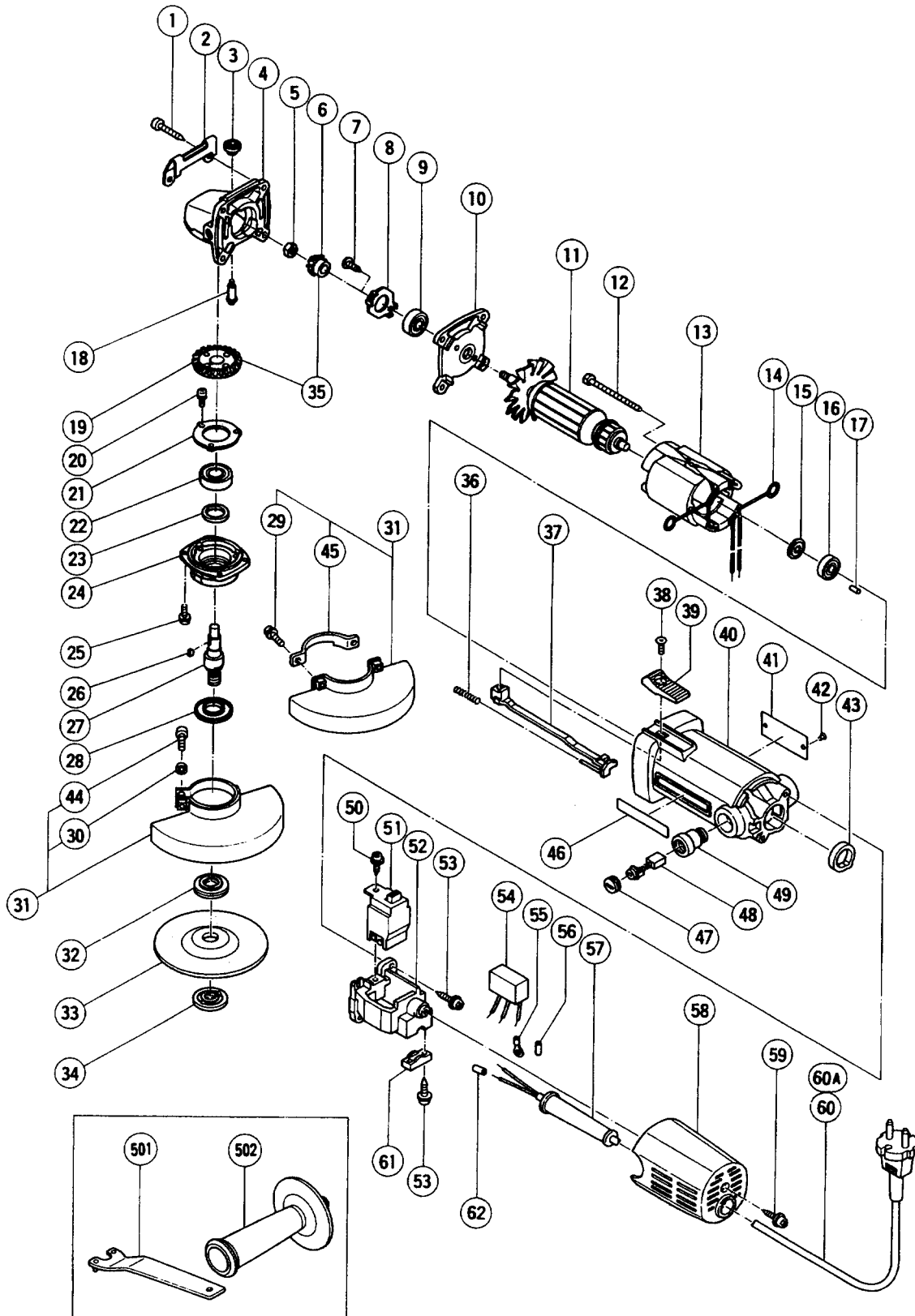

PARTS

G 10SD1

ITEM NO.	CODE NO.	DESCRIPTION	NO. USED	REMARKS
1	937-807	TAPPING SCREW D5X25	4	
2	302-149	GUARD PLATE	1	
3	301-944	PUSHING BUTTON	1	
4	302-097	GEAR COVER ASS'Y	1	INCLUD.3,18
5	301-941	SPECIAL NUT M7	1	
6	301-939	PINION	1	
7	301-936	SLOTTED HD. SCREW (SEAL LOCK) M4X10	2	
8	301-937	BEARING COVER	1	
9	608-VVM	BALL BEARING 608VVMC2EPS2L	1	
10	301-935	INNER COVER	1	
*	11	360-163C	ARMATURE 110V - 115V	1
*	11	360-163D	ARMATURE 120V - 127V	1
*	11	360-163E	ARMATURE 220V	1
*	11	360-163F	ARMATURE 230V - 240V	1
12	982-021	HEX. HD. TAPPING SCREW D4X70	2	
*	13	340-187C	STATOR ASS'Y 110V - 115V	1 INCLUD.14
*	13	340-187D	STATOR ASS'Y 120V - 127V	1 INCLUD.14
*	13	340-187E	STATOR ASS'Y 220V	1 INCLUD.14
*	13	340-187F	STATOR ASS'Y 230V - 240V	1 INCLUD.14
*	13	340-187M	STATOR ASS'Y 230V - 240V	1 INCLUD.14 FOR NZLSAF
*	13	340-187J	STATOR ASS'Y 230V - 240V	1 INCLUD.14 FOR GBR
*	13	340-187G	STATOR ASS'Y 110V	1 INCLUD.14 FOR GBR
*	13	340-187K	STATOR ASS'Y 115V	1 INCLUD.14 FOR USA
14	931-867	BRUSH TERMINAL	2	
15	980-865	WASHER (A)	1	
16	626-VVM	BALL BEARING 626VVMC2ERPS2S	1	
17	931-701	BEARING LOCK	1	
18	301-943	LOCK PIN	1	
19	301-940	GEAR	1	
20	987-201	SEAL LOCK SCREW (W/SP. WASHER) M4X10	3	
21	938-058	BEARING COVER (B)	1	
22	600-1VV	BALL BEARING 6001VVCMP2L	1	
23	301-946	FELT PACKING	1	
*	24	302-286	PACKING GLAND	1
*	24	301-947	PACKING GLAND	1 FOR INA
25	987-203	SEAL LOCK SCREW (W/SP. WASHER) M4X12	4	
26	940-220	WOODRUFF KEY 2.5X8	1	
27	302-046	SPINDLE	1	
28	301-945	FRINGER	1	
*	29	987-512	MACHINE SCREW (W/SP. WASHER) M5X16	2 FOR INA
*	30	949-454	SPRING WASHER M5 (10 PCS.)	1 EXCEPT FOR INA
*	31	937-831Z	WHEEL GUARD (A) ASS'Y	1 INCLUD.30,44
*	31	994-430	WHEEL GUARD ASS'Y	1 INCLUD.30,44 FOR GBR
*	31	301-948	WHEEL GUARD ASS'Y	1 INCLUD.29,45 FOR INA
*	32	937-835Z	WHEEL WASHER (C)	1
*	32	937-834Z	WHEEL WASHER	1 FOR USA
*	32	938-363Z	WHEEL WASHER	1 FOR INA
*	33	939-640Z	D. C. WHEELS 100MMX4T A36Q (20 PCS.)	1
*	34	936-583Z	WHEEL NUT	1
*	34	938-214Z	WHEEL NUT (B)	1 FOR INA
35	301-938	GEAR PINION ASS'Y	1	INCLUD.6,19

*: ALTERNATIVE PARTS

PARTS

G 10SD1

ITEM NO.	CODE NO.	DESCRIPTION	NO. USED	REMARKS
36	938-299	SPRING	1	
37	982-033	SLIDE BAR	1	
38	949-323	FLAT HD. SCREW M4X12 (10 PCS.)	1	
39	994-298	SLIDE KNOB (C)	1	
40	982-020	HOUSING ASS'Y	1	INCLUD.49
41		NAME PLATE	1	
42	932-642	RIVET D2.5X2.8	2	
43	982-023	BEARING BUSHING	1	
* 44	949-241	MACHINE SCREW M5X20 (10 PCS.)	1	EXCEPT FOR INA
* 45	301-949	SET PLATE	1	FOR INA
46	957-581	HITACHI LABEL	1	
47	937-847	BRUSH CAP	2	
48	999-021	CARBON BRUSH (1 PAIR)	2	
49	937-846	BRUSH HOLDER	2	
50	982-034	TAPPING SCREW (W/WASHER) D4X12	1	
51	980-778	SLIDE SWITCH (2P PILLAR TYPE)	1	
52	982-044	SWITCH HOLDER	1	
53	984-750	TAPPING SCREW (W/FLANGE) D4X16	4	
* 54	994-273	NOISE SUPPRESSOR	1	FOR NZL,GBR,SAF
* 55	980-083	TERMINAL	1	FOR NOISE SUPPRESSOR
* 56	981-373	TUBE (D)	2	FOR NOISE SUPPRESSOR
* 57	953-327	CORD ARMOR D8.8	1	
* 57	938-051	CORD ARMOR D10.1	1	
58	982-035	TAIL COVER	1	
59	930-446	TAPPING SCREW (W/WASHER) D4X16	1	
* 60	500-201Z	CORD	1	(CORD ARMOR D10.1)
* 60	500-409Z	CORD	1	(CORD ARMOR D8.8) FOR INA,SUR,GRE
* 60	500-245Z	CORD	1	(CORD ARMOR D10.1) FOR SYR
* 60	971-675Z	CORD	1	(CORD ARMOR D8.8) FOR SAF,GBR (110V)
* 60	938-310P	CORD	1	(CORD ARMOR D8.8) FOR USA
* 60	500-420Z	CORD	1	(CORD ARMOR D10.1) FOR SAU (127V)
* 60	500-421Z	CORD	1	(CORD ARMOR D8.8) FOR SAU (220V)
* 60	500-223Z	CORD	1	(CORD ARMOR D10.1) FOR SIN,KUW
* 60	500-226Z	CORD	1	(CORD ARMOR D8.8) FOR AUS,NGU,NZL
* 60A	500-436Z	CORD	1	(CORD ARMOR D8.8) FOR GBR (240V)
61	980-286	CORD CLIP	1	
* 62	981-373	TUBE (D)	2	FOR CORD

* : ALTERNATIVE PARTS

STANDARD ACCESSORIES

G 10SD1

ITEM NO.	CODE NO.	DESCRIPTION	NO. USED	REMARKS
501	936-522	WRENCH	1	
* 502	302-142	SIDE HANDLE	1	
* 502	302-739	SIDE HANDLE (C)	1	FOR USA

OPTIONAL ACCESSORIES

ITEM NO.	CODE NO.	DESCRIPTION	NO. USED	REMARKS
* 601	303-058	DIAMOND WHEEL (SEGMENT) 105MM – D20 HOLE	1	FOR USA
* 602	303-059	DIAMOND WHEEL 105MM – D20 HOLE	1	FOR USA
* 603	303-681	WASHER (FOR DIAMOND WHEEL)	1	FOR USA
604	304-015	DIAMOND WHEEL (SEGMENT) 105MM – D20 HOLE	1	FOR CONCRETE
605	304-018	DIAMOND WHEEL 105MM – D20 HOLE	1	WAVE SHAPE TYPE FOR CONCRETE
* 606	937-835Z	WHEEL WASHER (C)	1	FOR DIAMOND WHEEL FOR USA

*: ALTERNATIVE PARTS