



BOSCH

Diamond Drilling Machine

GDB 2500 WE | 0 601 18P 743

Table of Content

Spare parts list.....	2
Illustration - Type.....	5

Spare parts list

Item	Part Number	Description
4	3 607 031 559	Switch
4/4	2 910 601 327	Tapping Screw DIN 7982-ST 4,2x19-C
6	3 608 871 594	Grommet Ø11,0-Ø13,4x76 MM
7	1 601 302 013	Fastening Clamp
9	3 601 119 442	Manufacturer's nameplate
9/1	3 601 119 201	Reference Plate
9/2	3 601 119 441	Reference Plate
12	3 607 328 018	Suppression Filter
13	1 600 905 011	groove ball bearing 8x22x7
14	3 600 905 155	groove ball bearing 10x35x11
17	1 607 233 170	Speed governor 220-240V
18	3 604 420 008	Light Conductor
23	1 618 B00 802	Sealing cap
27	3 606 309 059	Drive Spur Wheel LEFTHAND THREADS
31	3 600 499 018	Air-Deflector Ring
33	3 600 290 065	Rotary shaft lip seal 15X30X7/6
38	1 600 206 020	Rubber Ring 7 MM WIDE
39	1 600 206 030	Rubber Ring
41	3 602 329 038	Holding Plate
41	3 602 329 040	Holding Plate
42	3 604 441 012	Connecting Cable
43	3 604 441 013	Connecting Cable
44	1 601 334 009	Pickup Clip
61	2 912 401 039	Tapping Screw DIN 7981-ST4,8X45-C-Z
62	3 603 435 027	Tapping Screw 5x30
63	3 603 435 028	Tapping Screw 5x20
64	1 603 435 042	Plastic-Cutting Screw St3,9x12
65	2 912 401 020	Tapping Screw DIN 7981-3,9x19-C-Z-ST
103	2 600 210 003	O-Ring 40,0x1,5 MM
104	2 910 141 201	Hex Socket Head Cap Screw DIN 912-M6x20-8.8
224	3 603 100 037	Retaining Pin
226	3 600 700 053	Sight Glass
227	3 605 510 041	Impeller Wheel
228	3 600 210 112	O-Ring 25,0x2,65 MM

Spare parts list

Item	Part Number	Description
229	3 600 210 114	O-Ring 33,0x2,5 MM
230	3 600 100 082	Plain Washer
231	3 602 380 011	Isolating Valve
232	3 600 760 107	Flexible Connection
237	3 600 109 014	Sealing Disc
301	3 609 201 540	Drilling Spindle SW36, 1 1/4", R 1/2"
302	3 609 201 541	Contrarotating Disc
303	3 609 201 542	Shaft Seal
304	3 609 201 543	Thrust Needle Bearing
305	3 609 201 544	Needle-Roller Bearing
306	3 609 201 545	Coupling Plate
308	3 609 201 546	Friction Disk
309	3 609 201 547	Straight Pin
310	3 609 201 548	Cylindrical Gear
311	3 609 201 549	Bearing Sleeve
312	3 609 201 550	Disc Spring
313	3 609 201 551	Hex Nut
316	3 609 201 552	groove ball bearing
318	3 609 201 553	Shaft Seal
320	3 609 201 570	Seal
321	3 609 201 554	Needle bearing
322	3 609 201 555	groove ball bearing
335	3 609 201 556	Pinion Shaft
337	3 609 201 557	Sliding Gear
338	3 609 201 558	Straight Pin
342	3 609 201 559	groove ball bearing
343	3 609 201 560	Pinion Shaft
345	3 609 201 561	Upper Housing
346	3 609 201 563	Housing Base
346/1	3 609 201 562	Coiled Spring Pin
347	3 609 201 564	Spring retaining ring
349	3 609 201 565	O-Ring
350	3 609 201 566	Clamp Handle
350/1	3 609 201 567	Straight Pin
350/2	3 609 201 568	Coiled Spring Pin

Diamond Drilling Machine | GDB 2500 WE | 0 601 18P 743

Spare parts list

Item	Part Number	Description
353	3 609 201 569	Socket head cap screw
734/8	3 603 386 050	Hose Coupling 1/2"
800	1 600 A00 9VE	Adapter Plate For GCR 180 and GCR 350
801	3 607 031 569	Motor Housing BLUE
802	3 604 220 157	Field 220-240V
803	3 604 010 097	Armature 220-240V
805	3 604 460 178	Power supply cord
808	1 601 11A 3H7	Nameplate
810	3 607 014 008	Carbon-Brush Set
816	1 604 336 048	Brush Holder
819	3 605 133 026	Cap-Handle
821	3 605 500 168	End Shield
824	3 607 031 562	Handle
825	3 607 031 563	Connecting Plate
835	1 606 610 127	Fan
846	1 607 000 342	Retaining Washer
867	3 607 031 560	Grounding plate
895	1 615 430 019	Oil Reservoir 1000 ML
898	3 609 201 577	Spindle Bearing
899	1 600 190 043	Glide ring Ø32,2xØ41x1 MM
726	0 601 190 025	Drill Stand
758	2 609 390 308	Calibrating Unit
759	2 609 390 315	Sharpening Stone
760	1 609 202 230	Air Hose Ø 35 MM, L=5 M
761	0 601 989 103	All Purpose Vacuum Clean

Illustration - Type - E

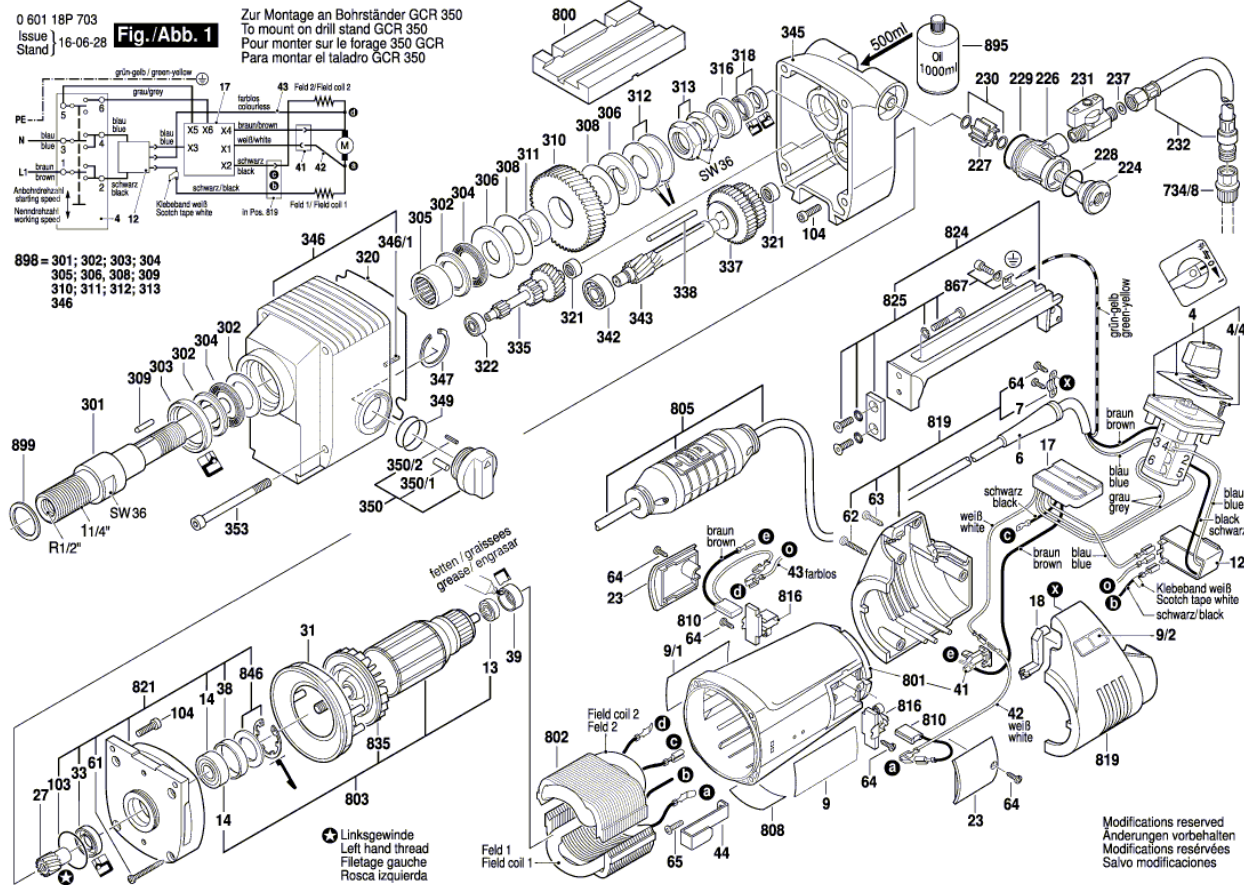
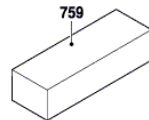
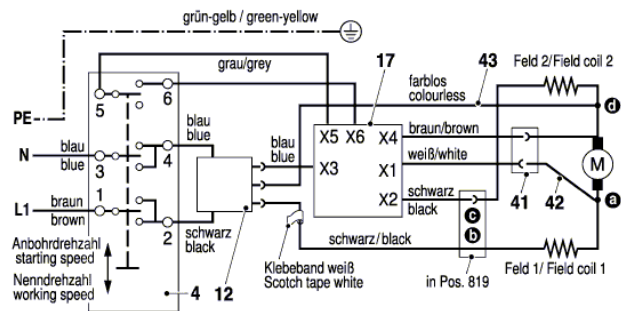

Illustration - Type - E

0 601 18P 703
Issue
Stand | 14-07-15

Fig./Abb. 2



Modifications reserved
Änderungen vorbehalten
Modifications réservées
Salvo modificaciones

