

ELECTRIC TOOL PARTS LIST

■ HAMMER
Model H 41SA

2001-6-1
(E1-1)

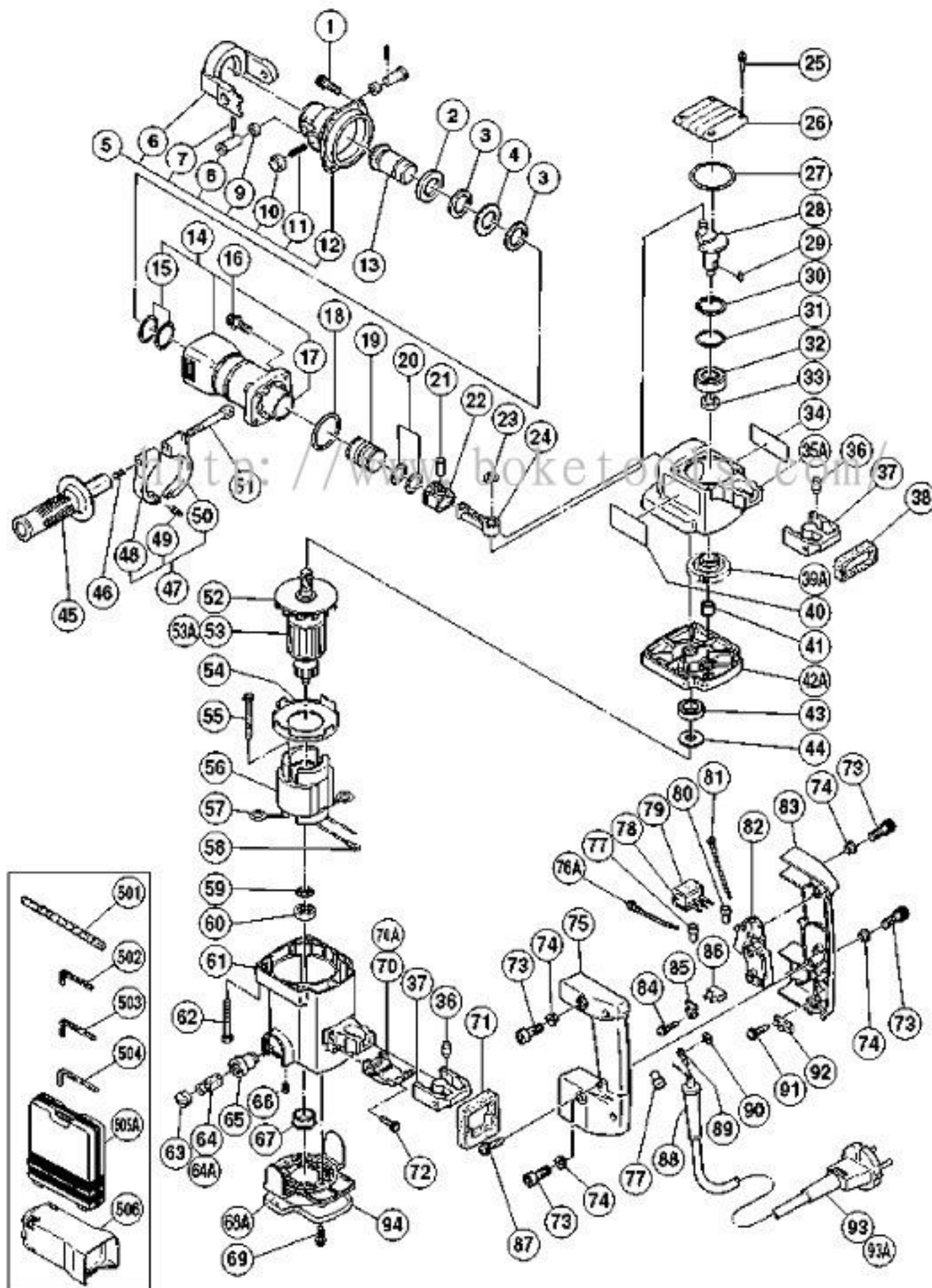

PARTS

H41SA

ITEM No.	CODE No.	DESCRIPTION	No. USED	REMARKS
1	993-040	NYLOCK HIGH TENSION BOLT M7X25	4	
2	991-695	DAMPER WASHER	1	
3	983-235	DAMPER	2	
4	983-236	WASHER	1	
5	993-042	FRONT COVER ASS'Y	1	INCLUD. 6-12
6	990-131	RETAINER	1	
7	991-697	ROLL PIN D4X20	2	
8	990-135	RETAINER PIN	2	
9	990-134	DAMPER (B)	2	
10	990-133	PUSHING BUTTON	1	
11	990-132	SET SPRING	1	
12	991-693	FRONT COVER	1	
13	991-708	SECOND HAMMER	1	
14	310-109	CYLINDER CASE ASS'Y	1	INCLUD. 15, 17
15	983-234	O-RING (A)	2	
16	993-041	NYLOCK BOLT (W/FLANGE) M6X25	4	
17	310-110	CYLINDER	1	
18	980-715	O-RING (S-48)	1	
19	310-112	STRIKER	1	
20	986-104	O-RING	2	
21	980-708	PISTON PIN	1	
22	310-113	PISTON	1	
23	939-540	RETAINING RING FOR D10 SHAFT (10 PCS.)	1	
24	310-114	CONNECTING ROD	1	
25	983-162	SEAL LOCK HEX. SOCKET HD. BOLT M4X12	4	
26	310-115	CRANK COVER	1	
27	980-744	O-RING (S-55)	1	
28	310-116	CRANK SHAFT	1	
29	930-511	FEATHER KEY 4X4X10	1	
30	948-391	RETAINING RING FOR D40 HOLE	1	
31	996-363	O-RING (S-40)	1	
32	620-3DD	BALL BEARING 6203DDCMPS2L	1	
33	310-119	OIL SEAL	1	
* 34		NAME PLATE	1	
35A	310-117	CRANK CASE	1	
36	310-124	HANDLE DAMPER	8	
37	310-123	TRANSATORY UNIT	2	
38	310-126	HANDLE PACKING (A)	1	
39A	310-120	FIRST GEAR	1	
40		HITACHI LABEL	1	
41	939-299	NEEDLE BEARING (M661)	1	
42A	310-129	GEAR COVER ASS'Y	1	INCLUD. 41
43	620-1VV	BALL BEARING 6201VVCMP2L	1	

*:ALTERNATIVE PARTS

PARTS

H41SA

ITEM No.	CODE No.	DESCRIPTION	No. USED	REMARKS
44	971-736	WASHER (B)	1	
* 45	981-870	SIDE HANDLE	1	EXCEPT FOR KOR, CHN
* 46	672-612	SPRING	1	EXCEPT FOR KOR, CHN
* 47	980-657	HANDLE HOLDER ASS'Y	1	INCLUD. 48-50 EXCEPT FOR KOR, CHN
* 48	980-659	HANDLE HOLDER (B)	1	EXCEPT FOR KOR, CHN
* 49	949-875	ROLL PIN D6X22 (10 PCS.)	1	EXCEPT FOR KOR, CHN
* 50	980-658	HANDLE HOLDER (A)	1	EXCEPT FOR KOR, CHN
* 51	971-785	HANDLE BOLT	1	EXCEPT FOR KOR, CHN
52	310-130	FAN	1	
* 53	360-360E	ARMATURE ASS'Y 220V-230V	1	INCLUD. 52
54	980-931	FAN GUIDE	1	
55	953-121	HEX. HD. TAPPING SCREW D5X50	2	
* 56	340-317E	STATOR ASS'Y 220V-230V	1	INCLUD. 57, 58
57	930-703	BRUSH TERMINAL	2	
58	930-804	TERMINAL M4.0 (10 PCS.)	1	FOR STATOR
59	982-631	WASHER (A)	1	
60	608-VVM	BALL BEARING 608VVC2PS2L	1	
61	310-146	HOUSING ASS'Y	1	INCLUD. 65, 66
62	980-951	HEX. SOCKET HD. BOLT (W/FLANGE) M5X45	4	
63	935-829	BRUSH CAP	2	
* 64A	999-073	CARBON BRUSH (AUTO STOP TYPE) (1 PAIR)	2	FOR SIN, GBR, ITA, FRG, FRA, HOL, DEN, FIN, SWE, AUT, NOR, ESP, SUI, AUS
65	971-001	BRUSH HOLDER	2	
66	938-477	HEX. SOCKET SET SCREW M5X8	2	
67	310-111	BEARING BUSHING (B)	1	
68A	314-130	TAIL COVER ASS'Y	1	INCLUD. 94
69	307-811	TAPPING SCREW (W/FLANGE) D4X16 (BLACK)	2	
* 70	980-754	INTERNAL WIRE HOLDER	1	
71	310-125	HANDLE PACKING (B)	1	
72	985-480	TAPPING SCREW (W/WASHER) D5X20	2	
73	991-690	SEAL LOCK HEX. SOCKET HD. BOLT M5X12	4	
74	991-711	DISTANCE PIECE (B)	4	
75	310-142	HANDLE (B)	1	
* 77	959-141	CONNECTOR 50092 (10 PCS.)	2	EXCEPT FOR CHN
82	992-891	SWITCH (A) (1P SCREW TYPE) W/O LOCK	1	
83	310-141	HANDLE (A)	1	
87	307-028	TAPPING SCREW (W/FLANGE) D4X25 (BLACK)	3	
* 88	953-327	CORD ARMOR D8.8	1	
89	992-810	TERMINAL	1	FOR CORD
91	984-750	TAPPING SCREW (W/FLANGE) D4X16	2	
92	960-266	CORD CLIP	1	
* 93	500-424Z	CORD	1	(CORD ARMOR D8.8) FOR KUW, SIN
94	314-262	PLATE	1	

*:ALTERNATIVE PARTS

STANDARD ACCESSORIES

ITEM No.	CODE No.	DESCRIPTION	No. USED	REMARKS
501	980-752	BULL POINT 280MM (HEX. SHANK TYPE)	1	
* 502	943-277	HEX. BAR WRENCH 3MM	1	
503	944-458	HEX. BAR WRENCH 4MM	1	
504	944-459	HEX. BAR WRENCH 5MM	1	
505A	310-131	CASE (PLASTIC)	1	