

Tuff Torq K46 CR

Spare parts

Ersatzteile

Pièces détachées

Reserve onderdelen

Repuestos

Reservdelar

ACTUAL PARTS
 MAY NOT APPEAR
 AS SHOWN

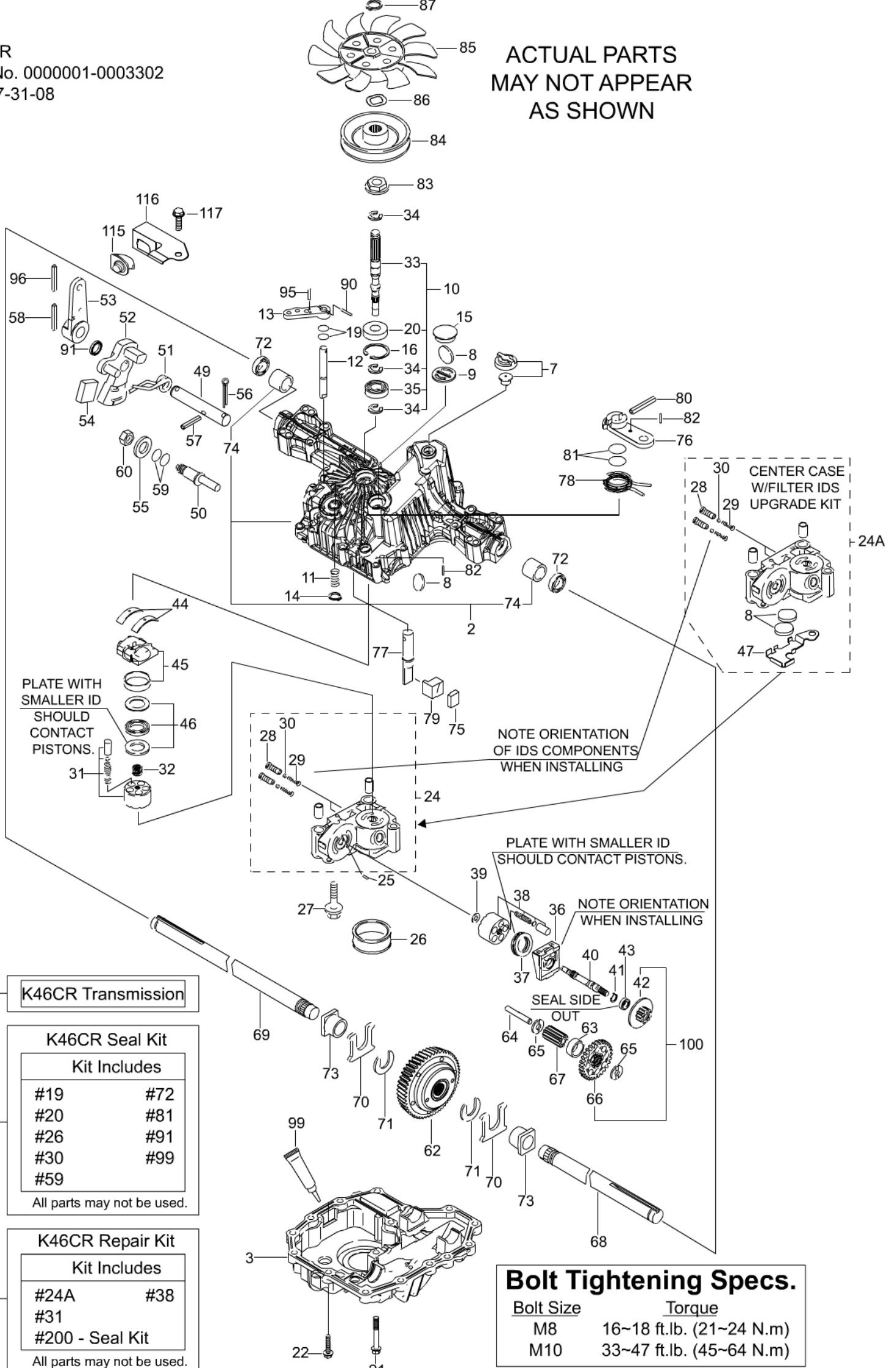

PLATE WITH
 SMALLER ID
 SHOULD
 CONTACT
 PISTONS.

NOTE ORIENTATION
 OF IDS COMPONENTS
 WHEN INSTALLING

PLATE WITH SMALLER ID
 SHOULD CONTACT PISTONS.

NOTE ORIENTATION
 WHEN INSTALLING

SEAL SIDE
 OUT

1- K46CR Transmission

K46CR Seal Kit

Kit Includes

- | | |
|-----|-----|
| #19 | #72 |
| #20 | #81 |
| #26 | #91 |
| #30 | #99 |
| #59 | |

All parts may not be used.

K46CR Repair Kit

Kit Includes

- | | |
|-----------------|-----|
| #24A | #38 |
| #31 | |
| #200 - Seal Kit | |

All parts may not be used.

Bolt Tightening Specs.

Bolt Size	Torque
M8	16~18 ft.lb. (21~24 N.m)
M10	33~47 ft.lb. (45~64 N.m)

K46CR

K46CR 000001-0003302 - (K46CR-HOP / 7A646084320)

KEY NO.	PART NO.	DESCRIPTION	TUFF TORQ PART NO
1	523 05 82-01	K46 CR HOP	7A646084320
2	523 05 83-01	UPPER CASE KIT (K46ADL)	1A646084430
3	523 05 85-01	LOWER CASE ADL	1A646084180
7	505 56 38-01	VENT VALVE 15	19485924252
8	505 56 39-01	MAGNET	19216324360
9	502 45 20-01	MAGNET HOLDER	1A646029000
11	502 46 01-01	SPRING 25	19215427281
12	505 56 40-01	BYPASS SHAFT A	1A646029510
13	535 40 28-17	BYPASS LEVER	1A632029520
14	535 40 28-49	SNAP RING 10	19216829570
15	535 40 28-32	SEALING CAP 30	1C655036300
16	535 40 28-50	SNAP RING C 35	22252000350
19	535 40 28-15	O-RING 1A P10A	24311240100
20	502 46 23-01	SEAL TC 153507	24421153507
21	535 40 28-51	TAPPING SCREW 8 * 55	26476080552
22	535 40 28-28	TAPPING SCREW 8 * 30	26476080302
24	523 05 86-01	SERICE KIT CENTER CASE	1A646099750
25	535 40 28-58	PIN 3 * 9.8	19216824760
26	535 40 28-59	FILTER 105	168T2025220
27	535 40 28-63	BOLT 10 * 75	26106100752
28	505 56 43-01	IDS VALVE 1.2	1A646024800
29	535 40 28-61	IDS SPRING	1A646024761
30	535 40 28-62	IDS FILTER 300	1A646024790
31	535 40 28-64	CYLINDER BLOCK (PUMP) KIT	19216825111
32	535 40 28-69	SPRING	1A646025200
33	505 56 45-01	PUMP SHAFT, STANDARD	1A646025251
34	535 40 28-07	E-RING 15	19215485310
35	535 40 28-71	BEARING 6202C3	24101062020
36	535 40 28-72	MOTOR HOUSING	19216824210
37	535 40 28-73	THRUST BEARING 51106	19216324240
38	502 85 27-01	CYLINDER BLOCK (MOTOR) KIT	187Q0025140
39	535 40 28-79	WASHER 12 * 24 * 1	19216825230
40	502 45 17-01	MOTOR SHAFT	1A646025271
41	535 40 28-81	SNAP RING S15	19215425310
42	502 45 18-01	BRAKE DISC/MOTOR GEAR (11T)	1A646025400
43	535 40 28-83	BEARING 6202 RSR C3	168T2025280
44	535 40 28-84	THRUST METAL	19216327051
45	523 05 88-01	SWASH PLATE CMP	168T2084530
46	523 05 89-01	THRUST BEARING (PUMP) KIT	19216399000
49	502 45 22-01	CONTROL SHAFT	1A646029911
50	502 85 30-01	FULCRUM	168T2029920
51	505 56 47-01	TORSION SPRING	168T2029800
52	535 41 49-51	CONTROL ARM A	168T2029740

KEY NO.	PART NO.	DESCRIPTION	TUFF TORQ PART NO.
53	505 56 48-01	CONTROL LEVER F	1A646029400
54	535 40 28-91	JERKY PLATE	168T2029350
55	535 40 28-13	WASHER 12 ea 1 \$1.05	22137120000
56	502 45 24-01	COTTER PIN 1/8" * 3/4"	1A646029940
57	502 46 18-01	SPRING PIN 6 * 36	22351060036
58	535 40 28-09	ROLL PIN 6 * 40	22351060040
59	535 40 28-14	O-RING 1A P14	24311000140
60	506 95 66-01	NUT 12	26776120002
62	523 05 90-01	ETC DIFF COMP	1A646031700
63	535 41 46-05	FINAL PINION COLLAR	1A646033250
64	535 41 46-06	REDUCTION SHAFT	1A646088820
65	502 46 07-01	WASHER 12 * 32 * 3.2	19216833420
66	502 45 26-01	REDUCTION GEAR (37T)	1A646033450
67	502 45 27-01	FINAL PINION GEAR (10T)	1A646033531
68	535 41 46-10	AXLE SHAFT, LEFT	1A646034111
69	535 41 46-11	AXLE SHAFT, RIGHT	1A646034121
70	535 41 46-12	THRUST WASHER	19216334261
71	535 41 46-13	RING 17	19216834270
72	535 40 28-37	SEAL 19 * 32 * 8	19216334280
73	535 41 46-14	BUSHING 19 * 25	19216834350
74	522 54 12-01	BUSHING 19.05	19216334240
75	535 41 46-16	BRAKE SHOE	1A646036121
76	535 40 28-38	BRAKE LEVER	1A646036160
77	535 41 46-17	BRAKE SHAFT	1A646036171
78	535 40 28-39	BRAKE RETURN SPRING	168T2036180
79	535 41 46-18	BRAKE ACTUATOR	1A646036200
80	535 40 28-40	SPRING PIN 5 * 32	22351050032
81	535 41 46-19	O-RING 1A P12	24311000120
82	535 40 28-41	SPRING PIN 4 * 16	22351040016
83	506 98 66-01	SPLINE COLLAR	1A646025300
84	502 45 19-01	PULLEY L	1A646025810
85	506 98 68-01	FAN, BLACK	1A646083070
86	506 98 65-01	WAVE WASHER	1A646083060
87	735 31 15-00	SNAP RING	19215489090
90	535 40 28-16	SPRING PIN 3.0A * 20	22351030020
91	535 40 28-46	OIL SEAL 16 * 22 * .03	1A646024440
95	535 40 28-33	SPRING PIN 3.0A * 16	22351030016
96	505 56 50-01	ROLL PIN 3.5 * 40	22351035040
115	505 56 51-01	SWITCH 6440-11 DELTA	1A632086550
116	505 56 52-01	SWITCH BRACKET	1A646083250
117	505 56 54-01	TAPPING SCREW 8 * 20	26476080202
200	502 45 33-01	K46 & T40 SEAL KIT (ALL MODELS)	1A646099140
201	523 05 91-01	REPAIR KIT (K46 CE,CR)	1A646099540