

# Tuff Torq K46 DF

**Spare parts**

**Ersatzteile**

**Pièces détachées**

**Reserve onderdelen**

**Repuestos**

**Reservdelar**

---

ACTUAL PARTS  
 MAY NOT APPEAR  
 AS SHOWN

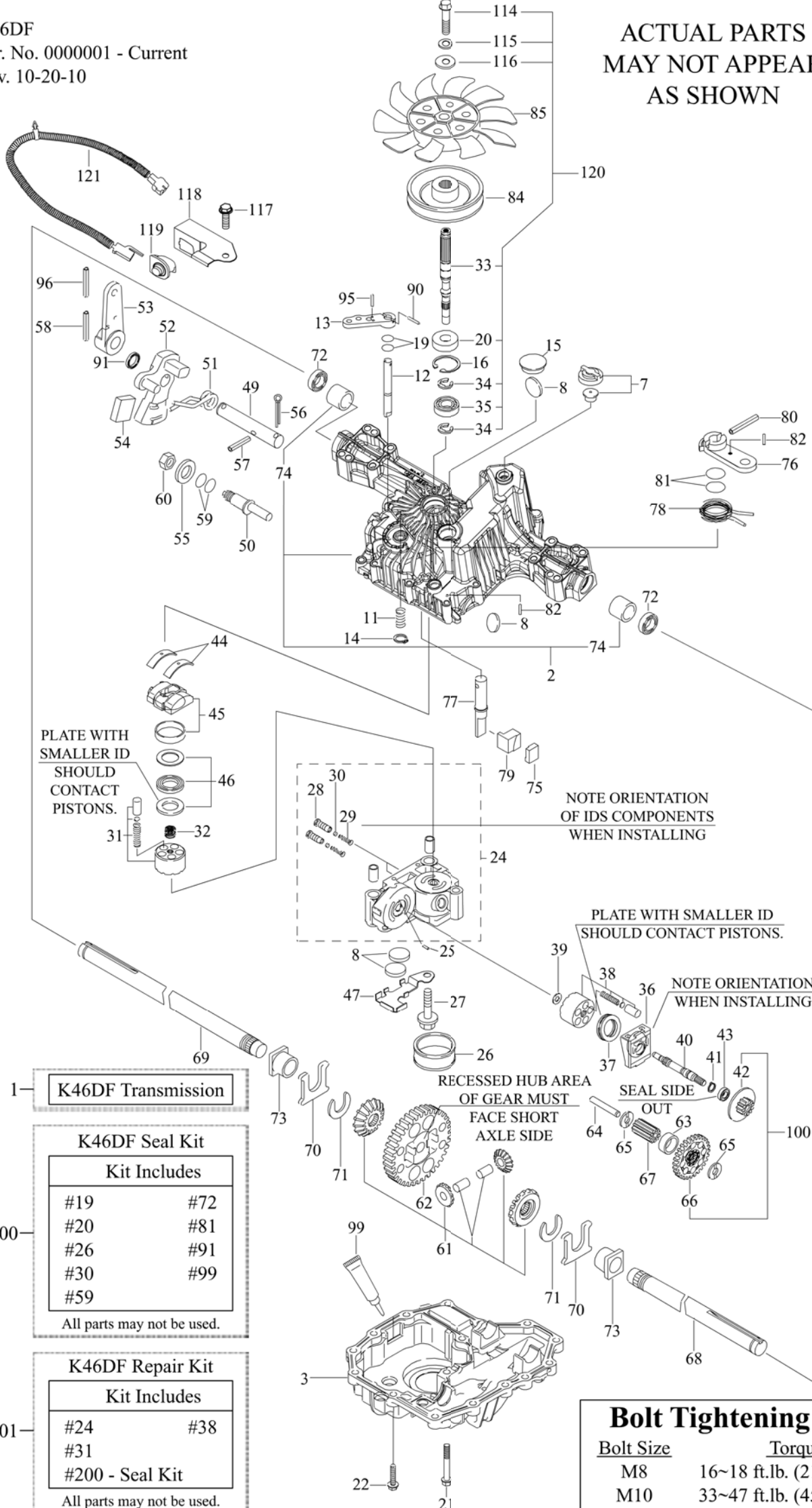

PLATE WITH SMALLER ID SHOULD CONTACT PISTONS.

NOTE ORIENTATION OF IDS COMPONENTS WHEN INSTALLING

PLATE WITH SMALLER ID SHOULD CONTACT PISTONS.

NOTE ORIENTATION WHEN INSTALLING

RECESSED HUB AREA OF GEAR MUST FACE SHORT AXLE SIDE

SEAL SIDE OUT

1 — K46DF Transmission

**K46DF Seal Kit**

**Kit Includes**

- |     |     |
|-----|-----|
| #19 | #72 |
| #20 | #81 |
| #26 | #91 |
| #30 | #99 |
| #59 |     |

All parts may not be used.

**K46DF Repair Kit**

**Kit Includes**

- |                 |     |
|-----------------|-----|
| #24             | #38 |
| #31             |     |
| #200 - Seal Kit |     |

All parts may not be used.

**Bolt Tightening Specs.**

| Bolt Size | Torque                   |
|-----------|--------------------------|
| M8        | 16~18 ft.lb. (21~24 N.m) |
| M10       | 33~47 ft.lb. (45~64 N.m) |

K468 :                    K468 : 0000001----- (K468 : -HOP / 7A646084(' \$)

| KEY NO. | PART NO.     | DESCRIPTION                 | TUFF TORQ PART NO |
|---------|--------------|-----------------------------|-------------------|
| 1       | 532 43 68-14 | K46DF HOP                   | 7A646084430       |
| 2       | 578 97 30-01 | UPPER CASE KIT              | 1A646084431       |
| 3       | 578 97 31-01 | LOWER HOUSING               | 1A646084181       |
| 7       | 578 97 32-01 | VENT VALVE                  | 168T2024250       |
| 8       | 505 56 39-01 | MAGNET                      | 19216324360       |
| 10      | 578 97 33-01 | PUMP SHAFT/BEARING KIT      | 1A646099990       |
| 11      | 502 46 01-01 | SPRING 25                   | 19215427281       |
| 12      | 505 56 40-01 | BYPASS SHAFT A              | 1A646029510       |
| 13      | 535 40 28-17 | BYPASS LEVER                | 1A632029520       |
| 14      | 535 40 28-49 | SNAP RING 10                | 19216829570       |
| 15      | 535 40 28-32 | SEALING CAP 30              | 1C655036300       |
| 16      | 535 40 28-50 | SNAP RING C 35              | 22252000350       |
| 19      | 535 40 28-15 | O-RING 1A P10A              | 24311240100       |
| 20      | 502 46 23-01 | SEAL TC 153507              | 24421153507       |
| 21      | 535 40 28-51 | TAPPING SCREW 8 * 55        | 26476080552       |
| 22      | 535 40 28-28 | TAPPING SCREW 8 * 30        | 26476080302       |
| 24      | 578 97 35-01 | CENTER CASE W/IDS FILT      | 1A646099750       |
| 25      | 535 40 28-58 | PIN 3 * 9.8                 | 19216824760       |
| 26      | 535 40 28-59 | FILTER 105                  | 168T2025220       |
| 27      | 578 97 36-01 | BOLT 10 * 75                | 168T2099990       |
| 28      | 505 56 43-01 | IDS VALVE 1.2               | 1A646024800       |
| 29      | 535 40 28-61 | IDS SPRING                  | 1A646024761       |
| 30      | 535 40 28-62 | IDS FILTER 300              | 1A646024790       |
| 31      | 578 97 38-01 | CYLINDER BLOCK (PUMP) Kit   | 168T2025090       |
| 32      | 535 40 28-69 | SPRING                      | 1A646025200       |
| 33      | 578 97 37-01 | PUMP SHAFT                  | 1A646025240       |
| 34      | 535 40 28-07 | E-RING 15                   | 19215485310       |
| 35      | 535 40 28-71 | BEARING 6202C3              | 24101062020       |
| 36      | 535 40 28-72 | MOTOR HOUSING               | 19216824210       |
| 37      | 578 97 39-01 | THRUST BEARING 51106        | 1A646034750       |
| 38      | 578 97 55-01 | CYLINDER BLOCK (MOTOR) KIT  | 168T2025080       |
| 39      | 535 40 28-79 | WASHER 12 * 24 * 1          | 19216825230       |
| 40      | 502 45 17-01 | MOTOR SHAFT                 | 1A646025271       |
| 41      | 535 40 28-81 | SNAP RING S15               | 19215425310       |
| 42      | 502 45 18-01 | BRAKE DISC/MOTOR GEAR (11T) | 1A646025400       |
| 43      | 535 40 28-83 | BEARING 6202 RSR C3         | 168T2025280       |
| 44      | 535 40 28-84 | THRUST METAL                | 19216327051       |
| 45      | 523 05 88-01 | SWASH PLATE CMP             | 168T2084530       |
| 46      | 523 05 89-01 | THRUST BEARING (PUMP) KIT   | 19216399000       |
| 49      | 502 45 22-01 | CONTROL SHAFT               | 1A646029911       |
| 50      | 502 85 30-01 | FULCRUM                     | 168T2029920       |
| 51      | 505 56 47-01 | TORSION SPRING              | 168T2029800       |
| 52      | 535 41 49-51 | CONTROL ARM A               | 168T2029740       |

| KEY NO. | PART NO.     | DESCRIPTION                     | TUFF TORQ PART NO. |
|---------|--------------|---------------------------------|--------------------|
| 53      | 578 97 41-01 | CONTROL LEVER                   | 1A646029410        |
| 54      | 578 97 42-01 | JERKY PLATE                     | 168T2029360        |
| 55      | 535 40 28-13 | WASHER 12 ea                    | 22137120000        |
| 56      | 502 45 24-01 | COTTER PIN 1/8" * 3/4"          | 1A646029940        |
| 57      | 502 46 18-01 | SPRING PIN 6 * 36               | 22351060036        |
| 58      | 535 40 28-09 | ROLL PIN 6 * 40                 | 22351060040        |
| 59      | 535 40 28-14 | O-RING 1A P14                   | 24311000140        |
| 60      | 506 95 66-01 | NUT 12                          | 26776120002        |
| 61      | 578 97 44-01 | DIFFERENTIAL GEAR KIT           | 1A646031570        |
| 62      | 578 97 45-01 | FINAL GEAR (54T)                | 1A646033520        |
| 63      | 535 41 46-05 | FINAL PINION COLLAR             | 1A646033250        |
| 64      | 578 97 46-01 | REDUCTION SHAFT                 | 1A646033410        |
| 65      | 502 46 07-01 | WASHER 12 * 32 * 3.2            | 19216833420        |
| 66      | 502 45 26-01 | REDUCTION GEAR (37T)            | 1A646033450        |
| 67      | 502 45 27-01 | FINAL PINION GEAR (10T)         | 1A646033531        |
| 68      | 535 41 46-10 | AXLE SHAFT, LEFT                | 1A646034111        |
| 69      | 535 41 46-11 | AXLE SHAFT, RIGHT               | 1A646034121        |
| 70      | 535 41 46-12 | THRUST WASHER                   | 19216334261        |
| 71      | 535 41 46-13 | RING 17                         | 19216834270        |
| 72      | 535 40 28-37 | SEAL 19 * 32 * 8                | 19216334280        |
| 73      | 535 41 46-14 | BUSHING 19 * 25                 | 19216834350        |
| 74      | 522 54 12-01 | BUSHING 19.05                   | 19216334240        |
| 75      | 535 41 46-16 | BRAKE SHOE                      | 1A646036121        |
| 76      | 535 40 28-38 | BRAKE LEVER                     | 1A646036160        |
| 77      | 535 41 46-17 | BRAKE SHAFT                     | 1A646036171        |
| 78      | 535 40 28-39 | BRAKE RETURN SPRING             | 168T2036180        |
| 79      | 535 41 46-18 | BRAKE ACTUATOR                  | 1A646036200        |
| 80      | 535 40 28-40 | SPRING PIN 5 * 32               | 22351050032        |
| 82      | 535 40 28-41 | SPRING PIN 4 * 16               | 22351040016        |
| 84      | 578 97 47-01 | PULLEY                          | 1A646025850        |
| 85      | 578 97 48-01 | FAN, WHITE                      | 1A646083050        |
| 90      | 535 40 28-16 | SPRING PIN 3.0A * 20            | 22351030020        |
| 91      | 535 40 28-46 | OIL SEAL 16 * 22 * .03          | 1A646024440        |
| 95      | 535 40 28-33 | SPRING PIN 3.0A * 16            | 22351030016        |
| 96      | 505 56 50-01 | ROLL PIN 3.5 * 40               | 22351035040        |
| 99      | 578 97 49-01 | SEALANT                         | 1A646099500        |
| 100     | 578 97 50-01 | MOTOR GEAR KIT                  | 1A646099020        |
| 114     | 578 97 51-01 | BOLT                            | 1A646083090        |
| 115     | 578 97 52-01 | LOCK WASHER                     | 1A646083100        |
| 116     | 578 97 53-01 | WASHER                          | 1A646083110        |
| 117     | 505 56 54-01 | TAPPING SCREW 8 * 20            | 26476080202        |
| 118     | 505 56 52-01 | SWITCH BRACKET                  | 1A646083250        |
| 119     | 505 56 51-01 | SWITCH 6440-11 DELTA            | 1A632086550        |
| 121     | 532 44 12-62 | PIGTAIL WIRE                    | 441262             |
| 200     | 502 45 33-01 | K46 & T40 SEAL KIT (ALL MODELS) | 1A646099140        |
| 201     | 578 97 54-01 | REPAIR KIT                      | 1A646099540        |