

Tuff Torq K46 BA

Spare parts
Ersatzteile
Pièces détachées
Reserve onderdelen
Repuestos
Reservdelar

ACTUAL PARTS
 MAY NOT APPEAR
 AS SHOWN

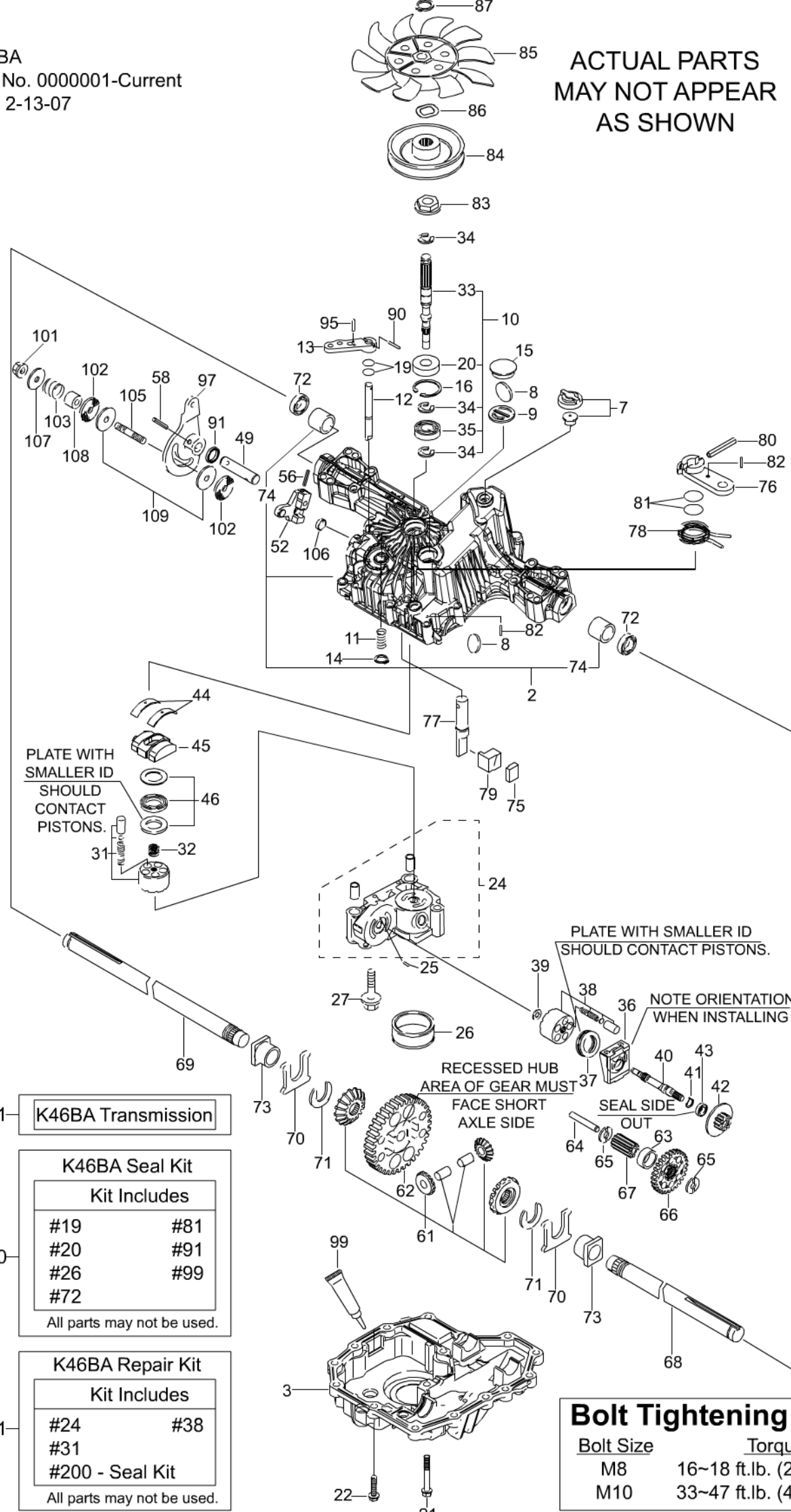

1 K46BA Transmission

200 K46BA Seal Kit
 Kit Includes
 #19 #81
 #20 #91
 #26 #99
 #72
 All parts may not be used.

201 K46BA Repair Kit
 Kit Includes
 #24 #38
 #31
 #200 - Seal Kit
 All parts may not be used.

Bolt Tightening Specs.

Bolt Size	Torque
M8	16~18 ft.lb. (21~24 N.m)
M10	33~47 ft.lb. (45~64 N.m)

K46BA

K46BA 0000001-9999999 - (K46BA-HOP / 7A646084100)

KEY NO.	PART NO.	DESCRIPTION	TUFF TORQ PART NO
1	522 54 04-01	K46BA TRANSAXLE	7A646084100
2	505 56 36-01	UPPER CASE KIT	1A646084421
3	522 54 05-01	LOWER CASE	1A646024163
7	505 56 38-01	VENT VALVE 15	19485924252
8	505 56 39-01	MAGNET	19216324360
9	502 45 20-01	MAGNET HOLDER	1A646029000
11	502 46 01-01	SPRING 25	19215427281
12	505 56 40-01	BYPASS SHAFT A	1A646029510
13	535 40 28-17	BYPASS LEVER	1A632029520
14	535 40 28-49	SNAP RING 10	19216829570
15	535 40 28-32	SEALING CAP 30	1C655036300
16	535 40 28-50	SNAP RING C 35	22252000350
21	535 40 28-51	TAPPING SCREW 8 * 55	26476080552
22	535 40 28-28	TAPPING SCREW 8 * 30	26476080302
24	522 53 82-01	CENTER CASE F	1A646024870
25	535 40 28-58	PIN 3 * 9.8	19216824760
26	535 40 28-59	FILTER 105	168T2025220
27	535 40 28-63	BOLT 10 * 75	26106100752
31	535 40 28-64	CYLINDER BLOCK (PUMP) KIT	19216825111
32	535 40 28-69	SPRING	1A646025200
33	505 56 45-01	PUMP SHAFT, STANDARD	1A646025251
34	535 40 28-07	E-RING 15	19215485310
35	535 40 28-71	BEARING 6202C3	24101062020
36	535 40 28-72	MOTOR HOUSING	19216824210
37	522 53 85-01	THRUST BEARING 51106	1A646034750
38	502 85 27-01	CYLINDER BLOCK (MOTOR) KIT	187Q0025140
39	535 40 28-79	WASHER 12 * 24 * 1	19216825230
40	502 45 17-01	MOTOR SHAFT	1A646025271
41	535 40 28-81	SNAP RING S15	19215425310
42	522 53 86-01	MOTOR GEAR (11T)	168T2025400
43	535 40 28-83	BEARING 6202 RSR C3	168T2025280
44	535 40 28-84	THRUST METAL	19216327051
45	502 45 52-01	SWASH PLATE	168T2084700
46	502 45 31-01	THRUST BEARING ASSEMBLY (PUMP)	1A646088150
52	522 53 88-01	CONTROL ARM D	1A646029770
56	502 45 24-01	COTTER PIN 1/8" * 3/4"	1A646029940
61	535 40 28-99	DIFF GEAR KIT	1A646031570
62	535 41 46-04	FINAL GEAR (54T)	1A646033520
63	535 41 46-05	FINAL PINION COLLAR	1A646033250

KEY NO.	PART NO.	DESCRIPTION	TUFF TORQ PART NO.
64	535 41 46-06	REDUCTION SHAFT	1A646088820
65	502 46 07-01	WASHER 12 * 32 * 3.2	19216833420
66	522 53 89-01	REDUCTION GEAR (37T)	168T2033450
67	502 45 27-01	FINAL PINION GEAR (10T)	1A646033531
68	535 41 46-10	AXLE SHAFT, LEFT	1A646034111
69	535 41 46-11	AXLE SHAFT, RIGHT	1A646034121
70	535 41 46-12	THRUST WASHER	19216334261
71	535 41 46-13	RING 17	19216834270
72	535 40 28-37	SEAL 19 * 32 * 8	19216334280
73	535 41 46-14	BUSHING 19 * 25	19216834350
74	502 85 33-01	BUSHING 19.05	168T2034240
75	535 41 46-16	BRAKE SHOE	1A646036121
76	535 40 28-38	BRAKE LEVER	1A646036160
77	535 41 46-17	BRAKE SHAFT	1A646036171
78	535 40 28-39	BRAKE RETURN SPRING	168T2036180
79	535 41 46-18	BRAKE ACTUATOR	1A646036200
80	535 40 28-40	SPRING PIN 5 * 32	22351050032
82	535 40 28-41	SPRING PIN 4 * 16	22351040016
83	506 98 66-01	SPLINE COLLAR	1A646025300
84	502 45 19-01	PULLEY L	1A646025810
85	506 98 68-01	FAN, BLACK	1A646083070
86	506 98 65-01	WAVE WASHER	1A646083060
87	735 31 15-00	SNAP RING	19215489090
90	535 40 28-16	SPRING PIN 3.0A * 20	22351030020
94	522 53 90-01	CONTROL SHAFT	1A646089670
95	535 40 28-33	SPRING PIN 3.0A * 16	22351030016
97	522 53 91-01	CONTROL LEVER	1A646029840
101	522 53 93-01	LOCK NUT 10	19216829860
102	522 53 94-01	WASHER 10 * 40 * 4	19216829810
103	522 53 95-01	SPRING	19216829790
104	535 40 28-09	ROLL PIN 6 * 40	22351060040
105	522 53 96-01	STUD 10 * 60	26216100602
106	522 53 98-01	SEALING CAP 18	27260180000
107	522 54 00-01	WASHER 10 * 36 * 2.8	19216829840
108	522 54 01-01	COLLAR 10 * 22 * 17	19216829850
109	522 54 02-01	FRICTION PLATE KIT	19216829770
119	505 56 58-01	TAPPING SCREW	26476080162
200	502 45 33-01	K46 & T40 SEAL KIT (ALL MODELS)	1A646099140
201	522 54 03-01	REPAIR KIT (K46L,M,W,H,AW,AX)	1A646099570